

ISO A1 - 594mm x 841mm

P:\2018\1800599-Dominion-PP-03.dwg, Last Saved: 4/11/2018 10:24 AM, by: Diane, Plotter: 417/2018 2:48 PM, by: Dave Lane

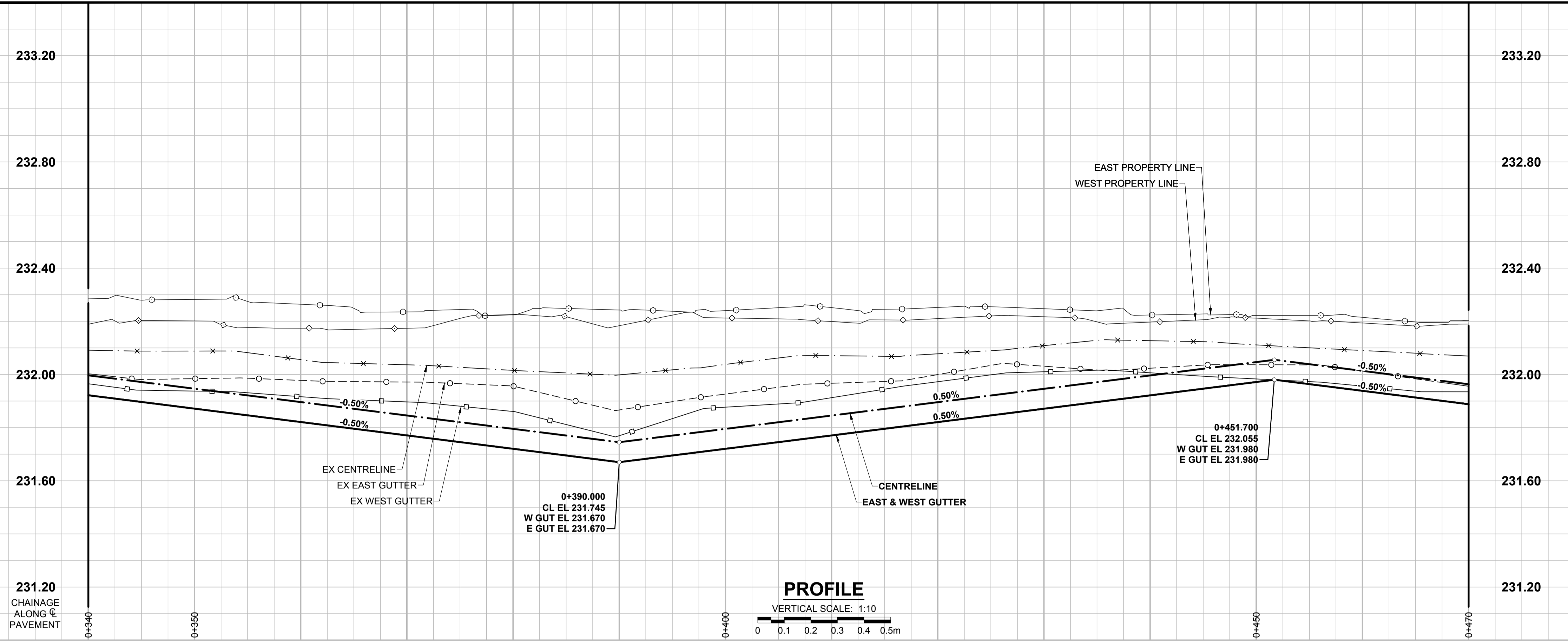

- NOTES**
- ADJUST MH AND CB RIMS TO NEW GRADES.
 - LAMP STANDARDS, HYDRO POLES, AND ANCHORS THAT REQUIRE TEMPORARY SUPPORT, REMOVAL OR REPLACEMENT, TO BE DONE SO AT THE EXPENSE OF THE CONTRACTOR AS NECESSARY.
 - CONTRACTOR TO REGRADE/RENEW EXISTING PRIVATE SIDEWALKS TO LIMITS AS SHOWN. SIDEWALKS TO BE RENEWED WITH CONCRETE UNLESS NOTED OTHERWISE.
 - CONTRACTOR TO TAKE PRECAUTIONARY STEPS TO PROTECT EXISTING TREES WITHIN THE LIMITS OF CONSTRUCTION FROM DAMAGE FROM CONSTRUCTION ACTIVITIES AS OUTLINED IN THE SPECIFICATIONS.
 - CONTRACTOR TO CONFIRM THE LOCATION OF ALL UTILITIES/SERVICES IN THE FIELD PRIOR TO CONSTRUCTION.
 - CB SD-023 & SD-024 OFFSETS ARE DIMENSIONED TO BOC. CB SD-025 OFFSETS ARE DIMENSIONED O/C.
 - IN GENERAL, PAVEMENT AND SIDEWALK AREAS TO BE REMOVED. MATCH RECONSTRUCTION LIMITS.
 - REFER TO BID OPPORTUNITY FOR DETAILS REGARDING TRAFFIC MANAGEMENT.
 - EXISTING LONG WATER SERVICES TO BE INSULATED (SD-018). REFER TO BID OPPORTUNITY FOR FURTHER REQUIREMENTS AND AS NOTED IN PLAN.
 - ALL COSTS, MATERIALS AND LABOR ASSOCIATED WITH THE RESTORATION OF THE CATHODIC PROTECTED WATERMAIN WILL BE RESPONSIBILITY OF THE CONTRACTOR.
 - MODIFIED BARRIER CURB & GUTTER INLET FRAME & COVER TF-122.
 - ADD 200.000 m TO ABBREVIATED ELEVATIONS TO OBTAIN GEODETIC ELEVATIONS.

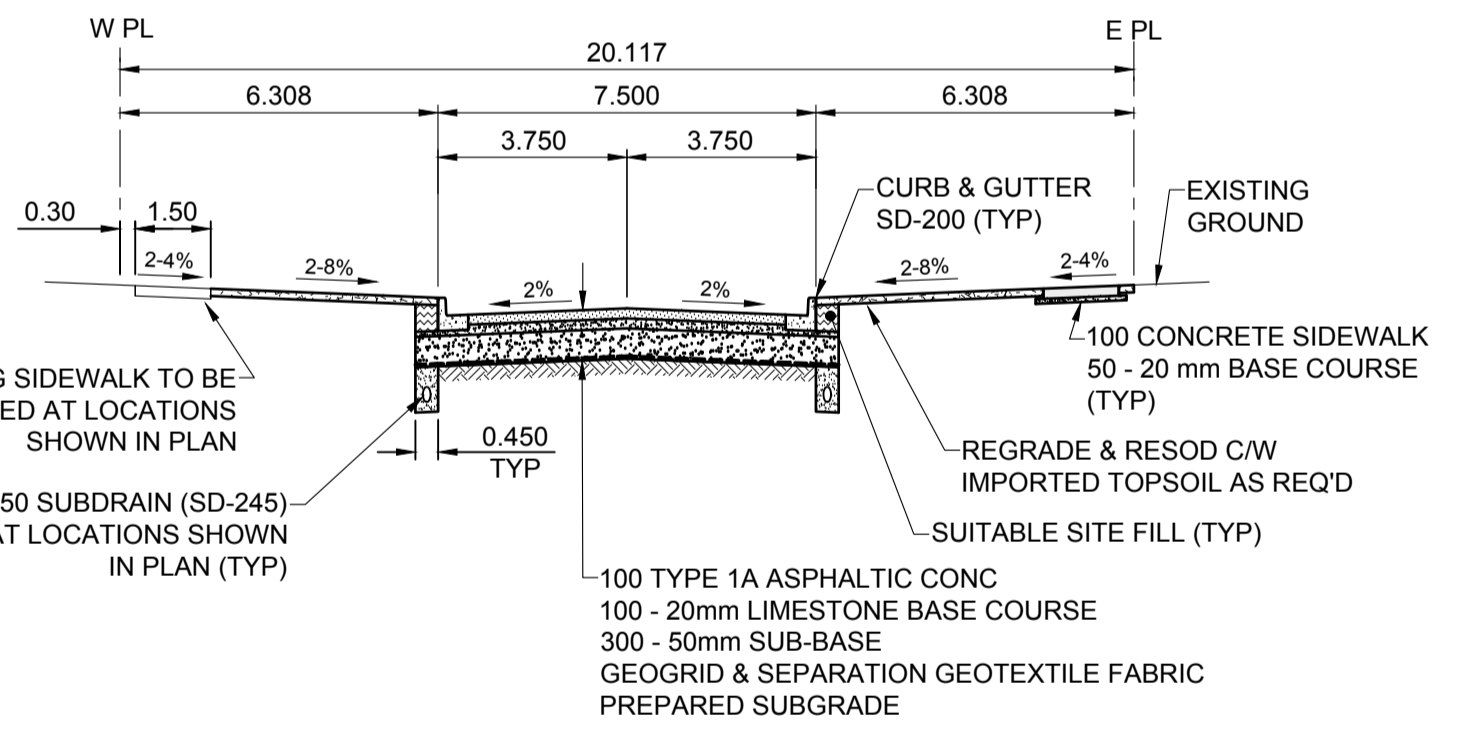
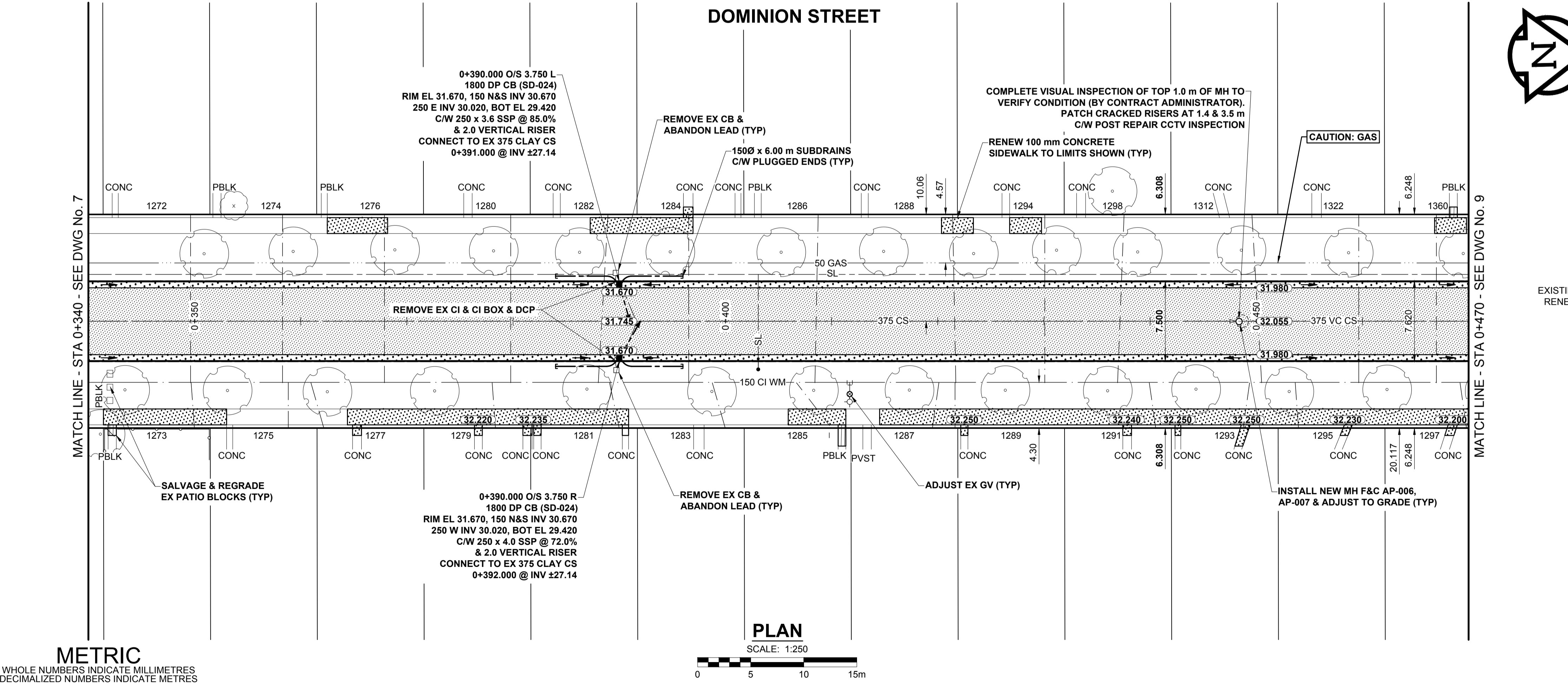

TYPICAL PAVEMENT SECTION
ASPHALT PAVEMENT STRUCTURE
SCALE: NTS

METRIC
WHOLE NUMBERS INDICATE MILLIMETRES
DECIMALIZED NUMBERS INDICATE METRES

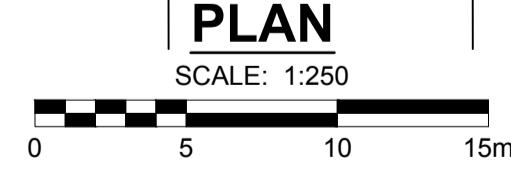

EXISTING		NEW		EXISTING		NEW		EXISTING		NEW	
LEGEND - PLAN		LEGEND - PLAN		LEGEND - PLAN		LEGEND - PLAN		LEGEND - PLAN		LEGEND - PLAN	
	GAS		MANHOLE		CONCRETE PAVEMENT		CATCH BASIN/CATCH PIT		CONC SIDEWALK/MEDIAN		TREE
	HYDRO HANDWELL/CABINET		PROPERTY LINE		ASPHALT PAVEMENT		SURVEY BAR		PAVING STONE		FENCE
	CATV/FIBRE OPTIC		TEST HOLE		GRAVEL		BOC/EDGE OF PAVEMENT		RAMP CURB		ELEVATION (33.333)
	TRAFFIC SIGNALS/PIT		PROPERTY LINE		PLANING/REMOVAL		TRAFFIC SIGN		DITCH		
	LAND DRAINAGE SEWER										
	SANITARY/COMBINED SEWER										
	CB LEAD/SSP/DCP										
	WATERMAIN										
	SUBDRAIN										
	DITCH										

LOCATION APPROVED
UNDERGROUND STRUCTURES

SUPR. UG STRUCTURES COMMITTEE DATE

NOTE:
LOCATION OF UNDERGROUND STRUCTURES AS SHOWN ARE BASED ON THE BEST INFORMATION AVAILABLE BUT NO GUARANTEE IS GIVEN THAT ALL EXISTING UTILITIES ARE SHOWN OR THAT THE GIVEN LOCATIONS ARE EXACT. CONFIRMATION OF EXISTENCE AND EXACT LOCATION OF ALL SERVICES MUST BE OBTAINED FROM THE INDIVIDUAL UTILITIES BEFORE PROCEEDING WITH CONSTRUCTION.

BM 36-048	ELEV 232.513 m	S. side Notre Dame Ave. Btwn. Downing St. & Dominion St. (Tab. in N. Conc. Foundation No. 1134 Notre Dame Ave. (Clifton Apts.), 1 m W. & 0.7 m below stucco of N.E. Cor. of Bldg.)
B	ISSUED FOR TENDER	18/04/12 RPB
A	ISSUED FOR CLIENT REVIEW	18/03/23 RPB
No.	REVISIONS	YY/MM/DD BY



DESIGNED BY	RPB	CHECKED BY	WRJ
DRAWN BY	DML	APPROVED BY	BWB
RELEASED FOR CONSTRUCTION			
HOR SCALE	1:250		
VERT SCALE	1:10		
DATE	18/01/26	DATE	

PROFESSIONAL'S SEAL

PRELIMINARY DRAWING

NOT TO BE USED FOR CONSTRUCTION

CONSULTANT FILE NAME
1800599-Dominion-PP-03.dwg

THE CITY OF WINNIPEG
PUBLIC WORKS DEPARTMENT
ENGINEERING DIVISION

2018 LOCAL STREETS PACKAGE
DOMINION STREET
YARWOOD AVE TO NOTRE DAME AVE
ASPHALT RECONSTRUCTION
PAVING AND GRADING
STA 0+340 TO STA 0+470

CITY DRAWING NUMBER: N/A
SHEET 8 OF 32
DRAWING No. 8

BID OPPORTUNITY No. 128-2018