

TYPICAL CROSS SECTION

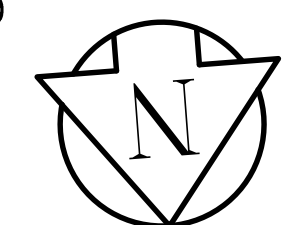
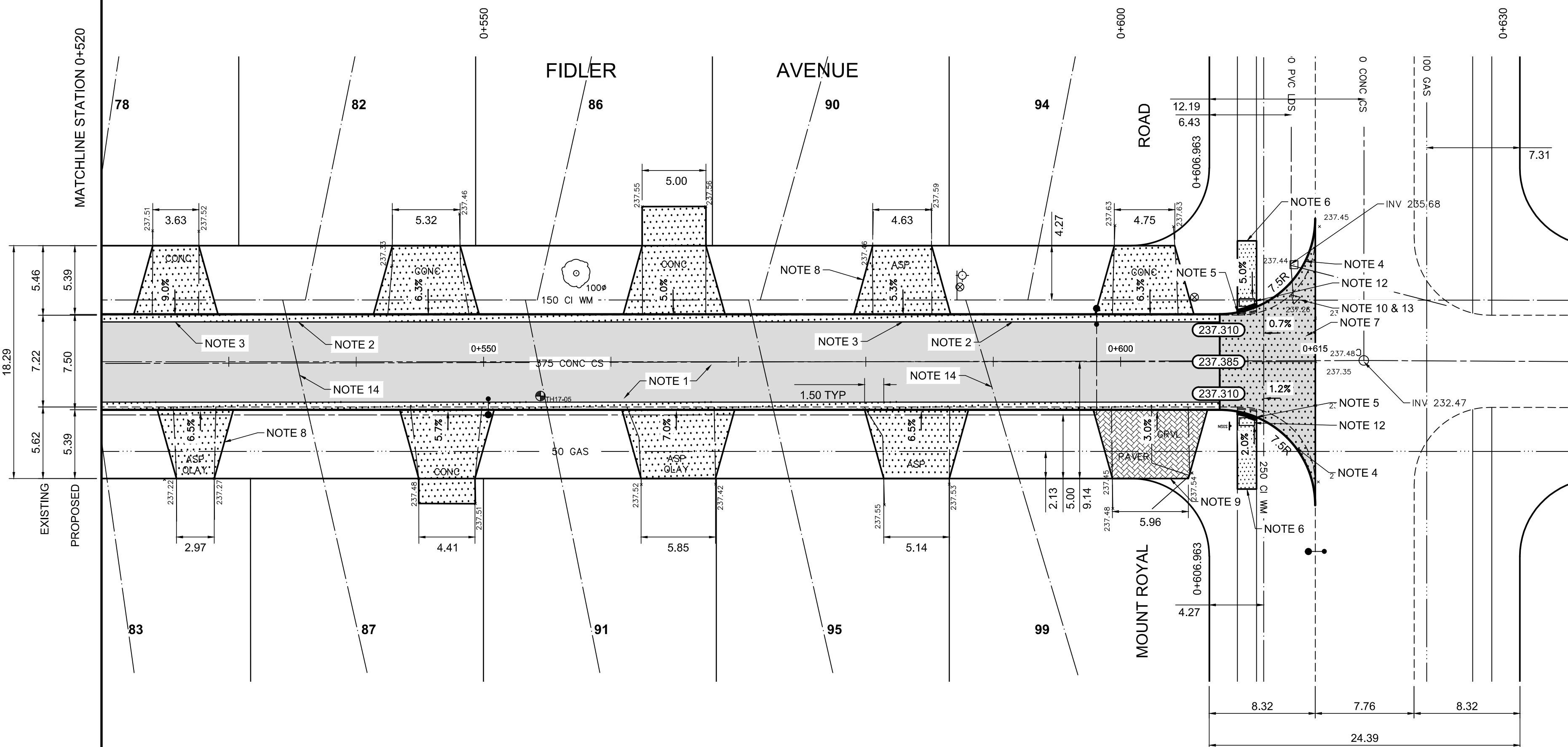

REFERENCE NOTES

- A. PAVEMENT DIMENSIONS ARE TO BACK OF CURB
- B. BASELINE IS CENTRE LINE RIGHT-OF-WAY
- C. PROPERTY LINES OBTAINED FROM CITY OF WINNIPEG L.B.I.S., AND NO SCALE FACTOR WAS APPLIED
- D. REFER TO AECOM FIELD BOOK NO. 4997

CONSTRUCTION NOTES

1. REMOVE EXISTING CONCRETE / ASPHALT PAVEMENT AND CONSTRUCT NEW ASPHALTIC PAVEMENT (100mm THICKNESS TYPE 1A)
2. CONSTRUCT NEW CONCRETE BARRIER CURB AND GUTTER (180mm HT & 600mm WIDTH)
3. CONSTRUCT NEW CONCRETE LIP CURB AND GUTTER (40mm HT, & 600mm WIDTH)
4. INSTALL NEW CONCRETE MODIFIED BARRIER CURB (150mm REVEAL HT. INTEGRAL)
5. INSTALL NEW CONCRETE RAMP CURB (8-12mm HT. INTEGRAL)
6. RENEW EXISTING 100mm CONCRETE SIDEWALK
7. CONSTRUCT NEW 200mm REINFORCED CONCRETE PAVEMENT c/w ASPHALT OVERLAY (50mm, TYPE 1A)
8. REMOVE EXISTING CONCRETE / ASPHALT AND CONSTRUCT NEW 150mm REINFORCED CONCRETE PAVEMENT
9. INSTALL AND REGRADE EXISTING PAVING STONES AS NECESSARY
10. ADJUST MANHOLE / CATCHBASIN TO GRADE
11. INSTALL NEW CAST IRON RISER RING
12. INSTALL NEW DETECTABLE WARNING SURFACE TILE
13. REMOVE EXISTING FRAME AND COVER AND INSTALL NEW BARRIER CURB AND GUTTER INLET FRAME AND COVER (AP-011/AP-012)
14. INSTALL STYROFOAM WATER SERVICE INSULATION

**AECOM**  
 Certificate of Authorization  
 AECOM Canada Ltd.  
 No. 4671 Date: \_\_\_\_\_

**METRIC**  
 WHOLE NUMBERS INDICATE MILLIMETRES  
 DECIMALIZED NUMBERS INDICATE METRES

EXISTING		PROPOSED		EXISTING		PROPOSED	
LEGEND - PLAN		LEGEND - PLAN		LEGEND - PROFILE		LEGEND - PROFILE	
150 mm W.M.	WATERMAIN	150 mm W.M.	WATERMAIN	— x —	PROFILE	— x —	PROFILE
Hydrant	HYDRANT	Hydrant	HYDRANT	— □ —	LEFT GUTTER	— □ —	LEFT GUTTER
Valve	VALVE	Valve	VALVE	— ○ —	RIGHT GUTTER	— ○ —	RIGHT GUTTER
300mm L.D.S.	LAND DRAINAGE SEWER	300mm L.D.S.	LAND DRAINAGE SEWER	— ◇ —	N/W PROPERTY LINE	— ◇ —	N/W PROPERTY LINE
250mm W.W.S.	WASTEWATER SEWER	250mm W.W.S.	WASTEWATER SEWER	— ○ —	S/E PROPERTY LINE	— ○ —	S/E PROPERTY LINE
Manhole	MANHOLE	Manhole	MANHOLE	— — —	PROPERTY LINE	— — —	PROPERTY LINE
Catch Basin	CATCH BASIN	Catch Basin	CATCH BASIN	— — —	SURVEY BAR	— — —	SURVEY BAR
Catch Pit	CATCH PIT	Catch Pit	CATCH PIT	— — —	ELEVATION	235.750	ELEVATION
Junctions	JUNCTIONS	Junctions	JUNCTIONS	— — —	TREE	— — —	TREE
Culvert	CULVERT	Culvert	CULVERT	— — —	SIDEWALK RAMP	— — —	SIDEWALK RAMP
Gas	GAS	Gas	GAS	— — —	CONCRETE SIDEWALK	— — —	CONCRETE SIDEWALK
Existing	LEGEND - PLAN	Proposed	LEGEND - PLAN	Existing	LEGEND - PLAN	Proposed	LEGEND - PROFILE

**LOCATION APPROVED UNDERGROUND STRUCTURES**  
 SUPV. U/G STRUCTURES COMMITTEE DATE \_\_\_\_\_  
 NOTE:  
 LOCATION OF UNDERGROUND STRUCTURES AS SHOWN ARE BASED ON THE BEST INFORMATION AVAILABLE, BUT NO GUARANTEE IS GIVEN THAT ALL EXISTING UTILITIES ARE SHOWN OR THAT THE GIVEN LOCATIONS ARE EXACT. CONFIRMATION OF EXISTENCE AND EXACT LOCATION OF ALL SERVICES MUST BE OBTAINED FROM THE INDIVIDUAL UTILITIES BEFORE PROCEEDING WITH CONSTRUCTION.

B.M. 39-061  
 ELEV. 236.440  
 N.E. Cor. Mount Royal Rd. & Bruce Ave.  
 T.B.L. on top of 0.30 m dia. x 2.4 m int. pipe, 6.5 m W. of E.L. of Mount Royal Rd. produced from the N. & 2.1 m S. of N.L. of Bruce Ave. produced from the E.

NO.	REVISIONS	DATE	BY
0	ISSUED FOR TENDER	04/10/2018	BC
A	ISSUED FOR REVIEW	03/23/2018	BC

**AECOM**

DESIGNED BY	JC	CHECKED BY	BC/KWR
DRAWN BY	JC	APPROVED BY	
HOR. SCALE:	1:250	RELEASED FOR CONSTRUCTION BY:	
VERTICAL:	1:10	DATE	

ENGINEER'S SEAL  
**K.W. RAE**  
 REGISTERED PROFESSIONAL ENGINEER  
 CONSULTANT DRAWING NO. CT-24

**THE CITY OF WINNIPEG**  
 PUBLIC WORKS DEPARTMENT  
 ENGINEERING DIVISION

2018 RESIDENTIAL STREET RENEWAL PROGRAM

FIDLER AVENUE - MOUNT ROYAL ROAD TO MOUNT ROYAL ROAD  
 ASPHALT PAVEMENT RECONSTRUCTION  
 STATION 0+520 TO MOUNT ROYAL ROAD

CITY DRAWING NUMBER SHEET 24 OF 29