

ROBLIN BOULEVARD EASTBOUND

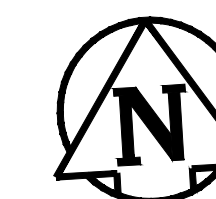
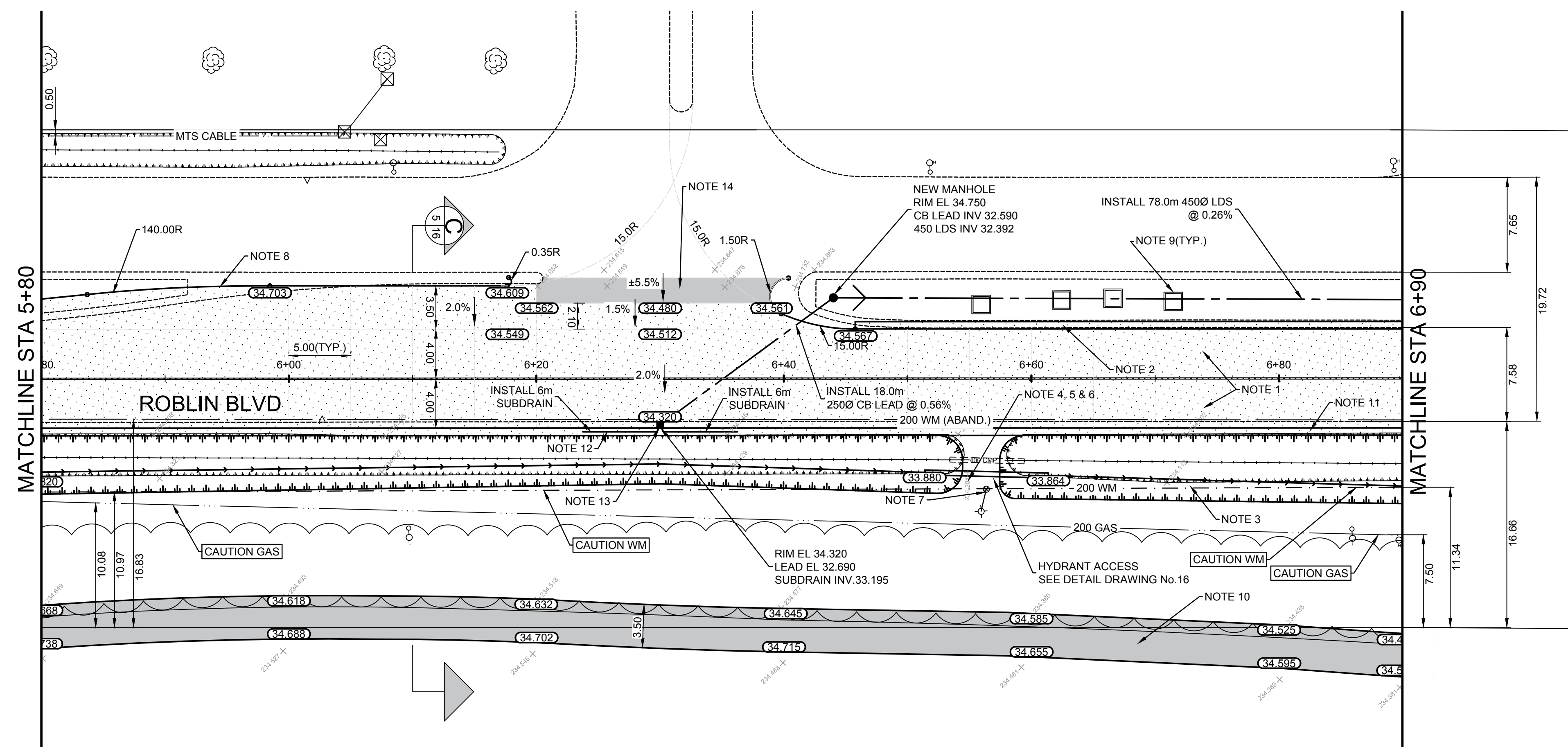

CONSTRUCTION NOTES

1. REMOVE EXISTING PAVEMENT AND CONSTRUCT NEW 250mm CONCRETE PAVEMENT (PLAIN DOWELLED) WITH 180mm INTEGRAL BARRIER CURB
2. CONSTRUCT MONOLITHIC CONCRETE SPLASH STRIP (SD-223A)
3. RE-GRADE EXISTING DITCH
4. REMOVE EXISTING CULVERT
5. INSTALL NEW 10m 4500 CULVERT
6. REPLACE HYDRANT ACCESS WITH SUITABLE SITE MATERIAL, CAP WITH TOP SOIL & SEED
7. ADJUST EXISTING WATER VALVE TO GRADE
8. CONSTRUCT NEW BARRIER CURB (180mm HT. REVEAL)
9. REMOVE PLANTERS (BY OTHERS)
10. MILL/RECLAIM EXISTING ASPHALT PATH AND CONSTRUCT NEW 100mm ASPHALT PATH
11. CONSTRUCT SEPARATE CONCRETE SPLASH STRIP (SD-223B) SEE DETAIL DWG 17
12. INSTALL 150mm SUBDRAINS (SD-245)
13. INSTALL NEW CURB AND GUTTER INLET C/W CATCHBASIN (SD-024 - 1800)
14. MILL EXISTING ASPHALT AND REPLACE WITH NEW TYPE 1A ASPHALT

GENERAL NOTES

- A. PAVEMENT DIMENSIONS ARE TO BACK OF CURB
- B. ALL CURB RADII UNDER 15.0m SHALL BE MODIFIED
- C. ADD 200.000m TO ALL DESIGN ELEVATION TO OBTAIN GEODETIC ELEVATIONS
- D. CURB REPLACEMENT AS DIRECTED BY CONTRACT ADMINISTRATOR
- E. CONTRACTOR TO CONFIRM THE LOCATION OF ALL UTILITIES/SERVICES IN THE FIELD PRIOR TO CONSTRUCTION
- F. ADJUST ALL EXISTING WATER VALVES AND CURB STOPS TO GRADE

PRELIMINARY
NOT TO BE USED FOR CONSTRUCTION

METRIC
WHOLE NUMBERS INDICATE MILLIMETERS
DECIMALIZED NUMBERS INDICATE METERS

BID OPPORTUNITY NO. 2-2018

EXISTING	LEGEND - PLAN	PROPOSED	EXISTING	LEGEND - PLAN	PROPOSED
	HYDRANT			LDS/WWS	
	VALVE			WATERMAIN	
	CURB STOP			GAS	
	MANHOLE			TRAFFIC SIGNALS	
	CATCH BASIN			HYDRO/STREET LIGHT	
	CURB INLET			MTS	
	HYDRO POLE			CURB RENEWAL	
	LIGHT STANDARD			PROPERTY LINE	
	TRAFFIC SIGNAL POLE			RAMP CURB	
	SURVEY BAR			ELEVATIONS	
	GEODETIC BENCH MARK			TREELINE	

LOCATION APPROVED UNDERGROUND STRUCTURES		DATE	
CONCRETE		DATE	
CONCRETE SIDEWALK			
ASPHALT			
DITCH FLOW			
DITCH - TOP OF SLOPE			
CULVERT			
LDS FLOW DIRECTION			
EDGE OF PAVEMENT			
LEGEND - PLAN			
PROPOSED			

DESIGNED BY	R.W.	CHECKED BY	A.M.C.
DRAWN BY	M.S.	APPROVED BY	

ENGINEERING DIVISION
TECHNOLOGY SERVICES BRANCH
106 - 1155 PACIFIC AVE

ENGINEER'S SEAL
PROVINCE OF MANITOBA
FIRST LAST
Member #
REGISTERED ENGINEER

THE CITY OF WINNIPEG
PUBLIC WORKS DEPARTMENT

ROBLIN BOULEVARD EASTBOUND
FROM ASSINBOINE PARK DRIVE TO SHAFTESBURY BOULEVARD
CONCRETE RECONSTRUCTION AND ASSOCIATED WORKS

ROBLIN BOULEVARD MULTI-USE PATHWAY
FROM CHALFONT ROAD TO SHAFTESBURY BOULEVARD
REHABILITATION AND ASSOCIATED WORKS

CITY DRAWING NUMBER
P-3490-05
SHEET 5 OF 30

5

NO.	REVISIONS	DATE	BY
2.	ISSUED FOR TENDER	08/03/2018	R.W.
1.	SUBMIT FOR PLAN APPROVAL	13/02/2018	R.W.

HOR. SCALE: 1 : 250
VERTICAL: 1 : 10
DATE: 13/02/2018