

ASSINIBOINE PARK DRIVE

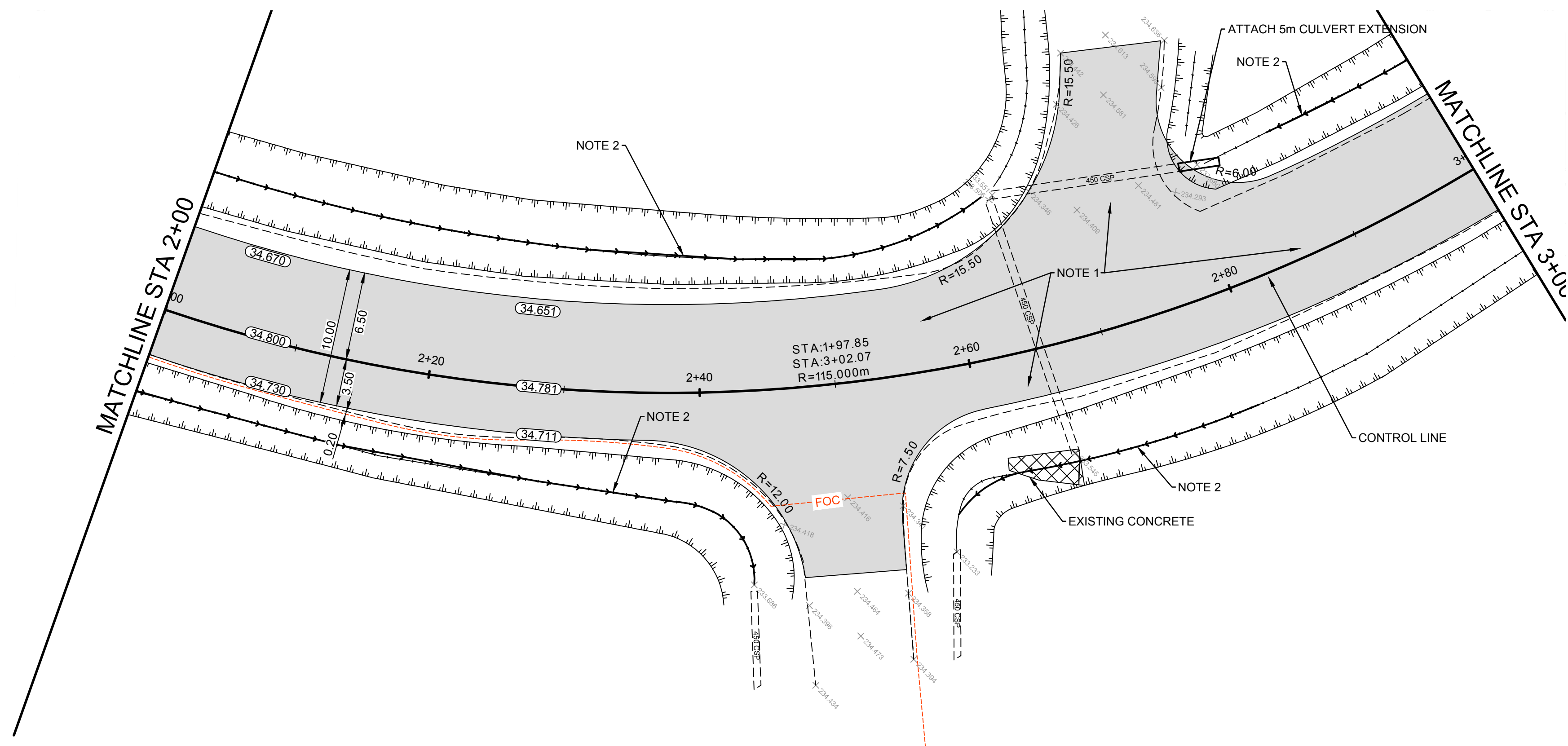
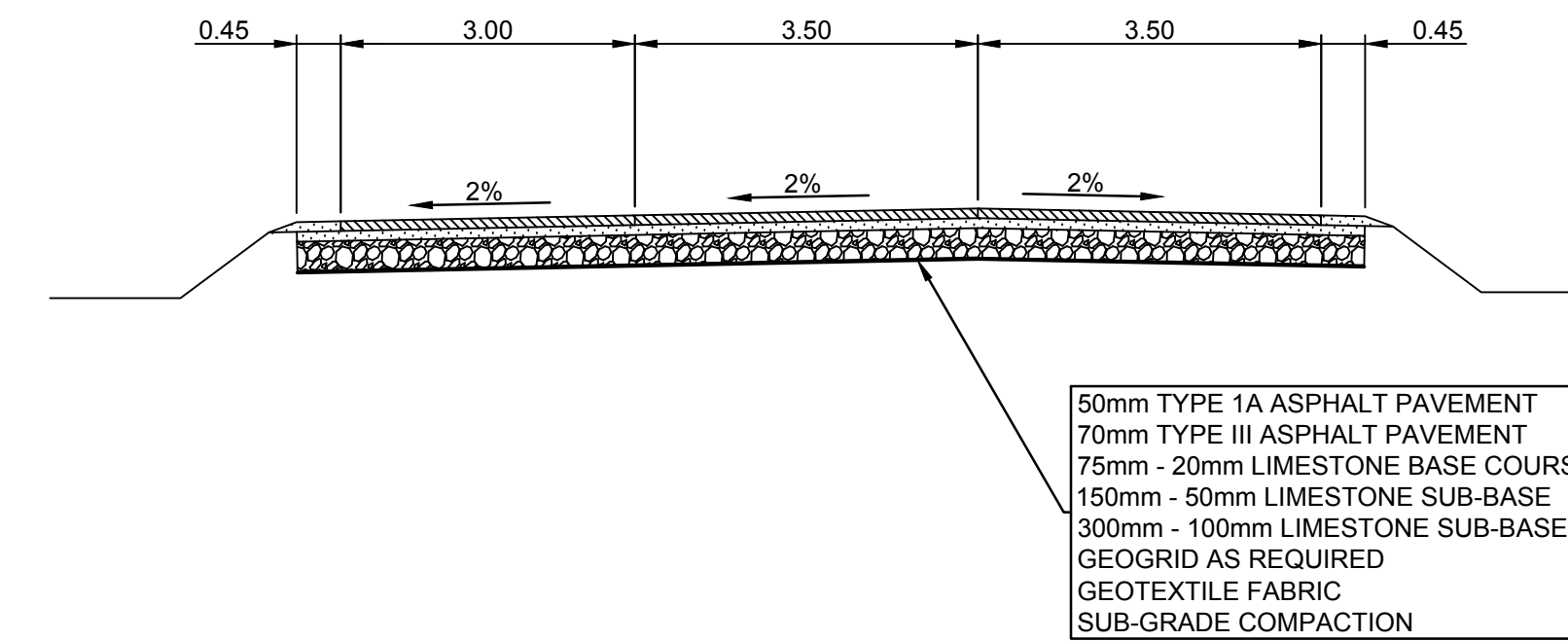

- CONSTRUCTION NOTES**
1. REMOVE EXISTING PAVEMENT AND CONSTRUCT NEW 120mm ASPHALT PAVEMENT
  2. RE-GRADE EXISTING DITCH AS REQUIRED

- GENERAL NOTES**
- A. PAVEMENT DIMENSIONS ARE TO EDGE OF PAVEMENT
  - B. ALL CURB RADII UNDER 15.0m SHALL BE MODIFIED
  - C. ADD 200.000m TO ALL DESIGN ELEVATION TO OBTAIN GEODETIC ELEVATIONS
  - D. CONTRACTOR TO CONFIRM THE LOCATION OF ALL UTILITIES/SERVICES IN THE FIELD PRIOR TO CONSTRUCTION

**PRELIMINARY**  
NOT TO BE USED FOR CONSTRUCTION

METRIC  
WHOLE NUMBERS INDICATE MILLIMETERS  
DECIMALIZED NUMBERS INDICATE METERS  
BID OPPORTUNITY NO. 2-2018

<table border="1"> <tr> <td>⊕</td><td>HYDRANT</td> <td>◆</td><td>---</td><td>LDS/WWS</td> <td>---</td><td>CONCRETE</td> <td>---</td><td>LOCATION APPROVED</td> <td rowspan="2">         SUPR. U/G STRUCTURES COMMITTEE DATE          NOTE:          LOCATION OF UNDERGROUND STRUCTURES AS SHOWN ARE BASED ON THE BEST INFORMATION AVAILABLE. BUT NO GUARANTEE IS GIVEN THAT ALL EXISTING UTILITIES ARE SHOWN OR THAT THE GIVEN LOCATIONS ARE EXACT. CONFIRMATION OF EXISTENCE AND EXACT LOCATION OF ALL SERVICES MUST BE OBTAINED FROM THE INDIVIDUAL UTILITIES BEFORE PROCEEDING WITH CONSTRUCTION.       </td> <td rowspan="2">         B.M. ELEV.           2. ISSUED FOR TENDER 08/03/2018 R.W.          1. SUBMIT FOR PLAN APPROVAL 13/02/2018 R.W.          NO. REVISIONS DATE BY       </td> <td rowspan="2">         ENGINEERING DIVISION          TECHNOLOGY SERVICES BRANCH          106 - 1155 PACIFIC AVE           DESIGNED BY R.W. CHECKED BY A.M.C.          DRAWN BY M.S. APPROVED BY       </td> <td rowspan="2">         ENGINEER'S SEAL  </td> <td rowspan="2"> <b>THE CITY OF WINNIPEG</b>          PUBLIC WORKS DEPARTMENT   <b>ASSINIBOINE PARK DRIVE</b>          FROM ROBLIN BOULEVARD TO COMMISSARY ROAD          ASPHALT RECONSTRUCTION AND ASSOCIATED WORKS          FROM STA. 2+00 TO STA. 3+00       </td> <td rowspan="2">         CITY DRAWING NUMBER          P -3490 - 22          SHEET 22 OF 30   <b>2</b> </td> </tr> <tr> <td>⊙</td><td>VALVE</td> <td>●</td><td>---</td><td>WATERMAIN</td> <td>---</td><td>CONCRETE SIDEWALK</td> <td>---</td><td>UNDERGROUND STRUCTURES</td> </tr> </table>	⊕	HYDRANT	◆	---	LDS/WWS	---	CONCRETE	---	LOCATION APPROVED	SUPR. U/G STRUCTURES COMMITTEE DATE NOTE: LOCATION OF UNDERGROUND STRUCTURES AS SHOWN ARE BASED ON THE BEST INFORMATION AVAILABLE. BUT NO GUARANTEE IS GIVEN THAT ALL EXISTING UTILITIES ARE SHOWN OR THAT THE GIVEN LOCATIONS ARE EXACT. CONFIRMATION OF EXISTENCE AND EXACT LOCATION OF ALL SERVICES MUST BE OBTAINED FROM THE INDIVIDUAL UTILITIES BEFORE PROCEEDING WITH CONSTRUCTION.	B.M. ELEV.  2. ISSUED FOR TENDER 08/03/2018 R.W. 1. SUBMIT FOR PLAN APPROVAL 13/02/2018 R.W. NO. REVISIONS DATE BY	ENGINEERING DIVISION TECHNOLOGY SERVICES BRANCH 106 - 1155 PACIFIC AVE  DESIGNED BY R.W. CHECKED BY A.M.C. DRAWN BY M.S. APPROVED BY	ENGINEER'S SEAL 	<b>THE CITY OF WINNIPEG</b> PUBLIC WORKS DEPARTMENT  <b>ASSINIBOINE PARK DRIVE</b> FROM ROBLIN BOULEVARD TO COMMISSARY ROAD ASPHALT RECONSTRUCTION AND ASSOCIATED WORKS FROM STA. 2+00 TO STA. 3+00	CITY DRAWING NUMBER P -3490 - 22 SHEET 22 OF 30  <b>2</b>	⊙	VALVE	●	---	WATERMAIN	---	CONCRETE SIDEWALK	---	UNDERGROUND STRUCTURES	<table border="1"> <tr> <td>⊙</td><td>CURB STOP</td> <td>●</td><td>---</td><td>GAS</td> <td>---</td><td>ASPHALT</td> <td>---</td><td>DATE</td> </tr> <tr> <td>⊙</td><td>MANHOLE</td> <td>●</td><td>---</td><td>TRAFFIC SIGNALS</td> <td>---</td><td>DITCH FLOW</td> <td>---</td><td></td> </tr> <tr> <td>⊙</td><td>CATCH BASIN</td> <td>●</td><td>---</td><td>HYDRO/STREET LIGHT</td> <td>---</td><td>DITCH - TOP OF SLOPE</td> <td>---</td><td></td> </tr> <tr> <td>⊙</td><td>CURB INLET</td> <td>●</td><td>---</td><td>MTS</td> <td>---</td><td>CULVERT</td> <td>---</td><td></td> </tr> <tr> <td>⊙</td><td>HYDRO POLE</td> <td>●</td><td>---</td><td>EDGE OF PAVEMENT</td> <td>---</td><td>EXISTING</td> <td>---</td><td></td> </tr> <tr> <td>⊙</td><td>LIGHT STANDARD</td> <td>●</td><td>---</td><td>PROPERTY LINE</td> <td>---</td><td>LEGEND - PLAN</td> <td>---</td><td></td> </tr> <tr> <td>⊙</td><td>TRAFFIC SIGNAL POLE</td> <td>●</td><td>---</td><td>RAMP CURB</td> <td>---</td><td>PROPOSED</td> <td>---</td><td></td> </tr> <tr> <td>⊙</td><td>SURVEY BAR</td> <td>●</td><td>---</td><td>ELEVATIONS</td> <td>---</td><td></td> <td>---</td><td></td> </tr> <tr> <td>⊙</td><td>GEODETIC BENCH MARK</td> <td>●</td><td>---</td><td>TREE</td> <td>---</td><td></td> <td>---</td><td></td> </tr> <tr> <td>⊙</td><td>EXISTING</td> <td>---</td><td>---</td><td>LEGEND - PLAN</td> <td>---</td><td>PROPOSED</td> <td>---</td><td></td> </tr> </table>	⊙	CURB STOP	●	---	GAS	---	ASPHALT	---	DATE	⊙	MANHOLE	●	---	TRAFFIC SIGNALS	---	DITCH FLOW	---		⊙	CATCH BASIN	●	---	HYDRO/STREET LIGHT	---	DITCH - TOP OF SLOPE	---		⊙	CURB INLET	●	---	MTS	---	CULVERT	---		⊙	HYDRO POLE	●	---	EDGE OF PAVEMENT	---	EXISTING	---		⊙	LIGHT STANDARD	●	---	PROPERTY LINE	---	LEGEND - PLAN	---		⊙	TRAFFIC SIGNAL POLE	●	---	RAMP CURB	---	PROPOSED	---		⊙	SURVEY BAR	●	---	ELEVATIONS	---		---		⊙	GEODETIC BENCH MARK	●	---	TREE	---		---		⊙	EXISTING	---	---	LEGEND - PLAN	---	PROPOSED	---	
⊕	HYDRANT	◆	---	LDS/WWS	---	CONCRETE	---	LOCATION APPROVED	SUPR. U/G STRUCTURES COMMITTEE DATE NOTE: LOCATION OF UNDERGROUND STRUCTURES AS SHOWN ARE BASED ON THE BEST INFORMATION AVAILABLE. BUT NO GUARANTEE IS GIVEN THAT ALL EXISTING UTILITIES ARE SHOWN OR THAT THE GIVEN LOCATIONS ARE EXACT. CONFIRMATION OF EXISTENCE AND EXACT LOCATION OF ALL SERVICES MUST BE OBTAINED FROM THE INDIVIDUAL UTILITIES BEFORE PROCEEDING WITH CONSTRUCTION.							B.M. ELEV.  2. ISSUED FOR TENDER 08/03/2018 R.W. 1. SUBMIT FOR PLAN APPROVAL 13/02/2018 R.W. NO. REVISIONS DATE BY	ENGINEERING DIVISION TECHNOLOGY SERVICES BRANCH 106 - 1155 PACIFIC AVE  DESIGNED BY R.W. CHECKED BY A.M.C. DRAWN BY M.S. APPROVED BY	ENGINEER'S SEAL 	<b>THE CITY OF WINNIPEG</b> PUBLIC WORKS DEPARTMENT  <b>ASSINIBOINE PARK DRIVE</b> FROM ROBLIN BOULEVARD TO COMMISSARY ROAD ASPHALT RECONSTRUCTION AND ASSOCIATED WORKS FROM STA. 2+00 TO STA. 3+00	CITY DRAWING NUMBER P -3490 - 22 SHEET 22 OF 30  <b>2</b>																																																																																															
⊙	VALVE	●	---	WATERMAIN	---	CONCRETE SIDEWALK	---	UNDERGROUND STRUCTURES																																																																																																											
⊙	CURB STOP	●	---	GAS	---	ASPHALT	---	DATE																																																																																																											
⊙	MANHOLE	●	---	TRAFFIC SIGNALS	---	DITCH FLOW	---																																																																																																												
⊙	CATCH BASIN	●	---	HYDRO/STREET LIGHT	---	DITCH - TOP OF SLOPE	---																																																																																																												
⊙	CURB INLET	●	---	MTS	---	CULVERT	---																																																																																																												
⊙	HYDRO POLE	●	---	EDGE OF PAVEMENT	---	EXISTING	---																																																																																																												
⊙	LIGHT STANDARD	●	---	PROPERTY LINE	---	LEGEND - PLAN	---																																																																																																												
⊙	TRAFFIC SIGNAL POLE	●	---	RAMP CURB	---	PROPOSED	---																																																																																																												
⊙	SURVEY BAR	●	---	ELEVATIONS	---		---																																																																																																												
⊙	GEODETIC BENCH MARK	●	---	TREE	---		---																																																																																																												
⊙	EXISTING	---	---	LEGEND - PLAN	---	PROPOSED	---																																																																																																												