

- GENERAL NOTES**
1. ALL PIPING ASSOCIATED WITH THE POOL RECIRCULATION PUMPS TO REMAIN.
 2. PROVIDE THE SPECIFIED RECIRCULATION PUMPS P-1 AND P-2 AND COORDINATE WITH ELECTRICAL.
 3. MOUNT NEW RECIRCULATION PUMPS P-1 AND P-2 ON EXISTING CONCRETE PAD, AND CONNECT PUMPS TO EXISTING SUCTION AND DISCHARGE PIPING.

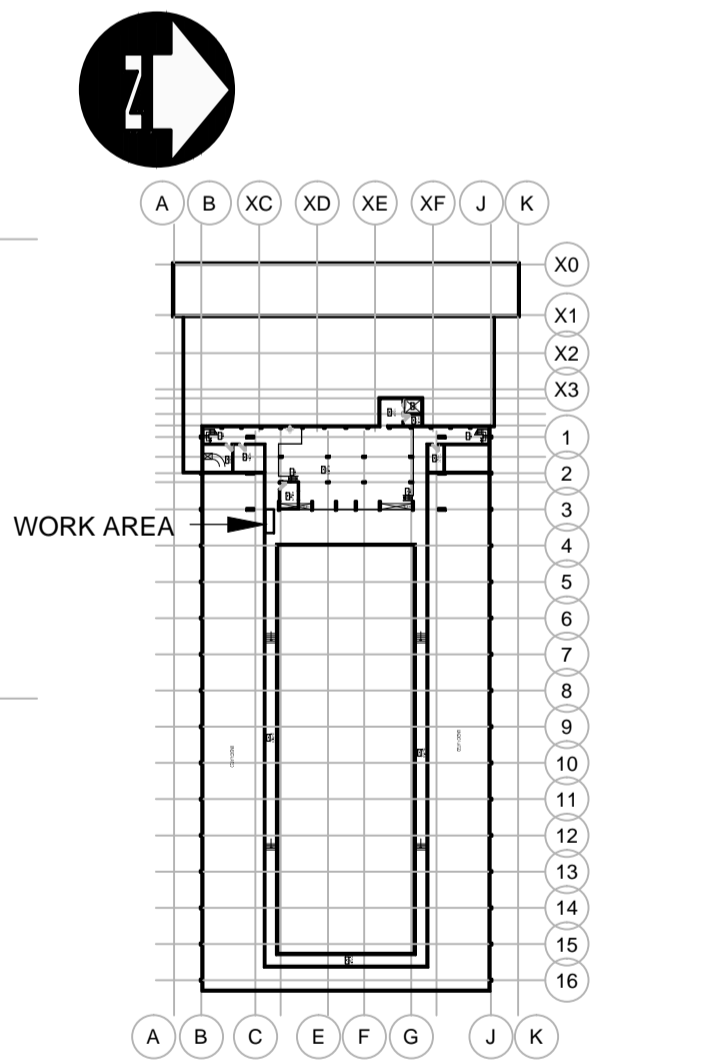

PARTIAL BASEMENT FLOOR PLAN

1:100



NO.	REVISIONS	DATE	BY	DATE
B	ISSUED FOR BID OP 247-2018	18/04/16	EP	
A	ISSUED FOR 50% CLIENT REVIEW	18/03/16	EP	

DESIGNED BY EP	CHECKED BY PDT
DRAWN BY TKD	APPROVED BY
HOR. SCALE VERTICAL	RELEASED FOR CONSTRUCTION
DATE	DATE

ENGINEER'S SEAL
PROVINCE OF MANITOBA
E. PLANIM
Member
30607
REGISTERED PROFESSIONAL ENGINEER
CONSULTANT PROJECT NUMBER
18-7165

THE CITY OF WINNIPEG
PUBLIC WORKS DEPARTMENT

PAN AM POOL PUMP REPLACEMENT

MECHANICAL BASEMENT LEVEL BOILER ROOM

CITY DRAWING NUMBER
247-2018_DRAWING_M-101-RO.PDF
SHEET 2 OF 5
CONSULTANT DRAWING NUMBER
M-101