

NOTE: CHAINAGES SHOWN ARE ALONG ϕ OF TACHE AVENUE

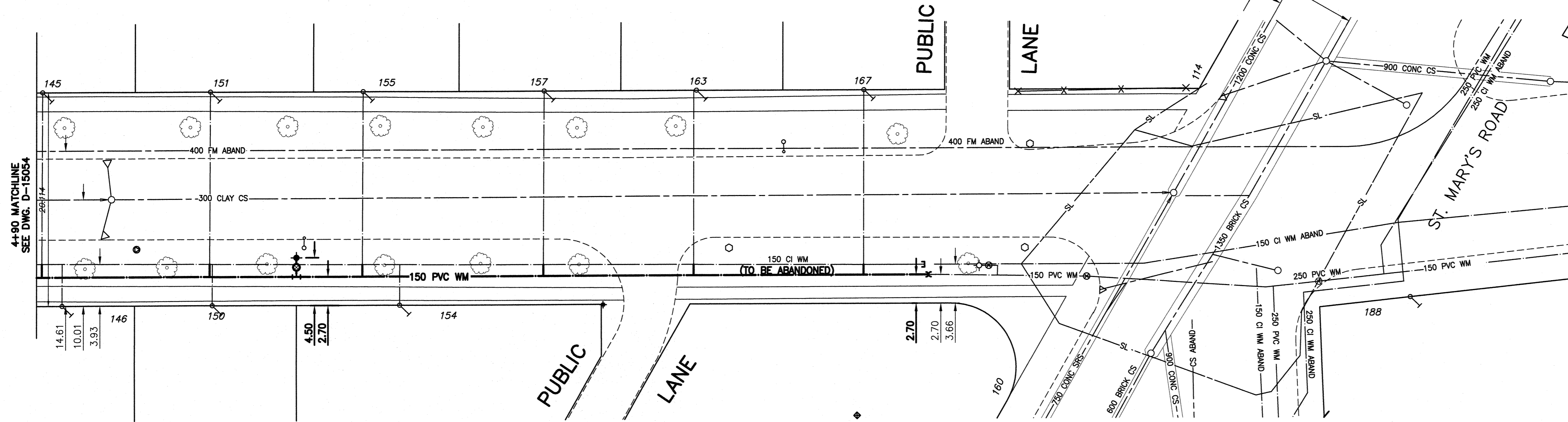

TACHE AVENUE



WATER SERVICE INFORMATION					
ADDRESS	PIPE SIZE & MATERIAL (STREET)	PIPE SIZE & MATERIAL (PROP.)	SHORT & LONG MEASUREMENT	CORP. LOCATION	REMARKS
145 TACHE AVE	-	12	1.22 L R COR HSE	-	RECONNECT SERVICE
RESIDENTIAL	-	COPPER	128.35 FROM HYD	-	RECONNECT SERVICE
146 TACHE AVE	-	20	5.34 R L COR HSE	-	RECONNECT SERVICE
RESIDENTIAL	-	COPPER	122.87 FROM HYD	-	RECONNECT SERVICE
150 TACHE AVE	-	20	5.18 L R COR HSE	-	RECONNECT SERVICE
RESIDENTIAL	-	COPPER	137.8 FROM HYD	-	RECONNECT SERVICE
151 TACHE AVE	-	20	1.52 R L COR HSE	-	RECONNECT SERVICE
RESIDENTIAL	-	COPPER	1.52 R L COR HSE	-	RECONNECT SERVICE
154 TACHE AVE	-	20	6.1 RLHL	-	RECONNECT SERVICE
RESIDENTIAL	-	COPPER	60.98 FROM HYD	-	RECONNECT SERVICE
155 TACHE AVE	-	20	2.13 R L COR HSE	-	RECONNECT SERVICE
RESIDENTIAL	-	COPPER	158.54 FROM HYD	-	RECONNECT SERVICE
157 TACHE AVE	-	20	5.18 R L COR HSE	-	RECONNECT SERVICE
RESIDENTIAL	-	COPPER	50.61 FROM HYD	-	RECONNECT SERVICE
163 TACHE AVE	20	12	0.91 NSHL	OPP S/C	RECONNECT SERVICE
RESIDENTIAL	COPPER	COPPER	38.89 FROM HYD	-	RECONNECT SERVICE
167 TACHE AVE	-	20	5.43 R L COR HSE	-	RECONNECT SERVICE
RESIDENTIAL	-	COPPER	24.85 FROM HYD	-	RECONNECT SERVICE

NOTE: VALVES TO BE INSTALLED CLOCKWISE TO CLOSE

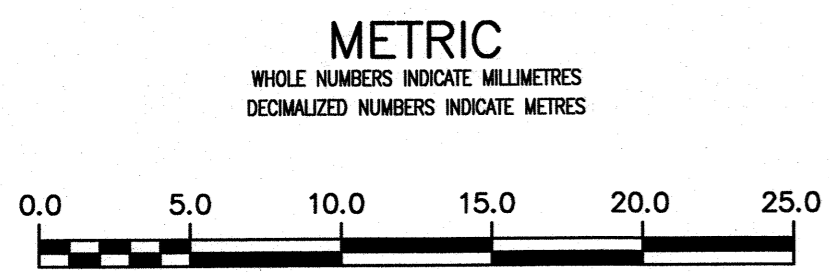

ENGINEERS GEOSCIENTISTS MANITOBA
 Certificate of Authorization
 Stantec Consulting Ltd.
 No. 1301

LOCATION APPROVED UNDERGROUND STRUCTURES
 SUPV. U/G STRUCTURES COMMITTEE DATE
 NOTE: LOCATION OF UNDERGROUND STRUCTURES AS SHOWN ARE BASED ON THE BEST INFORMATION AVAILABLE BUT NO GUARANTEE IS GIVEN THAT ALL EXISTING UTILITIES ARE SHOWN OR THAT THE GIVEN LOCATIONS ARE EXACT. CONFIRMATION OF EXISTENCE AND EXACT LOCATION OF ALL SERVICES MUST BE OBTAINED FROM THE INDIVIDUAL UTILITIES BEFORE PROCEEDING WITH CONSTRUCTION.

R.M. 34-4 372 (654372) - Tbl. in 7.6 m Conc. pile, 2.1 m N. ELEV. 229.873m of line of N. wall of No. 146 Tache Ave, S. of St.	
DESIGNED BY	RS
CHECKED BY	WB
DRAWN BY	SG
APPROVED BY	RS
SCALE:	
HORIZONTAL	1:250
VERTICAL	1:50
DATE	2018 02 26
NO.	01
ISSUED FOR TENDER	2018.04.06
REVISIONS	DATE BY

Stantec

DESIGNED BY: RS
 CHECKED BY: WB
 DRAWN BY: SG
 APPROVED BY: RS
 SCALE: HORIZONTAL 1:250, VERTICAL 1:50
 DATE: 2018 02 26
 PLOT DATE: 2018 04 06

ENGINEER'S SEAL
 PROVINCE OF MANITOBA
 APRIL 16 2018
 R.M. SHERLOCK
 REGISTERED PROFESSIONAL ENGINEER
 CONSULTANT DRAWING NUMBER: C-206

THE CITY OF WINNIPEG
 WATER AND WASTE DEPARTMENT
 ENGINEERING DIVISION

2018 WATERMAIN RENEWALS
 CONTRACT 7
 TACHE AVENUE
 117.5 NSL HIGHFIELD STREET TO
 ST. MARY'S ROAD

SHEET 8 OF 17
 CITY DRAWING NUMBER: D-15055