

NOTE: CHAINAGES SHOWN ARE ALONG ϕ OF BERESFORD AVENUE

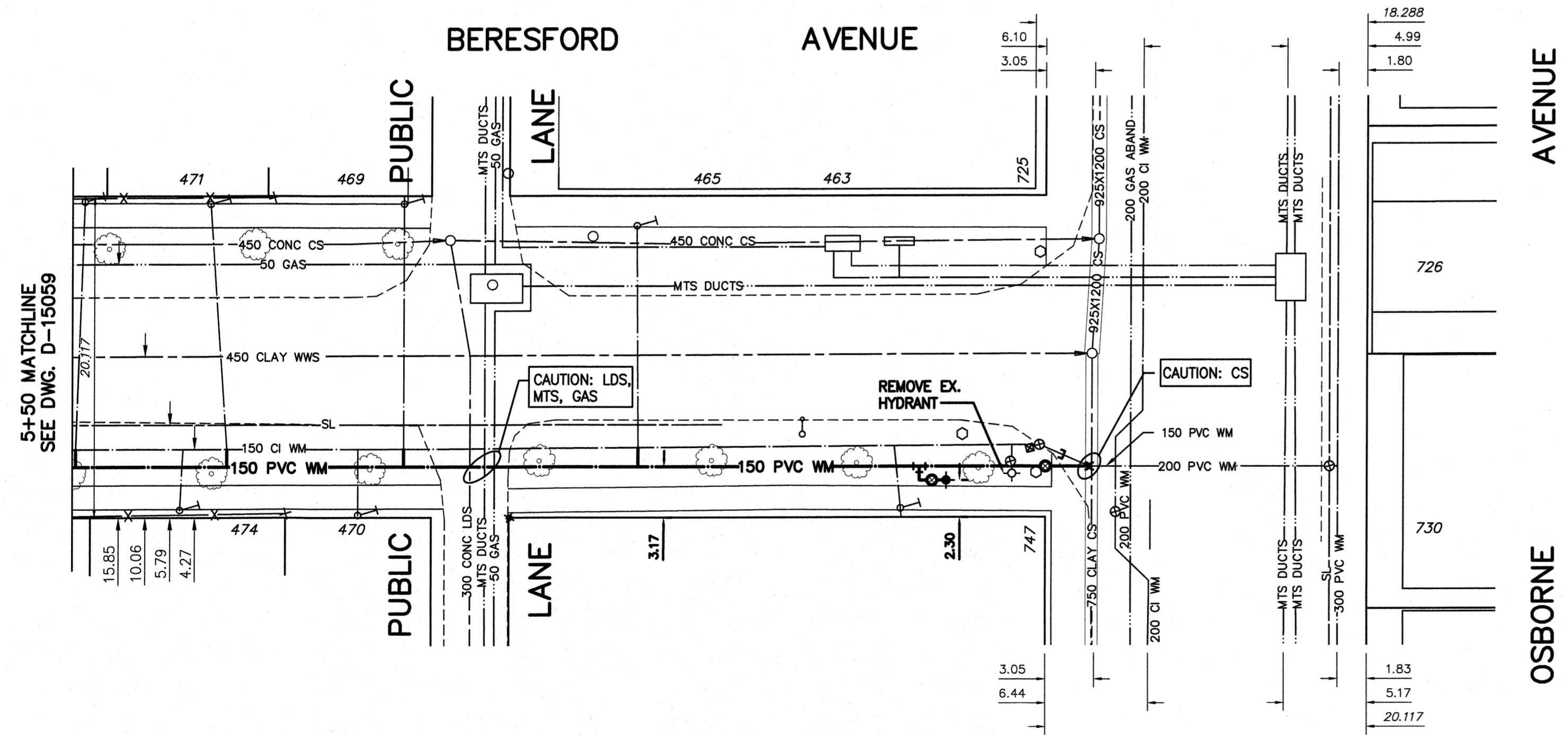

WATER SERVICE INFORMATION

ADDRESS	PIPE SIZE & MATERIAL (STREET)	PIPE SIZE & MATERIAL (PROP.)	SHORT & LONG MEASUREMENT	CORP. LOCATION	REMARKS
465 BERESFORD AVE	-	-	-	-	RECONNECT SERVICE
469 BERESFORD AVE	25	25	5.49 E/WBL	OPP S/C	RECONNECT SERVICE
470 BERESFORD AVE	20	20	1.52 WEL HSE	0.3 W OF S/C	RECONNECT SERVICE
471 BERESFORD AVE	20	12	2.29 WEL HSE	1.07 E S/C	RECONNECT SERVICE
474 BERESFORD AVE	20	20	6.4 W E LL	-	RECONNECT SERVICE
747 OSBORNE ST	20	20	SAME AS LONG MEASUREMENT	0.3 W S/C	RECONNECT SERVICE
COMMERCIAL	COPPER	COPPER	8.99 WML OSBORNE	-	-

* SERVICES TO BE RENEWED TO ϕ

NOTE: VALVES TO BE INSTALLED COUNTERCLOCKWISE TO CLOSE

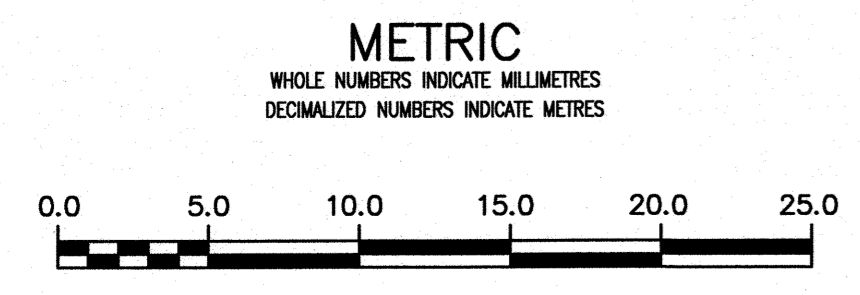

ENGINEERS GEOSCIENTISTS MANITOBA
 Certificate of Authorization
 Stantec Consulting Ltd.
 No. 1301

LOCATION APPROVED UNDERGROUND STRUCTURES

B.M. 53-21 N.E. Cor. Beresford Ave. & Nassau St. S., Tbt. In S. Conc. foundation of No. 525 Beresford Ave., 1.2 m E. & 0.2 m below ELEV. 232.577m brick from the most S. Wy. Cor. of Bldg. (Rosedale United Church).

NO.	ISSUED FOR TENDER	DATE	BY
01	ISSUED FOR TENDER	2018.04.08	RS
	REVISIONS	DATE	BY

NOTE: LOCATION OF UNDERGROUND STRUCTURES AS SHOWN ARE BASED ON THE BEST INFORMATION AVAILABLE BUT NO GUARANTEE IS GIVEN THAT ALL EXISTING UTILITIES ARE SHOWN OR THAT THE GIVEN LOCATIONS ARE EXACT. CONFIRMATION OF EXISTENCE AND EXACT LOCATION OF ALL SERVICES MUST BE OBTAINED FROM THE INDIVIDUAL UTILITIES BEFORE PROCEEDING WITH CONSTRUCTION.

Stantec

DESIGNED BY: RS
 CHECKED BY: WB
 DRAWN BY: SG
 APPROVED BY: RS

SCALE: HORIZONTAL 1:250
 VERTICAL 1:50

DATE: 2018 02 26
 PLOT DATE: 2018 04 06

ENGINEER'S SEAL

PROVINCE OF MANITOBA
 APRIL 6/18
 SHELDON LOCK
 REGISTERED PROFESSIONAL ENGINEER
 MEMBER 24045

CONSULTANT DRAWING NUMBER: C-211

THE CITY OF WINNIPEG
 WATER AND WASTE DEPARTMENT
 ENGINEERING DIVISION

2018 WATERMAIN RENEWALS
 CONTRACT 7
 BERESFORD AVENUE
 216.44 EEL NASSAU STREET TO
 OSBORNE AVENUE

SHEET 13 OF 17
 CITY DRAWING NUMBER: D-15060