

NOTE: CHAINAGES SHOWN ARE ALONG ϕ OF SUNSET BOULEVARD

SUNSET BOULEVARD

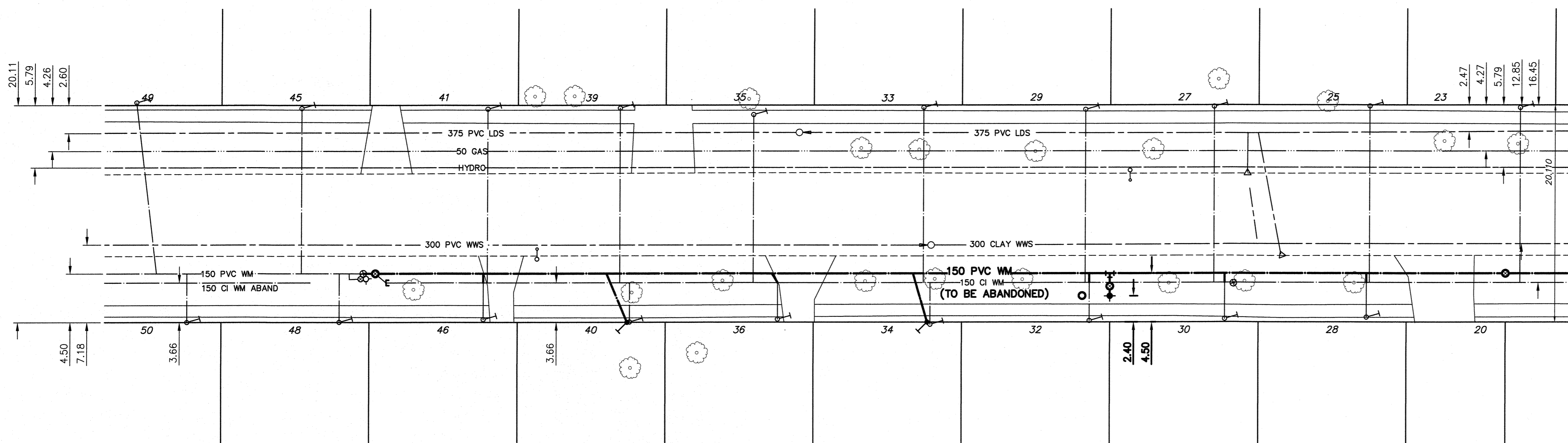

WATER SERVICE INFORMATION

ADDRESS	PIPE SIZE & MATERIAL (STREET)	PIPE SIZE & MATERIAL (PROP.)	SHORT & LONG MEASUREMENT	CORP. LOCATION	REMARKS
20 SUNSET BLVD	-	12	2.1 WELL	0.50 E CS	RECONNECT SERVICE
RESIDENTIAL	-	LEAD	-	-	-
23 SUNSET BLVD	-	20	2.44 WEHL	-	RECONNECT SERVICE
RESIDENTIAL	-	COPPER	-	-	-
25 SUNSET BLVD	20	12	1.22 WEHL	-	RECONNECT SERVICE
RESIDENTIAL	COPPER	LEAD	-	-	-
27 SUNSET BLVD	20	12	2.13 WEHL 1 IN LAWN	-	RECONNECT SERVICE
RESIDENTIAL	COPPER	LEAD	-	-	-
28 SUNSET BLVD	-	-	2.6 WEHL	.61 W OF STOP	RECONNECT SERVICE
RESIDENTIAL	-	-	-	-	-
29 SUNSET BLVD	-	20	EHL	-	RECONNECT SERVICE
RESIDENTIAL	-	COPPER	-	-	-
30 SUNSET BLVD	-	20	1.9 W/EHL	-	RECONNECT SERVICE
RESIDENTIAL	-	COPPER	-	-	-
32 SUNSET BLVD	-	20	EHL	-	RECONNECT SERVICE
RESIDENTIAL	-	COPPER	-	-	-
33 SUNSET BLVD	-	12	2.44 WEHL	-	RECONNECT SERVICE
RESIDENTIAL	-	COPPER	-	-	-
34 SUNSET BLVD	-	12	0.3 LL CR OF HSE	-	RENEW TO PL W/ 20 CU
RESIDENTIAL	-	LEAD	59.15 E OF HYD	-	-
35 SUNSET BLVD	-	12	5.6 WELL	-	RECONNECT SERVICE
RESIDENTIAL	-	COPPER	-	-	-
36 SUNSET BLVD	-	12	1.22 W/EHL	0.30 E/WHL	RECONNECT SERVICE
RESIDENTIAL	-	COPPER	-	-	-
39 SUNSET BLVD	-	12	0.61 W/EHL	-	RECONNECT SERVICE
RESIDENTIAL	-	COPPER	-	-	-
40 SUNSET BLVD	-	12	2.19 W/EHL	-	RENEW TO PL W/ 20 CU
RESIDENTIAL	-	LEAD	4.45 W/EPL	-	-
41 SUNSET BLVD	-	20	1.37 WEHL	-	RECONNECT SERVICE
RESIDENTIAL	-	COPPER	-	-	-
45 SUNSET BLVD	-	12	5.18 WEHL 1 IN LAWN	-	OUTSIDE LIMITS
RESIDENTIAL	-	COPPER	-	-	-
48 SUNSET BLVD	-	20	2.74 E/EHL	-	RECONNECT SERVICE
RESIDENTIAL	-	COPPER	-	-	-
48 SUNSET BLVD	-	12	2 W/E LL	-	OUTSIDE LIMITS
RESIDENTIAL	-	COPPER	-	-	-
49 SUNSET BLVD	-	20	4.8 E/WBL	-	OUTSIDE LIMITS
RESIDENTIAL	-	COPPER	5.9 E/WPL	-	-
50 SUNSET BLVD	-	20	0.46 WEHL	-	OUTSIDE LIMITS
RESIDENTIAL	-	COPPER	-	-	-

* SERVICES TO BE RENEWED TO ϕ

NOTE: ALL VALVES TO BE INSTALLED COUNTERCLOCKWISE TO CLOSE

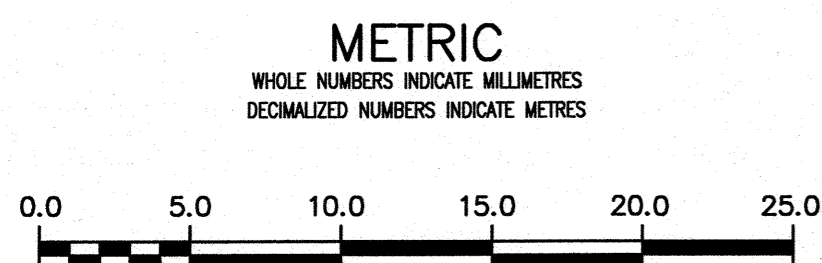

ENGINEERS GEOSCIENTISTS MANITOBA
 Certificate of Authorization
 Stantec Consulting Ltd.
 No. 1301

LOCATION APPROVED UNDERGROUND STRUCTURES		B.M. 54-11 378 (654378) - S.W. Cor. St. Mary's Rd. & Glenview Ave., Tblt. in 7.6 m Conc. pile, 6 m N. of S.L. of Glenview Ave. & 0.6 m W. of W.L. of St. Mary's Rd.	
SUPV. U/G STRUCTURES COMMITTEE	DATE	DESIGNED BY	CHECKED BY
		RS	WB
NOTE:		DRAWN BY	APPROVED BY
LOCATION OF UNDERGROUND STRUCTURES AS SHOWN ARE BASED ON THE BEST INFORMATION AVAILABLE BUT NO GUARANTEE IS GIVEN THAT ALL EXISTING UTILITIES ARE SHOWN OR THAT THE GIVEN LOCATIONS ARE EXACT. CONFIRMATION OF EXISTENCE AND EXACT LOCATION OF ALL SERVICES MUST BE OBTAINED FROM THE INDIVIDUAL UTILITIES BEFORE PROCEEDING WITH CONSTRUCTION.		SG	RS
		SCALE:	RELEASED FOR CONSTRUCTION
		HORIZONTAL 1:250	
		VERTICAL 1:50	
01	ISSUED FOR TENDER	2018.04.06	RS
NO.	REVISIONS	DATE	BY
		DATE 2018 02 26	

Stantec

DESIGNED BY: RS
 CHECKED BY: WB
 DRAWN BY: SG
 APPROVED BY: RS

SCALE:
 HORIZONTAL 1:250
 VERTICAL 1:50

DATE: 2018 02 26

PLOT DATE: 2018 04 06

ENGINEER'S SEAL

PROVINCE OF MANITOBA
 APRIL 16 2018
 R.M. SHERLOCK
 MEMBER 24045
 REGISTERED PROFESSIONAL ENGINEER

CONSULTANT DRAWING NUMBER
 C-212

THE CITY OF WINNIPEG
 WATER AND WASTE DEPARTMENT
 ENGINEERING DIVISION

2018 WATERMAIN RENEWALS
 CONTRACT 7
SUNSET BOULEVARD
 194 W.L. ST. MARY'S ROAD TO
 83.27 W.L. ST. MARY'S ROAD

SHEET 14 OF 17
 CITY DRAWING NUMBER
 D-15061