

NOTES:

1. ALL WORK AND MATERIALS TO BE IN ACCORDANCE WITH THE LATEST REVISION OF THE CITY OF WINNIPEG STANDARD CONSTRUCTION SPECIFICATION. THE CONTRACTOR IS TO CONFIRM THE LOCATION OF ALL UTILITIES/SERVICES IN THE FIELD PRIOR TO CONSTRUCTION.
2. ISOLATE EXISTING HYDRO POLES AND ANCHORS AS PER SD-228C, AS DIRECTED BY CONTRACT ADMINISTRATOR.
3. ALL EXISTING APPROACHES TO BE RENEWED AS DIRECTED BY CONTRACT ADMINISTRATOR.
4. ADDITIONAL EXCAVATION AND INSTALLATION OF SUBGRADE GEOGRID TO BE DETERMINED BY CONTRACT ADMINISTRATOR.
5. ADJUSTMENTS TO PROPOSED CROSSFALL, WHERE REQUIRED, ARE TO BE DETERMINED BY CONTRACT ADMINISTRATOR TO SUIT EXISTING DRIVEWAYS, APPROACHES, ETC..
6. ALL LAND DRAINAGE SEWER EXCAVATIONS TO BE JETTED, FLOODED AND TAMPED AS PER CW2030-R7
7. TREE/BUSH REMOVALS AS DIRECTED BY CONTRACT ADMINISTRATOR.
8. ALL BOULEVARD RESTORATIONS TO BE SODDED UNLESS OTHERWISE NOTED.
9. RENEW CURB AND SIDEWALK AS DIRECTED BY THE CONTRACT ADMINISTRATOR.

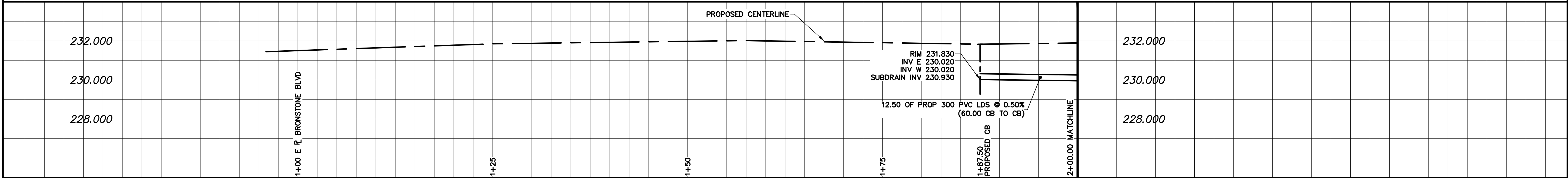

NOTE: CHAINAGES SHOWN ARE ALONG
CL OF RIGHT-OF-WAY

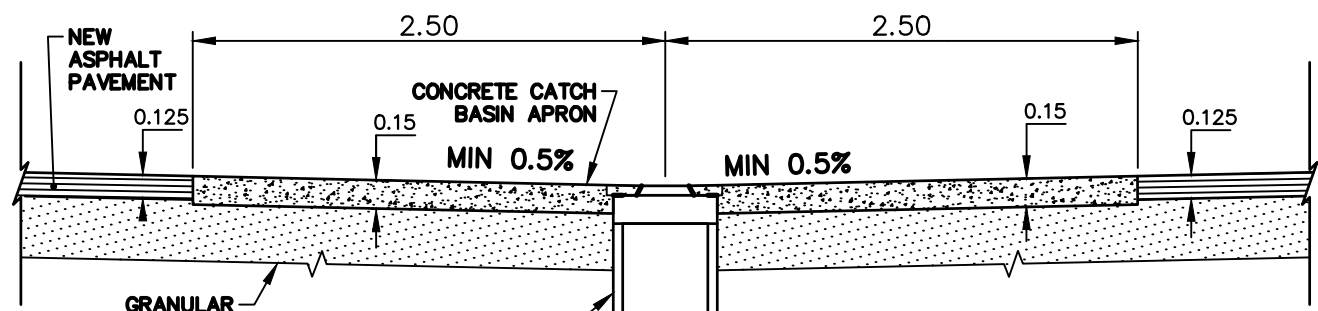

TYPICAL CATCHBASIN APRON DETAIL
SCALE: N.T.S.

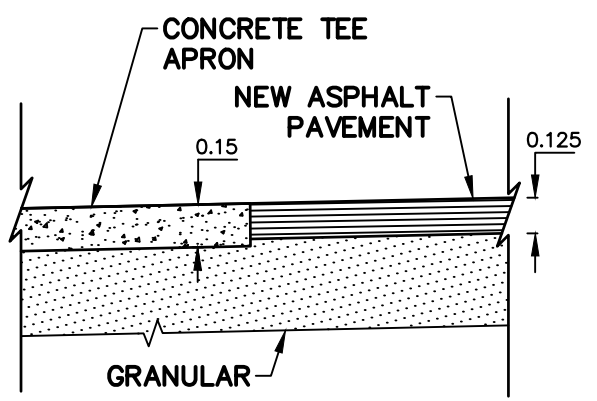

TYPICAL TEE APRON TIE-IN DETAIL
SCALE: N.T.S.

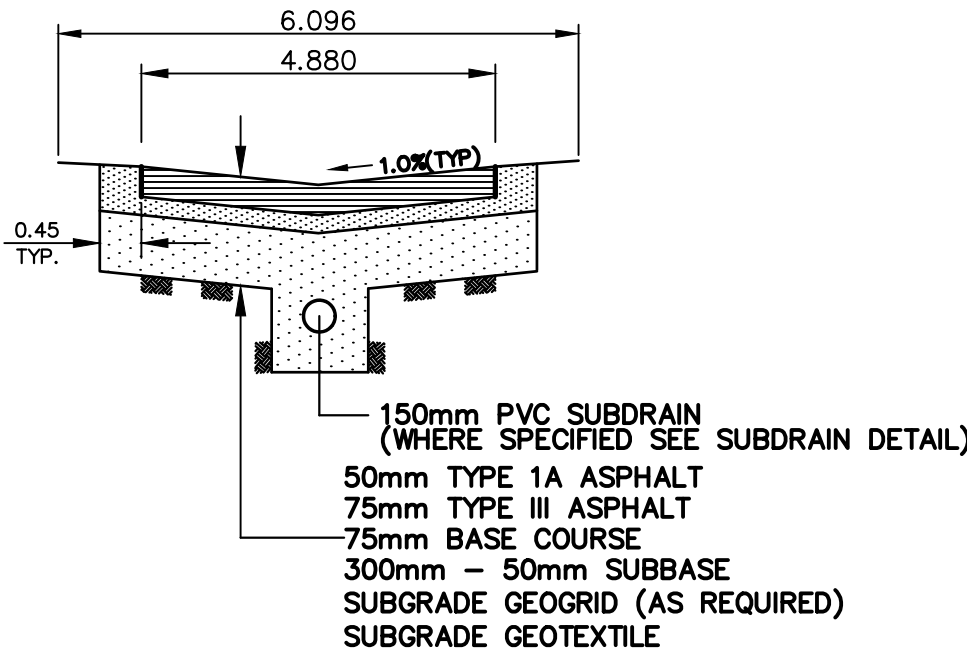

TYPICAL ALLEY CROSS SECTION WITH SUBDRAIN
SCALE: N.T.S.

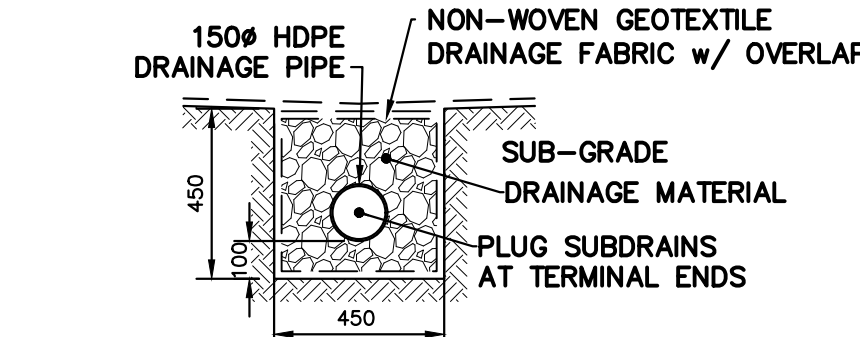

REFERENCE SPECIFICATIONS
1. SUB-GRADE, SUB-BASE AND BASE MATERIAL SHALL BE SUPPLIED AND PLACED IN ACCORDANCE WITH CW-3110.
2. INSTALLATION OF SUBDRAINS SHALL BE IN ACCORDANCE WITH CW-3120.
3. DRAINAGE GEOTEXTILE FABRIC AND DRAINAGE PIPE SHALL CONFORM TO "APPROVED PRODUCTS FOR SURFACE WORKS"

TYPICAL SUBDRAIN DETAIL
SCALE: N.T.S.

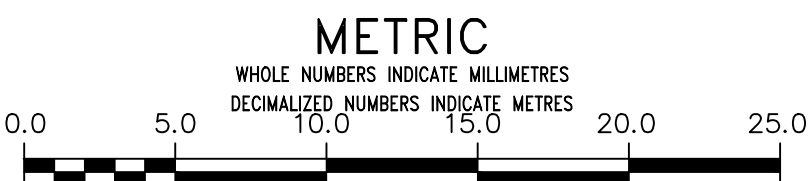
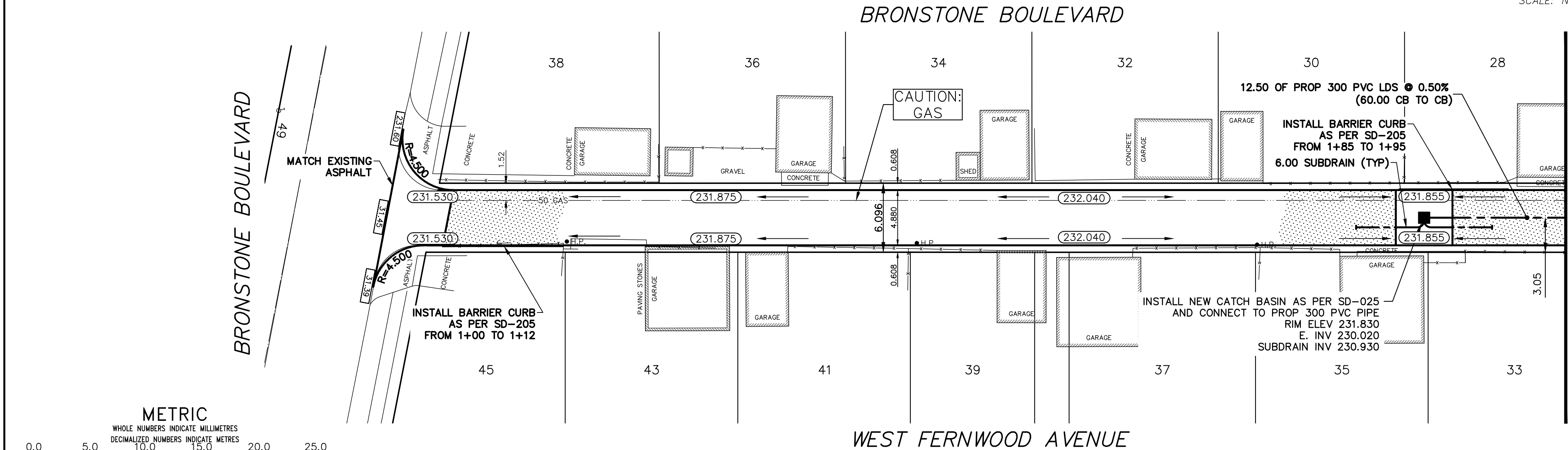

WATERMAIN		HYDRANT		GAS		M.T.S.		TRAFFIC SIGNALS		CONCRETE/ASPHALT		SIDEWALK		CURB RAMP		ELEVATIONS		PROPERTY LINE		SURVEY BAR	
LAND DRAINAGE SEWER		WASTE WATER SEWER		CB LEAD		MANHOLE		CATCH BASIN		CURB INLET		HYDRO		EXISTING		LEGEND -- PLAN		PROPOSED		EXISTING	
LEGEND -- PLAN		PROPOSED		EXISTING		LEGEND -- PLAN		PROPOSED		EXISTING		LEGEND -- PROFILE		PROPOSED		EXISTING		LEGEND -- PROFILE		PROPOSED	

LOCATION APPROVED UNDERGROUND STRUCTURES		SUPV. U/G STRUCTURES COMMITTEE		DATE	
NOTE:		LOCATION OF UNDERGROUND STRUCTURES AS SHOWN ARE BASED ON THE BEST INFORMATION AVAILABLE BUT NO GUARANTEE IS GIVEN THAT ALL EXISTING UTILITIES ARE SHOWN OR THAT THE GIVEN LOCATIONS ARE EXACT. CONFIRMATION OF EXISTENCE AND EXACT LOCATION OF ALL SERVICES MUST BE OBTAINED FROM THE INDIVIDUAL UTILITIES BEFORE PROCEEDING WITH CONSTRUCTION.			
18/03/13		R.H.		A.B.	
18/03/08		A.B.		R.H.	
18/02/14		A.B.		R.H.	
18/01/15		A.B.		R.H.	
NO		REVISIONS		DATE	
JANUARY 2018		---		---	

DESIGNED BY		A.B.		CHECKED BY		R.H.	
DRAWN BY		R.H.		APPROVED BY		S.M.	
HOR. SCALE:		1:250		RELEASED FOR CONSTRUCTION		---	
VERT. SCALE:		AS SHOWN		---		---	
CONSULTANT DRAWING NO.		17M-02285-00		-01			

THE CITY OF WINNIPEG		PUBLIC WORKS DEPARTMENT	
2018 LOCAL IMPROVEMENTS		BRONSTONE BLVD/WEST FERNWOOD AVE LANE	
FROM BRONSTONE BLVD TO		MATCHLINE AT 2+00	
ASPHALT PAVEMENT		30-2018	

PLOT DATE: March 15, 2018

BID OPPORTUNITY: 30-2018
CONTRACT NUMBER: ----

FILE PATH: P:\2017\17M-02285-00 - Local Improvements Package 18-U-01\08 WSP Drawings
FILE NAME: Bronstone_West Fernwood Lane.dwg