

LANE PAVEMENT PROFILE

SCALE: 1:250 HOR
1:10 VER

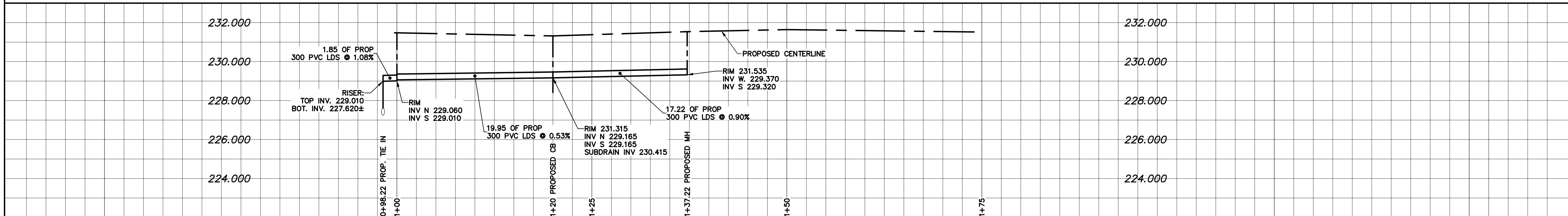

LAND DRAINAGE SEWER PROFILE

SCALE: 1:250 HOR
1:100 VER

NOTE: CHAINAGES SHOWN ARE ALONG
C OF RIGHT-OF-WAY

NOTES:

1. ALL WORK AND MATERIALS TO BE IN ACCORDANCE WITH THE LATEST REVISION OF THE CITY OF WINNIPEG STANDARD CONSTRUCTION SPECIFICATION.
2. THE CONTRACTOR IS TO CONFIRM THE LOCATION OF ALL UTILITIES/SERVICES IN THE FIELD PRIOR TO CONSTRUCTION.
3. ISOLATE EXISTING HYDRO POLES AND ANCHORS AS PER SD-228C, AS DIRECTED BY CONTRACT ADMINISTRATOR.
4. ALL EXISTING APPROACHES TO BE RENEWED AS DIRECTED BY CONTRACT ADMINISTRATOR.
5. ADDITIONAL EXCAVATION AND INSTALLATION OF SUBGRADE GEOGRID TO BE DETERMINED BY CONTRACT ADMINISTRATOR.
6. ADJUSTMENTS TO PROPOSED CROSSFALL, WHERE REQUIRED, ARE TO BE DETERMINED BY CONTRACT ADMINISTRATOR TO SUIT EXISTING DRIVEWAYS, APPROACHES, ETC..
7. ALL LAND DRAINAGE SEWER EXCAVATIONS TO BE JETTED, FLOODED AND TAMPED AS PER CW2030-R7
8. TREE/BUSH REMOVALS AS DIRECTED BY CONTRACT ADMINISTRATOR.
9. ALL BOULEVARD RESTORATIONS TO BE SODDED UNLESS OTHERWISE NOTED.
10. RENEW CURB AND SIDEWALK AS DIRECTED BY THE CONTRACT ADMINISTRATOR.

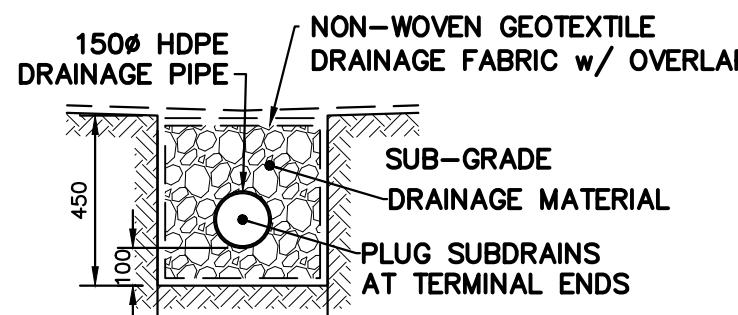
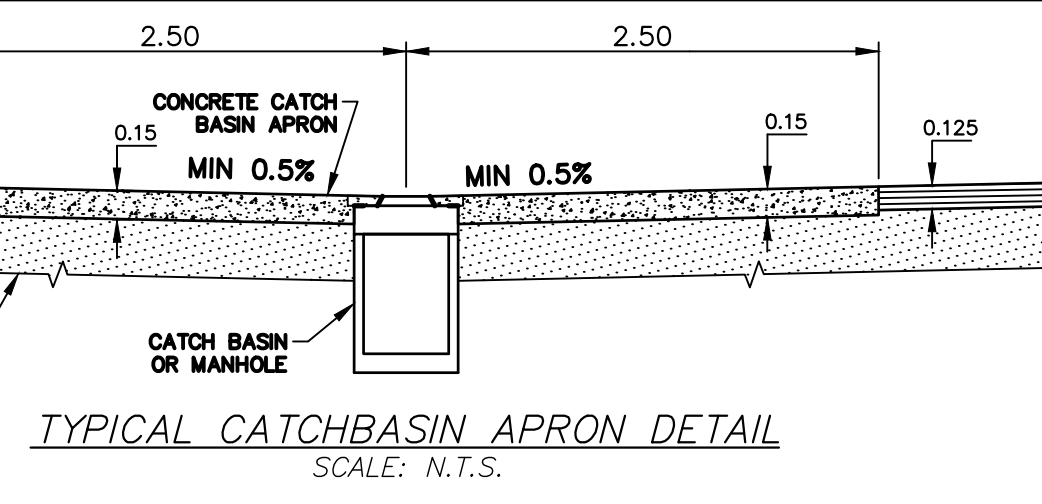
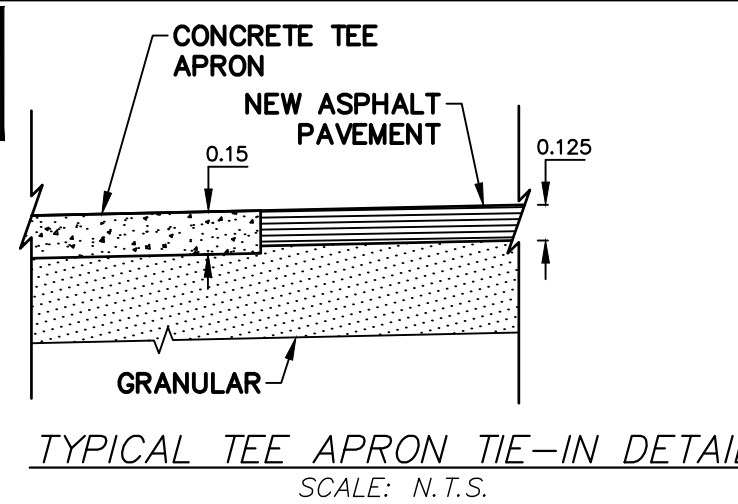

- REFERENCE SPECIFICATIONS
1. SUB-GRADE, SUB-BASE AND BASE MATERIAL SHALL BE SUPPLIED AND PLACED IN ACCORDANCE WITH CW-3110
 2. INSTALLATION OF SUBDRAINS SHALL BE IN ACCORDANCE WITH CW-3120
 3. DRAINAGE GEOTEXTILE FABRIC AND DRAINAGE PIPE SHALL CONFORM TO "APPROVED PRODUCTS FOR SURFACE WORKS"

TYPICAL SUBDRAIN DETAIL

SCALE: N.T.S.

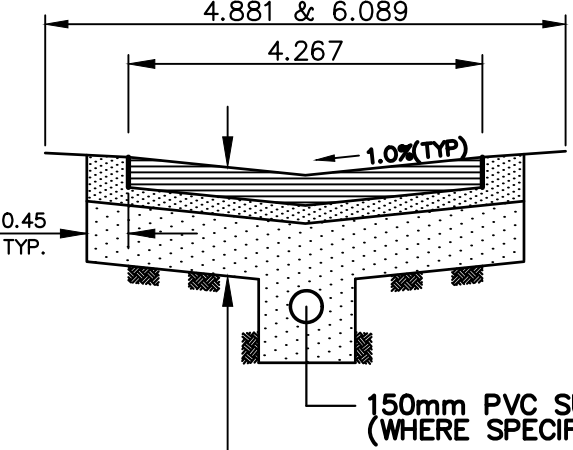

TYPICAL ALLEY CROSS SECTION WITH SUBDRAIN

SCALE: N.T.S.

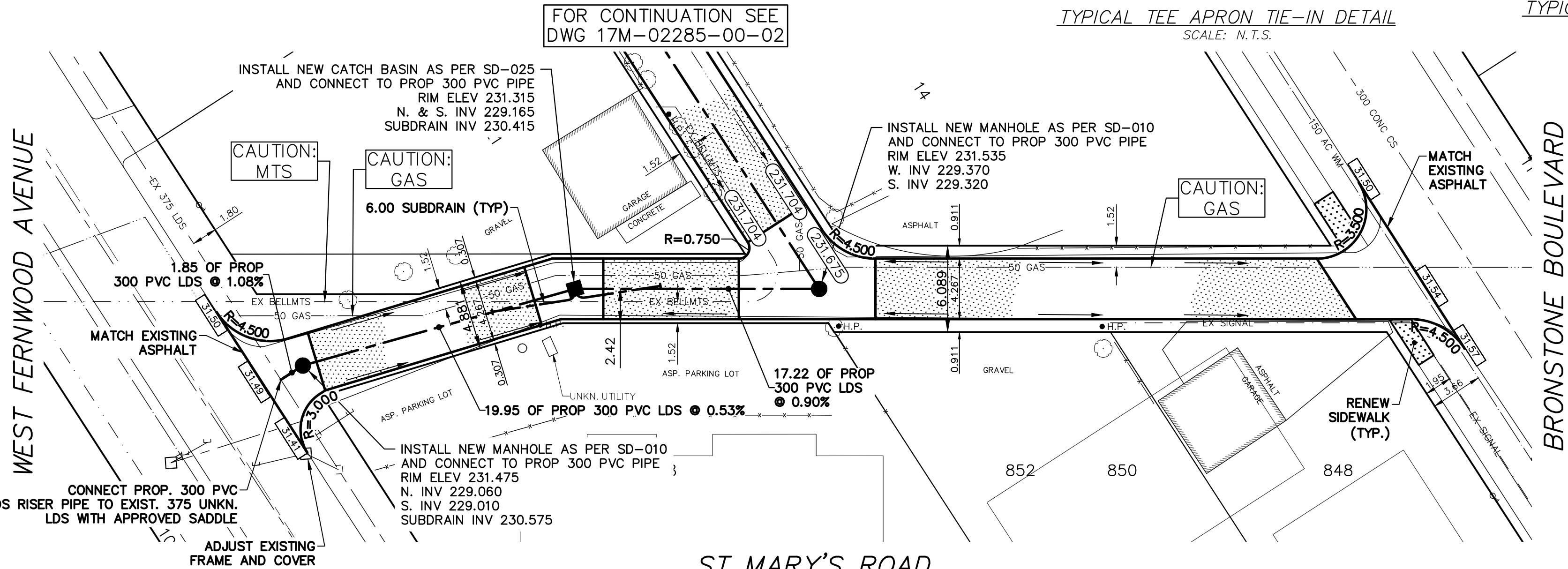
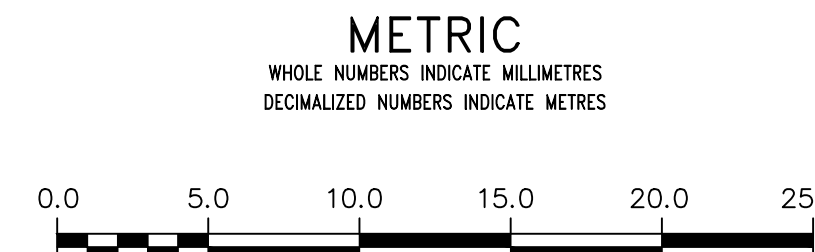

EXISTING	LEGEND - PLAN	PROPOSED	EXISTING	LEGEND - PLAN	PROPOSED	EXISTING	LEGEND - PROFILE	PROPOSED
WATERMAIN	HYDRANT	WATERMAIN	GAS	M.T.S.	GAS	WATERMAIN	VALVE	WATERMAIN
LAND DRAINAGE SEWER	WASTE WATER SEWER	LAND DRAINAGE SEWER	WASTE WATER SEWER	WASTE WATER SEWER	LAND DRAINAGE SEWER	WASTE WATER SEWER	WASTE WATER SEWER	WASTE WATER SEWER
CB LEAD	MANHOLE	CB LEAD	MANHOLE	MANHOLE	CB LEAD	MANHOLE	MANHOLE	MANHOLE
CATCH BASIN	CURB INLET	CATCH BASIN	CURB INLET	CURB INLET	CATCH BASIN	CURB INLET	CURB INLET	CURB INLET
HYDRO		HYDRO			HYDRO			

LOCATION APPROVED	UNDERGROUND STRUCTURES
SUPV. U/G STRUCTURES	DATE
NOTE:	
LOCATION OF UNDERGROUND STRUCTURES AS SHOWN ARE BASED ON THE BEST INFORMATION AVAILABLE BUT NO GUARANTEE IS GIVEN THAT ALL EXISTING UTILITIES ARE SHOWN OR THAT THE GIVEN LOCATIONS ARE EXACT. CONFIRMATION OF EXISTENCE AND EXACT LOCATION OF ALL SERVICES MUST BE OBTAINED FROM THE INDIVIDUAL UTILITIES BEFORE PROCEEDING WITH CONSTRUCTION.	

REVISIONS	DATE	BY
1	18/03/19	R.H.
2	18/03/19	R.H.
3	18/03/19	R.H.
4	18/03/19	R.H.
5	18/03/19	R.H.
6	18/03/19	R.H.
7	18/03/19	R.H.
8	18/03/19	R.H.
9	18/03/19	R.H.
10	18/03/19	R.H.

DESIGNED BY	CHECKED BY
A.B.	R.H.
DRAWN BY	APPROVED BY
R.H.	S.M.
HOR. SCALE	VERT. SCALE
1:250	AS SHOWN
DATE	BY
JANUARY 2018	

NOT FOR CONSTRUCTION
CONSULTANT DRAWING NO.
17M-02285-00 -03

THE CITY OF WINNIPEG	PUBLIC WORKS DEPARTMENT
2018 LOCAL IMPROVEMENTS	CITY DRAWING NO.
ST MARY'S LANE	SHEET 3 OF 3
FROM WEST FERNWOOD AVE TO BRONSTONE BLVD	BID OPPORTUNITY
ASPHALT PAVEMENT	30-2018

