

Note:
Layout and marking of finished elevations at corners of all tees to be field staked by Contractor Administrator.

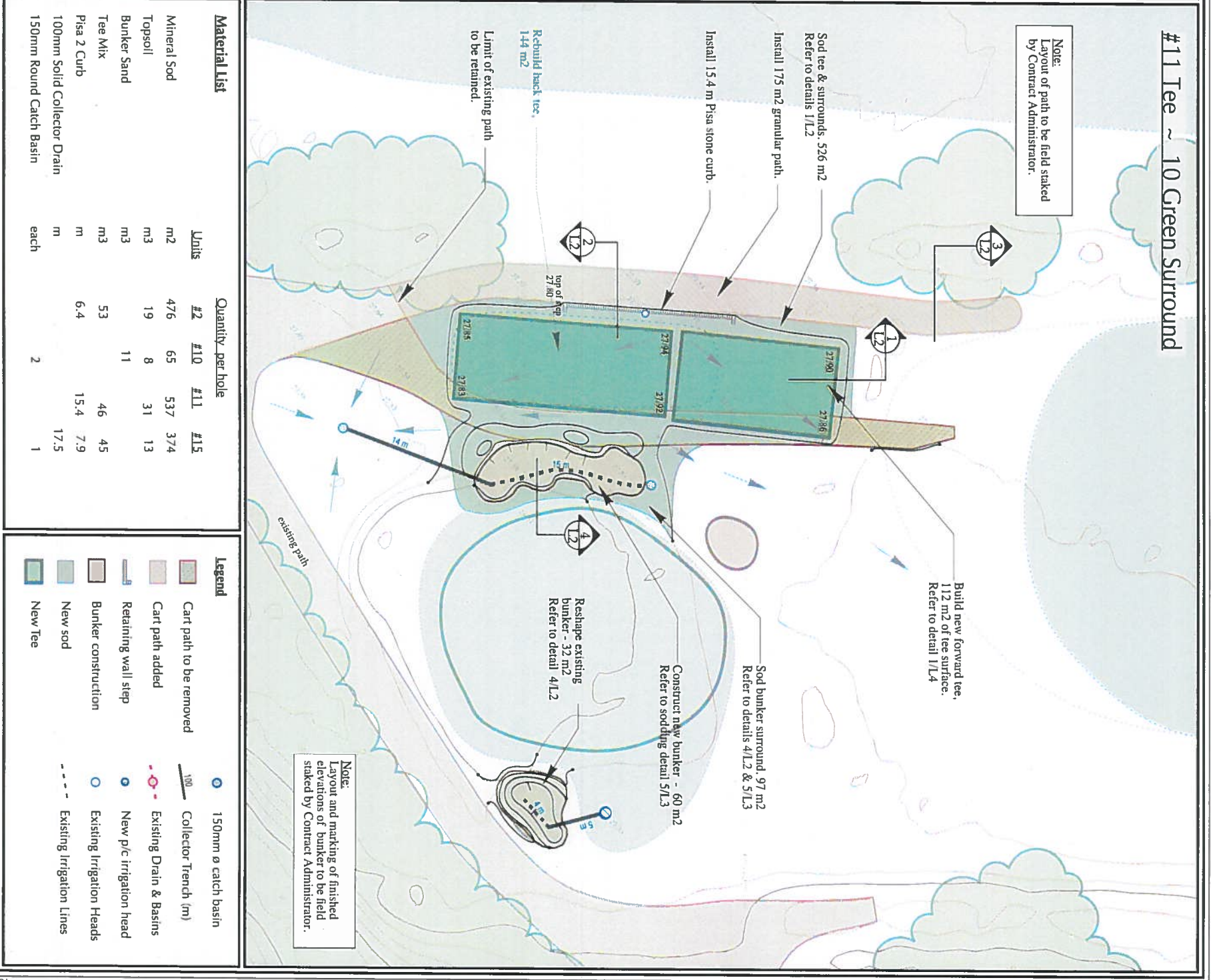

Note:
Layout of path to be field staked by Contractor Administrator.

Note:
Layout and marking of finished elevations of bunker to be field staked by Contractor Administrator.

Material List

| Units | #2 | #10 | #11 | #15 |
|-----------------------------|------|-----|-----|------|
| Mineral Sod | m2 | 476 | 65 | 537 |
| Topsoil | m3 | 19 | 8 | 31 |
| Bunker Sand | m3 | | 11 | |
| Tee Mix | m3 | 53 | | 46 |
| Pisa 2 Curb | m | 6.4 | | 15.4 |
| 100mm Solid Collector Drain | m | | | 17.5 |
| 150mm Round Catch Basin | each | | 2 | 1 |

Legend

- 150mm ø catch basin
- Collector Trench (m)
- Cart path to be removed
- Cart path added
- Retaining wall step
- Bunker construction
- New sod
- New Tee
- Existing Drain & Basins
- Existing Irrigation Heads
- New p/c irrigation head
- Existing Irrigation Heads
- Existing Irrigation Lines

GRANT GOLF
 Golf Course Planning • Design • Construction Management
 Winnipeg, Manitoba • (204) 229-2419 • Email: grantgolf@mac.com

Project: **Kildonan Park Golf Course**
 2021 Main St., Winnipeg, MB.
 Drawing Title: **Construction Layout Plan**

Notes:
Bid Opportunity 314-2018
 1. Invert elevations and drainage pipe slope are subject to on-site verifications.
 2. Elevations are shown in meters. Add 200.0m to get geodetic elevations.
 3. Removed new irrigation pipe at No. 2 Tee

Scale: **1 : 200**
 North:
 Drawn: **TK**
 Checked: **DC**
 Date: **Mar. 7, 2018**
 Revisions: **May 7, 2018**
 Drawing No.: **L1R1**