



Roof A: Existing
 Top Coat w/Gravel Ballast
 (possible re-saturant)
 4-Ply Bur
 1" FibreGlass
 Felt Vapour Barrier
 Steel Decking

Roof A: New
 TG - SBS Cap Sheet
 Semi-Adhered Base Sheet
 2" ISO w/ Acrylic Facer
 TBA
 SBS Vapour Barrier
 5/8" Glass Mat Sheathing
 Steel Decking

Roof B: Existing
 Top Coat w/Gravel Ballast
 4-Ply Bur
 1/2" FibreBoard
 4" ISO
 Felt Vapour Barrier
 Steel Decking

Roof B: New
 TG - SBS Cap Sheet
 Semi-Adhered Base Sheet
 2" ISO w/ Acrylic Facer
 4" Poly-Iso
 SBS Vapour Barrier
 5/8" Glass Mat Sheathing
 Steel Decking

Roof F: Existing
 Top Coat w/Gravel Ballast
 4-Ply Bur
 1/2" FibreBoard
 3" FibreGlass
 Felt Vapour Barrier
 Steel Decking

Roof F: New
 TG - SBS Cap Sheet
 Semi-Adhered Base Sheet
 2" ISO w/ Acrylic Facer
 EPS TBD
 SBS Vapour Barrier
 5/8" Glass Mat Sheathing
 Steel Decking

Notes

1. All roof areas are approximate, bidder responsible for site verification.
2. Bidder is responsible for site verification of existing decking & roof assemblies.
3. Drawings Not to Scale (NTS).

PARTIAL ROOF PLAN VIEW

Roof-F: Provide min. 1.5% slope c/w min. 2" plus ISO to effective R30. (Min. 2" ISO required for membrane warranty. Remaining R-value can be composed of EPS Type 2.)

Roof-A: Structurally sloped. Provide min. 2% back-slope to effective drainage.

Min. 13' drain to wall

Roof-B: Provide min. 1.5% slope c/w min. 2" plus ISO to effective R30. (Min. 2" ISO required for membrane warranty. Remaining R-value can be composed of EPS Type 2.)

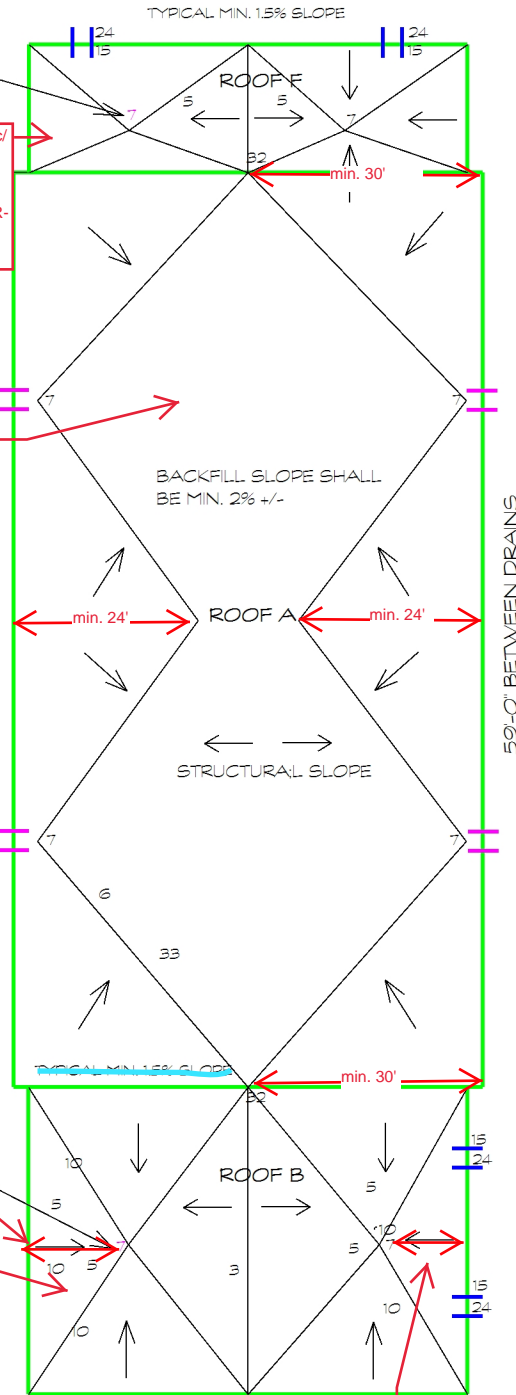

Keynote Legend

- | | |
|--------------------|---------------------------|
| 1. CORE SAMPLE | 17. HVAC UNIT |
| 2. CHIMNEY | 18. CAPPED CURB |
| 3. A/C UNIT | 19. FLAG POLE |
| 4. SIGN SUPPORT | 20. ELECTRICAL MAST |
| 5. VENTILATOR | 21. COOLING TOWER |
| 6. VENT PIPE | 22. SPLASH PAD |
| 7. ROOF DRAIN | 23. SPLASH PAN |
| 8. SKYLIGHT | 24. DOWN SPOUT |
| 9. EAVESTROUGH | 25. BACK SLOPE |
| 10. PLUMBING STACK | 26. CANT |
| 11. ANTENNA | 27. SLOPE TO DRAIN |
| 12. LADDER | 28. CRICKET |
| 13. ATTIC VENT | 29. PARAPET/WIDE FLASHING |
| 14. ROOF HATCH | 30. SAFETY LINE ANCHOR |
| 15. SCUPPER | 31. LIGHT POLES |
| 16. PITCH BOX | 32. GARAGE EXHAUST FAN |
| | 33. KITCHEN EXHAUST FAN |



QCA Building Envelope Ltd.

1295 Pembina Highway Winnipeg, MB R3T 2B0
 Tel: (204) 371-0996

Project **FS-01 Fire Station # 1
 65 Ellen Street, Winnipeg**

Client City of Winnipeg

Dwg. No. **A1-R1**

Date April 12, 2018 Scale N.T.S.

This drawing is the property of QCA Building Envelope Ltd.
 It may not be reproduced without consent.