

APPENDIX 'E'

PRECAST CONCRETE PORTABLE TRAFFIC BARRIER



185 DAWSON ROAD, WINNIPEG, MB R2J 0S6 PH:(204) 958-8333

MATERIAL DETAIL SHEET

Drawn By: **SB**

W.O: **931-18**

PAGE:

Checked: **IL**

Sheet

E44-02

Project: **STANDARD TRAFFIC BARRIER**

Date: **01.22.18**

ENG: **IL IL**

GRADE	BAR GRADE	FINISH	REV.	BY	DATE	DESCRIPTION	QTY.	TOTAL
<input checked="" type="checkbox"/> W	<input type="checkbox"/> 300 Grade	<input type="checkbox"/> Plain	0			RELEASED FOR PRODUCTION	-	-
<input type="checkbox"/> 300 W	<input type="checkbox"/> 400W Grade	<input type="checkbox"/> Prime Coat						
<input type="checkbox"/> 350 W	<input type="checkbox"/> 400W Studs	<input type="checkbox"/> Zinc rich paint						
	<input type="checkbox"/> 550 Def. Bars	<input type="checkbox"/> Zinc plate						
	<input type="checkbox"/> 400W W Grade	<input type="checkbox"/> Galvanize						
Other _____	Other _____	Other _____						

BID OPPORTUNITY NO. 1104-2017

E44-02 38 DIA. X 813 LG STEEL RETAINING PIN

813

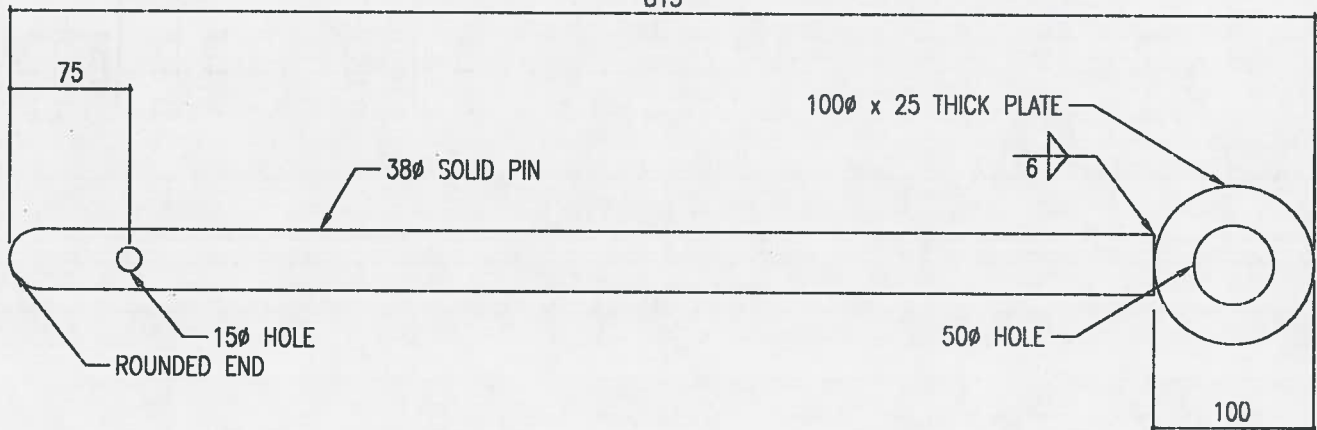



PRODUCTION HARDWARE LIST

PROJECT		STANDARD TRAFFIC BARRIER		PAGE
DRAWN SB		CHECKER IL		PM-1
REL.#1		REL.#4		W.O.#
REL.#2		REL.#5		931
REL.#3		REL.#6		
REL.#4		REL.#7		
REL.#5		REL.#8		
REL.#6		REL.#9		
REL.#7		REL.#10		
REL.#8		REL.#11		
REL.#9		REL.#12		
REL.#10		REL.#13		
REL.#11		REL.#14		
REL.#12		REL.#15		
REL.#13		REL.#16		
REL.#14		REL.#17		
REL.#15		REL.#18		
REL.#16		REL.#19		
REL.#17		REL.#20		
REL.#18		REL.#21		
REL.#19		REL.#22		
REL.#20		REL.#23		
REL.#21		REL.#24		
REL.#22		REL.#25		
REL.#23		REL.#26		
REL.#24		REL.#27		
REL.#25		REL.#28		
REL.#26		REL.#29		
REL.#27		REL.#30		
REL.#28		REL.#31		
REL.#29		REL.#32		
REL.#30		REL.#33		
REL.#31		REL.#34		
REL.#32		REL.#35		
REL.#33		REL.#36		
REL.#34		REL.#37		
REL.#35		REL.#38		
REL.#36		REL.#39		
REL.#37		REL.#40		
REL.#38		REL.#41		
REL.#39		REL.#42		
REL.#40		REL.#43		
REL.#41		REL.#44		
REL.#42		REL.#45		
REL.#43		REL.#46		
REL.#44		REL.#47		
REL.#45		REL.#48		
REL.#46		REL.#49		
REL.#47		REL.#50		
REL.#48		REL.#51		
REL.#49		REL.#52		
REL.#50		REL.#53		
REL.#51		REL.#54		
REL.#52		REL.#55		
REL.#53		REL.#56		
REL.#54		REL.#57		
REL.#55		REL.#58		
REL.#56		REL.#59		
REL.#57		REL.#60		
REL.#58		REL.#61		
REL.#59		REL.#62		
REL.#60		REL.#63		
REL.#61		REL.#64		
REL.#62		REL.#65		
REL.#63		REL.#66		
REL.#64		REL.#67		
REL.#65		REL.#68		
REL.#66		REL.#69		
REL.#67		REL.#70		
REL.#68		REL.#71		
REL.#69		REL.#72		
REL.#70		REL.#73		
REL.#71		REL.#74		
REL.#72		REL.#75		
REL.#73		REL.#76		
REL.#74		REL.#77		
REL.#75		REL.#78		
REL.#76		REL.#79		
REL.#77		REL.#80		
REL.#78		REL.#81		
REL.#79		REL.#82		
REL.#80		REL.#83		
REL.#81		REL.#84		
REL.#82		REL.#85		
REL.#83		REL.#86		
REL.#84		REL.#87		
REL.#85		REL.#88		
REL.#86		REL.#89		
REL.#87		REL.#90		
REL.#88		REL.#91		
REL.#89		REL.#92		
REL.#90		REL.#93		
REL.#91		REL.#94		
REL.#92		REL.#95		
REL.#93		REL.#96		
REL.#94		REL.#97		
REL.#95		REL.#98		
REL.#96		REL.#99		
REL.#97		REL.#100		
REL.#98		REL.#101		
REL.#99		REL.#102		
REL.#100		REL.#103		
REL.#101		REL.#104		
REL.#102		REL.#105		
REL.#103		REL.#106		
REL.#104		REL.#107		
REL.#105		REL.#108		
REL.#106		REL.#109		
REL.#107		REL.#110		
REL.#108		REL.#111		
REL.#109		REL.#112		
REL.#110		REL.#113		
REL.#111		REL.#114		
REL.#112		REL.#115		
REL.#113		REL.#116		
REL.#114		REL.#117		
REL.#115		REL.#118		
REL.#116		REL.#119		
REL.#117		REL.#120		
REL.#118		REL.#121		
REL.#119		REL.#122		
REL.#120		REL.#123		
REL.#121		REL.#124		
REL.#122		REL.#125		
REL.#123		REL.#126		
REL.#124		REL.#127		
REL.#125		REL.#128		
REL.#126		REL.#129		
REL.#127		REL.#130		
REL.#128		REL.#131		
REL.#129		REL.#132		
REL.#130		REL.#133		
REL.#131		REL.#134		
REL.#132		REL.#135		
REL.#133		REL.#136		
REL.#134		REL.#137		
REL.#135		REL.#138		
REL.#136		REL.#139		
REL.#137		REL.#140		
REL.#138		REL.#141		
REL.#139		REL.#142		
REL.#140		REL.#143		
REL.#141		REL.#144		
REL.#142		REL.#145		
REL.#143		REL.#146		
REL.#144		REL.#147		
REL.#145		REL.#148		
REL.#146		REL.#149		
REL.#147		REL.#150		
REL.#148		REL.#151		
REL.#149		REL.#152		
REL.#150		REL.#153		
REL.#151		REL.#154		
REL.#152		REL.#155		
REL.#153		REL.#156		
REL.#154		REL.#157		
REL.#155		REL.#158		
REL.#156		REL.#159		
REL.#157		REL.#160		
REL.#158		REL.#161		
REL.#159		REL.#162		
REL.#160		REL.#163		
REL.#161		REL.#164		
REL.#162		REL.#165		
REL.#163		REL.#166		
REL.#164		REL.#167		
REL.#165		REL.#168		
REL.#166		REL.#169		
REL.#167		REL.#170		
REL.#168		REL.#171		
REL.#169		REL.#172		
REL.#170		REL.#173		
REL.#171		REL.#174		
REL.#172		REL.#175		
REL.#173		REL.#176		
REL.#174		REL.#177		
REL.#175		REL.#178		
REL.#176		REL.#179		
REL.#177		REL.#180		
REL.#178		REL.#181		
REL.#179		REL.#182		
REL.#180		REL.#183		
REL.#181		REL.#184		
REL.#182		REL.#185		
REL.#183		REL.#186		
REL.#184		REL.#187		
REL.#185		REL.#188		
REL.#186		REL.#189		
REL.#187		REL.#190		
REL.#188		REL.#191		
REL.#189		REL.#192		
REL.#190		REL.#193		
REL.#191		REL.#194		
REL.#192		REL.#195		
REL.#193		REL.#196		
REL.#194		REL.#197		
REL.#195		REL.#198		
REL.#196		REL.#199		
REL.#197		REL.#200		
REL.#198		REL.#201		
REL.#199		REL.#202		
REL.#200		REL.#203		
REL.#201		REL.#204		
REL.#202		REL.#205		
REL.#203		REL.#206		
REL.#204		REL.#207		
REL.#205		REL.#208		
REL.#206		REL.#209		
REL.#207		REL.#210		
REL.#208		REL.#211		
REL.#209		REL.#212		
REL.#210		REL.#213		
REL.#211		REL.#214		
REL.#212		REL.#215		
REL.#213		REL.#216		
REL.#214		REL.#217		
REL.#215		REL.#218		
REL.#216		REL.#219		
REL.#217		REL.#220		
REL.#218		REL.#221		
REL.#219		REL.#222		
REL.#220		REL.#223		
REL.#221		REL.#224		
REL.#222		REL.#225		
REL.#223		REL.#226		
REL.#224		REL.#227		
REL.#225		REL.#228		
REL.#226		REL.#229		
REL.#227		REL.#230		
REL.#228		REL.#231		
REL.#229		REL.#232		
REL.#230		REL.#233		
REL.#231		REL.#234		
REL.#232		REL.#235		
REL.#233		REL.#236		
REL.#234		REL.#237		
REL.#235		REL.#238		
REL.#236		REL.#239		
REL.#237		REL.#240		
REL.#238		REL.#241		
REL.#239		REL.#242		
REL.#240		REL.#243		
REL.#241		REL.#244		
REL.#242		REL.#245		
REL.#243		REL.#246		
REL.#244		REL.#247		
REL.#245		REL.#248		
REL.#246		REL.#249		
REL.#247		REL.#250		
REL.#248		REL.#251		
REL.#249		REL.#252		
REL.#250		REL.#253		
REL.#251		REL.#254		
REL.#252		REL.#255		
REL.#253		REL.#256		
REL.#254		REL.#257		
REL.#255		REL.#258		
REL.#256		REL.#259		
REL.#257		REL.#260		
REL.#258		REL.#261		
REL.#259		REL.#262		
REL.#260		REL.#263		
REL.#261		REL.#264		
REL.#262		REL.#265		
REL.#263		REL.#266		
REL.#264		REL.#267		
REL.#265		REL.#268		
REL.#266		REL.#269		
REL.#267		REL.#270		
REL.#268		REL.#271		
REL.#269		REL.#272		
REL.#270		REL.#273		
REL.#271		REL.#274		
REL.#272		REL.#275		
REL.#273		REL.#276		
REL.#274		REL.#277		
REL.#275		REL.#278		
REL.#276		REL.#279		
REL.#277		REL.#280		
REL.#278		REL.#281		
REL.#279		REL.#282		
REL.#280		REL.#283		
REL.#281		REL.#284		
REL.#282		REL.#285		
REL.#283		REL.#286		
REL.#284		REL.#287		
REL.#285		REL.#288		
REL.#286		REL.#289		
REL.#287		REL.#290		
REL.#288		REL.#291		
REL.#289		REL.#292		
REL.#290		REL.#293		
REL.#291		REL.#294		
REL.#292		REL.#295		
REL.#293		REL.#296		
REL.#294		REL.#297		
REL.#295		REL.#298		
REL.#296		REL.#299		
REL.#297		REL.#300		
REL.#298		REL.#301		
REL.#299		REL.#302		
REL.#300		REL.#303		
REL.#301		REL.#304		
REL.#302		REL.#305		
REL.#303		REL.#306		
REL.#304		REL.#307		
REL.#305		REL.#308		
REL.#306		REL.#309		
REL.#307		REL.#310		
REL.#308		REL.#311		
REL.#309		REL.#312		
REL.#310		REL.#313		



MATERIAL DETAIL SHEET

185 DAWSON ROAD, WINNIPEG, MB R2J 0S8 PH:(204) 968-6333

Drawn By: *W* SB

W.O: 931-18

PAGE:

Checked: IL

Sheet

P44-01

Project: **STANDARD TRAFFIC BARRIER**

Date: **01.22.18**

ENG: IL *X*

REV.	BY	DATE	DESCRIPTION	QTY.	TOTAL
0			RELEASED FOR PRODUCTION	-	-

GRADE	BAR GRADE	FINISH
<input type="checkbox"/> W	<input type="checkbox"/> 300 Grade	<input type="checkbox"/> Plain
<input type="checkbox"/> 300 W	<input type="checkbox"/> 400W Grade	<input type="checkbox"/> Prime Coat
<input type="checkbox"/> 350 W	<input type="checkbox"/> 400W Studs	<input type="checkbox"/> Zinc rich paint
	<input type="checkbox"/> 650 Def. Bars	<input type="checkbox"/> Zinc plate
	<input type="checkbox"/> 400W W Grade	<input type="checkbox"/> Galvanize
Other _____	Other _____	Other _____

BID OPPORTUNITY NO. 1104-2017

DN50 x 196 STD. PIPE

P44-01 DN50 x 196 STEEL
PIPE C/E (1) PLUG &
(1) 10x75 STRAP IRON
W/ (2) 14 DIA. HOLE

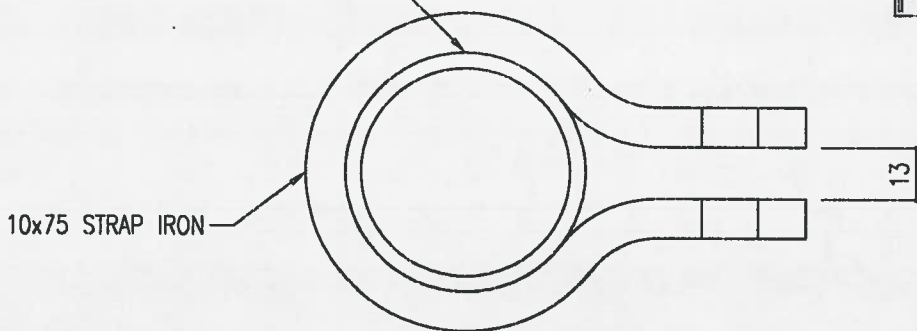

TOP VIEW
SCALE: 1:2

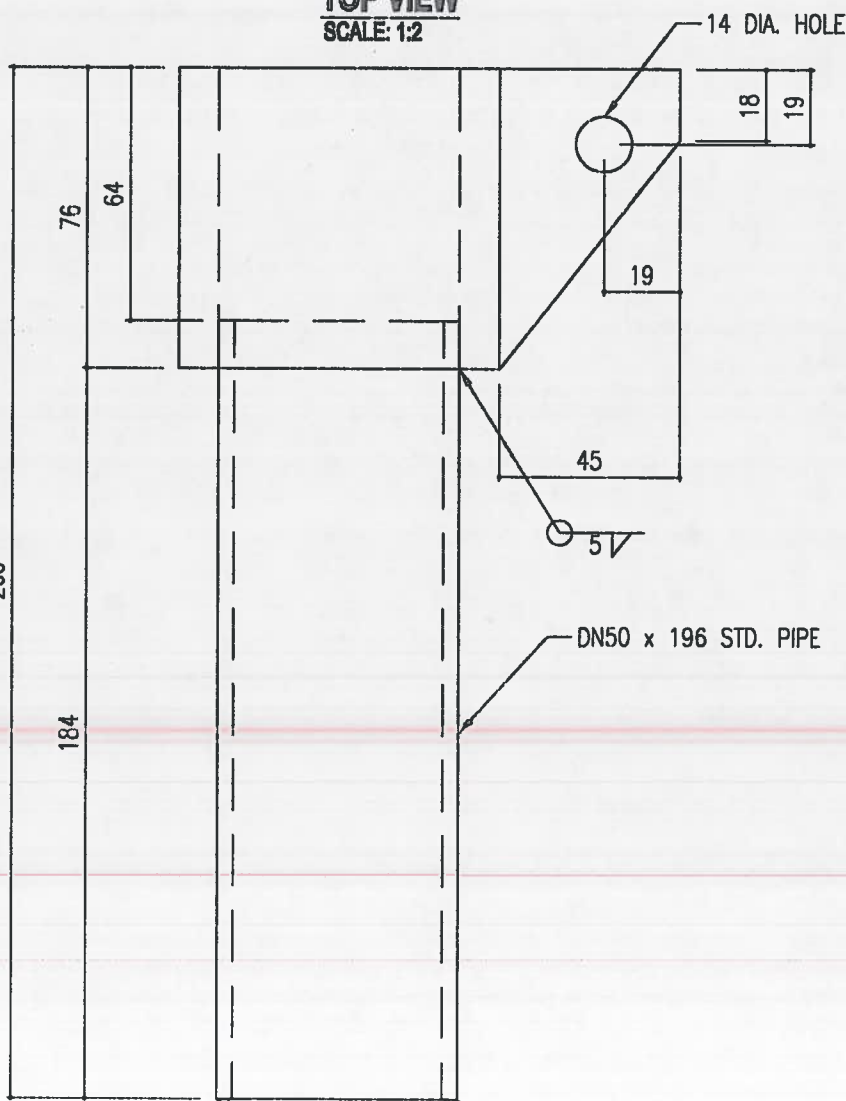

SIDE VIEW
SCALE: 1:2

JAN 26 2018
RELEASED FOR PRODUCTION



185 DAWSON ROAD, WINNIPEG, MB R2J 0S6 PH:(204) 953-8333

MATERIAL DETAIL SHEET

Drawn By: **SB**
Checked: **IL**
ENG: **IL**

W.O: **931-18**
Sheet: **-**

PAGE:

P44-02

Project: **STANDARD TRAFFIC BARRIER**

Date: **01.22.18**

ENG: **IL**

GRADE	BAR GRADE	FINISH	REV.	BY	DATE	DESCRIPTION	QTY.	TOTAL
<input type="checkbox"/> W	<input type="checkbox"/> 300 Grade	<input type="checkbox"/> Plain	0			RELEASED FOR PRODUCTION	-	-
<input type="checkbox"/> 300 W	<input type="checkbox"/> 400W Grade	<input type="checkbox"/> Prime Coat						
<input type="checkbox"/> 350 W	<input type="checkbox"/> 400W Studs	<input type="checkbox"/> Zinc rich paint						
	<input type="checkbox"/> 560 Def. Bars	<input type="checkbox"/> Zinc plate						
	<input type="checkbox"/> 400W W Grade	<input type="checkbox"/> Galvanize						
Other _____	Other _____	Other _____						

NAME	EC-2	SYSTEM SIZE	1"	BID OPPORTUNITY NO. 1104-2017
------	------	-------------	----	-------------------------------

COIL
LIFTING
INSERTS



Type EC-2



INSERT TYPE	DIA.	LENGTH Inch (mm)	WIDTH Inch (mm)	WASHER THICKNESS Inch (mm)
EC-2	3/4"	4 3/4" (115)	2 1/4" (67)	1/8" (270)
EC-2	1"	5 1/2" (140)	2 5/8" (67)	3/16" (270)

4:1 Approximate Safety Factor

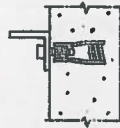

BRACKETS

BOLT DIAMETER AND SYMBOL	MIN. CONC. THICKNESS Inch (mm)	INSERT LENGTH Inch (L-mm)	INSERT WIDTH Inch (D-mm)	WASHER THICKNESS Inch (T-mm)	WORKING LOAD lbs (kN)	
					SHEAR	TENSION
3/4" 2 Strut Type EC-2	6" (150)	4 3/4" (121)	2 1/4" (67)	1/8" (3.10)	3,525 lbs. (15.65)	4,500 lbs. (20.00)
1" 2 Strut Type EC-2	6" (150)	5 1/4" (146)	2 5/8" (67)	3/16" (4.70)	6,000 lbs. (26.70)	8,000 lbs. (26.70)

4:1 Approximate Safety Factor

FORCE IN kN (lbs) FOR EDGE DISTANCE - CENTERLINE OF INSERT TO NEAREST EDGE

SIZE AND TYPE	FORCE IN kN (lbs) FOR EDGE DISTANCE - CENTERLINE OF INSERT TO NEAREST EDGE																	
	1 1/2" (40mm)		2" (50mm)		3" (75mm)		4" (100mm)		5" (125mm)		6" (150mm)		8" (200mm)		9" (225mm)			
	TENSION	SHEAR	TENSION	SHEAR	TENSION	SHEAR	TENSION	SHEAR	TENSION	SHEAR	TENSION	SHEAR	TENSION	SHEAR	TENSION	SHEAR		
3/4" Type EC-2 2 Strut	1,125	375	2,250	800	3,180	975	3,975	1,360	4,500*	3,375	15,600*	(3,525*)			4,500*	3,525*	(20.00*) (15.00*)	
1" Type EC-2 2 Strut					3,375	1,500	4,125	2,250	5,250	3,375	8,000*	4,600			8,000*	8,000*	8,000*	(26.70*) (26.70*) (26.70*)

Type EC-4



INSERT TYPE	DIA.	LENGTH Inch (mm)	WIDTH Inch (mm)	WASHER THICKNESS Inch (mm)
EC-4	1 1/4"	7 5/8" (191)	3 1/4" (83)	7/32" (270)

4:1 Approximate Safety Factor



PRECAST ANCHORING TO STEEL

BOLT DIAMETER AND SYMBOL	MIN. CONC. THICKNESS Inch (mm)	INSERT LENGTH Inch (L-mm)	INSERT WIDTH Inch (D-mm)	WASHER THICKNESS Inch (T-mm)	WORKING LOAD lbs (kN)	
					SHEAR	TENSION
1 1/4" 4 Strut Type EC-4	8" (200)	7 5/8" (194)	3 1/4" (83)	7/32" (5.50)	9,000 lbs. (40.00)	12,000 lbs. (53.00)

4:1 Approximate Safety Factor

FORCE IN kN (lbs) FOR EDGE DISTANCE - CENTERLINE OF INSERT TO NEAREST EDGE

SIZE AND TYPE	FORCE IN kN (lbs) FOR EDGE DISTANCE - CENTERLINE OF INSERT TO NEAREST EDGE																	
	1 1/2" (40mm)		2" (50mm)		3" (75mm)		4" (100mm)		5" (125mm)		6" (150mm)		8" (200mm)		9" (225mm)			
	TENSION	SHEAR	TENSION	SHEAR	TENSION	SHEAR	TENSION	SHEAR	TENSION	SHEAR	TENSION	SHEAR	TENSION	SHEAR	TENSION	SHEAR		
1 1/4" Type EC-4 4 Strut								6,000	2,400	7,500	3,750	9,000	5,625	11,250	8,250	12,000*	9,000*	(26.70) (10.60) (33.30) (16.50) (40.00) (25.00) (50.00) (36.50) (53.00*) (40.00*)

LAFARGE
 JAN 26 2018
 RELEASED FOR PRODUCTION