

230 CONCRETE PAVEMENT
PLAIN-DOWELLED JOINTS
75 BASE COURSE MATERIAL
150 CRUSHED SUB BASE MATERIAL
(MAX. SIZE 50mm)
375 CRUSHED SUB BASE MATERIAL
(MAX. SIZE 100mm)
SEPERATION GEOTEXTILE FABRIC
GEOGRID
PREPARED SUBGRADE

TYPICAL CROSS SECTION

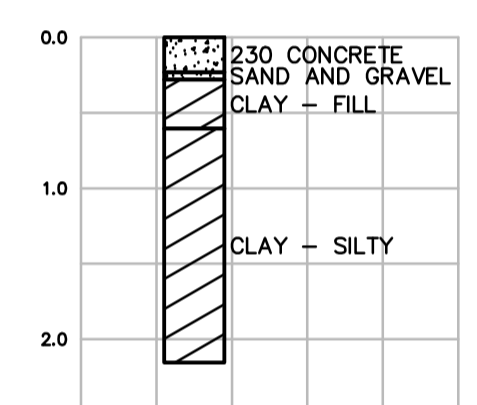

TESTHOLE TP17-14 LOG

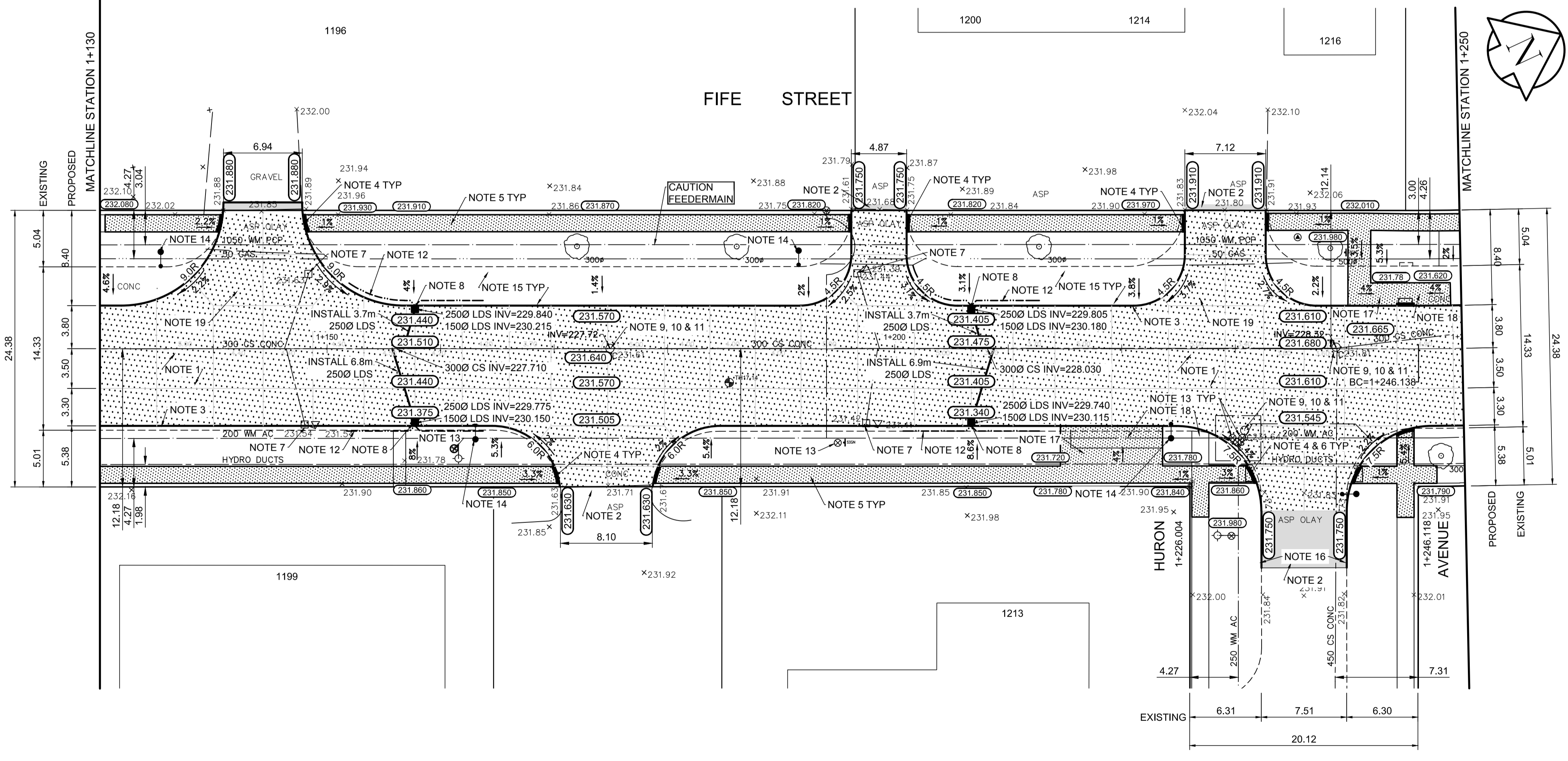

REFERENCE NOTES

- A. PAVEMENT DIMENSIONS ARE TO BACK OF CURB
- B. BASELINE IS CENTRE LINE RIGHT-OF-WAY
- C. PROPERTY LINES OBTAINED FROM CITY OF WINNIPEG L.B.I.S., AND NO SCALE FACTOR WAS APPLIED
- D. REFER TO AECOM FIELD BOOK NO. 4993

CONSTRUCTION NOTES

- REMOVE EXISTING CONCRETE PAVEMENT AND CONSTRUCT NEW 230mm PLAIN DOWELLED CONCRETE PAVEMENT
- REMOVE EXISTING ASPHALT PAVEMENT AND CONSTRUCT NEW ASPHALTIC PAVEMENT TYPE 1A (75mm)
- CONSTRUCT NEW MODIFIED BARRIER CURB (180mm HT. INTEGRAL)
- CONSTRUCT NEW CURB RAMP (10mm HT. INTEGRAL)
- RENEW EXISTING 100mm CONCRETE SIDEWALK
- INSTALL NEW DETECTABLE WARNING SURFACE TILE EXISTING LEAD
- REMOVE EXISTING CATCHBASIN AND CATCHPIT AND PLUG EXISTING LEAD
- INSTALL NEW MODIFIED BARRIER CURB AND GUTTER INLET FRAME AND COVER c/w CATCH BASIN (SD-024) AND CONNECT NEW 250mm LEAD TO EXISTING 300mm COMBINED SEWER
- REMOVE EXISTING FRAME AND COVER AND PLACE NEW FRAME AND SOLID COVER (AP-004/AP-005)
- ADJUST EXISTING MANHOLE TO GRADE
- INSTALL NEW CAST IRON RING
- INSTALL 150mm SUBDRAIN 6.0m ON EACH SIDE OF CATCHBASIN
- ADJUST EXISTING WATER VALVE TO GRADE
- REMOVE EXISTING LIGHT STANDARD (BY OTHERS)
- REMOVE EXISTING CONCRETE PAVEMENT AND PLACE AND COMPACT SUITABLE SITE MATERIAL
- RENEW EXISTING CONCRETE BARRIER CURB (DOWELLED 100mm HT)
- CONSTRUCT NEW 100mm CONCRETE SIDEWALK
- REMOVE EXISTING CONCRETE SIDEWALK
- REMOVE EXISTING CONCRETE PAVEMENT AND CONSTRUCT NEW 200mm REINFORCED CONCRETE PAVEMENT

AECOM
Certificate of Authorization
AECOM Canada Ltd.
No. 4671 Date: _____

METRIC
WHOLE NUMBERS INDICATE MILLIMETRES
DECIMALIZED NUMBERS INDICATE METRES

150 mm W.M.	WATERMAIN	150 mm W.M.	HYDRO	— x —	Q PROFILE
Hydrant	HYDRANT	Hydrant	M.T.S.	— □ —	WEST GUTTER
Valve	VALVE	Valve	CONCRETE	— ○ —	EAST GUTTER
300mm L.D.S.	LAND DRAINAGE SEWER	300mm L.D.S.	ASPHALT	— ◇ —	N/W PROPERTY LINE
250mm W.W.S.	WASTEWATER SEWER	250mm W.W.S.	PROPERTY LINE	— ○ —	S/E PROPERTY LINE
Manhole	MANHOLE	Manhole	SURVEY BAR		
Catch Basin	CATCH BASIN	Catch Basin	ELEVATION (235.750)		
Catch Pit	CATCH PIT	Catch Pit	TREE		
Junctions	JUNCTIONS	Junctions	SIDEWALK RAMP		
Culvert	CULVERT	Culvert	CONCRETE SIDEWALK		
Gas	GAS	Gas	FENCE		
EXISTING	LEGEND - PLAN	PROPOSED	EXISTING	LEGEND - PLAN	PROPOSED
EXISTING	LEGEND - PROFILE	PROPOSED	EXISTING	LEGEND - PROFILE	PROPOSED

LOCATION APPROVED UNDERGROUND STRUCTURES

SUPV. U/G STRUCTURES COMMITTEE DATE _____

NOTE:
LOCATION OF UNDERGROUND STRUCTURES AS SHOWN ARE BASED ON THE BEST INFORMATION AVAILABLE. BUT NO GUARANTEE IS GIVEN THAT ALL EXISTING UTILITIES ARE SHOWN OR THAT THE GIVEN LOCATIONS ARE EXACT. CONFIRMATION OF EXISTENCE AND EXACT LOCATION OF ALL SERVICES MUST BE OBTAINED FROM THE INDIVIDUAL UTILITIES BEFORE PROCEEDING WITH CONSTRUCTION.

B.M. 24-025 N.W. Cor. Mountain Ave. & Fife St. Tbl. in 12m Conc. Pipe beneath Valve Box. 1.9m S. of N. L. of ELEV. 231.217 Mountain Ave. produced from the E. of W.L. of Fife St.

NO.	REVISIONS	DATE	BY
0	ISSUED FOR TENDER	03/05/2018	BC
A	ISSUED FOR REVIEW	02/02/2018	BC

AECOM

DESIGNED BY	SS	CHECKED BY	BC/KWR
DRAWN BY	SS/RAM	APPROVED BY	
HOR. SCALE:	1:250	RELEASED FOR CONSTRUCTION BY:	
VERTICAL:	1:10	DATE	

ENGINEER'S SEAL
PROVINCE OF MANITOBA
K.W. RAE
REGISTERED PROFESSIONAL ENGINEER

THE CITY OF WINNIPEG
PUBLIC WORKS DEPARTMENT
ENGINEERING DIVISION

2018/2019 INDUSTRIAL STREET RENEWAL PROGRAM

FIFE STREET - COLLEGE AVENUE TO INKSTER BOULEVARD
CONCRETE PAVEMENT RECONSTRUCTION
STATION 1+130 TO STATION 1+250

CITY DRAWING NUMBER
SHEET 21 OF 47

CONSULTANT DRAWING NO. CT-21