

APPENDIX D. 2018 WATERMAIN RENEWALS

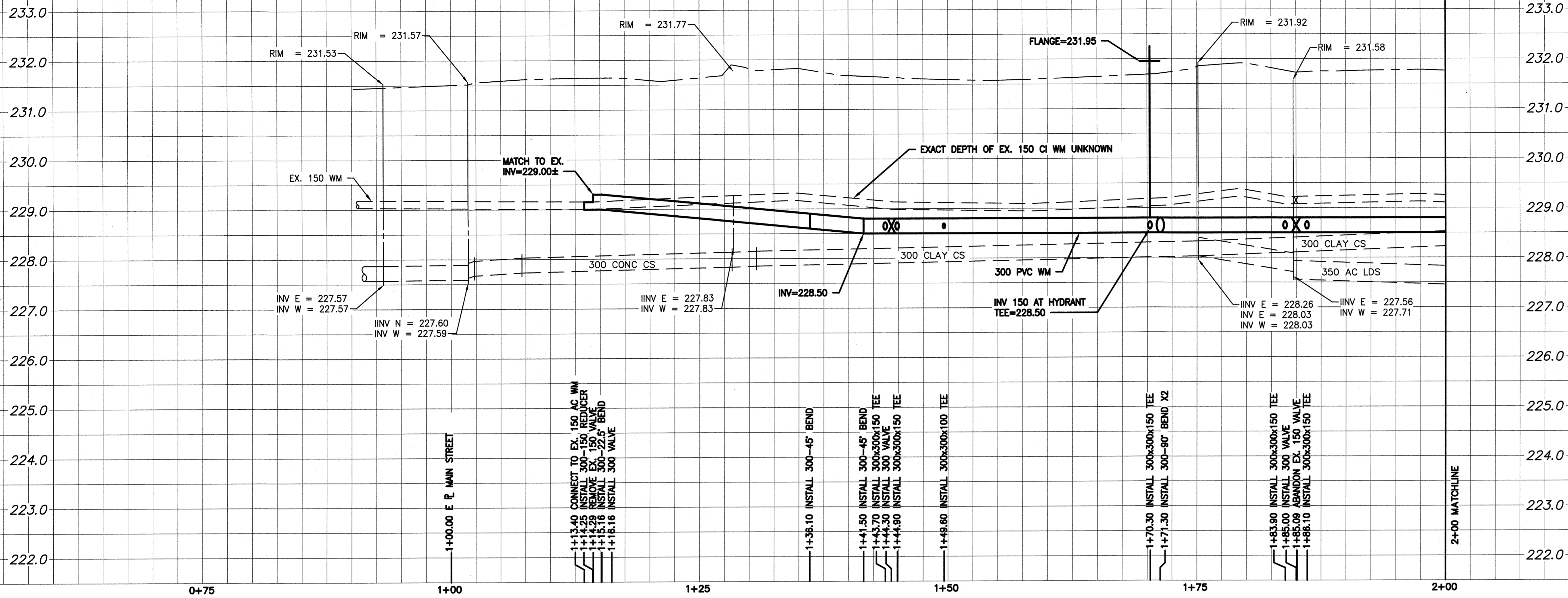

NOTE: CHAINAGES SHOWN ARE ALONG S. R. OF PORTAGE AVENUE

PORTAGE AVENUE

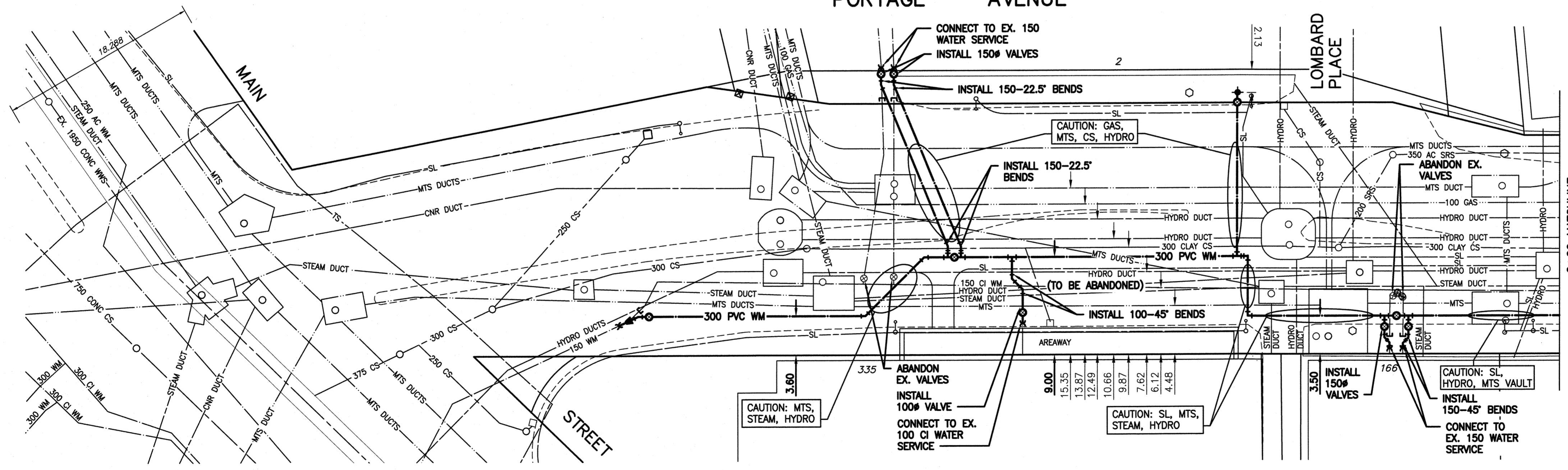

ADDRESS	PIPE SIZE & MATERIAL (STREET)	PIPE SIZE & MATERIAL (PROP.)	SHORT & LONG MEASUREMENT	CORP. LOCATION	REMARKS
* 335 MAIN ST	100 CI	100 CI	-	-	RENEW SERVICE
* 166 PORTAGE AVE E	150	150	-	-	RENEW SERVICE
* 166 PORTAGE AVE E	150	150	-	-	RENEW SERVICE
* 2 LOMBARD PLACE	150	150	-	-	RENEW SERVICE
* 2 LOMBARD PLACE	150	150	-	-	RENEW SERVICE
* SERVICES TO BE RENEWED TO R.					

2+00 MATCHLINE SEE DWG. D-15051

NOTE: VALVES TO BE INSTALLED COUNTERCLOCKWISE TO CLOSE

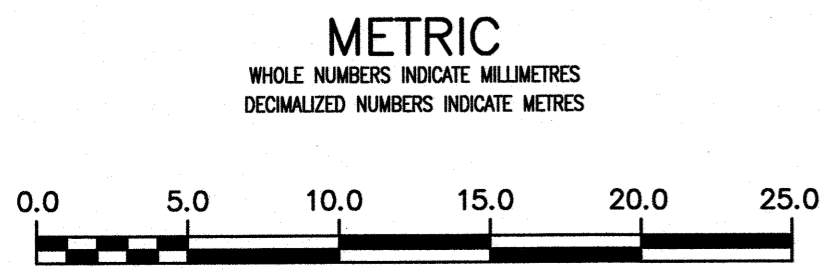

LOCATION APPROVED UNDERGROUND STRUCTURES		B.M. 35-6 ELEV. 232.063m 74M601 - Chrome Tilt. in Ely. wall of The Richardson Bldg. No. 1 Lombard Place, 4.1 m N. of 30y. Cor. of Bldg.	
SUPV. U/O STRUCTURES COMMITTEE	DATE	DESIGNED BY	RS
NOTE:	LOCATION OF UNDERGROUND STRUCTURES AS SHOWN ARE BASED ON THE BEST INFORMATION AVAILABLE BUT NO GUARANTEE IS GIVEN THAT ALL EXISTING UTILITIES ARE SHOWN OR THAT THE GIVEN LOCATIONS ARE EXACT. CONFIRMATION OF EXISTENCE AND EXACT LOCATION OF ALL SERVICES MUST BE OBTAINED FROM THE INDIVIDUAL UTILITIES BEFORE PROCEEDING WITH CONSTRUCTION.	CHECKED BY	WB
		DRAWN BY	SG
		SCALE:	HORIZONTAL 1:250 VERTICAL 1:50
		DATE	2018 02 26
		DATE	2018 02 26
		DATE	2018 04 06
		DATE	2018 04 06



DESIGNED BY	RS	CHECKED BY	WB
DRAWN BY	SG	APPROVED BY	RS
SCALE:	HORIZONTAL 1:250 VERTICAL 1:50	RELEASED FOR CONSTRUCTION	
DATE	2018 02 26	DATE	2018 02 26
DATE	2018 04 06	DATE	2018 04 06

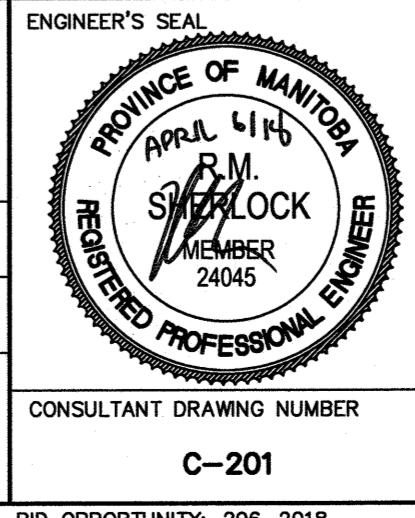

THE CITY OF WINNIPEG
WATER AND WASTE DEPARTMENT
ENGINEERING DIVISION

2018 WATERMAIN RENEWALS
CONTRACT 7
PORTAGE AVENUE
MAIN STREET TO
105 EEL MAIN STREET

SHEET 3 OF 17
CITY DRAWING NUMBER
D-15050

CONSULTANT DRAWING NUMBER
C-201

FILE PATH: V:\1112\active\11121790\0300_drawing\0302_sheet_files\02_civil\ FILE NAME: 17590c-201-913.dwg

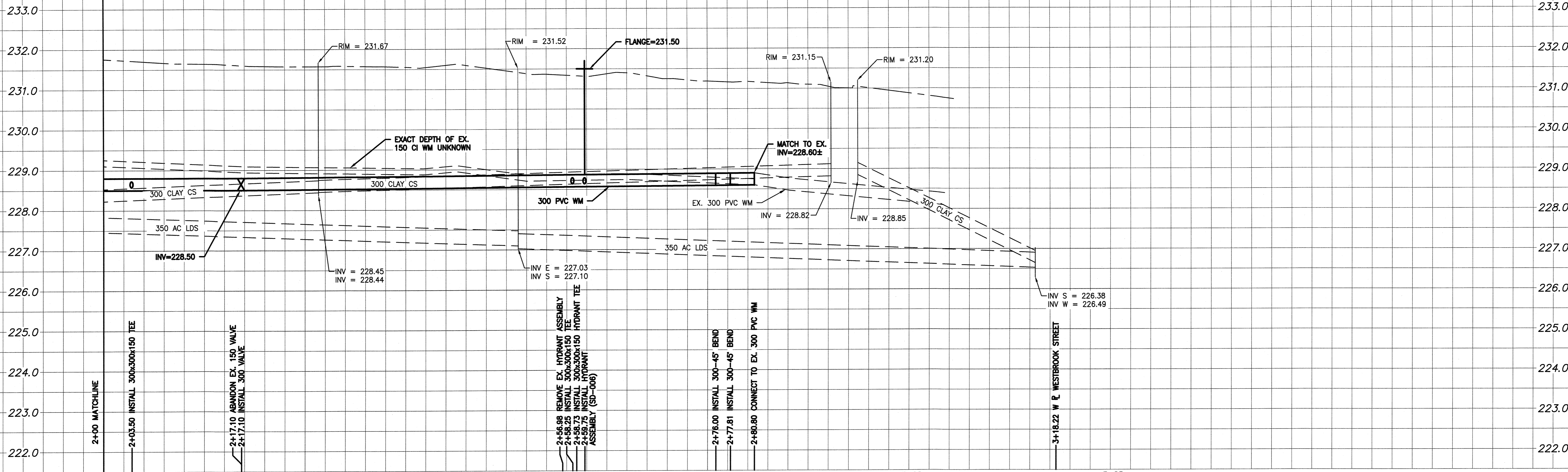

NOTE: CHAINAGES SHOWN ARE ALONG S. R OF PORTAGE AVENUE

ADDRESS	PIPE SIZE & MATERIAL (STREET)	PIPE SIZE & MATERIAL (PROP.)	SHORT & LONG MEASUREMENT	CORP. LOCATION	REMARKS
138 PORTAGE AVE E	20 LEAD	25 COPPER	12.04 E/WBL	0.3 W OF S/C	RENEW TO PL W/ 25 CU
138 PORTAGE AVE E	25 COPPER	25 LEAD	12.35 E/WBL	0.3 W OF S.C.	RECONNECT SERVICE
138 PORTAGE AVE E	25 COPPER	25 LEAD	0.61 W 1ST HYD W WESTBROOK	OPP S.C.	RECONNECT SERVICE
132 PORTAGE AVE E	25 COPPER	25 COPPER	11.74 EWL OF BUILDING	OPP S/C	RECONNECT SERVICE
132 PORTAGE AVE E	25 COPPER	25 COPPER	18.00 WEL BUILDING	OPP S/C	OUTSIDE LIMITS
161 PORTAGE AVE E	150 COPPER	150 COPPER	18.2 WML WESTBROOK	-	RECONNECT SERVICE

* SERVICES TO BE RENEWED TO R

PORTAGE AVENUE

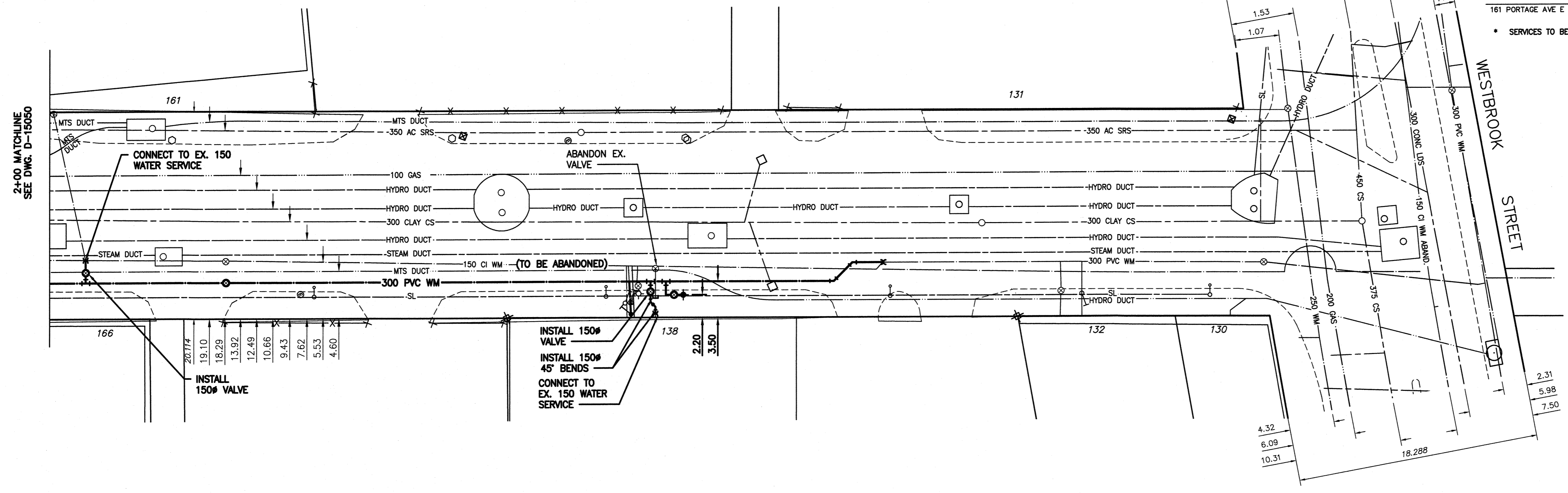

NOTE: VALVES TO BE INSTALLED COUNTERCLOCKWISE TO CLOSE

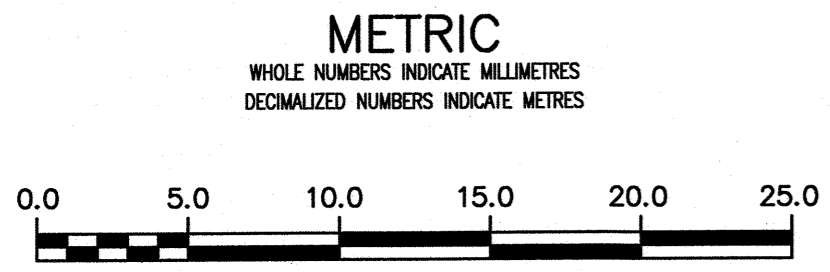

ENGINEERS GEOSCIENTISTS MANITOBA
 Certificate of Authorization
 Stantec Consulting Ltd.
 No. 1301

LOCATION APPROVED UNDERGROUND STRUCTURES

SUPV. U/G STRUCTURES COMMITTEE DATE

NOTE: LOCATION OF UNDERGROUND STRUCTURES AS SHOWN ARE BASED ON THE BEST INFORMATION AVAILABLE BUT NO GUARANTEE IS GIVEN THAT ALL EXISTING UTILITIES ARE SHOWN OR THAT THE GIVEN LOCATIONS ARE EXACT. CONFIRMATION OF EXISTENCE AND EXACT LOCATION OF ALL SERVICES MUST BE OBTAINED FROM THE INDIVIDUAL UTILITIES BEFORE PROCEEDING WITH CONSTRUCTION.

B.M. 35-6 ELEV. 232.063m

74M001 - Chrome Tilt, in Ely, wall of The Richardson Bldg. No. 1 Lombard Place, 4.1 m N. of 50y-Cor. of Bldg.

NO.	ISSUED FOR TENDER	DATE	BY
01	ISSUED FOR TENDER	2018.04.06	RS
	REVISIONS	DATE	BY

Stantec

DESIGNED BY: RS
 CHECKED BY: WB
 DRAWN BY: SG
 APPROVED BY: RS

SCALE: HORIZONTAL 1:250
 VERTICAL 1:50

DATE: 2018 02 26
 PLOT DATE: 2018 04 06

ENGINEER'S SEAL

PROVINCE OF MANITOBA
 APRIL 6/18
 R.M. SHEPLOCK
 NUMBER 24045
 REGISTERED PROFESSIONAL ENGINEER

CONSULTANT DRAWING NUMBER
 C-202

THE CITY OF WINNIPEG
 WATER AND WASTE DEPARTMENT
 ENGINEERING DIVISION

2018 WATERMAIN RENEWALS
 CONTRACT 7
 PORTAGE AVENUE
 105 EEL MAIN STREET TO
 WESTBROOK STREET

SHEET 4 OF 17
 CITY DRAWING NUMBER
 D-15051