

SPOT ELEVATIONS
Scale H-1:200
BANNATYNE AVENUE AT MAIN STREET
NORTH SIDE CURB

ENGINEERS
GEOSCIENTISTS
MANITOBA
Certificate of Authorization
Urban Systems Ltd.
No. 5053

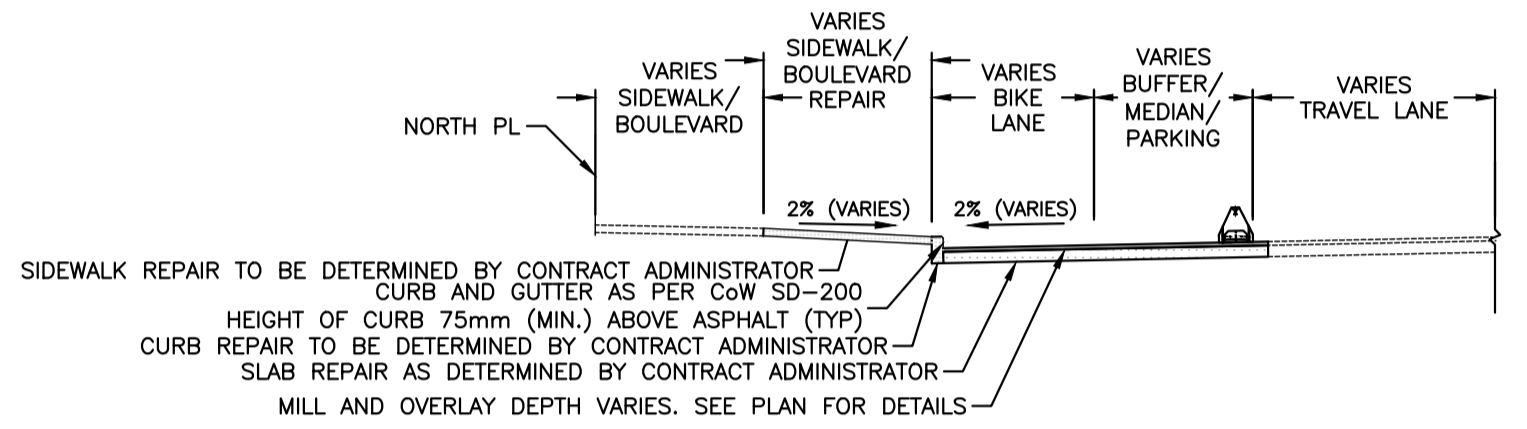

F TYPICAL SECTION
NOT TO SCALE

- GENERAL NOTES:**
- DESIGN GRADES ARE TO BE CONFIRMED ONCE PLANING HAS BEEN COMPLETED.
 - ADJUST VALVES TO MATCH FINAL GRADES.
 - ADJUST PAVEMENT MANHOLE AND CATCH BASIN FRAMES 50mm BELOW FINAL GRADE TO ACCOMMODATE A RISER RING FOR FINAL ASPHALT PAVING OPERATIONS.
 - MAINTAIN TRAFFIC AS OUTLINED IN THE TRAFFIC MANAGEMENT SPECIFICATION.
 - RADI CURB RENEWAL ON INTERSECTING STREETS & BACK LANES TO BE MODIFIED BARRIER CURB AS REQUIRED.
 - CONCRETE REPAIRS TO BE CONFIRMED BY THE CONTRACT ADMINISTRATOR.
 - CURB AND SIDEWALK RENEWAL AS DIRECTED BY THE CONTRACT ADMINISTRATOR.
 - MAINTAIN 25-75mm OF REVEAL ON THE SIGNAL BASES.
 - SEE DWG C22 FOR ADJUSTABLE CURB AND END UNIT DETAILS.

FOR SIGNING AND PAVEMENT MARKING DRAWINGS SEE DWG C23 TO C35

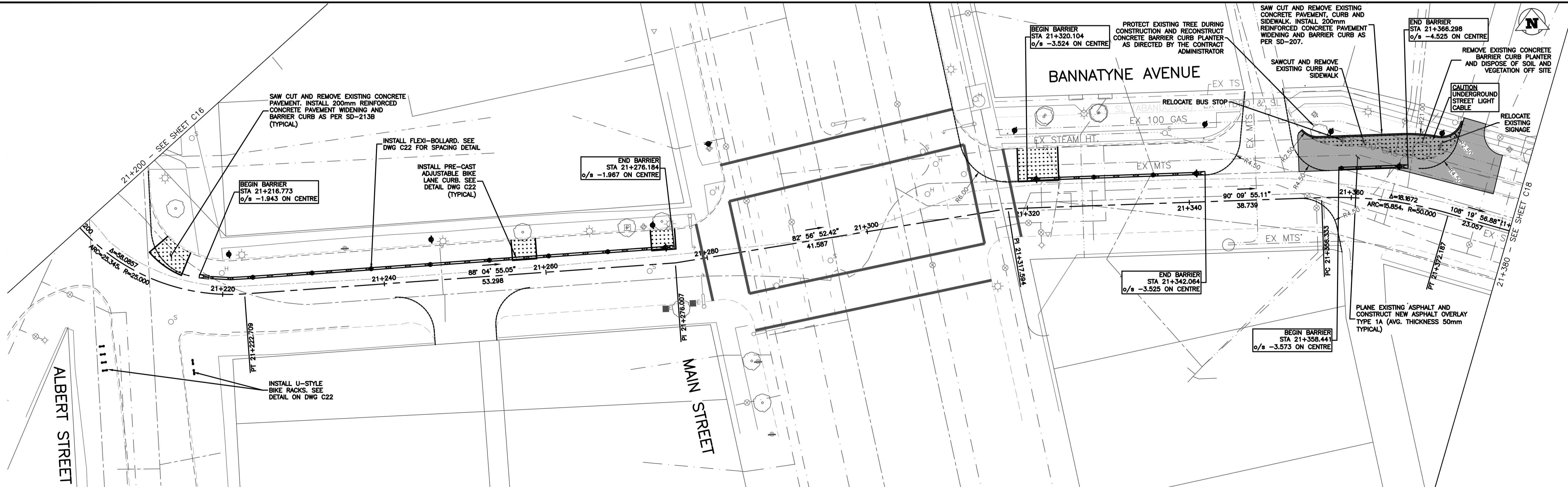

U:\Projects_VAN\3354001101\1D-Design\CAD\PROJ\SET 1\C02-C22-3354001101-PLN.dwg, C17, 2018-03-28 10:13 am mnikolich

150 mm W.M.	WATERMAIN	150 mm W.M.	HYDRO	ADJUSTABLE CURB	LOCATION APPROVED UNDERGROUND STRUCTURES	B.M. ELEV.	<p>URBAN systems</p> <p>DESIGNED BY: M. Nikolich CHECKED BY: G. Smith DRAWN BY: M. Nikolich APPROVED BY: G. Propp HOR. SCALE: 1:250 VERTICAL: 1:25 RELEASSED FOR CONSTRUCTION BY:</p>	<p>ENGINEER'S SEAL</p> <p>NOT FOR CONSTRUCTION</p> <p>CONSULTANT DRAWING NO. 3354.0011.01 C17</p>	<p>THE CITY OF WINNIPEG PUBLIC WORKS DEPARTMENT ENGINEERING DIVISION</p> <p>McDermot Bannatyne Adjustable Bike Lanes Bannatyne Avenue Plan Profile Station 21+200 to 21+380</p>	SHEET 17 OF 36	
300mm L.D.S.	LAND DRAINAGE SEWER	300mm L.D.S.	CONCRETE	ADJUSTABLE END UNIT	A 60% DETAIL DESIGN 2018-01-40 GS	DESIGNED BY: M. Nikolich				APPROVED BY: G. Propp	CAD FILE DRAWING NUMBER C02-C22-3354001101-PLN.DWG
250mm W.W.S.	WASTEWATER SEWER	250mm W.W.S.	ASPHALT	DECORATIVE LIGHT	B 90% DETAIL DESIGN 2018-03-12 GS	CHECKED BY: G. Smith				RELEASSED FOR CONSTRUCTION BY:	CITY DRAWING NUMBER P-3496-17
	MANHOLE		PROPERTY LINE	BOLLARD	C ISSUED FOR TENDER 2018-03-28 GS						
	CATCH BASIN	235.750	SURVEY BAR			NO. REVISIONS	DATE	DATE			
	CURB INLET		ELEVATION (35.750)			DATE	MARCH 28, 2018	DATE			
	JUNCTIONS		TREE								
	CULVERT		SIDEWALK DETECTABLE								
	GAS		CONCRETE SIDEWALK								
EXISTING	LEGEND - PLAN	PROPOSED	EXISTING	LEGEND - PLAN	PROPOSED	EXISTING	LEGEND - PROFILE	PROPOSED			