

PROFILE
Scale H=1:250 V=1:10

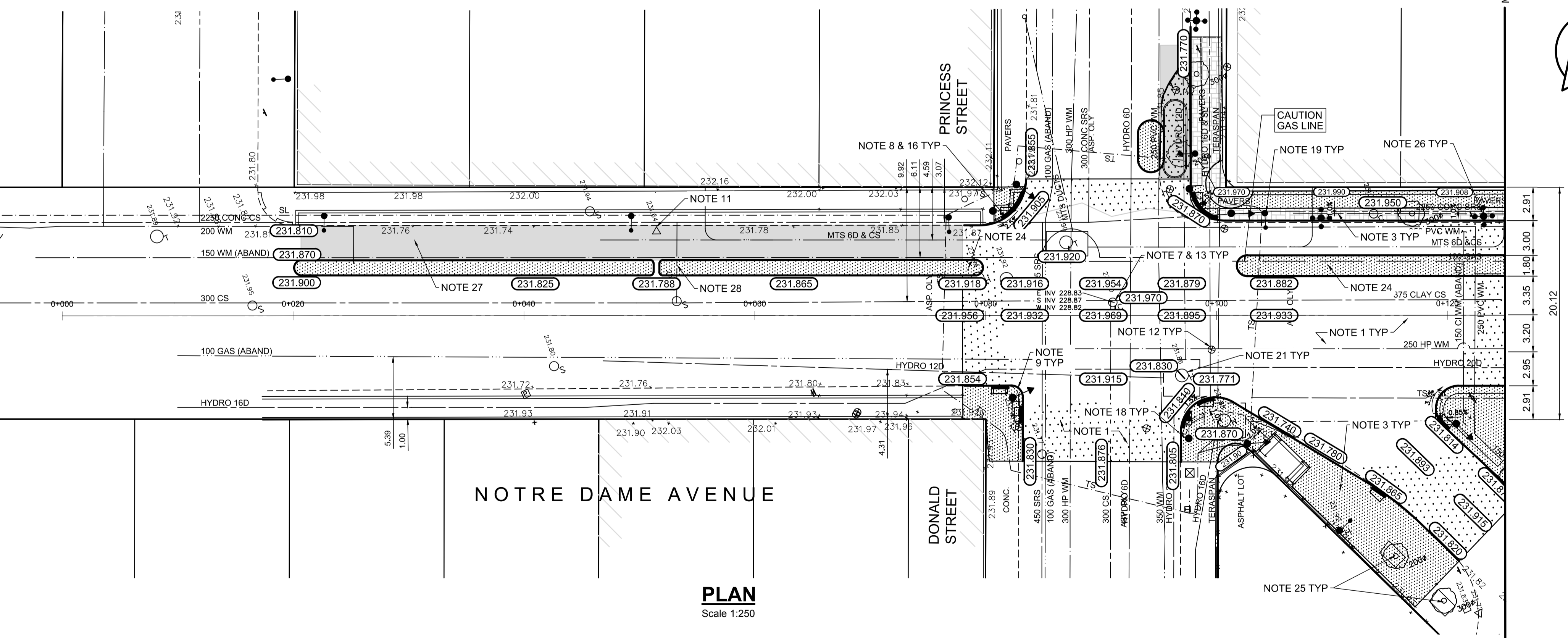

PLAN
Scale 1:250

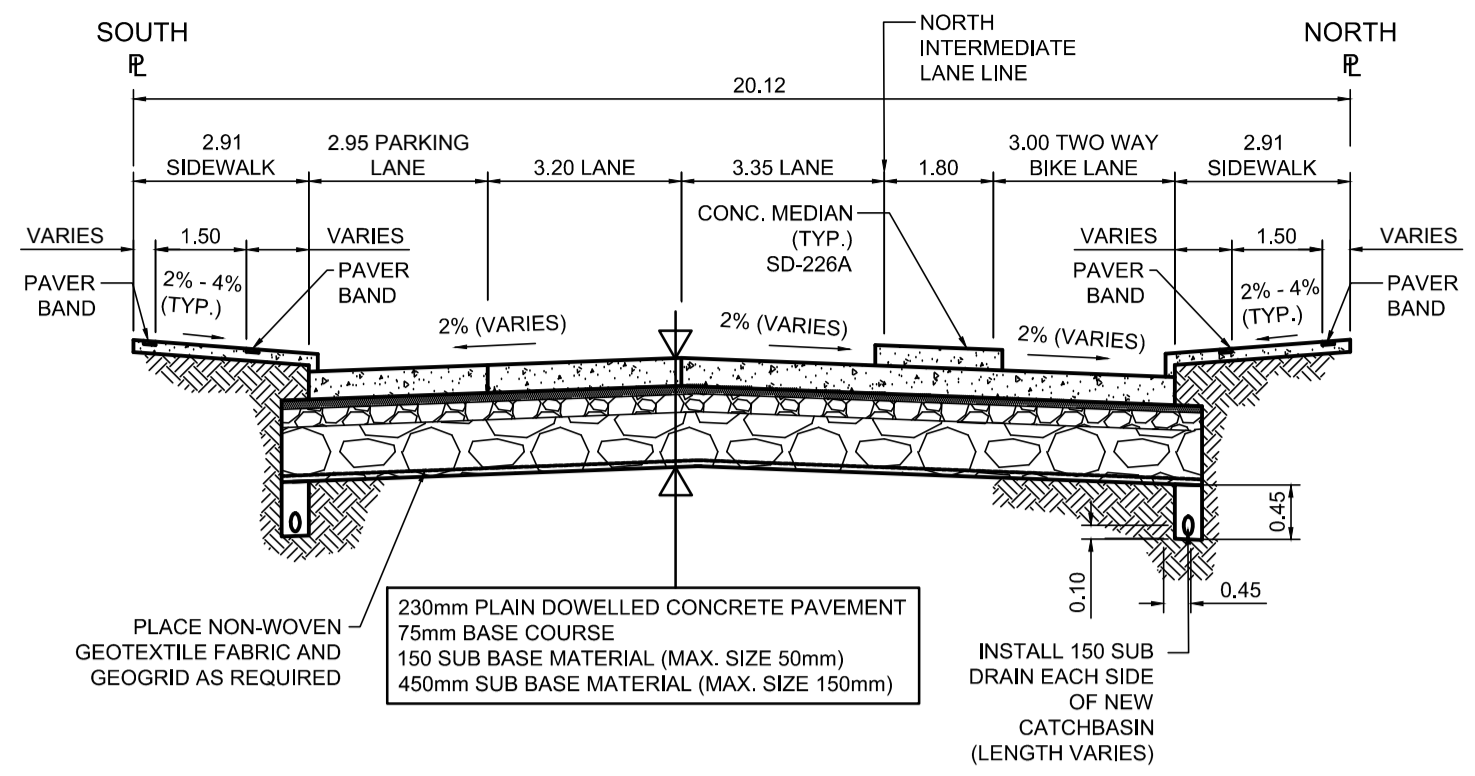

TYPICAL SECTION
Scale NTS

REFERENCE NOTES

- A. PAVEMENT DIMENSIONS ARE TO BACK OF CURB
- B. BASELINE IS PROPOSED CENTRELANE LINE
- C. PROPERTY LINES OBTAINED FROM THE CITY OF WINNIPEG L.B.I.S., AND SCALE FACTOR WAS NOT APPLIED
- D. REFER TO AECOM FIELD BOOK NO. 4987
- E. REFER TO DWGS CT-05 FOR STREETSCAPING ELEMENTS.
- F. CATCH BASIN CONNECTIONS TO SEWER DESIGNED TO MAINTAIN PRE-CONSTRUCTION CAPACITY BY CATCH BASIN LEAD RESTRICTION AS INDICATED ON THE DRAWINGS. ADDITIONAL OR MODIFIED CONNECTIONS TO THE SEWER SYSTEM BEYOND THOSE INDICATED ON THE DRAWINGS REQUIRE REVIEW AND WRITTEN APPROVAL BY THE CONTRACT ADMINISTRATOR.

CONSTRUCTION NOTES

1. REMOVE EXISTING PAVEMENT INCLUDING CONCRETE STREETCAR BEDDING, RAILS AND WOOD TIES, AND CONSTRUCT NEW 230mm PLAIN DOWELED CONCRETE PAVEMENT c/w 180mm BARRIER CURB (SEPARATE)
2. CONSTRUCT NEW 200mm REINFORCED CONCRETE PAVEMENT
3. REMOVE EXISTING CONCRETE SIDEWALK/PAVER STONE SIDEWALK AND CONSTRUCT NEW 100mm SIDEWALK c/w PAVING STONE BANDS (SEE DETAIL 1, CT-43) CONTRACTOR TO SAW CUT AT PROPERTY LINE FULL LENGTH OF PROJECT
4. INSTALL NEW CURB AND GUTTER INLET c/w CATCHBASIN (SD024/SD025), CONNECT NEW 250mm LEAD TO EXISTING LEAD, EXISTING COMBINED SEWER OR MANHOLE
5. REMOVE EXISTING CATCHBASIN AND INSTALL NEW CURB AND GUTTER INLET c/w CATCHBASIN (SD-024/SD-025), CONNECT NEW 250mm LEAD TO EXISTING LEAD, EXISTING COMBINED SEWER OR MANHOLE
6. REMOVE EXISTING CATCHBASIN AND ABANDON EXISTING LEAD
7. REMOVE EXISTING FRAME AND COVER AND INSTALL NEW FRAME AND SOLID COVER (AP-006 & AP-007)
8. CONSTRUCT NEW MONOLITHIC CURB RAMP (10mm HT. INTEGRAL)
9. CONSTRUCT NEW MODIFIED BARRIER CURB (180mm HT. INTEGRAL) AS PER SD-2038 AT ALL STREET/LANE INTERSECTION RADI
10. REMOVE EXISTING CURB AND GUTTER INLET AND LEAD
11. ADJUST EXISTING CATCHBASIN/MANHOLE FRAME AND COVER
12. ADJUST EXISTING WATERMAIN VALVE BOX TO GRADE
13. INSTALL NEW 50mm CAST IRON RISER RING
14. INSTALL 150mm SUBDRAIN 12m ON EACH SIDE OF CATCHBASIN UNLESS OTHERWISE NOTED
15. ADJUST EXISTING CURB STOP TO GRADE
16. INSTALL NEW DETECTABLE SURFACE WARNING TILES
17. PLACE ASPHALT PAVEMENT (TYPE 1A)
18. EXISTING TRAFFIC SIGNALS POLE TO BE RELOCATED (BY OTHERS)
19. EXISTING STREET LIGHT POLE TO BE RELOCATED (BY OTHERS)
20. INSTALL FLOW RESTRICTOR PIPE 200mm PVC SDR 35 CENTER RESTRICTOR PIPE IN CB LEAD (SD-122)
21. ADJUST MANITOBA HYDRO/MTS MANHOLES (BY OTHERS)
22. INSULATE WATER SERVICES UNDER ROADWAY EXCAVATION AS PER (SD-18)
23. REMOVE EXISTING CATCHPIT. INSTALL NEW CURB AND GUTTER INLET c/w CATCH PIT (SD-023) AND CONNECT NEW 250mm LEAD TO NEW CATCH BASIN
24. CONSTRUCT NEW MONOLITHIC CONCRETE MEDIAN
25. PROTECT EXISTING TREE DURING CONSTRUCTION
26. REMOVE, REFURBISH AND REINSTALL STITTSVILLE STREET LIGHTS AS PER SPECIFICATIONS
27. PLANE EXISTING ASPHALT AND CONSTRUCT NEW ASPHALTIC PAVEMENT OVERLY TYPE 1A (AVERAGE THICKNESS 85 mm)
28. PLANE EXISTING ASPHALT AND CONSTRUCT NEW MONOLITHIC CONCRETE MEDIAN



Certificate of Authorization
AECOM Canada Ltd.
No. 4671 Date: _____

METRIC
WHOLE NUMBERS INDICATE MILLIMETRES
DECIMALIZED NUMBERS INDICATE METRES

150 mm W.M.	WATERMAIN	150 mm W.M.	HYDRO	— x —	— x —	— x —	— x —
300mm L.D.S.	LAND DRAINAGE SEWER	300mm L.D.S.	M.T.S.	— x —	— x —	— x —	— x —
250mm W.W.S.	WASTEWATER SEWER	250mm W.W.S.	CONCRETE	— x —	— x —	— x —	— x —
	MANHOLE		ASPHALT	— x —	— x —	— x —	— x —
	CATCH BASIN		PROPERTY LINE	— x —	— x —	— x —	— x —
	CATCH PIT		SURVEY BAR	— x —	— x —	— x —	— x —
	TRAFFIC SIGNAL POLE		ELEVATION (35.750)	— x —	— x —	— x —	— x —
	STREET LIGHT		TREE	— x —	— x —	— x —	— x —
	GAS		SIDEWALK RAMP	— x —	— x —	— x —	— x —
			CONCRETE SIDEWALK	— x —	— x —	— x —	— x —
			FENCE	— x —	— x —	— x —	— x —
EXISTING	LEGEND - PLAN	PROPOSED	EXISTING	LEGEND - PLAN	PROPOSED	EXISTING	LEGEND - PROFILE

LOCATION APPROVED UNDERGROUND STRUCTURES

SUPV. U/G STRUCTURES COMMITTEE DATE

NOTE:
LOCATION OF UNDERGROUND STRUCTURES AS SHOWN ARE BASED ON THE BEST INFORMATION AVAILABLE, BUT NO GUARANTEE IS GIVEN THAT ALL EXISTING UTILITIES ARE SHOWN OR THAT THE GIVEN LOCATIONS ARE EXACT. CONFIRMATION OF EXISTENCE AND EXACT LOCATION OF ALL SERVICES MUST BE OBTAINED FROM THE INDIVIDUAL UTILITIES BEFORE PROCEEDING WITH CONSTRUCTION.

B.M. 38 - 035	S.W. Cor. Notre Dame Ave. & Hargrave St., Tblt. in N. Conc. Road, No. 440 Hargrave St., 1m NW & 0.3 m below Tyndall Stone of N.E. Cor. of Bldg.		
ELEV. 232.286			
NO.	REVISIONS	DATE	BY
0	ISSUED FOR TENDER	2018/02/26	KWR
B	RE-ISSUED FOR REVIEW	2018/01/29	KWR
A	ISSUED FOR REVIEW	2017/11/27	KWR

AECOM

DESIGNED BY: TLF
CHECKED BY: KWR

DRAWN BY: PAAP
APPROVED BY:

HOR. SCALE: 1:250
VERTICAL: 1:10

RELEASED FOR CONSTRUCTION BY:

DATE: 2017/11/27

ENGINEER'S SEAL

PROVINCE OF MANITOBA REGISTERED PROFESSIONAL ENGINEER

T.L. FINDLAY
Member
23820

CONSULTANT DRAWING NO. CT-16

THE CITY OF WINNIPEG
PUBLIC WORKS DEPARTMENT
ENGINEERING DIVISION

DOWNTOWN BIKE LANE SYSTEM AND STREET IMPROVEMENT

PLAN/PROFILE GRADING PLAN
NOTRE DAME AVENUE
ADELAIDE STREET TO STATION 0+125

CITY DRAWING NUMBER P-3495-16
SHEET 16 OF 45