

PROFILE
Scale H=1:250 V=1:10

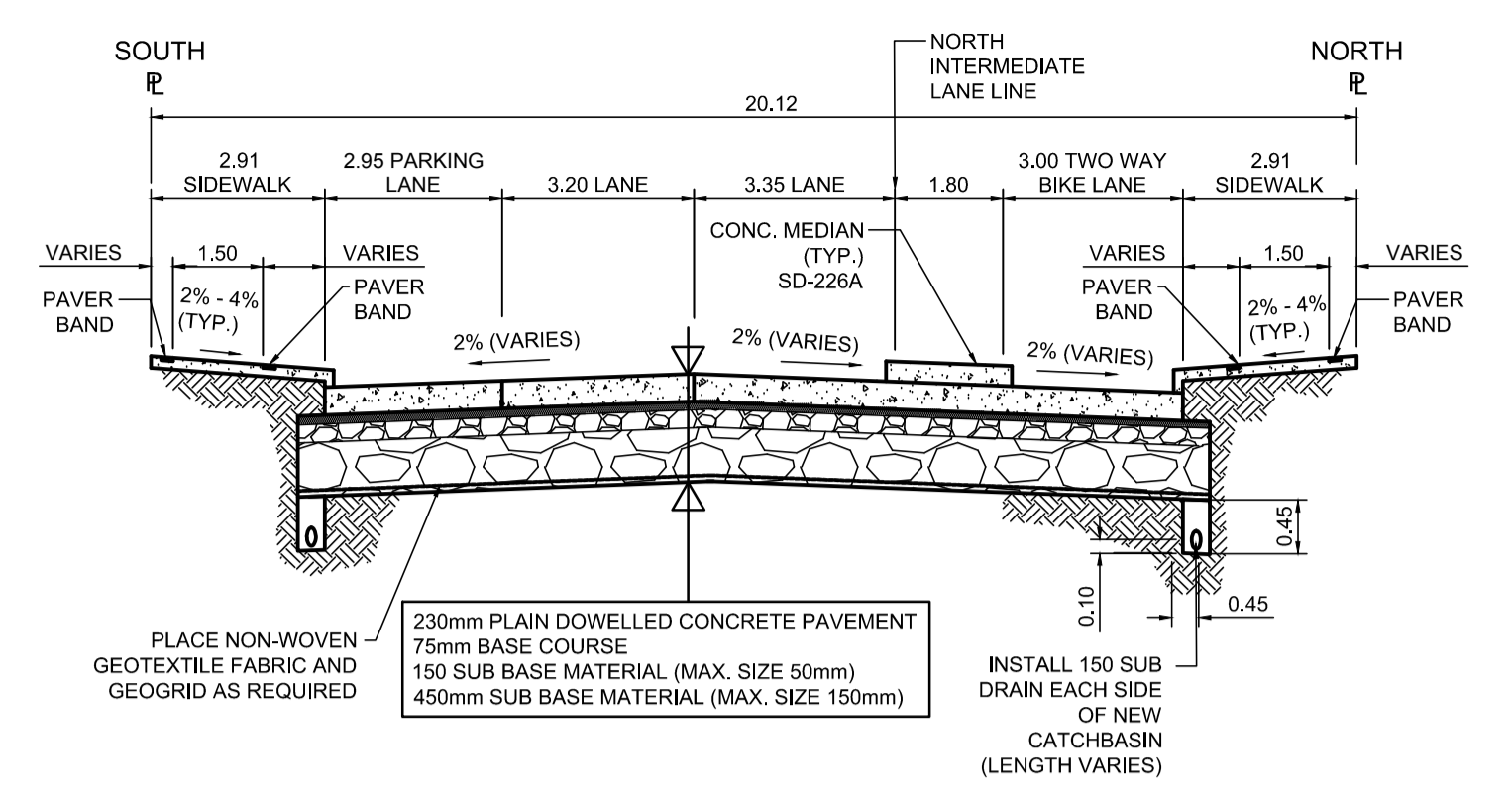

TYPICAL SECTION
Scale NTS

DESCRIPTION	RIM ELEV.	INVERT				CONNECTION	LEAD
		EAST	WEST	NORTH	SOUTH		
CB05	231.689			230.090	228.00±	375 CLAY CS	7.0m-2500 @ 2% Min
CB06	231.710			231.130	227.75±	600 CS	2.0m-2500 @ 2% Min
CP02A	231.600				230.600	NEW CB	5.0m DRAIN CONN. PIPE
CB07	231.730			231.130		EX. LEAD	
CP02	231.520				230.520	NEW CB	1.0m DRAIN CONN. PIPE

REFERENCE NOTES

- PAVEMENT DIMENSIONS ARE TO BACK OF CURB
- BASELINE IS PROPOSED CENTRELINE
- PROPERTY LINES OBTAINED FROM THE CITY OF WINNIPEG L.B.I.S., AND SCALE FACTOR WAS NOT APPLIED
- REFER TO AECOM FIELD BOOK NO. 4987
- REFER TO DWGS CT-39 FOR STREETSCAPING ELEMENTS.
- CATCH BASIN CONNECTIONS TO SEWER DESIGNED TO MAINTAIN PRE-CONSTRUCTION CAPACITY BY CATCH BASIN LEAD RESTRICTION AS INDICATED ON THE DRAWINGS. ADDITIONAL OR MODIFIED CONNECTIONS TO THE SEWER SYSTEM BEYOND THOSE INDICATED ON THE DRAWINGS REQUIRE REVIEW AND WRITTEN APPROVAL BY THE CONTRACT ADMINISTRATOR.

CONSTRUCTION NOTES

- REMOVE EXISTING PAVEMENT INCLUDING CONCRETE STREETCAR BEDDING, RAILS AND WOOD TIES, AND CONSTRUCT NEW 230mm PLAIN DOWELLED CONCRETE PAVEMENT c/w 180mm BARRIER CURB (SEPARATE)
- CONSTRUCT NEW 200mm REINFORCED CONCRETE PAVEMENT
- REMOVE EXISTING CONCRETE SIDEWALK/PAVER STONE SIDEWALK AND CONSTRUCT NEW 100mm SIDEWALK c/w PAVING STONE BANDS (SEE DETAIL 1, CT-43) CONTRACTOR TO SAW CUT AT PROPERTY LINE FULL LENGTH OF PROJECT
- INSTALL NEW CURB AND GUTTER INLET c/w CATCHBASIN (SD024/SD025). CONNECT NEW 250mm LEAD TO EXISTING LEAD, EXISTING COMBINED SEWER OR MANHOLE
- REMOVE EXISTING CATCHBASIN AND INSTALL NEW CURB AND GUTTER INLET c/w CATCHBASIN (SD-024/SD-025). CONNECT NEW 250mm LEAD TO EXISTING LEAD, EXISTING COMBINED SEWER OR MANHOLE
- REMOVE EXISTING CATCHBASIN AND ABANDON EXISTING LEAD
- REMOVE EXISTING FRAME AND COVER AND INSTALL NEW FRAME AND SOLID COVER (AP-006 & AP-007)
- CONSTRUCT NEW MONOLITHIC CURB RAMP (10mm HT. INTEGRAL)
- CONSTRUCT NEW MODIFIED BARRIER CURB (180mm HT. INTEGRAL) AS PER SD-203B AT ALL STREET/LANE INTERSECTION RADII
- REMOVE EXISTING CURB AND GUTTER INLET AND LEAD
- ADJUST EXISTING CATCHBASIN/MANHOLE FRAME AND COVER
- ADJUST EXISTING WATERMAIN VALVE BOX TO GRADE
- INSTALL NEW 50mm CAST IRON RISER RING
- INSTALL 150mm SUB-DRAIN 12m ON EACH SIDE OF CATCHBASIN UNLESS OTHERWISE NOTED
- ADJUST EXISTING CURB STOP TO GRADE
- INSTALL NEW DETECTABLE SURFACE WARNING TILES
- PLACE ASPHALT PAVEMENT (TYPE 1A)
- EXISTING TRAFFIC SIGNALS POLE TO BE RELOCATED (BY OTHERS)
- EXISTING STREET LIGHT POLE TO BE RELOCATED (BY OTHERS)
- INSTALL FLOW RESTRICTOR PIPE 200mm PVC SDR 35 CENTER RESTRICTOR PIPE IN CB LEAD (SD-122)
- ADJUST MANITOBA HYDRO/ MTS MANHOLES (BY OTHERS)
- INSULATE WATER SERVICES UNDER ROADWAY EXCAVATION AS PER (SD-18)
- REMOVE EXISTING CATCHPIT. INSTALL NEW CURB AND GUTTER INLET c/w CATCH PIT (SD-023) AND CONNECT NEW 250mm LEAD TO NEW CATCH BASIN
- CONSTRUCT NEW MONOLITHIC CONCRETE MEDIAN
- PROTECT EXISTING TREE DURING CONSTRUCTION
- REMOVE, REFURBISH AND REINSTALL STITTSVILLE STREET LIGHTS AS PER SPECIFICATIONS
- REMOVE AND REFURBISH STITTSVILLE STREET LIGHTS AND RETURN TO CITY OF WINNIPEG
- INSTALL NEW CURB AND GUTTER INLET c/w CATCHPIT (SD-023) AND CONNECT NEW 250mm LEAD TO NEW CATCHBASIN
- AREAWAY TO BE ABANDONED BY PROPERTY OWNER PRIOR TO CONSTRUCTION
- REGRADE EXISTING PAVERS 2.0m FOR CURB

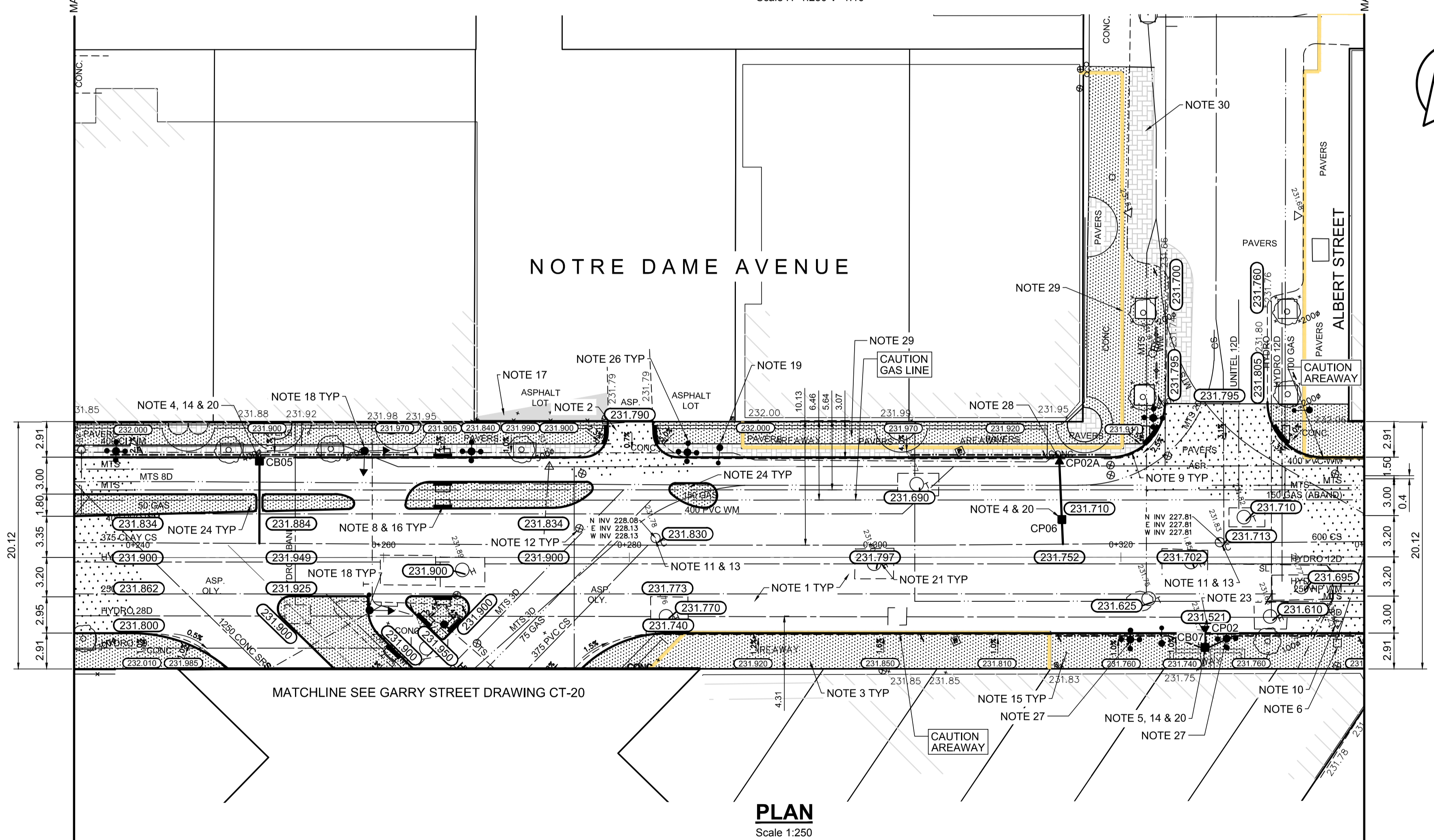

PLAN
Scale 1:250

150 mm W.M.	150 mm W.M.	300mm L.D.S.	250mm W.W.S.	HYDRO	M.T.S.	CONCRETE	ASPHALT	PROPERTY LINE	SURVEY BAR	ELEVATION	(35.750)	TREE	SIDEWALK RAMP	CONCRETE SIDEWALK	FENCE	LEGEND - PLAN	PROPOSED	EXISTING	LEGEND - PROFILE	PROPOSED	EXISTING
○	○	○	○	○	○	○	○	○	○	○	○	○	○	○	○	○	○	○	○	○	○
○	○	○	○	○	○	○	○	○	○	○	○	○	○	○	○	○	○	○	○	○	○
○	○	○	○	○	○	○	○	○	○	○	○	○	○	○	○	○	○	○	○	○	○
○	○	○	○	○	○	○	○	○	○	○	○	○	○	○	○	○	○	○	○	○	○

LOCATION APPROVED UNDERGROUND STRUCTURES

DATE

NOTE:
LOCATION OF UNDERGROUND STRUCTURES AS SHOWN ARE BASED ON THE BEST INFORMATION AVAILABLE, BUT NO GUARANTEE IS GIVEN THAT ALL EXISTING UTILITIES ARE SHOWN OR THAT THE GIVEN LOCATIONS ARE EXACT. CONFIRMATION OF EXISTENCE AND EXACT LOCATION OF ALL SERVICES MUST BE OBTAINED FROM THE INDIVIDUAL UTILITIES BEFORE PROCEEDING WITH CONSTRUCTION.

NO.	REVISIONS	DATE	BY
0	ISSUED FOR TENDER	2018/02/26	KWR
B	RE-ISSUED FOR REVIEW	2018/01/29	KWR
A	ISSUED FOR REVIEW	2017/11/27	KWR

AECOM

DESIGNED BY: TLF
CHECKED BY: KWR
DRAWN BY: PAAP
APPROVED BY: [Signature]
HOR. SCALE: 1:250
VERTICAL: 1:10
RELEASED FOR CONSTRUCTION BY: [Signature]
DATE: 2017/11/27

ENGINEER'S SEAL

PROVINCE OF MANITOBA
REGISTERED PROFESSIONAL ENGINEER
T.L. FINDLAY
Member
23820

THE CITY OF WINNIPEG
PUBLIC WORKS DEPARTMENT
ENGINEERING DIVISION

DOWNTOWN BIKE LANE SYSTEM
AND STREET IMPROVEMENT

PLAN/PROFILE GRADING PLAN
NOTRE DAME AVENUE
STATION 0+235 TO STATION 0+340

CITY DRAWING NUMBER: P-3495-18
SHEET 18 OF 45

AECOM
Certificate of Authorization
AECOM Canada Ltd.
No. 4671 Date: _____

METRIC
WHOLE NUMBERS INDICATE MILLIMETRES
DECIMALIZED NUMBERS INDICATE METRES