

PROFILE
Scale H=1:250 V=1:10

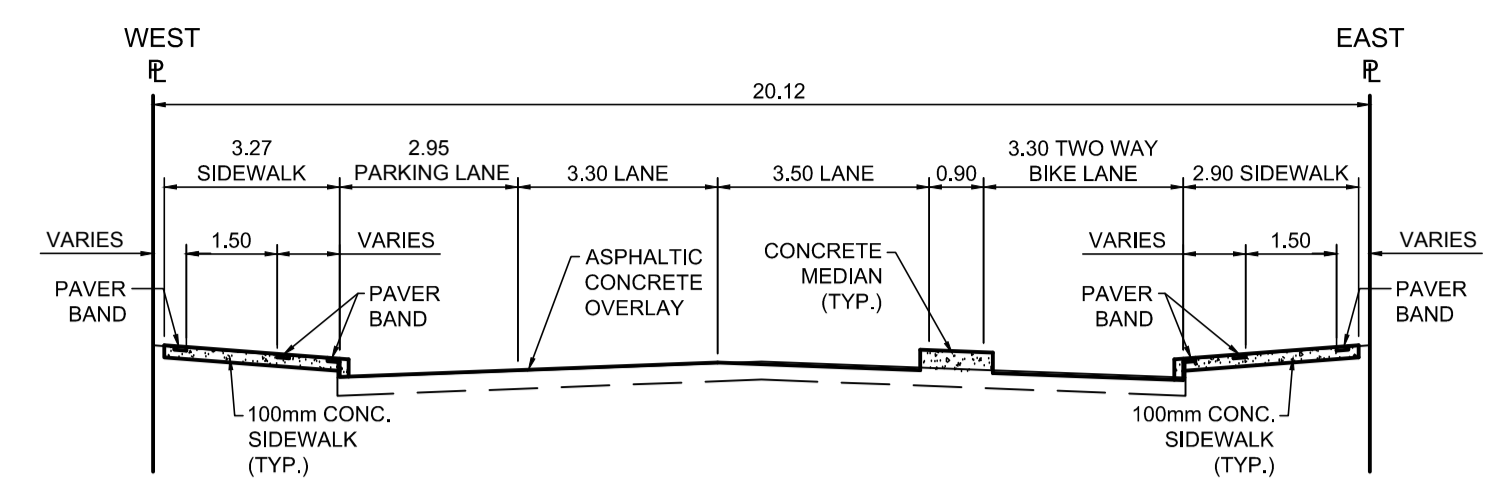

TYPICAL SECTION
Scale NTS

DESCRIPTION	RIM ELEV.	INVERT			CONNECTION	LEAD
		EAST	WEST	NORTH		
CB19	231.770		230.120		228.015±	375CS
CB20	231.650		230.00			EX. LEAD
CB21	231.630		230.630			EX. LEAD

- REFERENCE NOTES**
- PAVEMENT DIMENSIONS ARE TO BACK OF CURB
 - BASELINE IS CENTRELINE OF RIGHT-OF-WAY
 - PROPERTY LINES OBTAINED FROM THE CITY OF WINNIPEG L.B.I.S., AND SCALE FACTOR WAS APPLIED
 - REFER TO AECOM FIELD BOOK NO. 4987
 - REFER TO DWGS CT-41 FOR STREETSCAPING ELEMENTS.
 - CATCH BASIN CONNECTIONS TO SEWER DESIGNED TO MAINTAIN PRE-CONSTRUCTION CAPACITY BY CATCH BASIN LEAD RESTRICTION AS INDICATED ON THE DRAWINGS. ADDITIONAL OR MODIFIED CONNECTIONS TO THE SEWER SYSTEM BEYOND THOSE INDICATED ON THE DRAWINGS REQUIRE REVIEW AND WRITTEN APPROVAL BY THE CONTRACT ADMINISTRATOR.

- CONSTRUCTION NOTES:**
- PLANE EXISTING ASPHALT AND CONSTRUCT NEW ASPHALTIC PAVEMENT OVERLAY TYPE 1A (AVERAGE THICKNESS 85mm)
 - PLANE EXISTING ASPHALT AND CONSTRUCT NEW ASPHALTIC PAVEMENT OVERLAY (AVERAGE THICKNESS 50mm)
 - REMOVE EXISTING CONCRETE SIDEWALK AND CONSTRUCT NEW 100mm SIDEWALK c/w PAVING STONE BAND (SEE DETAIL 2, CT-43)
 - RENEW EXISTING MONOLITHIC CURB RAMP (100mm HT. INTEGRAL)
 - CONSTRUCT NEW MODIFIED BARRIER CURB (100mm AVG. HT. REVEAL SEPARATE)
 - REMOVE EXISTING BARRIER CURB
 - RENEW EXISTING BARRIER CURB (100mm AVG. HT. REVEAL)
 - ADJUST EXISTING CATCH BASIN/MANHOLE TO GRADE
 - REMOVE EXISTING FRAME AND COVER AND PLACED NEW FRAME AND COVER (AP-004 AND AP-005)
 - INSTALL NEW CAST IRON RING
 - INSTALL NEW DETECTABLE SURFACE WARNING TILES
 - ADJUST MTS MANHOLE FRAME AND COVER c/w 50mm CAST IRON RISER RING (BY OTHERS)
 - ADJUST EXISTING HYDRO MANHOLE (BY OTHERS)
 - ADJUST EXISTING CURB STOP TO GRADE
 - INSTALL VALVE BOX EXTENSION
 - REMOVE EXISTING CATCHBASIN AND CURB INLET
 - REMOVE EXISTING CATCHBASIN AND INSTALL NEW CURB AND GUTTER INLET c/w CATCHBASIN (SD-024) AND CONNECT TO EXISTING LEAD/CATCHBASIN
 - REGRADE EXISTING PAVING STONES
 - REMOVE EXISTING CONCRETE PAVEMENT AND CONSTRUCT NEW 200mm REINFORCED CONCRETE PAVEMENT c/w 50mm TYPE 1A ASPHALT OVERLAY
 - CONSTRUCT NEW BARRIER CURB (100mm AVERAGE HEIGHT REVEALS, SEPARATE)
 - REMOVE EXISTING PARKING PAY STATION (BY OTHERS)
 - CONSTRUCT NEW MONOLITHIC CONCRETE MEDIAN
 - REMOVE EXISTING CURB INLET
 - ADJUST EXISTING CURB & GUTTER INLET TO GRADE
 - REMOVE AND SALVAGE EXISTING BIKE RACK
 - INSTALL NEW CURB & GUTTER INLET c/w CATCHBASIN (SD-024) AND CONNECT TO EXIST. 375CS
 - REMOVE PAVEMENT AS REQUIRED AND PLACE ASPHALT PATCH
 - REPAIR 3.0m OF 250mmØ C.B. LEAD

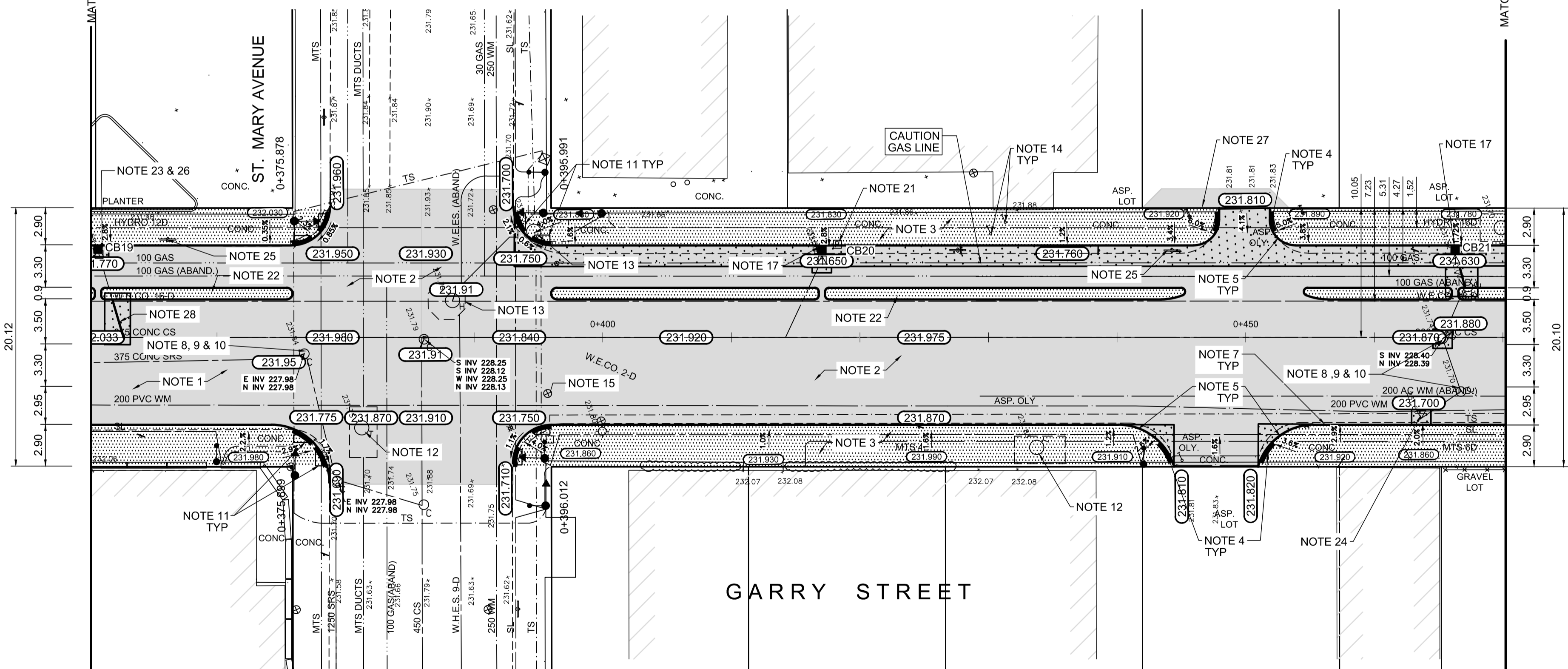

PLAN
Scale 1:250

EXISTING	LEGEND - PLAN	PROPOSED	EXISTING	LEGEND - PLAN	PROPOSED	EXISTING	LEGEND - PROFILE	PROPOSED
150 mm W.M.	WATERMAIN	150 mm W.M.	HYDRO	M.T.S.	— x —	— x —	PROFILE	— x —
300mm L.D.S.	LAND DRAINAGE SEWER	300mm L.D.S.	CONCRETE	CONCRETE	— □ —	— □ —	WEST GUTTER	— □ —
250mm W.W.S.	WASTEWATER SEWER	250mm W.W.S.	ASPHALT	ASPHALT	— ○ —	— ○ —	EAST GUTTER	— ○ —
□	MANHOLE	□	PROPERTY LINE	PROPERTY LINE	— — —	— — —	N/W PROPERTY LINE	— — —
□	CATCH BASIN	□	SURVEY BAR	SURVEY BAR	— — —	— — —	S/E PROPERTY LINE	— — —
▽	CATCH PIT	▽	ELEVATION	ELEVATION	(35.750)	(35.750)		
↑	TRAFFIC SIGNAL POLE	↑	TREE	TREE	— ○ —	— ○ —		
↑	STREET LIGHT	↑	SIDEWALK RAMP	SIDEWALK RAMP	— — —	— — —		
—	GAS	—	CONCRETE SIDEWALK	CONCRETE SIDEWALK	— — —	— — —		
—		—	FENCE	FENCE	— — —	— — —		

LOCATION APPROVED UNDERGROUND STRUCTURES

SUPV. U/G STRUCTURES COMMITTEE DATE

NOTE:
LOCATION OF UNDERGROUND STRUCTURES AS SHOWN ARE BASED ON THE BEST INFORMATION AVAILABLE. BUT NO GUARANTEE IS GIVEN THAT ALL EXISTING UTILITIES ARE SHOWN OR THAT THE GIVEN LOCATIONS ARE EXACT. CONFIRMATION OF EXISTENCE AND EXACT LOCATION OF ALL SERVICES MUST BE OBTAINED FROM THE INDIVIDUAL UTILITIES BEFORE PROCEEDING WITH CONSTRUCTION.

NO.	REVISIONS	DATE	BY
0	ISSUED FOR TENDER	2018/02/26	KWR
B	RE-ISSUED FOR REVIEW	2018/01/29	KWR
A	ISSUED FOR REVIEW	2017/11/27	KWR

B.M. 38 - 035 ELEV. 232.286	S.W. Cor. Notre Dame Ave. & Hargrave St., Tblt. in N. Cor. Round. No. 440 Hargrave St., 1m W. & 0.3 m below Tyndall Stone of N.E. Cor. of Bldg.
DESIGNED BY	KWR
CHECKED BY	KWR
DRAWN BY	PAAP
APPROVED BY	
HOR. SCALE:	1:250
VERTICAL:	1:10
RELEASED FOR CONSTRUCTION BY:	
CONSULTANT DRAWING NO.	CT-24
DATE	2017/11/27

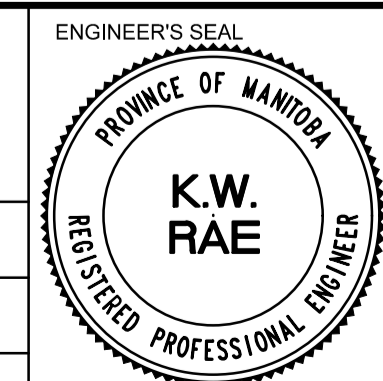

THE CITY OF WINNIPEG
PUBLIC WORKS DEPARTMENT
ENGINEERING DIVISION

DOWNTOWN BIKE LANE SYSTEM AND STREET IMPROVEMENT

PLAN/PROFILE GRADING PLAN
GARRY STREET
STATION 0+360 TO STATION 0+470

CITY DRAWING NUMBER P-3495-24
SHEET 24 OF 45

AECOM
Certificate of Authorization
AECOM Canada Ltd.
No. 4671 Date: _____

METRIC
WHOLE NUMBERS INDICATE MILLIMETRES
DECIMALIZED NUMBERS INDICATE METRES