

**PROFILE**  
Scale H=1:250 V=1:10

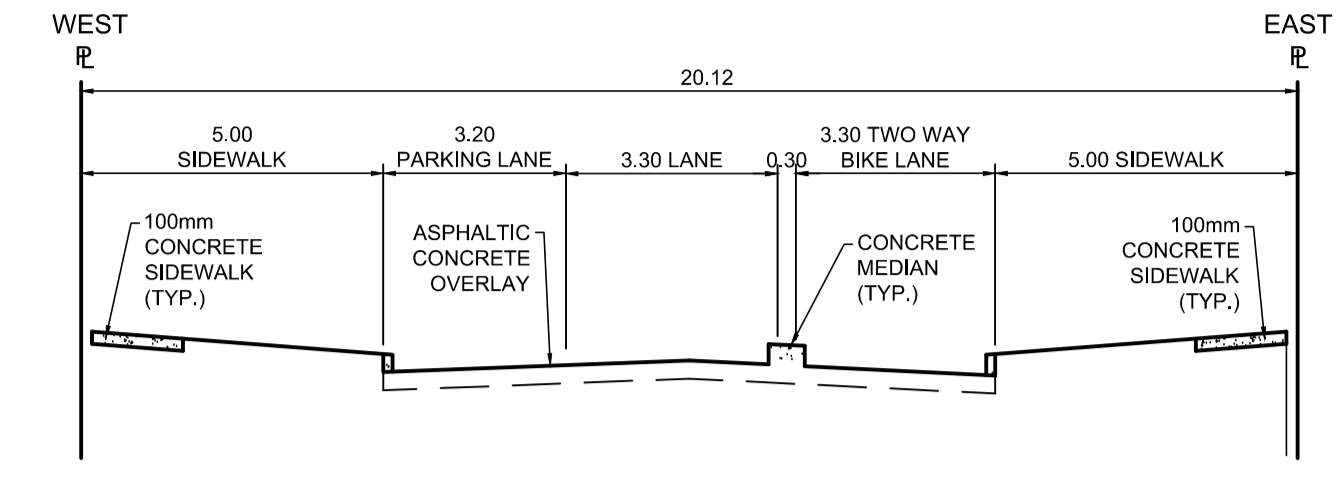

**TYPICAL SECTION**  
Scale NTS

DESCRIPTION	RIM ELEV.	INVERT				CONNECTION	LEAD
		EAST	WEST	NORTH	SOUTH		
CP05	231.870			230.870	230.870	EX. CB	2.0m-DRAIN CONN. PIPE
CB26	231.800		230.15			228.05±	375 CS 7.5m-2500 @ 2% Min
CB27	231.850	230.20				228.05±	375 CS 7.0m-2500 @ 2% Min

**REFERENCE NOTES**

- A. PAVEMENT DIMENSIONS ARE TO BACK OF CURB
- B. BASELINE IS CENTRELINE OF RIGHT-OF-WAY
- C. PROPERTY LINES OBTAINED FROM THE CITY OF WINNIPEG L.B.I.S., AND SCALE FACTOR WAS APPLIED
- D. REFER TO AECOM FIELD BOOK NO. 4987
- E. REFER TO DWGS CT-41 FOR STREETSCAPING ELEMENTS
- F. CATCH BASIN CONNECTIONS TO SEWER DESIGNED TO MAINTAIN PRE-CONSTRUCTION CAPACITY BY CATCH BASIN LEAD RESTRICTION AS INDICATED ON THE DRAWINGS. ADDITIONAL OR MODIFIED CONNECTIONS TO THE SEWER SYSTEM BEYOND THOSE INDICATED ON THE DRAWINGS REQUIRE REVIEW AND WRITTEN APPROVAL BY THE CONTRACT ADMINISTRATOR.

**CONSTRUCTION NOTES:**

1. PLANE EXISTING ASPHALT AND CONSTRUCT NEW ASPHALTIC PAVEMENT OVERLAY TYPE 1A (AVERAGE THICKNESS 85mm)
2. PLANE EXISTING ASPHALT AND CONSTRUCT NEW ASPHALTIC PAVEMENT OVERLAY (AVERAGE THICKNESS 50mm)
3. REMOVE EXISTING CONCRETE SIDEWALK AND CONSTRUCT NEW 100mm SIDEWALK c/w PAVING STONE BAND (SEE DETAIL 2, CT-43)
4. RENEW EXISTING MONOLITHIC CURB RAMP (10mm HT. INTEGRAL)
5. CONSTRUCT NEW MODIFIED BARRIER CURB (125mm AVG. HT. REVEAL SEPARATE)
6. REMOVE EXISTING BARRIER CURB
7. RENEW EXISTING BARRIER CURB (125mm AVG. HT. REVEAL)
8. ADJUST EXISTING CATCH BASIN/MANHOLE TO GRADE
9. REMOVE EXISTING FRAME AND COVER AND PLACED NEW FRAME AND COVER (AP-004 AND AP-005)
10. INSTALL NEW CAST IRON RISER RING
11. INSTALL NEW DETECTABLE SURFACE WARNING TILES
12. ADJUST MTS MANHOLE FRAME AND COVER c/w 50mm CAST IRON RISER RING (BY OTHERS)
13. ADJUST EXISTING HYDRO MANHOLE (BY OTHERS)
14. ADJUST EXISTING CURB STOP TO GRADE
15. INSTALL VALVE BOX EXTENSION
16. REMOVE EXISTING CATCHBASIN AND CURB INLET
17. REMOVE EXISTING CURB INLET AND INSTALL NEW CURB AND GUTTER INLET c/w CATCHPIT (SD-024) AND CONNECT TO EXISTING CATCHBASIN
18. REGRADE EXISTING PAVING STONES
19. REMOVE EXISTING PAVEMENT AND CONSTRUCT NEW 200mm REINFORCED CONCRETE PAVEMENT c/w 85mm TYPE 1A ASPHALT OVERLAY
20. CONSTRUCT NEW MONOLITHIC CONCRETE MEDIAN
21. CONSTRUCT NEW MONOLITHIC CONCRETE MEDIAN WITH MOUNTABLE CURB
22. RENEW EXISTING BARRIER CURB (180mm AVG. HT. REVEAL)
23. REMOVE EXISTING PAVING STONES AND REINSTALL ON LEAN CONCRETE BASE
24. REMOVE EXIST. CATCHBASIN AND ABANDON EXIST. LEAD.
25. INSTALL NEW CURB AND GUTTER INLET c/w CATCHBASIN (SD-024) AND CONNECT TO EXIST. SEWER
26. REMOVE EXIST. CURB INLET.

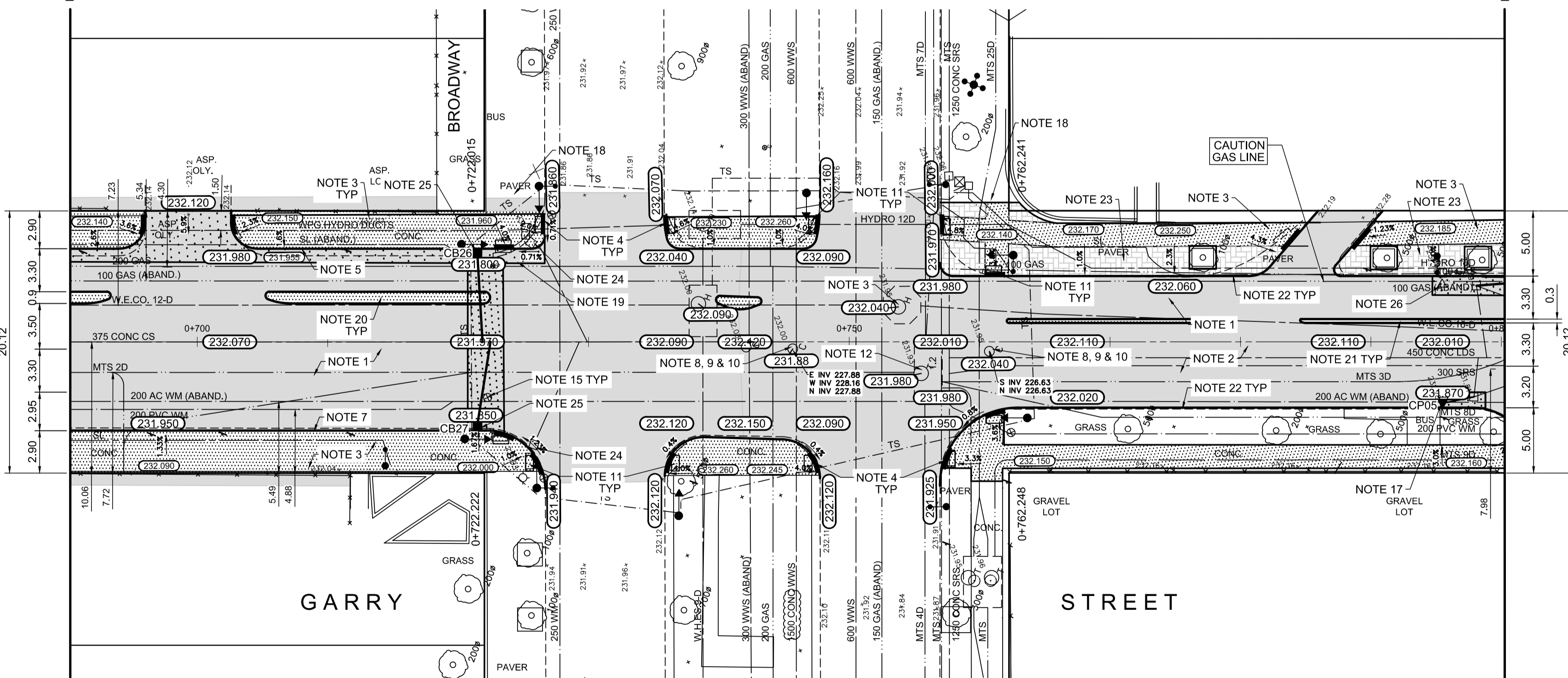

**PLAN**  
Scale 1:250

EXISTING	LEGEND - PLAN	PROPOSED	EXISTING	LEGEND - PLAN	PROPOSED	EXISTING	LEGEND - PROFILE	PROPOSED
150mm W.M.	WATERMAIN	150mm W.M.	HYDRO	PROPERTY LINE	PROPERTY LINE	---	---	---
Hydrant	HYDRANT	Hydrant	M.T.S.	SURVEY BAR	SURVEY BAR	---	---	---
Valve	VALVE	Valve	CONCRETE	ELEVATION	ELEVATION	(35.750)	(35.750)	(35.750)
300mm L.D.S.	LAND DRAINAGE SEWER	300mm L.D.S.	ASPHALT	TREE	TREE	---	---	---
250mm W.W.S.	WASTEWATER SEWER	250mm W.W.S.	PROPERTY LINE	SIDEWALK RAMP	SIDEWALK RAMP	---	---	---
Manhole	MANHOLE	Manhole	SURVEY BAR	CONCRETE SIDEWALK	CONCRETE SIDEWALK	---	---	---
Catch Basin	CATCH BASIN	Catch Basin	ELEVATION	FENCE	FENCE	---	---	---
Catch Pit	CATCH PIT	Catch Pit	TREE					
Traffic Signal Pole	TRAFFIC SIGNAL POLE	Traffic Signal Pole	SIDEWALK RAMP					
Street Light	STREET LIGHT	Street Light	CONCRETE SIDEWALK					
Gas	GAS	Gas	FENCE					

**LOCATION APPROVED UNDERGROUND STRUCTURES**

SUPV. U/G STRUCTURES COMMITTEE DATE

**NOTE:**  
LOCATION OF UNDERGROUND STRUCTURES AS SHOWN ARE BASED ON THE BEST INFORMATION AVAILABLE, BUT NO GUARANTEE IS GIVEN THAT ALL EXISTING UTILITIES ARE SHOWN OR THAT THE GIVEN LOCATIONS ARE EXACT. CONFIRMATION OF EXISTENCE AND EXACT LOCATION OF ALL SERVICES MUST BE OBTAINED FROM THE INDIVIDUAL UTILITIES BEFORE PROCEEDING WITH CONSTRUCTION.

NO.	REVISIONS	DATE	BY
0	ISSUED FOR TENDER	2018/02/26	KWR
B	RE-ISSUED FOR REVIEW	2018/01/29	KWR
A	ISSUED FOR REVIEW	2017/11/27	KWR

DESIGNED BY	CHECKED BY	APPROVED BY	RELEASED FOR CONSTRUCTION BY:
KWR	KWR	KWR	
PAAP			

HOR. SCALE: 1:250  
VERTICAL: 1:10

DATE: 2017/11/27

ENGINEER'S SEAL

PROVINCE OF MANITOBA

**K.W. RAE**

REGISTERED PROFESSIONAL ENGINEER

CONSULTANT DRAWING NO. CT-27

**THE CITY OF WINNIPEG**

Winnipeg PUBLIC WORKS DEPARTMENT ENGINEERING DIVISION

DOWNTOWN BIKE LANE SYSTEM AND STREET IMPROVEMENT

PLAN/PROFILE GRADING PLAN  
GARRY STREET  
STATION 0+690 TO STATION 0+800

CITY DRAWING NUMBER P-3495-27  
SHEET 27 OF 45

**AECOM**

Certificate of Authorization  
AECOM Canada Ltd.  
No. 4671 Date: \_\_\_\_\_

**METRIC**

WHOLE NUMBERS INDICATE MILLIMETRES  
DECIMALIZED NUMBERS INDICATE METRES