

LANDSCAPE LEGEND

- TOPSOIL & SALT TOLERANT GRASS SEEDING TO MEET CITY OF WINNIPEG SPEC CW 3520 & CW 3540
- TOPSOIL & NATIVE GRASSES - SALT TOLERANT GRASS MIX 2 YEAR ACCEPTANCE PERIOD, FOLLOWED BY A 1 YEAR MAINTENANCE AND WARRANTY
- EXISTING TREES TO REMAIN
- EXISTING TREES TO BE TRIMMED
- EXISTING TREES TO BE REMOVED

NOTES

- ALL CONSTRUCTION MATERIALS AND METHODS TO BE IN ACCORDANCE WITH "THE CITY OF WINNIPEG, STANDARD CONSTRUCTION SPECIFICATION AND STANDARD DETAILS" (LATEST REVISION).
- CONTRACTOR TO TAKE PRECAUTIONARY STEPS AS OUTLINED IN THE SPECIFICATIONS TO PROTECT EXISTING TREES WITHIN THE LIMITS OF CONSTRUCTION FROM DAMAGE FROM CONSTRUCTION ACTIVITIES.
- CONTRACTOR TO CONFIRM THE LOCATION OF ALL UTILITIES/SERVICES IN THE FIELD PRIOR TO CONSTRUCTION.
- CONTRACTOR MUST FOLLOW THE REQUIREMENTS OF THE VARIOUS UTILITIES.
- FINAL LOCATION OF REST STOPS TO BE CONFIRMED ON SITE PRIOR TO CONSTRUCTION.
- CONTRACTOR SHALL INSTALL TOPSOIL AND SEEDING / NATIVE GRASS TO ALL AREAS WHERE MATERIAL IS REMOVED AND NOT RE-ESTABLISHED. FINAL EXTENT & SEEDING TYPE TO BE CONFIRMED ON SITE PRIOR TO CONSTRUCTION.
- TOPSOIL AND SEEDING / NATIVE GRASS SHALL BE PLANTED AT A DISTANCE AS INDICATED BELOW, UNLESS NOTED OTHERWISE ON PLAN:
 - TYPICAL 1.0m OFFSET FROM SIDEWALK / PATHWAY
 - TYPICAL 0.6m OFFSET FROM SILT FENCING
- CONTRACTOR TO STAKE PROPOSED TREE LOCATION ON SITE, LAYOUT TO BE APPROVED BY LANDSCAPE ARCHITECT PRIOR TO INSTALLATION.
- SEE SHEET 84 FOR PROPOSED TREE PLANTING DETAILS
- BOULEVARD TREES SHALL BE PLANTED AT A MINIMUM DISTANCE FROM ABOVE GROUND STRUCTURES AS INDICATED BELOW:
 - MINIMUM DISTANCE FROM STREET INTERSECTIONS: 6m
 - MINIMUM DISTANCE FROM LIGHT STANDARDS: 3m
 - MINIMUM DISTANCE FROM PRIVATE APPROACHES: 1.5m
 - MINIMUM DISTANCE FROM HYDRANTS: 3m
 - MINIMUM DISTANCE FROM HYDRO POLES: 3m
 - MINIMUM DISTANCE FROM MANHOLES/CB'S/SEWER GRATES: 3m
- ALSO REFER TO WRITTEN SPECIFICATION.

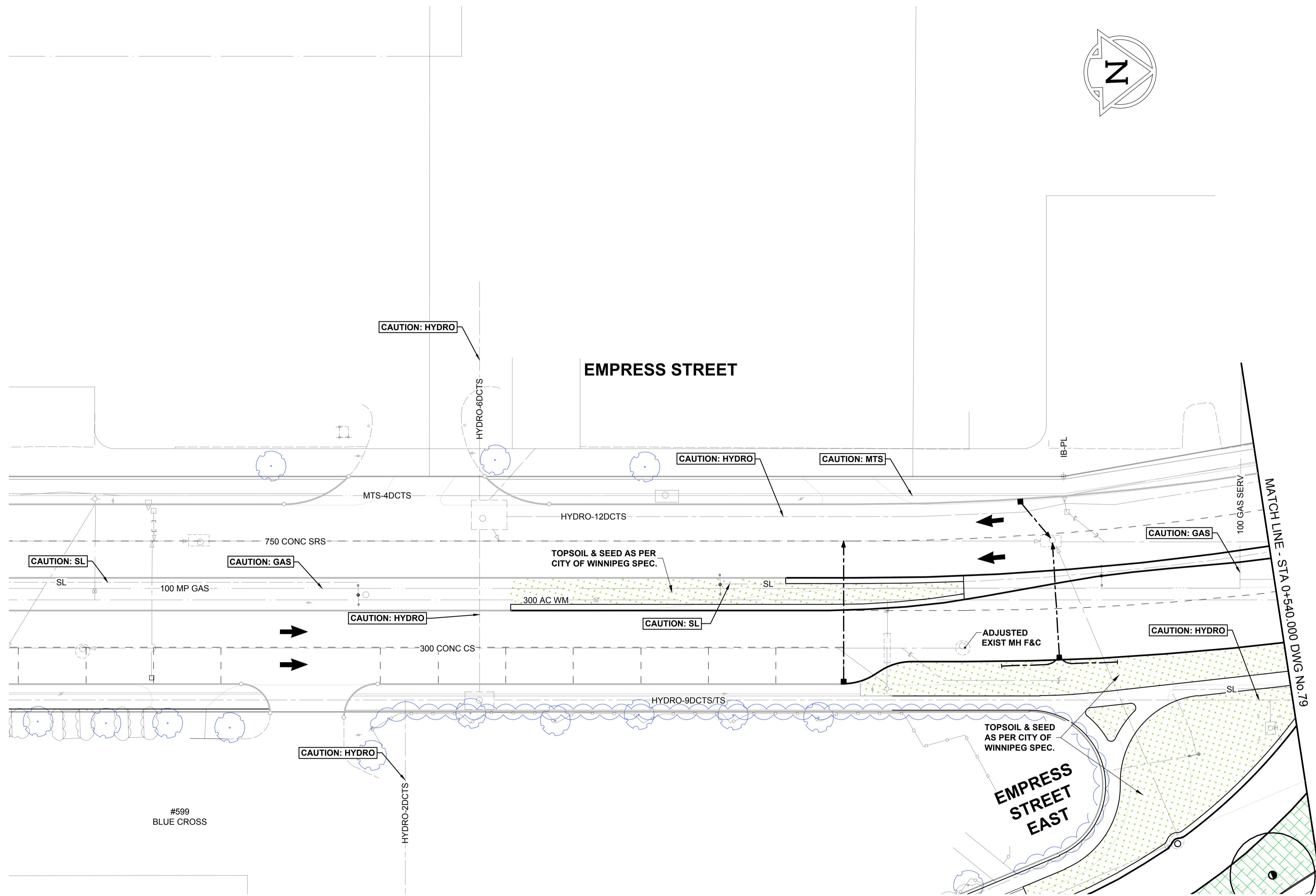

SEE DWG No. 77 FOR CONTINUATION OF EMPRESS STREET EAST LANDSCAPE WORKS

REFERENCE LEGEND

- SEE SHEET 16 FOR PAVING
- SEE SHEET 31 FOR GRADING
- SEE SHEET 48 FOR PROFILES

METRIC

WHOLE NUMBERS INDICATE MILLIMETRES
DECIMALIZED NUMBERS INDICATE METRES

---	GAS	○	MANHOLE	●	CONCRETE PAVEMENT	▨	LOCATION APPROVED	BM -	<p>SCATLIFF + MILLER + MURRAY visionary urban design + landscapes</p> <p>DESIGNED BY: CD CHECKED BY: DM DRAWN BY: WF APPROVED BY: CO</p> <p>HOR SCALE: 1:250 VERT SCALE: N/A</p> <p>RELEASED FOR CONSTRUCTION: N/A</p> <p>CONSULTANT FILE NAME: 602-2018_Drawing_P-3494-78-RC.dwg</p>
- - - -	MTS / PEDESTAL	△	CATCH BASIN / CATCH PIT	■	CONC SIDEWALK / MEDIAN	▨	UNDERGROUND STRUCTURES	ELEV -	
- - - -	HYDRO / CABINET	□	CURB INLET WITH BOX	▲	ASPHALT PAVEMENT	▨			
- - - -	CATV / FIBRE OPTIC	○	TREE	○	PAVING STONE	▨			
- - - -	TRAFFIC SIGNALS / PIT	⊕	TEST HOLE	⊕	GRAVEL	▨			
- - - -	LAND DRAINAGE SEWER	⊕	PROPERTY LINE	---	RAMP CURB	▨			
- - - -	SANITARY/COMBINED SEWER	⊕	SURVEY BAR	---	PLANING / REMOVAL	▨			
- - - -	CB LEAD / SSP / DCP	⊕	FENCE	---					
- - - -	WATER MAIN	---	BOC / EDGE OF PAVEMENT	---					
- - - -	SUBDRAIN	---	ELEVATION	(33.333)					
- - - -	DITCH	---	TRAFFIC SIGN	---					
---	EXISTING	---	LEGEND - PLAN	---	EXISTING	---	LEGEND - PLAN	---	
---	NEW	---	LEGEND - PLAN	---	NEW	---	LEGEND - PLAN	---	

LOCATION APPROVED UNDERGROUND STRUCTURES

SUPR. UIG STRUCTURES COMMITTEE DATE

NOTE: LOCATION OF UNDERGROUND STRUCTURES AS SHOWN ARE BASED ON THE BEST INFORMATION AVAILABLE BUT NO GUARANTEE IS GIVEN THAT ALL EXISTING UTILITIES ARE SHOWN OR THAT THE GIVEN LOCATIONS ARE EXACT. CONFIRMATION OF EXISTENCE AND EXACT LOCATION OF ALL SERVICES MUST BE OBTAINED FROM THE INDIVIDUAL UTILITIES BEFORE PROCEEDING WITH CONSTRUCTION.

C	ISSUED FOR ADDENDUM 1	18/09/21	CO
B	ISSUED FOR TENDER	18/09/04	CO
A	ISSUED FOR CLIENT REVIEW	18/06/27	CO
No.	REVISIONS	YYMMDD	BY

<p>SCATLIFF + MILLER + MURRAY visionary urban design + landscapes</p>			
DESIGNED BY	CD	CHECKED BY	DM
DRAWN BY	WF	APPROVED BY	CO
DATE	18/06/27	DATE	

PROFESSIONAL'S SEAL

CHERYL DIXON
Member No. 117

CONSULTANT FILE NAME

602-2018_Drawing_P-3494-78-RC.dwg

SCALE: 1:250

BID OPPORTUNITY No. 602-2018

THE CITY OF WINNIPEG
PUBLIC WORKS DEPARTMENT
ENGINEERING DIVISION

EMPRESS STREET PROJECT
PAVEMENT RECONSTRUCTION
LANDSCAPING
EMPRESS STREET
STA 0+410.000 WG TO STA 0+540.000 WG

CITY DRAWING NUMBER: P-3494-76
SHEET 78 OF 168
DRAWING No. REV 78 B