

POST Mk. P4 PLAN
SCALE 1:4

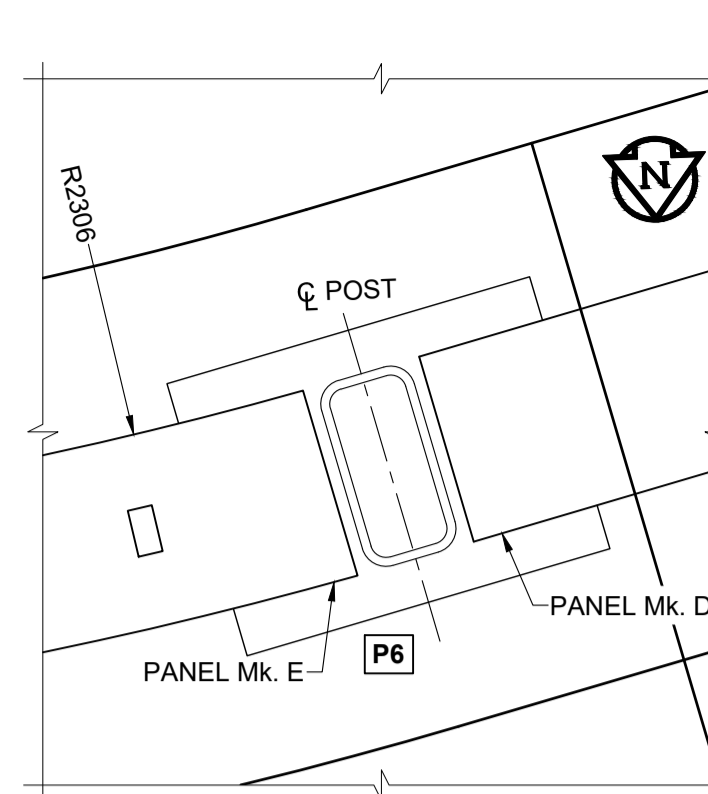

POST Mk. P6 PLAN
SCALE 1:4

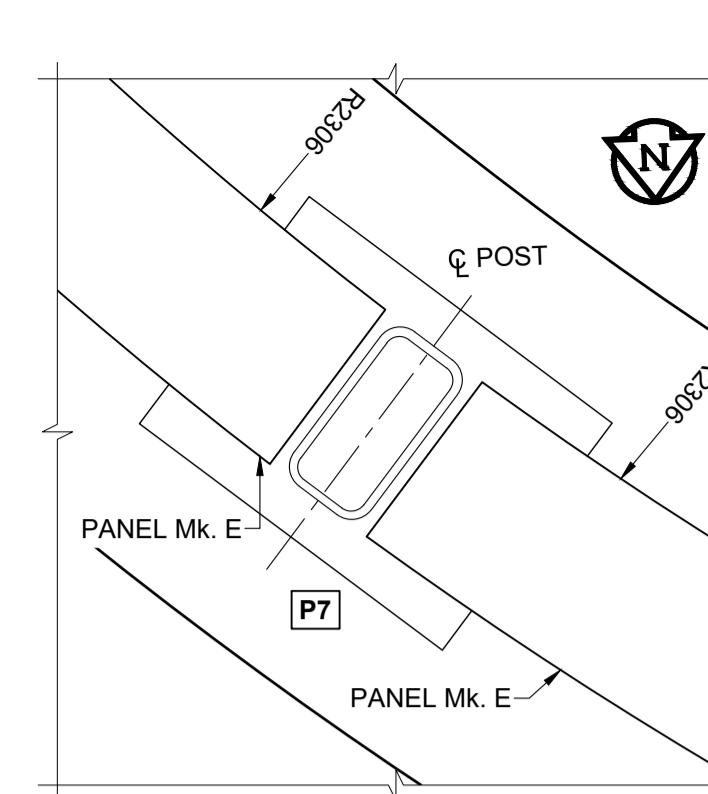

POST Mk. P7 PLAN
SCALE 1:4

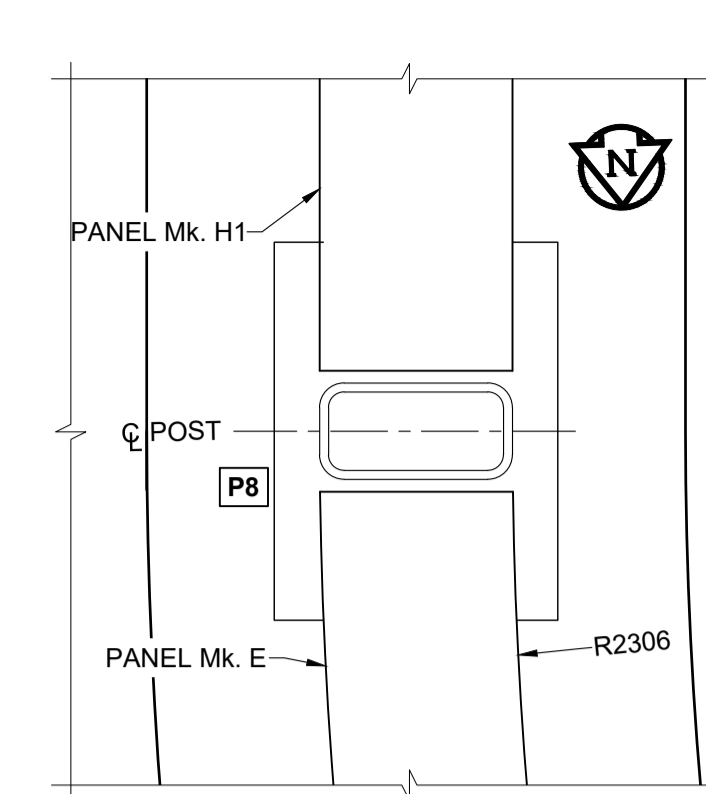

POST Mk. P8 PLAN
SCALE 1:4

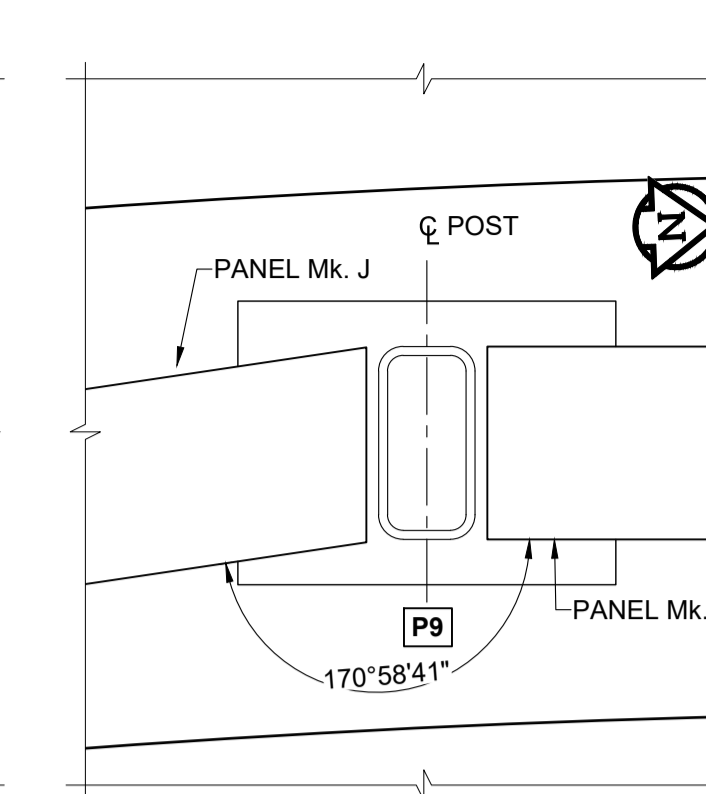

POST Mk. P9 PLAN
SCALE 1:4

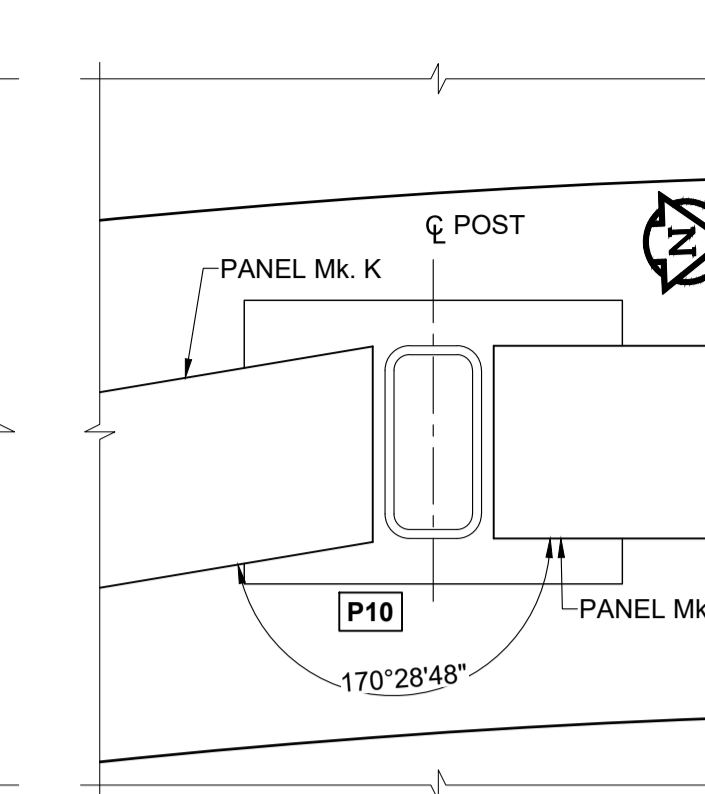

POST Mk. P10 PLAN
SCALE 1:4

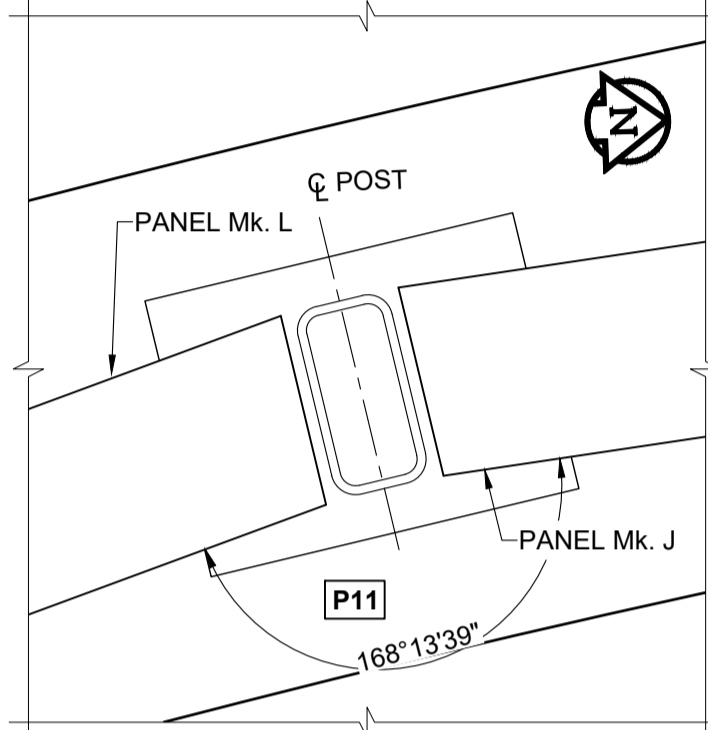

POST Mk. P11 PLAN
SCALE 1:4

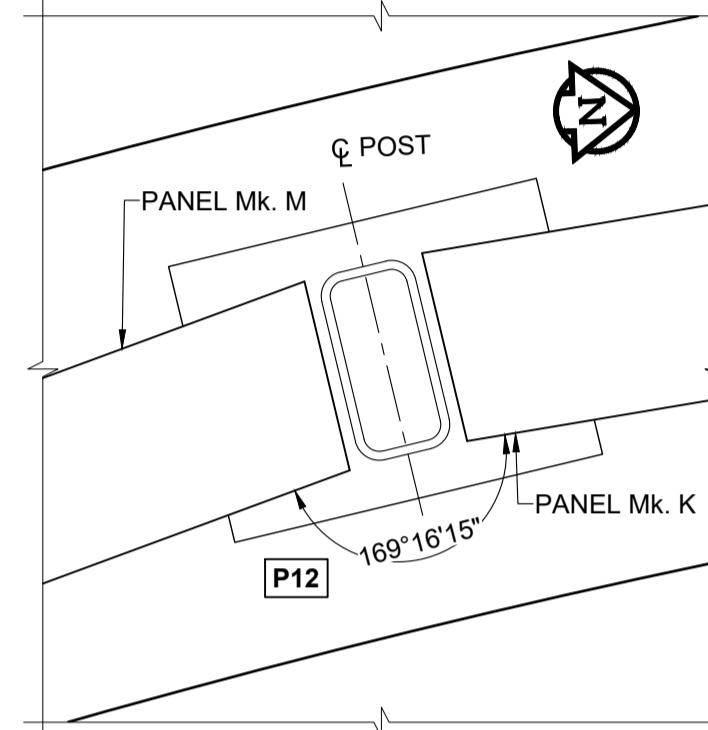

POST Mk. P12 PLAN
SCALE 1:4

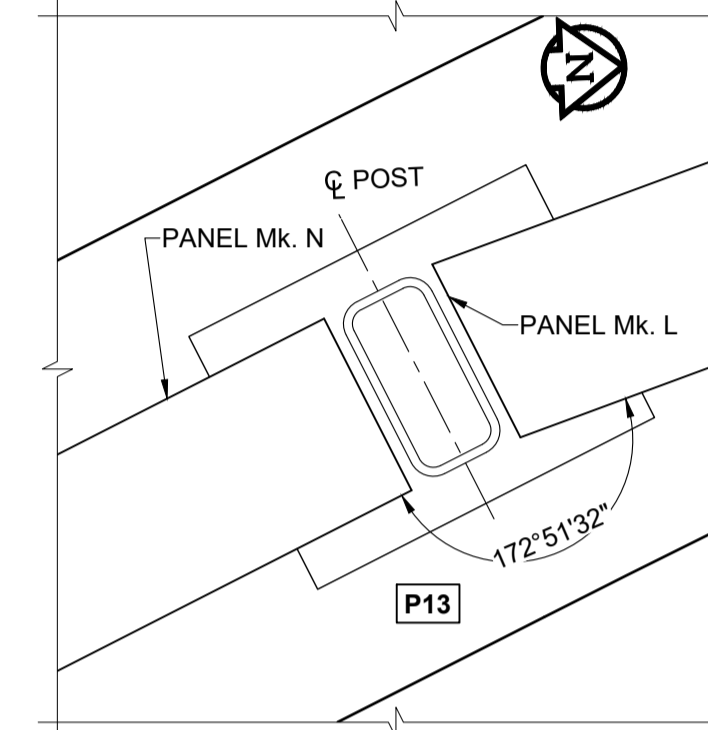

POST Mk. P13 PLAN
SCALE 1:4

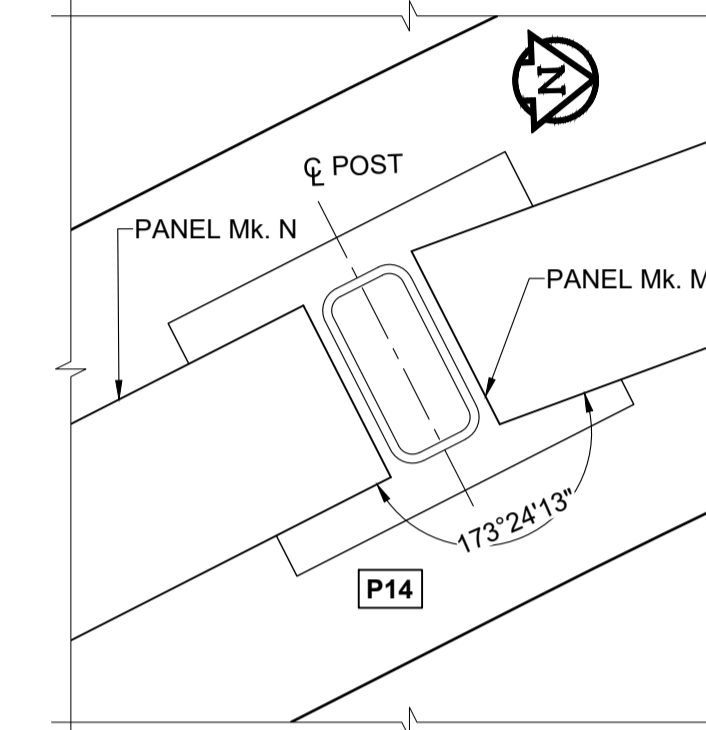

POST Mk. P14 PLAN
SCALE 1:4

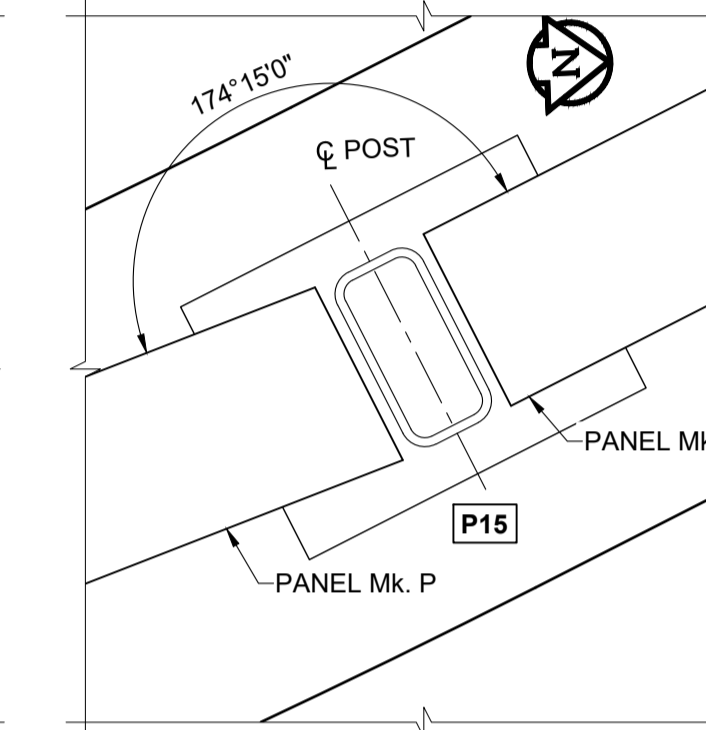

POST Mk. P15 PLAN
SCALE 1:4

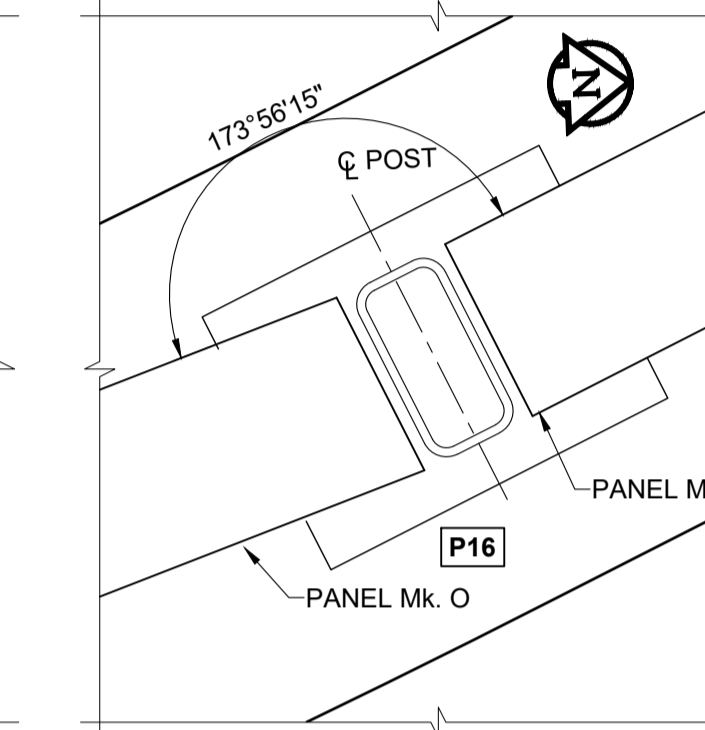

POST Mk. P16 PLAN
SCALE 1:4

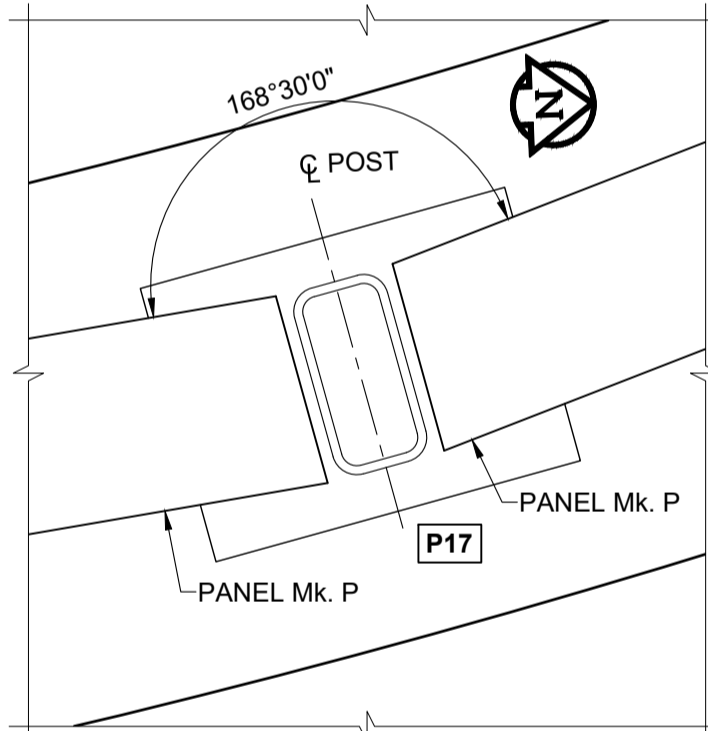

POST Mk. P17 PLAN
SCALE 1:4

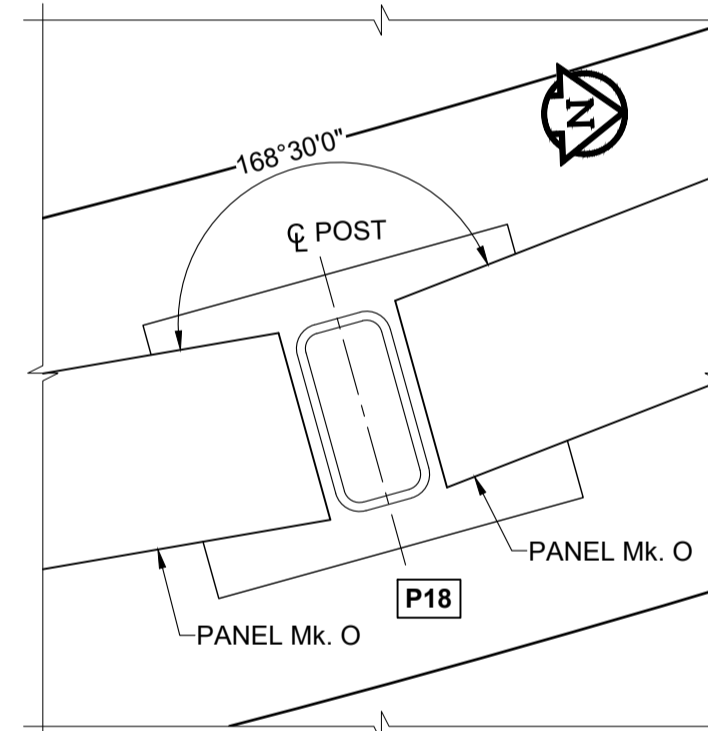

POST Mk. P18 PLAN
SCALE 1:4

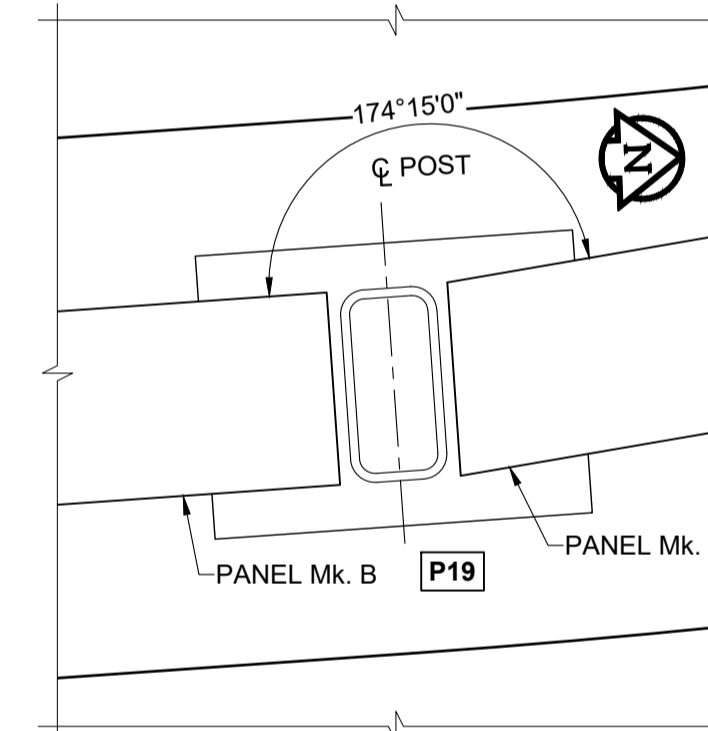

POST Mk. P19 PLAN
SCALE 1:4

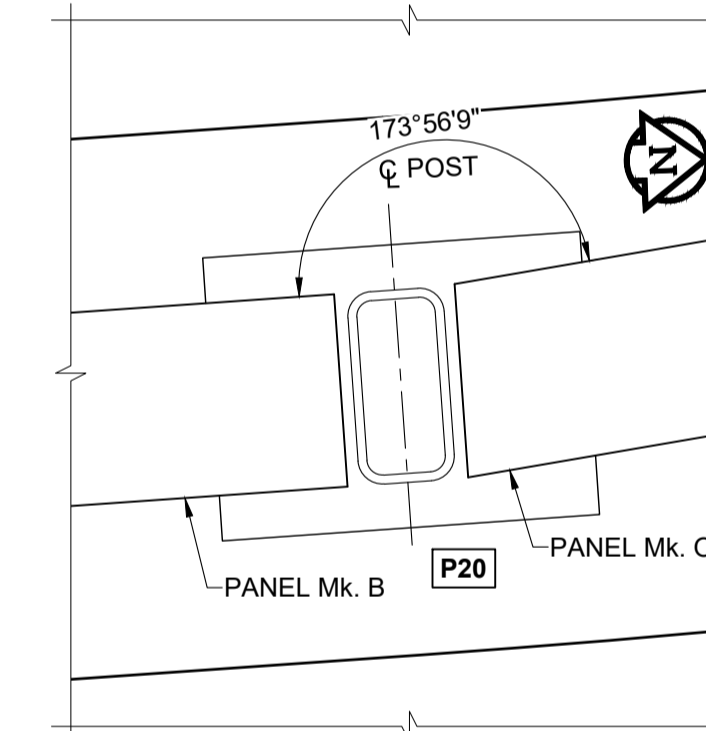

POST Mk. P20 PLAN
SCALE 1:4

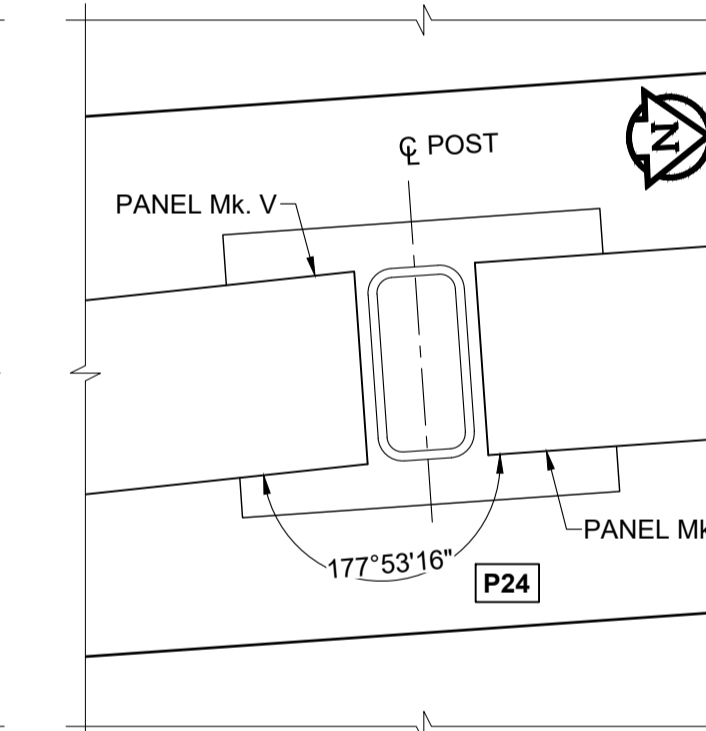

POST Mk. P24 PLAN
SCALE 1:4

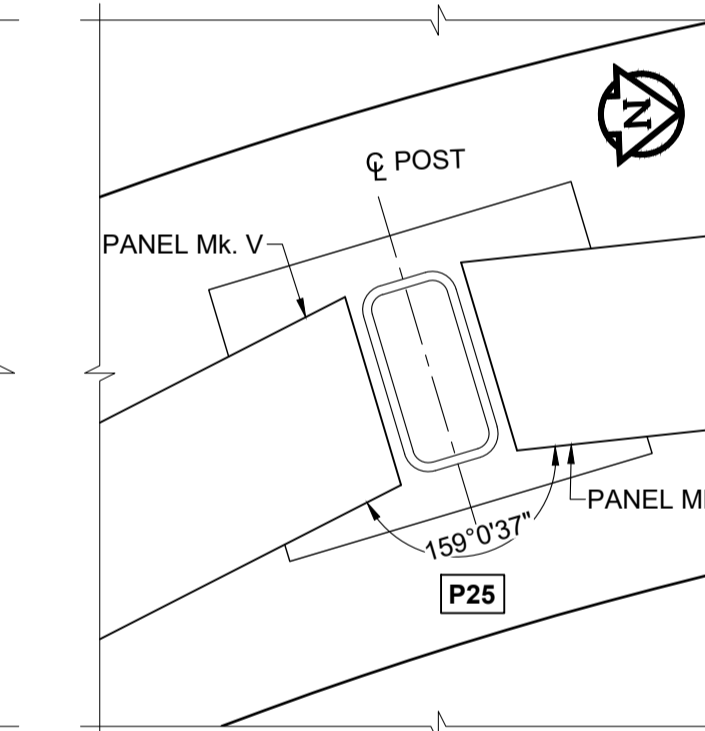

POST Mk. P25 PLAN
SCALE 1:4

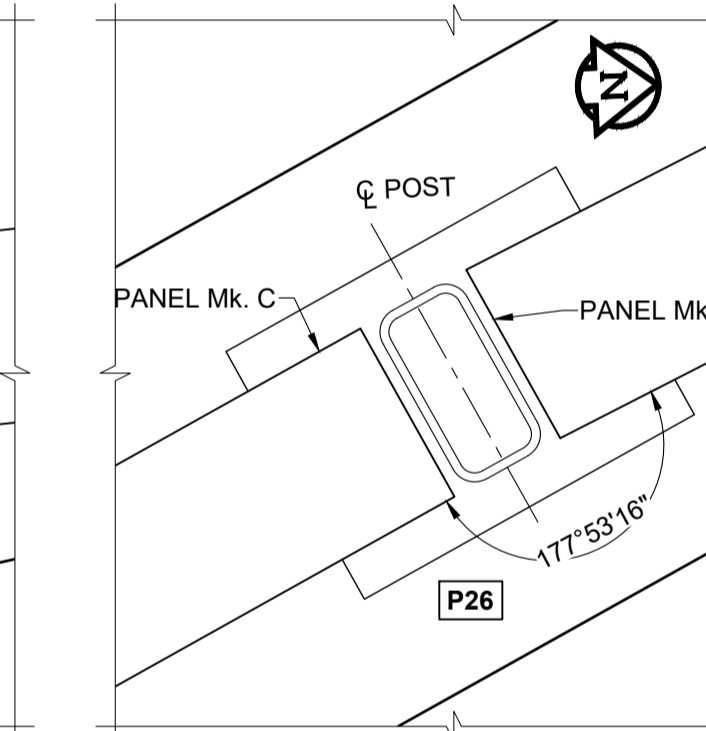

POST Mk. P26 PLAN
SCALE 1:4

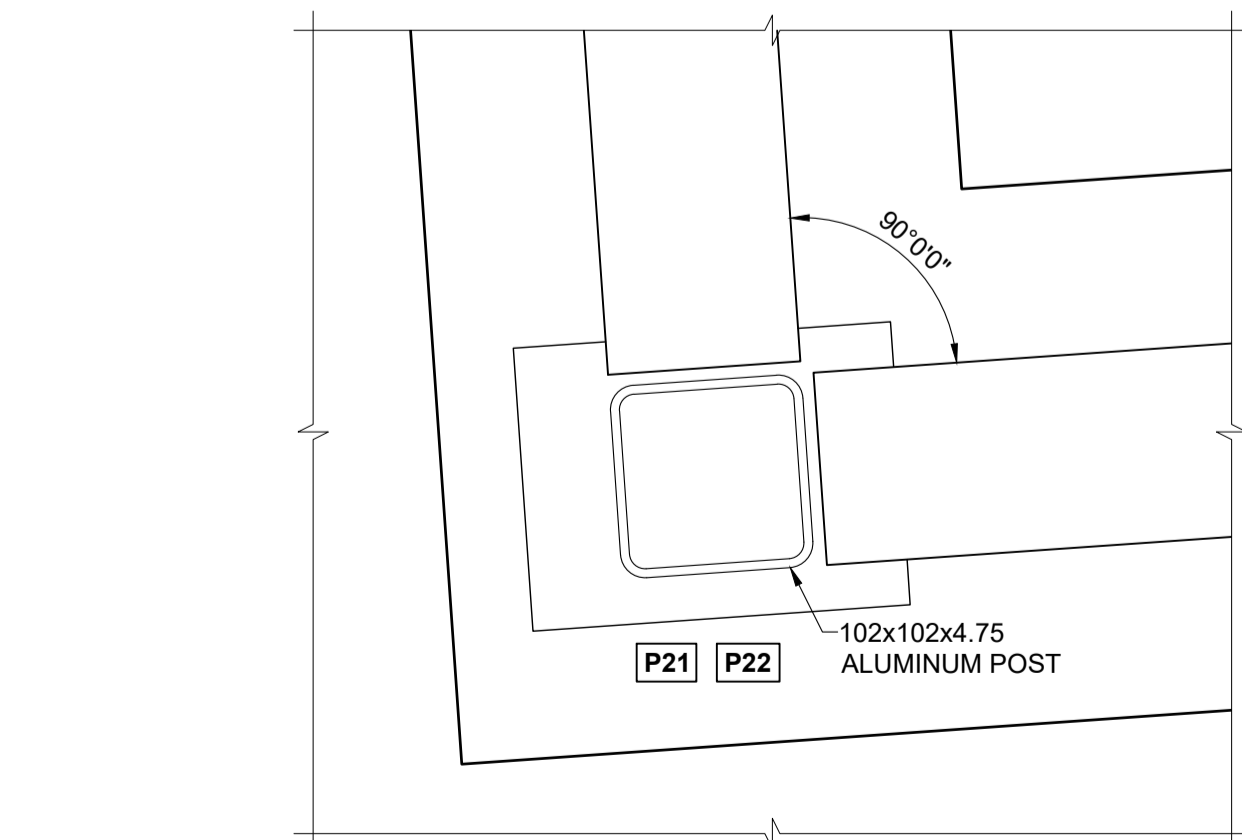
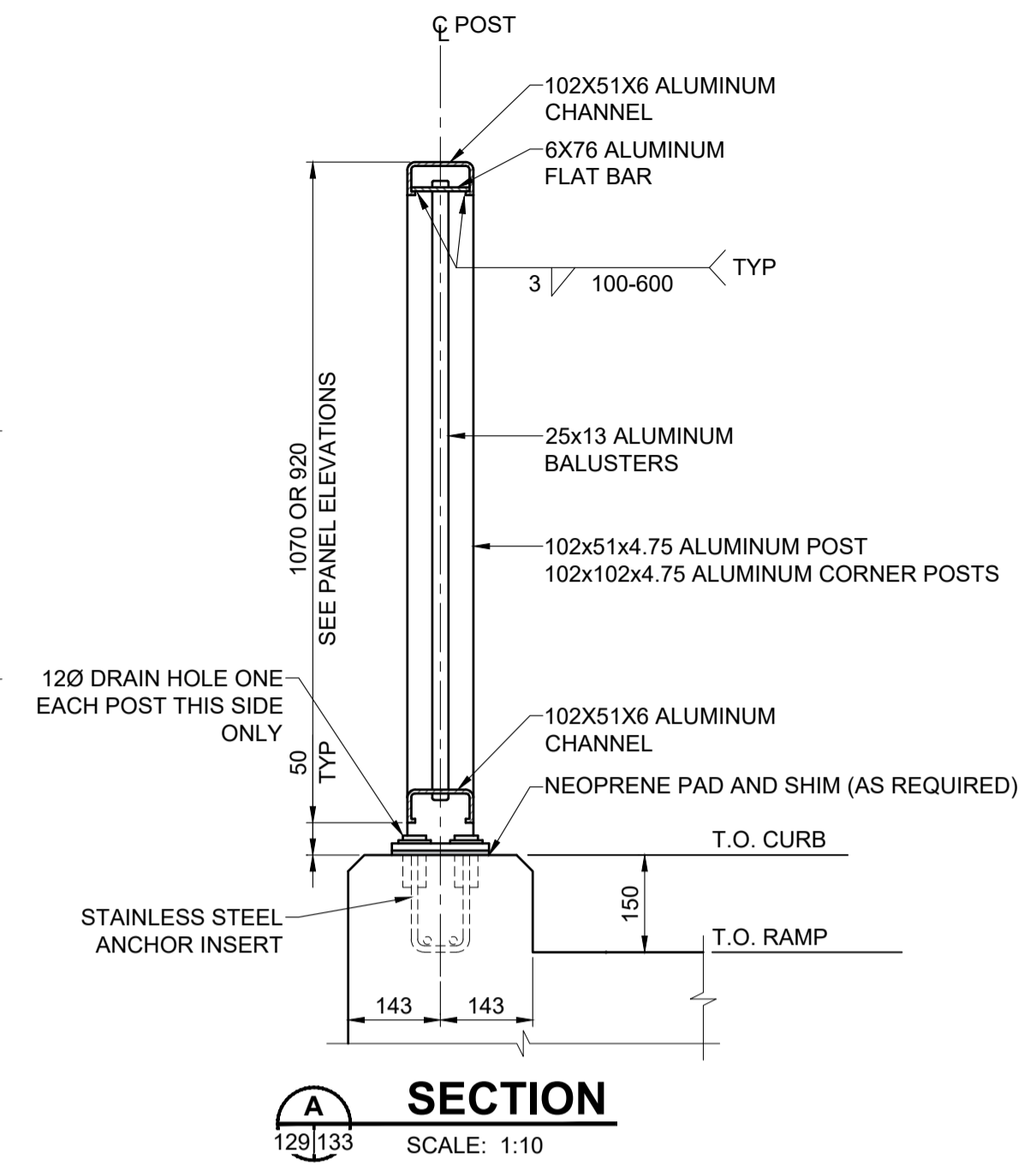

TYPICAL CORNER POST PLAN
SCALE 1:4

ENGINEERS
GEOSCIENTISTS
MORRISON HERSHFIELD
No. 1736

METRIC
WHOLE NUMBERS INDICATE MILLIMETRES
DECIMALIZED NUMBERS INDICATE METRES

LOCATION APPROVED
UNDERGROUND STRUCTURES

Supr. U/G Structures Committee
DATE
NOTE:
LOCATION OF UNDERGROUND STRUCTURES AS SHOWN ARE BASED ON THE BEST INFORMATION AVAILABLE BUT NO GUARANTEE IS GIVEN THAT ALL EXISTING UTILITIES ARE SHOWN OR THAT THE GIVEN LOCATIONS ARE EXACT. CONFIRMATION OF EXISTENCE AND EXACT LOCATION OF ALL SERVICES MUST BE OBTAINED FROM THE INDIVIDUAL UTILITIES BEFORE PROCEEDING WITH CONSTRUCTION.

BM ELEV				
DESIGNED BY	YM	CHECKED BY	BAP	
DRAWN BY	ALP	APPROVED BY	BE	
		RELEASED FOR CONSTRUCTION	N/A	
		DATE		
B	ISSUED FOR TENDER	18/09/04	BAP	
A	ISSUED FOR 95% DESIGN REVIEW	18/08/07	BAP	
REVISIONS		YYMMDD	BY	DATE

MORRISON HERSHFIELD	
DESIGNED BY	YM
CHECKED BY	BAP
DRAWN BY	ALP
APPROVED BY	BE
HOR SCALE	AS SHOWN
VERT SCALE	AS SHOWN

B.A.F. PHILLIPS
Member
32723
REGISTERED PROFESSIONAL ENGINEER

THE CITY OF WINNIPEG
PUBLIC WORKS DEPARTMENT
ENGINEERING DIVISION

EMPRESS STREET PROJECT
PEDESTRIAN ACCESSIBILITY RAMPS
SOUTH RAMP
PEDESTRIAN HANDRAIL DETAILS 5

BID OPPORTUNITY No. 602-2018

CITY DRAWING NUMBER	P-3494-133
SHEET	133 OF 168
DRAWING No.	REV
	133 B

- NOTES:**
- ALUMINUM EXTRUSIONS SHALL CONFORM TO ASTM B221 ALLOY 6351-T6.
 - THE M.I.G. PROCESS OF WELDING SHALL BE USED.
 - RAIL POSTS AND BALUSTERS SHALL BE SET PLUMB.
 - PLACE NEOPRENE PAD UNDER EACH POST BETWEEN BASE PLATE OR SHIM AND CONCRETE SURFACE. ALUMINUM SHIMS MAY BE REQUIRED FOR VERTICAL ALIGNMENT.
 - HANDRAIL ANCHOR INSERTS SHALL BE ACROW-RICHMOND TYPE DGRS-1.