

ISO A1 - 594mm x 841mm
 O:\Winnipeg\Proj\160034-17\Drawings\06_Sheets\Detailed Design\Contract 2_Reconstruction\W160034-17-Empress-Recon-PA-17.dwg
 Last Saved: 8/30/2018 8:31 AM by DDozrod
 Plotted: 8/30/2018 8:31 AM by Daniel Dozrod

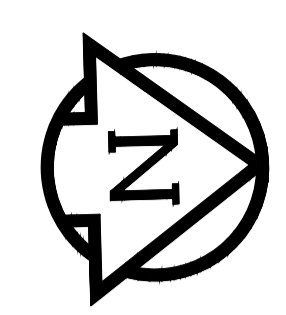
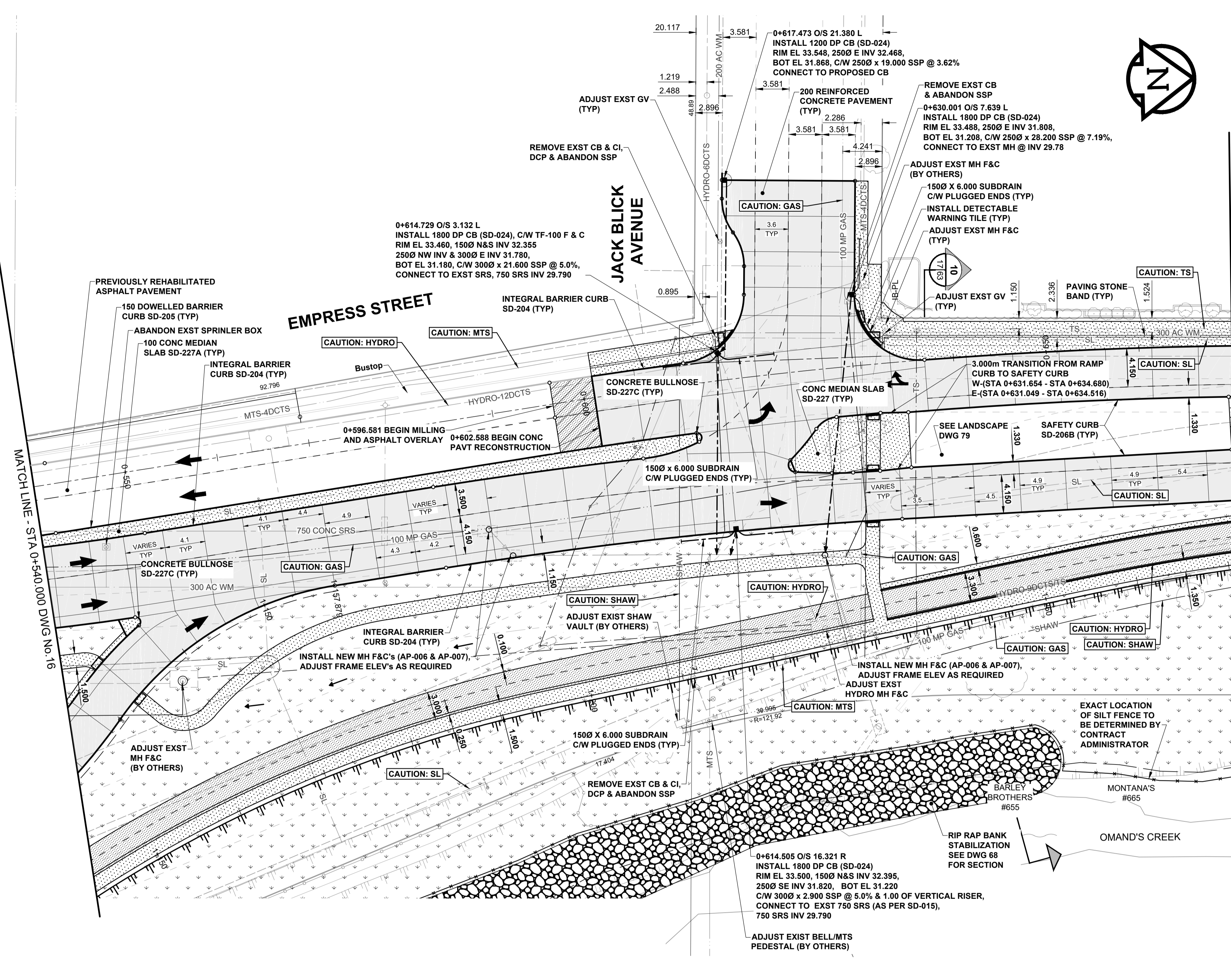

REFERENCE LEGEND
 -SEE SHEET 32 FOR GRADING
 -SEE SHEET 49 FOR PROFILES
 -SEE SHEETS 57 & 58 FOR CYCLE TRACK PROFILES
 -SEE SHEET 79 FOR LANDSCAPING

SEE DWG No. 15 FOR CONTINUATION
 OF EMPRESS STREET EAST PAVEMENT WORKS

- NOTES**
- ADJUST MH'S CB RIMS, WVS AND HYD'S TO NEW GRADES.
 - CONTRACTOR TO REGRADE/RENEW EXST PRIVATE SIDEWALKS TO LIMITS AS SHOWN. SIDEWALKS TO BE RENEWED WITH CONCRETE UNLESS NOTED OTHERWISE.
 - CONTRACTOR TO TAKE PRECAUTIONARY STEPS AS OUTLINED IN THE SPECIFICATIONS TO PROTECT EXISTING TREES WITHIN THE LIMITS OF CONSTRUCTION FROM DAMAGE FROM CONSTRUCTION ACTIVITIES.
 - MODIFIED BARRIER CURB TO BE CONSTRUCTED AT ALL INTERSECTION RADII, BACK LANE RADII AND BULLNOSES.
 - CONTRACTOR TO CONFIRM THE LOCATION OF ALL UTILITIES/SERVICES IN THE FIELD PRIOR TO CONSTRUCTION.
 - ADD 200.000m TO ABBREVIATED ELEVATIONS TO OBTAIN GEODETIC ELEVATIONS.
 - CB SD-024 OFFSETS ARE DIMENSIONED TO BOC. CB SD-025 OFFSETS ARE DIMENSIONED OIC.
 - ALL DIMENSIONS TO BACK OF CURB AND THEORETICAL BACK OF CURB.

SECTION LEGEND
 Section Taken Shown

METRIC
 WHOLE NUMBERS INDICATE MILLIMETRES
 DECIMALIZED NUMBERS INDICATE METRES

EXISTING	LEGEND - PLAN	NEW	EXISTING	LEGEND - PLAN	NEW	EXISTING	LEGEND - PLAN	NEW
	GAS		MANHOLE		CONCRETE PAVEMENT		LOCATION APPROVED	
	MTS / PEDESTAL		CATCH BASIN / CATCH PIT		CONC SIDEWALK / MEDIAN		UNDERGROUND STRUCTURES	
	HYDRO / CABINET		CURB INLET WITH BOX		ASPHALT PAVEMENT		SUPR. UIG STRUCTURES	DATE
	CATV / FIBRE OPTIC		TREE		PAVING STONE		COMMITTEE	
	TRAFFIC SIGNALS / PIT		TEST HOLE		GRAVEL		NOTE:	
	LAND DRAINAGE SEWER		PROPERTY LINE		RAMP CURB		LOCATION OF UNDERGROUND STRUCTURES AS SHOWN ARE BASED ON THE BEST INFORMATION AVAILABLE BUT NO GUARANTEE IS GIVEN THAT ALL EXISTING UTILITIES ARE SHOWN OR THAT THE GIVEN LOCATIONS ARE EXACT. CONFIRMATION OF EXISTENCE AND EXACT LOCATION OF ALL SERVICES MUST BE OBTAINED FROM THE INDIVIDUAL UTILITIES BEFORE PROCEEDING WITH CONSTRUCTION.	
	SANITARY/COMBINED SEWER		SURVEY BAR		PLANING / REMOVAL			
	CB LEAD / SSP / DCP		FENCE					
	WATER MAIN		BOC / EDGE OF PAVEMENT					
	SUBDRAIN		ELEVATION					
	DITCH		TRAFFIC SIGN					

DESIGNED BY		CHECKED BY		DRAWN BY		APPROVED BY		RELEASED FOR CONSTRUCTION	
WRJ		RPB		DID		BWB		N/A	
18/09/04		18/09/04		18/06/27		18/06/27		18/09/04	
ISSUED FOR TENDER		ISSUED FOR TENDER		ISSUED FOR CLIENT REVIEW		ISSUED FOR CLIENT REVIEW		ISSUED FOR CLIENT REVIEW	
18/09/04		18/09/04		18/06/27		18/06/27		18/09/04	
RWB		RWB		RWB		RWB		RWB	
18/09/04		18/09/04		18/06/27		18/06/27		18/09/04	

PROFESSIONAL'S SEAL
 PROVINCE OF MANITOBA
 REGISTERED PROFESSIONAL ENGINEER
 R.P. BRUCE
 CONSULTANT FILE NAME
 W160034-17-Empress-Recon-PA-17.dwg

THE CITY OF WINNIPEG
 PUBLIC WORKS DEPARTMENT
 ENGINEERING DIVISION

EMPIRE STREET PROJECT
 PAVEMENT RECONSTRUCTION
 PAVING
 EMPRESS STREET
 STA 0+540.000 WG TO STA 0+670.000 WG

CITY DRAWING NUMBER
 P-3494-17
 SHEET 17 OF 168
 DRAWING No. REV
 17 B

SCALE: 1:250
 0 5 10 15m

ENGINEERS
 GEOSCIENTISTS
 MANITOBA
 Certificate of Authorization
 MORRISON HERSHFIELD
 No. 1736

BID OPPORTUNITY No. 602-2018