

DRAWING INDEX

SHEET NUMBER	CITY OF WINNIPEG DRAWING NUMBER	DRAWING TITLE
1	LD-8594	COVER SHEET
2	LD-8595	GENERAL INFORMATION - DRAWING INDEX, CONSTRUCTION NOTES, LEGEND - MANHOLE SCHEDULE & TESTHOLE SCHEDULE
3	LD-8596	WILTON STREET - TAYLOR AVENUE TO GRANT AVENUE - TAYLOR AVENUE TO STA 2+20
4	LD-8597	WILTON STREET - TAYLOR AVENUE TO GRANT AVENUE - STA 2+20 TO STA 3+60
5	LD-8598	WILTON STREET - TAYLOR AVENUE TO GRANT AVENUE - STA 3+60 TO STA 4+95
6	LD-8599	WILTON STREET - TAYLOR AVENUE TO GRANT AVENUE - STA 4+95 TO STA GRANT AVENUE
7	LD-8600	WILTON BAY/EBBY AVENUE - WILTON STREET TO GUELPH STREET - WILTON BAY WEST LEG TO STA 2+25
8	LD-8601	EBBY AVENUE - WILTON STREET TO GUELPH STREET - STA 2+25 TO GUELPH STREET
9	LD-8602	HECTOR AVENUE - HECTOR BAY EAST TO GUELPH STREET - HECTOR BAY EAST TO STA 2+10
10	LD-8603	HECTOR AVENUE - HECTOR BAY EAST TO GUELPH STREET - STA 2+10 TO STA 3+25
11	LD-8604	HECTOR AVENUE - HECTOR BAY EAST TO GUELPH STREET - STA 3+25 TO STA 4+40
12	LD-8605	HECTOR AVENUE - HECTOR BAY EAST TO GUELPH STREET - STA 4+40 TO GUELPH STREET
13	LD-8606	HECTOR BAY EAST - WEST LEG
14	LD-8607	HECTOR BAY EAST - SOUTH LEG
15	LD-8608	HECTOR BAY EAST - EAST LEG
16	LD-8609	CARTER AVENUE - WILTON STREET TO GUELPH STREET - WILTON STREET TO STA 1+80
17	LD-8610	CARTER AVENUE - WILTON STREET TO GUELPH STREET - STA 1+80 TO ±30m EAST OF GUELPH STREET
18	LD-8611	WEATHERDON AVENUE - WILTON STREET TO GUELPH STREET - WILTON STREET TO STA 2+05
19	LD-8612	WEATHERDON AVENUE - WILTON STREET TO GUELPH STREET - STA 2+05 TO ±40m EAST OF GUELPH STREET
20	LD-8613	MANHOLE DETAILS (MUNICIPAL)
21	LD-8614	MANHOLE/TRANSITION CHAMBER MH-01 - PLAN AND SECTIONS (STRUCTURAL)
22	LD-8632	MANHOLE/TRANSITION CHAMBER MH-01 - SECTIONS AND DETAILS (STRUCTURAL)

CONSTRUCTION NOTES

- ALL UNDERGROUND WORKS TO BE CONSTRUCTED IN ACCORDANCE WITH THE LATEST REVISION OF THE CITY OF WINNIPEG STANDARD CONSTRUCTION SPECIFICATIONS.
- ALL EXISTING UNDERGROUND SERVICES SHOWN ON DRAWINGS ARE APPROXIMATE ONLY.
- CONTRACTOR TO VERIFY LOCATIONS OF ALL EXISTING UNDERGROUND UTILITIES AND SERVICES PRIOR TO START OF CONSTRUCTION.
- PIPE MATERIAL FOR ALL PIPES INSTALLED WITH 3.5 OR DEEPER OF COVER, SHALL BE REINFORCED CONCRETE TO ASTM C78 WITH STRENGTH CLASS TYPE INDICATED ON DRAWINGS.
- PIPE MATERIAL FOR PIPES HAVING LESS THAN 3.5 OF COVER CAN BE REINFORCED CONCRETE TO ASTM C78 OR SDR 35 PVC.
- FOR DETAILS OF STANDARD MANHOLE, LARGE DIAMETER MANHOLE AND LARGE DIAMETER DROP MANHOLE SEE DWG. LD-8613.
- STANDARD DROP MANHOLE SHALL COMPLY WITH C.O.W. DETAIL SD-010D.
- ALL NEW CATCH BASINS LEADS TO BE 250Ø PVC SDR 35 PIPES.
- ALL PIPE SHALL HAVE CLASS B BEDDING WHEN INSTALLED BY TRENCH METHOD.
- CONTRACTOR TO INSTALL SEWER BY TRENCHLESS METHODS.
- BACKFILL UNDER PAVEMENT & WITHIN 1.0 OF PAVEMENT ON REGIONAL STREETS TO BE CLASS 1.
- BACKFILL UNDER PAVEMENT & WITHIN 1.0 OF PAVEMENT ON OTHER ROADWAYS TO BE CLASS 3.
- BACKFILL IN BOULEVARD TO BE CLASS 5.
- CONTRACTOR TO INSTALL SEWER SERVICE RISERS TO AN ELEVATION WHERE MINIMUM SLOPE OF 2% IS MAINTAINED FOR ALL SERVICES.
- SHAFT LOCATIONS SHOWN ON DRAWINGS ARE FOR PLANNING PURPOSES ONLY. ACTUAL SHAFT LOCATIONS ARE THE RESPONSIBILITY OF THE CONTRACTOR TO MEET THEIR CONSTRUCTION MEANS AND METHODS.
- CONTRACTOR SHALL MITIGATE IMPACTS TO THE WORK AREA FROM SITE SURFACE RUNOFF.
- PEDESTRIAN ACCESS MUST BE MAINTAINED DURING CONSTRUCTION AT ALL TIMES.
- EXISTING SEWER AND WATER SERVICES TO BE REGRADED AS REQUIRED FOR CONSTRUCTION OF THE NEW LDS PIPING.
- EXISTING SERVICES OF THE CS TO BE ABANDONED SHALL BE INSPECTED IN ADVANCE OF ABANDONING TO CONFIRM THAT NO REMAINING SERVICE CONNECTIONS EXIST.

ABBREVIATIONS

WWS	WASTE WATER SEWER
CS	COMBINED SEWER
LDS	LAND DRAINAGE SEWER
ℙ	PROPERTY LINE
℄	CENTER LINE
G.I.S.	GEOGRAPHIC INFORMATION SYSTEM
B.M.	BENCH MARK
TH	TEST HOLE
ELEV	ELEVATION
INV	INVERT
MIN	MINIMUM
MAX	MAXIMUM
SL	STREET LIGHTING
TS	TRAFFIC SIGNALS
ABAND	ABANDONED
BLDG	BUILDING
HSE	HOUSE
CRN	CORNER
OPP	OPOSITE
C/S OR S/C	CURB STOP
MTS	MANITOBA TELEPHONE SYSTEM
R.O.W.	RIGHT-OF-WAY
WM	WATERMAIN
CULV	CULVERT
MH	MANHOLE
CB	CATCH BASIN
CI	CURB INLET
VERT.	VERTICAL
HORZ.	HORIZONTAL
I.B.	IRON BAR
FIBRE	FIBRE OPTIC
TYP	TYPICAL
X-ING	CROSSING
HYD	HYDRANT
EXIST	EXISTING
N	NORTH
E	EAST
S	SOUTH
W	WEST
W/W	WITH
C/W	CONSTRUCTED WITH
CONC	CONCRETE
AC	ASBESTOS CEMENT
VC OR CLAY	VITRIFIED CLAY
CI	CAST IRON
DI	DUCTILE IRON
PVC	POLYVINYL CHLORIDE
HDPE	HIGH DENSITY POLYETHYLENE
PCCP	PRESTRESSED CONCRETE CYLINDER PIPE
JCT	JUNCTION

LEGEND

DESCRIPTION	PLAN VIEW	
	EXISTING	PROPOSED
WATER PIPE	---	---
FIRE HYDRANT	⊕	⊕
VALVE	⊗	⊗
CURB STOP	⊕	⊕
REDUCER	⊕	⊕
COUPLING OR SLIDER	X	X
CROSS	⊕	⊕
BEND - 11.25', 22.5', 45', 90'	⊕	⊕
TEE	⊕	⊕
VERTICAL BEND	H	H
ANODE	⊕	⊕
REPAIR MARKER	⊕	⊕
PLUG	J	J
SEWER PIPE	---	---
MANHOLE	⊕	⊕
CATCH BASIN	⊕	⊕
CURB INLET	⊕	⊕
JUNCTION	⊕	⊕
DITCH	---	---
CULVERT	---	---
SURVEY BAR	⊕	⊕
SURVEY MONUMENT	⊕	⊕
TREE - DECIDUOUS	⊕	⊕
TREE - CONIFEROUS	⊕	⊕
HYDRO	---	---
HYDRO POLE	⊕	⊕
LAMP STANDARD	⊕	⊕
HYDRO POLE W/STREET LIGHTING	⊕	⊕
POLE	⊕	⊕
GUY ANCHOR	⊕	⊕
M.T.S. POLE	⊕	⊕
PEDESTAL OR BOX	⊕	⊕
CABINET	⊕	⊕
M.T.S., SHAW, OR VIDEON	⊕	⊕
TRAFFIC SIGNALS	⊕	⊕
TRAFFIC LIGHT STANDARD	⊕	⊕
GAS	---	---
STEAM	---	---
FIBRE OPTIC	---	---
FENCE	---	---
EDGE OF PAVEMENT OR GUTTER	---	---
EDGE UNPAVED OR GRAVEL ROAD	---	---
PROJECTED	---	---
LOT LINE	---	---
SIDEWALK - PATHWAY	---	---
EASEMENT	---	---
EDGE OF BUILDING	---	---
MAILBOX	⊕	⊕
PARKING METER	⊕	⊕
TEST HOLE	⊕	⊕
TREE LINE OR BUSH	---	---

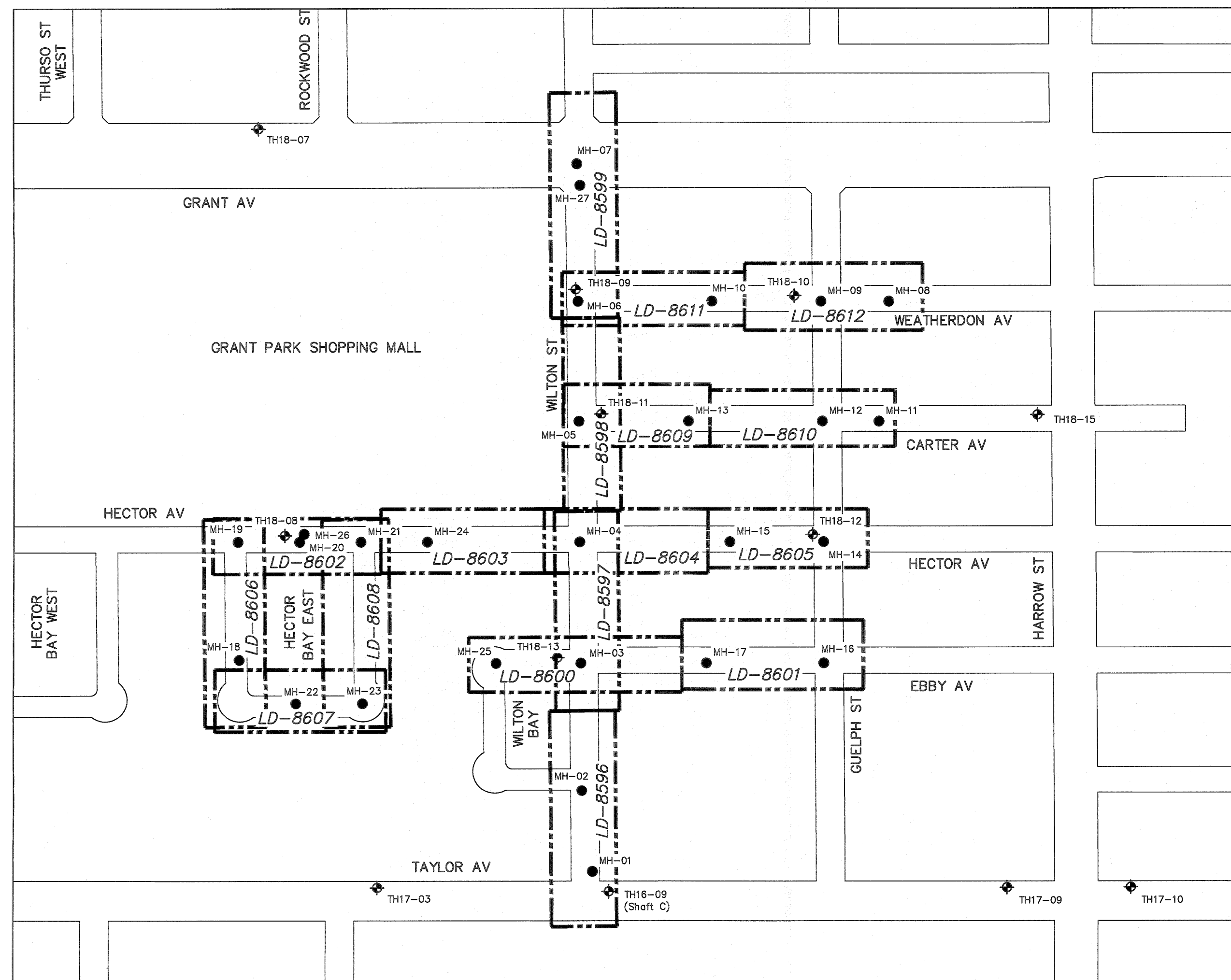

MANHOLE & TESTHOLE LOCATION PLAN
SCALE: N.T.S.

REFERENCE	NORTHING	EASTING
MH-01	5524249.64	632277.14
MH-02	5524296.04	632243.31
MH-03	5524374.87	632199.17
MH-04	5524448.70	632157.82
MH-05	5524522.07	632116.70
MH-06	5524595.71	632075.44
MH-07	5524670.71	632033.41
MH-08	5524700.73	632266.99
MH-09	5524678.02	632225.57
MH-10	5524641.09	632158.21
MH-11	5524623.52	632301.62
MH-12	5524604.40	632266.69
MH-13	5524559.25	632184.41
MH-14	5524531.12	632308.13
MH-15	5524499.39	632250.28
MH-16	5524457.04	632349.02
MH-17	5524417.34	632276.62
MH-18	5524261.04	631987.74
MH-19	5524333.18	631947.17
MH-20	5524354.07	631985.25
MH-21	5524374.68	632022.84
MH-22	5524253.25	632037.39
MH-23	5524275.81	632078.38
MH-24	5524397.06	632063.65
MH-25	5524346.19	632146.86
MH-26	5524356.51	631985.13
MH-27	5524666.48	632038.18

REFERENCE	NORTHING	EASTING
TH16-09	5524243.0	632294.0
TH17-03	5524167.0	632150.0
TH17-09	5524380.0	632538.0
TH17-10	5524422.0	632614.0
TH18-07	5524594.0	631820.0
TH18-08	5524353.0	631974.0
TH18-09	5524602.0	632070.0
TH18-10	5524672.0	632207.0
TH18-11	5524534.0	632128.0
TH18-12	5524532.0	632299.0
TH18-13	5524370.0	632183.0
TH18-15	5524681.0	632397.0

DESCRIPTION	PROFILE	
	EXISTING	PROPOSED
WATER PIPE	---	---
HYDRANT TOP	+	+
VALVE	X	X
TEE OR CROSS	⊕	⊕
COUPLING OR BEND	⊕	⊕
REDUCER	⊕	⊕
END OF PIPE	⊕	⊕
SEWER PIPE	---	---
UNPAVED GROUND SURFACE	---	---
PAVED GROUND SURFACE - PIPE	---	---
GUTTER (NORTH AND WEST)	---	---
GUTTER (SOUTH AND EAST)	---	---
℄ DITCH (NORTH AND WEST)	---	---
℄ DITCH (SOUTH AND EAST)	---	---
STRUCTURE	---	---
MANHOLE OR CATCH BASIN	---	---

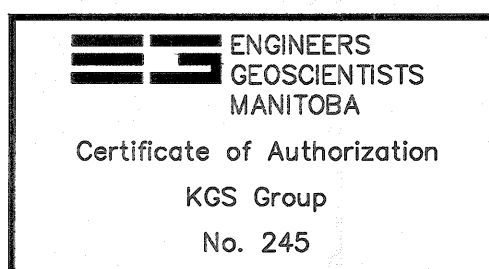

LOCATION APPROVED
UNDERGROUND STRUCTURES

SUPV. U/G STRUCTURES COMMITTEE DATE

NOTE:

LOCATION OF UNDERGROUND STRUCTURES AS SHOWN ARE BASED ON THE BEST INFORMATION AVAILABLE BUT NO GUARANTEE IS GIVEN THAT ALL EXISTING UTILITIES ARE SHOWN OR THAT THE GIVEN LOCATIONS ARE EXACT. CONFIRMATION OF EXISTENCE AND EXACT LOCATION OF ALL SERVICES MUST BE OBTAINED FROM THE INDIVIDUAL UTILITIES BEFORE PROCEEDING WITH CONSTRUCTION.

B.M. ELEV.

ISSUED FOR CONSTRUCTION

DATE

BY

NO.

REVISIONS

DATE

BY

DATE

BY



DESIGNED BY MID

CHECKED BY

DRAWN BY GEL

APPROVED BY

SCALE: HORIZONTAL AS NOTED

VERTICAL

DATE 2018 08 17

PLOT DATE: 2018 08 17

ENGINEER'S SEAL

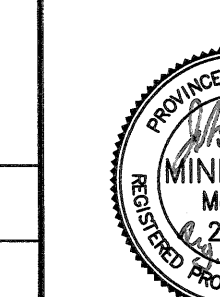

CONSULTANT DRAWING NUMBER

11-0107-18-C11_LD-8595

BID OPPORTUNITY: 640-2018

CONTRACT NUMBER: 11



THE CITY OF WINNIPEG
WATER AND WASTE DEPARTMENT
ENGINEERING DIVISION

COCKBURN & CALROSSIE SEWER RELIEF WORKS

CONTRACT 11

GENERAL INFORMATION

DRAWING INDEX, CONSTRUCTION NOTES, LEGEND, MANHOLE SCHEDULE & TESTHOLE SCHEDULE

SHEET 2 OF 22

CITY DRAWING NUMBER

LD-8595

FILE PATH: P:\Projects\2011\11-0107-18\DWG\Mun\C11 - WILTON-TAYLOR TO GRANT\

FILE NAME: 11-0107-18-C11_INDEX SHEET.dwg