

NOTE: CHAINAGES SHOWN ARE ALONG NORTH R. HECTOR AVENUE

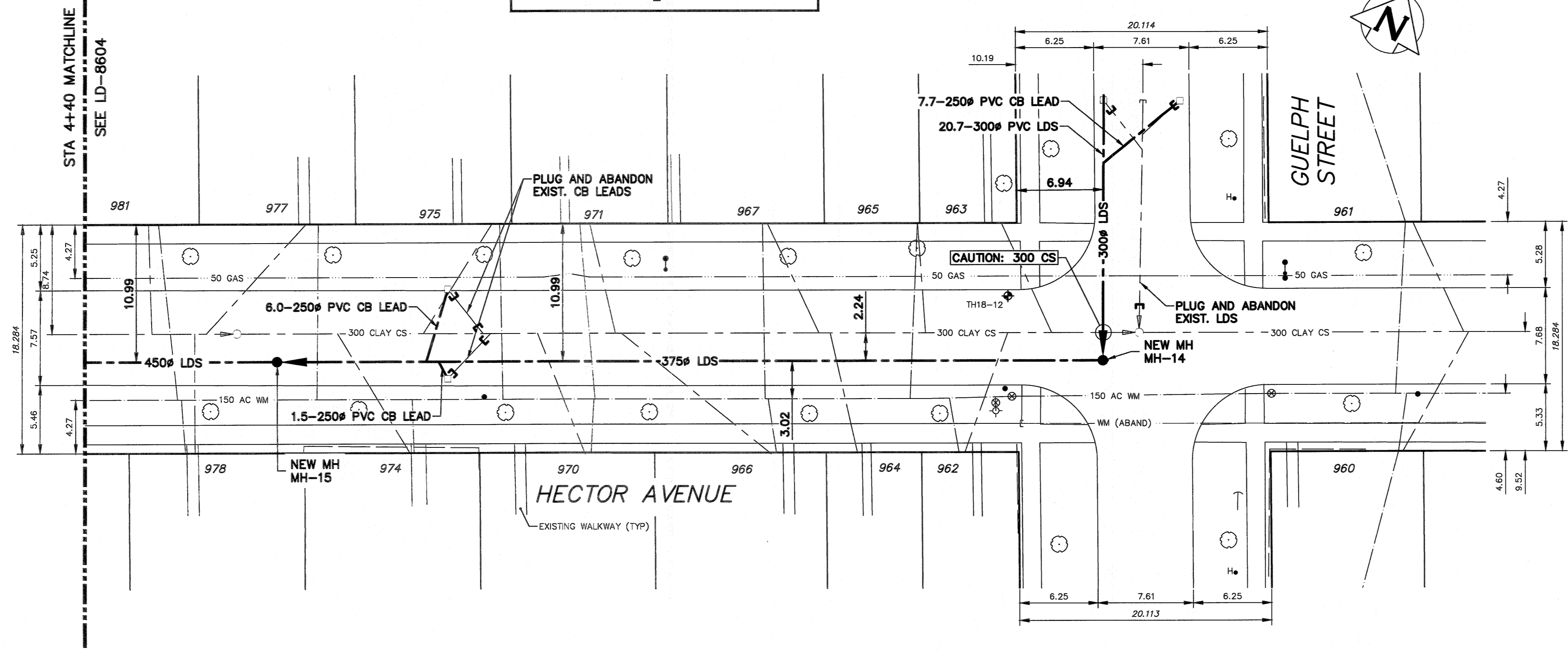

**ENGINEERS**  
GEOSCIENTISTS  
MANITOBA  
Certificate of Authorization  
KGS Group  
No. 245

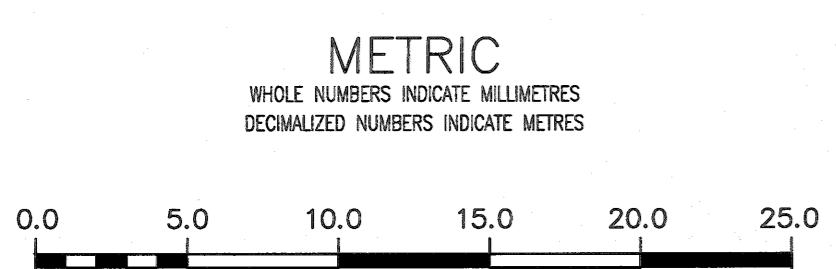

**PROPERTY LIMITS DELINEATION**  
DELINEATION OF PROPERTY LIMITS AS SHOWN ON THIS DWG DOES NOT REPRESENT A "LEGAL SURVEY". KGS GROUP MAKES NO REPRESENTATION OR WARRANTY AS TO THE ACCURACY OF PROPERTY LIMITS DELINEATED ON THIS DWG, NOR ON THE DIMENSIONAL ACCURACY OF DWG FEATURES RELATIVE TO THOSE PROPERTY LIMITS.

**WARNING**  
IF POWER EQUIPMENT OR EXPLOSIVES ARE TO BE USED FOR EXCAVATION ON THIS PROJECT THE CONTRACTOR MUST:  
1) NOTIFY THE GAS COMPANY OF THE PROPOSED LOCATION OF EXCAVATION.  
2) TAKE PRECAUTION TO AVOID DAMAGE TO GAS COMPANY INSTALLATIONS.  
SEE PROVINCIAL REGULATION 210/72 FOR DETAILS

**LOCATION APPROVED UNDERGROUND STRUCTURES**  
SUPV. U/G STRUCTURES COMMITTEE DATE  
NOTE:  
LOCATION OF UNDERGROUND STRUCTURES AS SHOWN ARE BASED ON THE BEST INFORMATION AVAILABLE BUT NO GUARANTEE IS GIVEN THAT ALL EXISTING UTILITIES ARE SHOWN OR THAT THE GIVEN LOCATIONS ARE EXACT. CONFIRMATION OF EXISTENCE AND EXACT LOCATION OF ALL SERVICES MUST BE OBTAINED FROM THE INDIVIDUAL UTILITIES BEFORE PROCEEDING WITH CONSTRUCTION.

B.M. ELEV.	
DESIGNED BY	MID
CHECKED BY	<i>jm</i>
DRAWN BY	GEL
APPROVED BY	<i>RSD</i>
SCALE:	
HORIZONTAL	1:250
VERTICAL	1:50
ISSUED FOR CONSTRUCTION	2018 08 17
DATE	2018 08 17
BY	<i>jm</i>
NO.	REVISIONS

**KGS GROUP**  
CONSULTING ENGINEERS

DESIGNED BY MID  
CHECKED BY *jm*  
DRAWN BY GEL  
APPROVED BY *RSD*  
SCALE: HORIZONTAL 1:250, VERTICAL 1:50  
ISSUED FOR CONSTRUCTION 2018 08 17  
DATE 2018 08 17  
BY *jm*

ENGINEER'S SEAL  
CONSULTANT DRAWING NUMBER  
11-0107-18-C11\_LD-8605

**THE CITY OF WINNIPEG**  
WATER AND WASTE DEPARTMENT  
ENGINEERING DIVISION

**COCKBURN & CALROSSIE SEWER RELIEF WORKS**  
CONTRACT 11  
**HECTOR AVENUE**  
HECTOR BAY EAST TO GUELPH STREET  
STA 4+40 TO GUELPH STREET

SHEET 12 OF 22  
CITY DRAWING NUMBER  
LD-8605