

NOTES:

1. RENEW RISERS OF THE EXISTING COMBINED SEWER MANHOLE IN THE OPEN EXCAVATION IF SHAFT LOCATION ENCLOSES ON TO THE CS.
2. MIN 1.0 CLEARANCE TO BE MAINTAINED BETWEEN SHAFT SHORING AND 150mm MAIN GAS LINE.

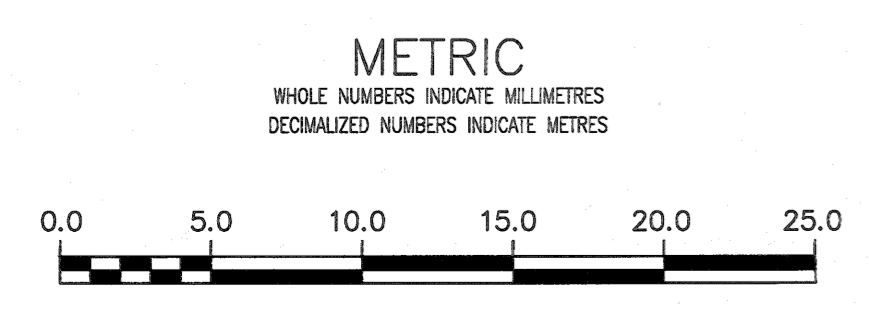
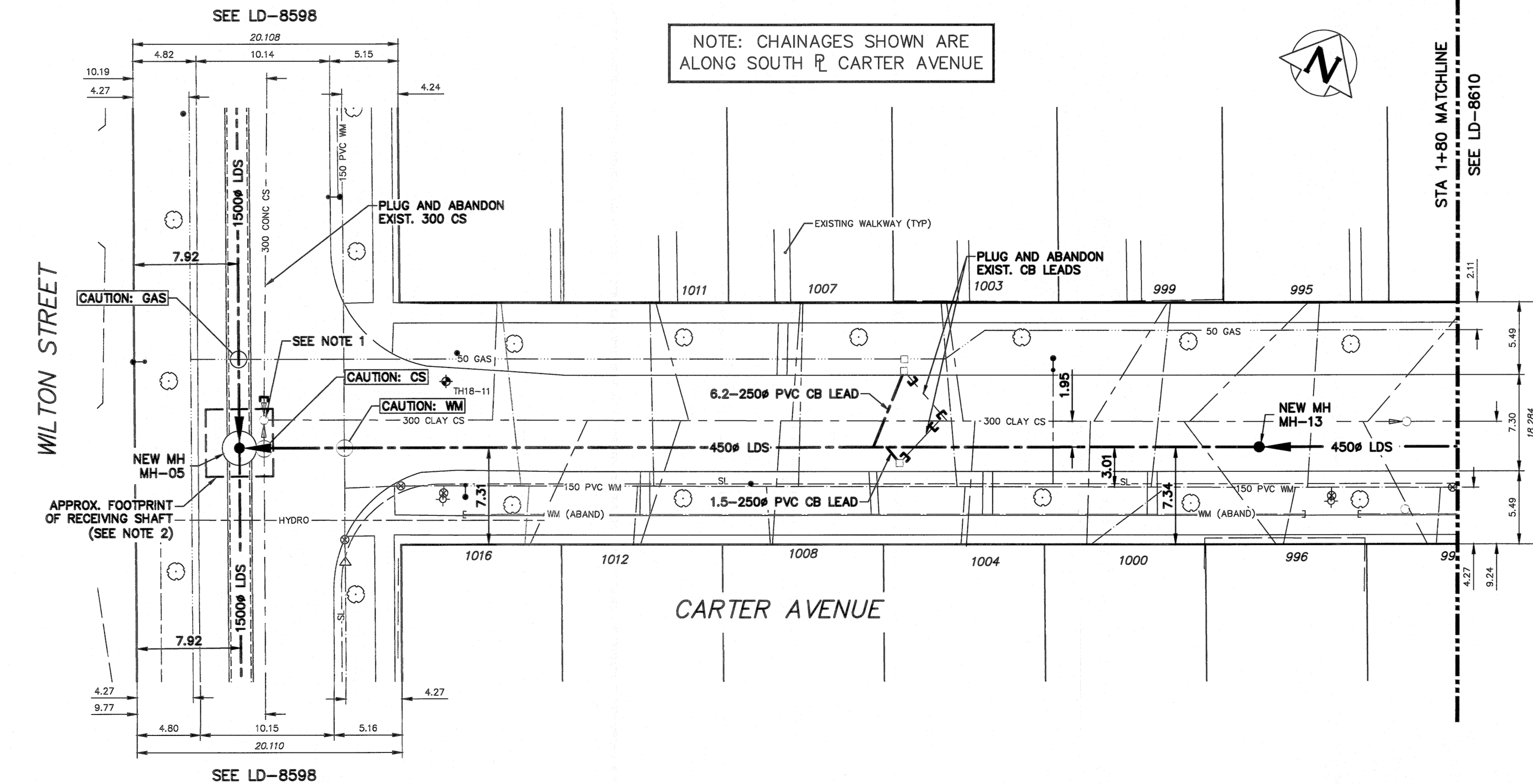

PROPERTY LIMITS DELINEATION
DELINEATION OF PROPERTY LIMITS AS SHOWN ON THIS DWG DOES NOT REPRESENT A "LEGAL SURVEY". KGS GROUP MAKES NO REPRESENTATION OR WARRANTY AS TO THE ACCURACY OF PROPERTY LIMITS DELINEATED ON THIS DWG, NOR ON THE DIMENSIONAL ACCURACY OF DWG FEATURES RELATIVE TO THOSE PROPERTY LIMITS.

WARNING
IF POWER EQUIPMENT OR EXPLOSIVES ARE TO BE USED FOR EXCAVATION ON THIS PROJECT THE CONTRACTOR MUST:
1) NOTIFY THE GAS COMPANY OF THE PROPOSED LOCATION OF EXCAVATION.
2) TAKE PRECAUTION TO AVOID DAMAGE TO GAS COMPANY INSTALLATIONS.
SEE PROVINCIAL REGULATION 210/72 FOR DETAILS

LOCATION APPROVED UNDERGROUND STRUCTURES
SUPV. U/G STRUCTURES COMMITTEE DATE
NOTE: LOCATION OF UNDERGROUND STRUCTURES AS SHOWN ARE BASED ON THE BEST INFORMATION AVAILABLE BUT NO GUARANTEE IS GIVEN THAT ALL EXISTING UTILITIES ARE SHOWN OR THAT THE GIVEN LOCATIONS ARE EXACT. CONFIRMATION OF EXISTENCE AND EXACT LOCATION OF ALL SERVICES MUST BE OBTAINED FROM THE INDIVIDUAL UTILITIES BEFORE PROCEEDING WITH CONSTRUCTION.

B.M. ELEV.	NO.	ISSUED FOR CONSTRUCTION	DATE	BY
	0	ISSUED FOR CONSTRUCTION	2018 08 17	Jm
		REVISIONS	DATE	BY

DESIGNED BY	MID	CHECKED BY	Jm
DRAWN BY	GEL	APPROVED BY	RBO
SCALE:	HORIZONTAL 1:250 VERTICAL 1:50		
DATE	2018 08 17	DATE	20-17-19

KGS GROUP CONSULTING ENGINEERS
ENGINEER'S SEAL
PROVINCE OF MANITOBA
MINKEVICH
Member
22769
PROFESSIONAL ENGINEER
CONSULTANT DRAWING NUMBER
11-0107-18-C11_LD-8609

THE CITY OF WINNIPEG
WATER AND WASTE DEPARTMENT
ENGINEERING DIVISION
COCKBURN & CALROSSIE SEWER RELIEF WORKS
CONTRACT 11
CARTER AVENUE
WILTON STREET TO GUELPH STREET
WILTON STREET TO STA 1+80
SHEET 16 OF 22
CITY DRAWING NUMBER
LD-8609

KGS ENGINEERS GEOSCIENTISTS MANITOBA
Certificate of Authorization
KGS Group
No. 245