

Crescent Drive Park Pavilion

Crescent Drive Park, 781 Crescent Drive, Winnipeg, MB



CONCEPTUAL RENDERING

DRAWING LIST

ARCHITECTURAL & LANDSCAPE

A-000	TITLE SHEET
A-SP1	ARCHITECTURAL SPECIFICATION
A-SP2	ARCHITECTURAL SPECIFICATION
L-001	LANDSCAPE ARCHITECTURAL SPECIFICATIONS
L-100	REMOVALS PLAN
L-101	GRADING, PLANTING, AND MATERIALS PLAN
L-501	DETAILS
A-200	FLOOR PLAN
A-201	REFLECTED CEILING PLAN, ROOF PLAN
A-300	BUILDING SECTIONS
A-400	ELEVATIONS
A-500	WALL SECTIONS & DETAILS
A-700	INTERIOR ELEVATIONS

STRUCTURAL

S-0	GENERAL NOTES & DETAILS
S-1	FOUNDATION FRAMING PLAN
S-2	MAIN FLOOR FRAMING PLAN
S-3	ROOF FRAMING PLAN
S-4	ELEVATION & BUILDING SECTIONS
S-5	BUILDING SECTIONS
S-6	BUILDING SECTIONS & ELEVATIONS

MECHANICAL

M-0	MECHANICAL LEGEND AND DRAWING LIST
M-1.1	MAIN FLOOR PLUMBING PLAN
M-2.1	MAIN FLOOR HVAC PLAN
M-3.1	MECHANICAL SPECIFICATION
M-3.2	MECHANICAL SPECIFICATION

ELECTRICAL

EL-0	ELECTRICAL SYMBOL LEGEND, DRAWING LIST AND SCHEDULES
EL-2.0	MAIN FLOOR - LIGHTING LAYOUT
EP-2.0	MAIN FLOOR - POWER AND SYSTEMS LAYOUT
ES-0	ELECTRICAL SPECIFICATION

PROJECT DESCRIPTION

The Crescent Drive Park Pavilion is a 208 sq. m, universally accessible public facility including a four season washroom (conditioned area of 72 sq. m), unconditioned change room, and a fire pit area. The washrooms (men's, women's, and a universal toilet room) and attached mechanical room are separated from an unconditioned change room by an outdoor covered patio. The building is wood construction. The siding/wall system is composed of vertical rough sawn douglas fir, with interior siding panels composed of polished finish EIFS.

CIVIC ADDRESS: 781 Crescent Drive, Crescent Drive Park

LEGAL DESCRIPTION

Firstly part public park plan 11355 WLTO
EXC: Plan 54553 WLTO in RL 24 to 30 Parish of St. Vital

Secondly parcels A, B, C, D, & E, Plan 54553 WLTO in RL 24 to 27 Parish of St. Vital

CERTIFICATE OF TITLE: No. 267438/1/1 in part WLTO

FLOOD PROTECTION LEVEL: 231.35

LOWEST FINISHED FLOOR LEVEL: 231.35

EXEMPTION FROM FPL. REFER TO DESIGNATED FLOODWAY AREA REGULATION SECTION 1 DEFINITIONS "STRUCTURE" (b).

Manitoba Building Code

Tenant: City of Winnipeg
Address: Crescent Drive Park, 781 Crescent Drive, Winnipeg, MB
Building Area: 208 sq. m (72 sq. m conditioned space).

Building Height: 1 storey

This project is governed by the National Building Code of Canada 2010 (NBC) - Division B, Part 9, Group D as adopted by the Manitoba Building Code of 2011, Part 3.8 accompanied by the MBC (2011) amendments appropriate where applicable.

GENERAL NOTES

- All existing dimensions are plus/minus and are to be confirmed by the Contractor on Site.
- The Contractor shall verify the location of all site services with their respective utility companies prior to commencement of Work. Coordinate with Contract Administrator and subtrades for service tie-ins.
- Patch and make good all surfaces affected by installation and construction of adjacent disciplines should any surfaces be damaged through the course of construction and transportation.
- Clean up all construction debris from the Site and repair any damage to the Site resulting from construction upon completion of the Work.
- Provide protective site hoarding until occupancy is issued.
- All topographic data provided is approximate and is to be verified prior to construction.
- Contract Administrator to verify Site layout and location prior to commencement of construction.
- Contractor to obtain all permits.
- All dimensions are to gridline or face of finished assembly unless otherwise noted.

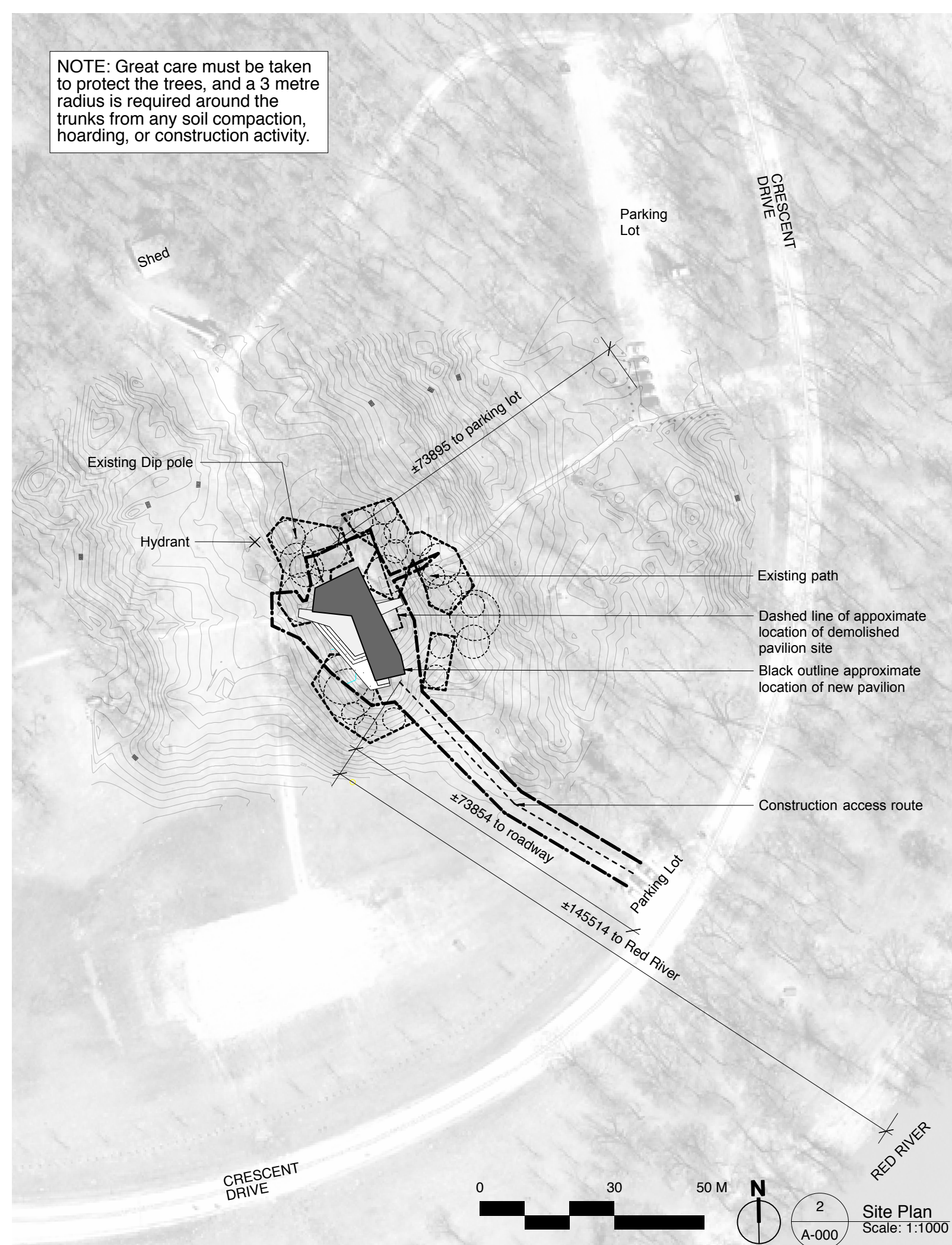

TAG	FIRE	STC	THERMAL	DIAGRAM	DESCRIPTION
PARTITION ASSEMBLIES					
P1	N/A	N/A	N/A		Partition 16mm fibreglass faced GWB 38mm x 89mm wood studs @ 610mm O/C 16mm fibreglass faced GWB
P2	N/A	36	N/A		Plumbing Partition 16mm fibreglass faced GWB 38mm x 140mm wood studs @ 610mm O/C 100mm acoustic mineral wool 16mm fibreglass faced GWB
P3	N/A	36	N/A		Plumbing Partition 16mm fibreglass faced GWB 38mm x 140mm wood studs @ 610mm O/C 20mm cavity 38mm x 140mm wood studs @ 610mm O/C 100mm acoustic mineral wool (both rows of stud) 16mm fibreglass faced GWB
WALL ASSEMBLIES					
W1	N/A	N/A	N/A		Wood Slat Firepit Area Wall 75mm x 150mm vertical fir rough sawn lumber @ 75mm O/C Steel Structure - See Structural
W2	N/A	N/A	N/A		Wood Slat Change Room Wall (Unconditioned) 75mm x 150mm vertical fir rough sawn lumber @ 50mm O/C 24 ga. Prefinished metal (black) lapped and sealed 13mm exterior grade plywood 38mm x 140mm wood studs @ 610mm O/C 13mm exterior grade plywood 35mm specified EIFS (polished plaster finish)
W3	N/A	N/A	R-19		Wood Slat Washroom Wall 38mm x 76mm vertical fir rough sawn lumber @ 25mm O/C 24 ga. Prefinished metal (black) lapped and sealed 13mm exterior grade plywood 38mm x 184mm wood studs @ 610mm O/C 38mm x 25mm vertical wood shims at each stud 140mm Closed cell type-2 spray foam insulation 16mm fibreglass faced GWB
W4	N/A	N/A	R-27		Stucco (Polished Plaster) Washroom Wall 60mm specified EIFS system (polished plaster finish) 16mm exterior grade plywood 38mm x 140mm wood studs @ 610mm O/C 38mm x 25mm vertical wood shims at each stud 140mm closed cell type-2 spray foam insulation 16mm fibreglass faced GWB
W5	N/A	N/A	N/A		Wood Slat Wall Hung from Structure Rough sawn vertical fir slats, size varies 13mm spacers Structure varies
W6	N/A	N/A	N/A		Stucco (Polished Plaster) Change Room Wall 60mm specified EIFS system (polished plaster finish) 13mm exterior grade plywood 38mm x 140mm wood studs @ 610mm O/C 13mm exterior grade plywood 35mm specified EIFS inside face (polished plaster finish)
FLOOR ASSEMBLIES					
F1	N/A	N/A	N/A		Washrooms and Mechanical Room Floor -Structural concrete slab -10mil poly vapour barrier -Voidform
ROOF ASSEMBLIES					
R1	N/A	N/A	N/A		-Ballast -Protection Mat -EPDM roof membrane -13mm exterior grade plywood -38mm x 140mm D fir 1x6 wood decking -Wood joist (see Structural)

ABBREVIATIONS:

ACT	Acoustic ceiling tile	I/I	Inside to inside
AFC	At finished ceiling	LF	Light fixture
ACRY	Acrylic	MG	Mechanical grille
AFF	At finished floor	MIR	Mirror
AH	Access hatch	MTL	Metal
ALUM	Aluminum	N/C	Not in contract
AP	Access panel	O/C	On centre
AR	Abuse resistant	O/F	Outside face
BB	Base board	O/H	Overhead
BH	Base board heater	O/O	Outside to outside
BF	Barrier free	OTR	Open to above
B/O	Bottom of	PC	Polycarbonate
CB	Cove base	PNT	Paint
CIP	Cast in place	PT	Pressure treated
CJ	Control joint	PTL	Push to lock button
CLG	Ceiling	PW	Plywood
COL	Column	RB	Rubber base
CONC	Concrete	RD	Roof drain
CAW	Complete with	RH	Robe hook
DF	Drinking fountain	R/O	Rough opening
DO	Door operator	RWL	Rain water leader
DN	Down	SD	Soap dispenser
EFIS	Exterior Insulation Finish System	SIM	Similar
EHD	Electric hand dryer	SN	Sanitary napkin disposal
ES	Each side	SP	Splash pad
EP	Electrical panel	SS	Stainless steel
EPT	Epoxy paint	ST	Stain
FE	Fire extinguisher	STL	Steel
FD	Floor drain	T/O	Top of
FB	Grab bar	TP	Toilet paper dispenser
GWB	Gypsum wall board	TPTN	Toilet Partition
HB	Hose bib	TYR	Typical
HDM	Hydro meter	U/S	Underside
HM	Hollow metal	VOS	Verify on site
HP	Hydro pole	WD	Wood
HSS	Hollow steel section	WG	Wall grille
HT	Recessed Heater	WP	Water proof
I/F	Inside face	WR	Waste receptacle
		X	Existing

OWNER:

THE CITY OF WINNIPEG
185 KING ST
WINNIPEG, MB
R3B 1J1
(204) 794-4418
(204) 986-4354

CONTRACT ADMINISTRATOR (ARCHITECT & LANDSCAPE ARCHITECT):

PUBLIC CITY ARCHITECTURE
707 SARA AVENUE
WINNIPEG, MB
R3G 0Y8
(204) 475-9323

Contract Administrator: Tim Horton
Architect: Peter Sampson
Landscape Architect: Liz Wreford

STRUCTURAL CONSULTANT:

WOLF FROM ENGINEERING LTD.
345 WARDLAW AVENUE
WINNIPEG, MB
R3L 0L5
(204) 452-0041

MECHANICAL & ELECTRICAL CONSULTANTS:

MCW/AGE Consulting Professional Engineers
1821 WELLINGTON AVE #210
WINNIPEG, MB
R3H 0G4
(204) 779-7900

NO.	ROOM NAME	FLOORS		WALLS								CEILINGS	
		FLOOR	BASE	NORTH		EAST		SOUTH		WEST		MATERIAL	FINISH
				MATERIAL	FINISH	MATERIAL	FINISH	MATERIAL	FINISH	MATERIAL	FINISH		
01	WOMEN'S WASHROOM	EPOXY PNT	COVE	GWB	PNT	GWB	PNT	GWB	PNT	GWB	PNT	GWB	PNT
02	UTR	EPOXY PNT	COVE	GWB	PNT	GWB	PNT	GWB	PNT	GWB	PNT	GWB	PNT
03	MEN'S WASHROOM	EPOXY PNT	COVE	GWB	PNT	GWB	PNT	GWB	PNT	GWB	PNT	GWB	PNT
04	MECHANICAL ROOM	EPOXY PNT	COVE	GWB	PNT	GWB	PNT	GWB	PNT	GWB	PNT	GWB	PNT
05	COVERED PATIO	CONC. SEALED	-	STUCCO MILANO	-	STUCCO MILANO	-	STUCCO MILANO	-	STUCCO MILANO	-	WD DECK	-
06	UNINSULATED CHANGE RM	CONC. SEALED	-	STUCCO MILANO	-	STUCCO MILANO	-	STUCCO MILANO	-	STUCCO MILANO	-	WD DECK	-
07	OUTDOOR PATIO	CONC. SEALED	-	STUCCO MILANO	-	-	-	-	-	-	-	-	-

- Apply skim coat at all fibreglass faced GWB surfaces prior to painting.

Owner

City of Winnipeg
185 King Street
Winnipeg, Manitoba
R3B 1J1
(204) 794-4418

Rev. No.	Date	Revision Notes
0.	2018.07.27	Issued for Construction



This drawing must not be scaled. The contractor shall verify all dimensions and other data on site prior to commencement of work. Discrepancies, errors, and omissions are to be reported to Public City Architecture Inc. the copyright in this same being reserved.

Drawings and specifications as instruments of service are the property of Public City Architecture Inc. and when made, must bear their name. All prints to be returned to Public City Architecture Inc. upon request.

Project
Crescent Drive Park Pavilion

Drawing
Title Sheet

Drawn By
DB, TH
Scale
As Noted

Reviewed By
PS
Drawing No.
A-000

Date
2018.05.24

Project No.
1448