

Owner

City of Winnipeg  
185 King Street  
Winnipeg, Manitoba  
R3B 1J1  
(204) 794-4418

Rev. No.	Date	Revision Notes
0.	2018.07.27	Issued for Construction

### PLANTING LEGEND

Symbol	Common Name	Botanical Name	Size	Quantity	Spacing
	Joe Pye Weed	Eupatorium maculatum	1 gal.	77	450mm o.c.
	Basswood	Tilia americana	65mm cal.	3	As shown

### GRADING NOTES:

- All existing trees, shrubs, sidewalks, curbs, sod, utilities, and paving to be protected (unless otherwise noted) during construction to City of Winnipeg standards. Contractor to make good all areas damaged during construction both on and off site to City of Winnipeg standards at the Contractor's cost.
- Existing grade to be maintained at all property lines and City of Winnipeg sidewalks and within 3.0m of existing trees (unless otherwise noted).
- All grading to be approved by Contract Administrator prior to any construction.
- Exact location of underground services should be checked with the utilities prior to construction or excavation.
- Existing grades, building locations and layouts are given as information only and should be verified on site. Report any discrepancies to Contract Administrator prior to construction.
- All proposed elevations to be finished elevations.
- Ensure positive drainage in all areas to catchbasins and curb inlets or overland drainage.
- Elevations of all existing trees and utilities to remain, unless noted otherwise.
- Slope tolerance:  
- Concrete paving slopes: Maximum 5%, minimum 1%; maximum cross slope 1.5%  
- Sodded area slopes: Maximum 25%, minimum 2%  
- Any deviation from the above slopes to be approved by Contract Administrator prior to construction
- If power equipment is to be used for excavation on this project the Contractor must:  
a) Notify all utilities of the proposed location of excavation.  
b) Take precaution to avoid damage to all utilities
- Refer also to City of Winnipeg and written specifications.
- All new landscape surfaces to meet foundation walls, typ.

**CIVIC ADDRESS:**  
781 CRESCENT DRIVE, CRESCENT DRIVE PARK

**LEGAL DESCRIPTION:**  
FIRSTLY PART PUBLIC PARK PLAN 11355 WLTO  
EXC. PLAN 54553 WLTO IN RL 24 TO 30 PARISH OF ST.VITAL  
SECONDLY PARCELS A,B,C,D & E PLAN 54553 WLTO IN RL 24 TO 27  
PARISH OF ST.VITAL

**CERT. OF TITLE NO.** 2674381/1 IN PART WLTO

### NOTE:

- FLOOD PROTECTION LEVEL (FPL) = 231.35
- LOWEST FINISHED FLOOR ELEVATION (FFE) = 231.35
- EXEMPTION FROM FPL, REFER TO DESIGNATED FLOODWAY AREA REGULATION SECTION 1 DEFINITIONS "STRUCTURE" (b)

### GENERAL LEGEND

	Existing tree to be protected for the duration of construction. Refer to current City of Winnipeg "Tree Protection During Construction" specifications. Excavate by hand within 3.0m of existing trees, typ. Licensed and pre-approved arborist (as listed on City of Winnipeg UFB website) to root prune, as required by City of Winnipeg Forester.
	Mineral Sod City of Winnipeg CW 3510
	Concrete pavement Finish: Light broom finish Colour: Natural Sawcut Pattern: As shown
	1/4" down compacted black granite aggregate surfacing
	Planting bed
	Existing contour line
	Proposed contour line
	Limit of work
	Proposed concrete sawcut
	Existing geodetic elevation
	Proposed geodetic elevation
	Top of step
	Bottom of step
	Direction of flow
	Finished floor elevation

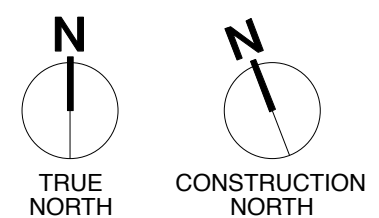

This drawing must not be scaled. The contractor shall verify all dimensions and other data on site prior to commencement of work. Discrepancies, errors, and omissions are to be reported to Public City Architecture Inc. prior to proceeding with the Work.

Drawings and specifications as instruments of service are the property of Public City Architecture Inc. and when made, must bear their name. All prints to be returned to Public City Architecture Inc. upon request.

Project  
**Crescent Drive Park Pavilion**

Drawing  
**Grading, Planting & Materials**

Drawn By TL	Reviewed By LW
Scale 1:75	Drawing No. <b>L-101</b>

Date 2018.07.27	Project No. 1448
--------------------	---------------------

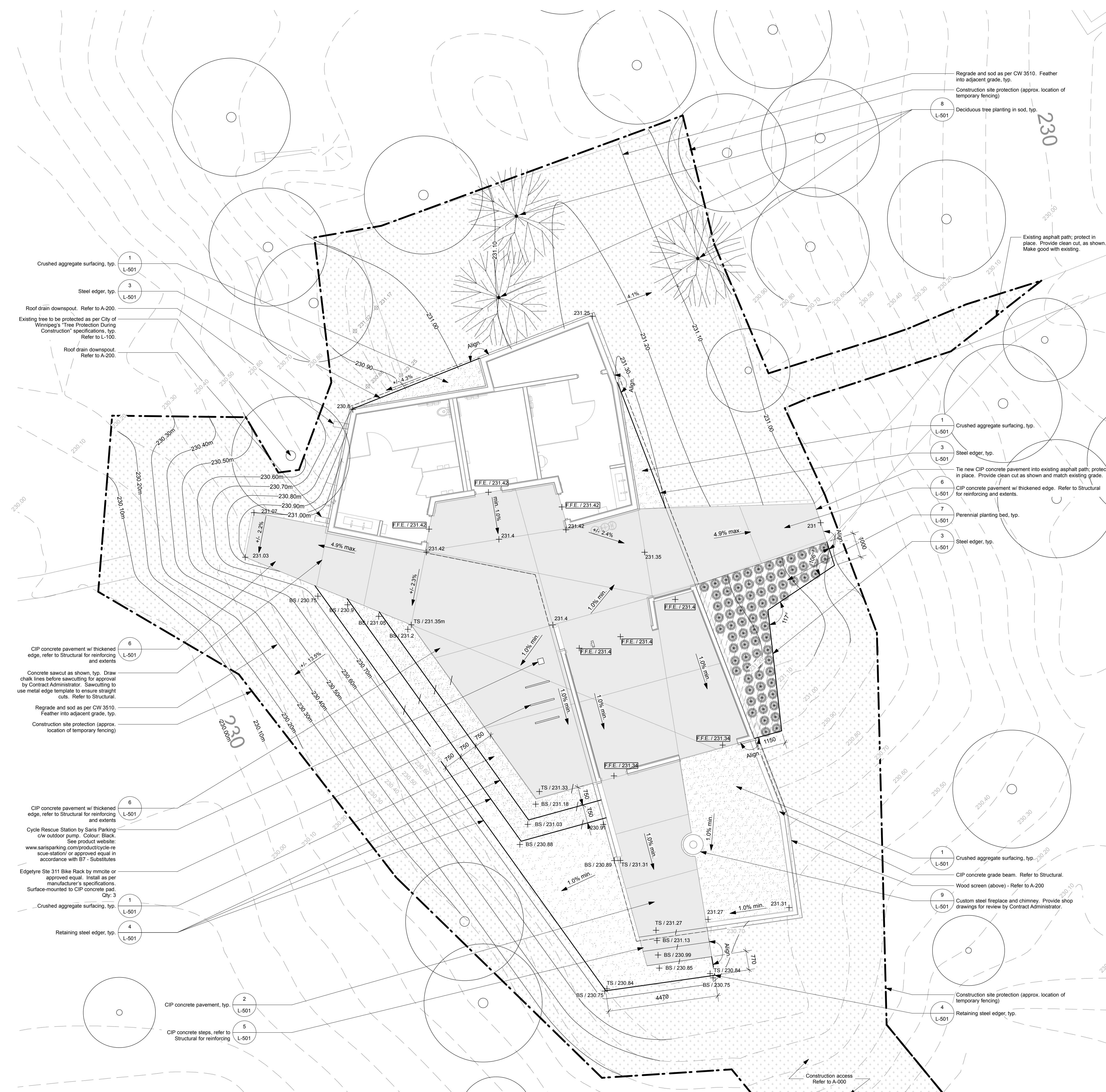

- 1 Crushed aggregate surfacing, typ. L-501
- 2 CIP concrete pavement, typ. L-501
- 3 Steel edger, typ. L-501
- 4 Retaining steel edger, typ. L-501
- 5 CIP concrete steps, refer to Structural for reinforcing L-501
- 6 CIP concrete pavement w/ thickened edge, refer to Structural for reinforcing and extents L-501
- 7 Perennial planting bed, typ. L-501
- 8 Deciduous tree planting in sod, typ. L-501
- 9 Custom steel fireplace and chimney. Provide shop drawings for review by Contract Administrator. L-501
- 10 Construction site protection (approx. location of temporary fencing) L-501

- 1 Crushed aggregate surfacing, typ. L-501
- 2 CIP concrete pavement, typ. L-501
- 3 Steel edger, typ. L-501
- 4 Retaining steel edger, typ. L-501
- 5 CIP concrete steps, refer to Structural for reinforcing L-501
- 6 CIP concrete pavement w/ thickened edge, refer to Structural for reinforcing and extents L-501

- 6 CIP concrete pavement w/ thickened edge, refer to Structural for reinforcing and extents L-501
- 7 Perennial planting bed, typ. L-501
- 8 Deciduous tree planting in sod, typ. L-501

- 6 CIP concrete pavement w/ thickened edge, refer to Structural for reinforcing and extents L-501
- 7 Perennial planting bed, typ. L-501
- 8 Deciduous tree planting in sod, typ. L-501

- 1 Crushed aggregate surfacing, typ. L-501
- 2 CIP concrete pavement, typ. L-501
- 3 Steel edger, typ. L-501
- 4 Retaining steel edger, typ. L-501
- 5 CIP concrete steps, refer to Structural for reinforcing L-501
- 6 CIP concrete pavement w/ thickened edge, refer to Structural for reinforcing and extents L-501