

FILE NAME: 18-0107-006_S02.dwg DATE: 2018.05.16 PROJECT No: 18-0107-006 SHEET TITLE: STAIR ELEVATION AND DETAILS ADDRESS: 25 POSEIDON BAY

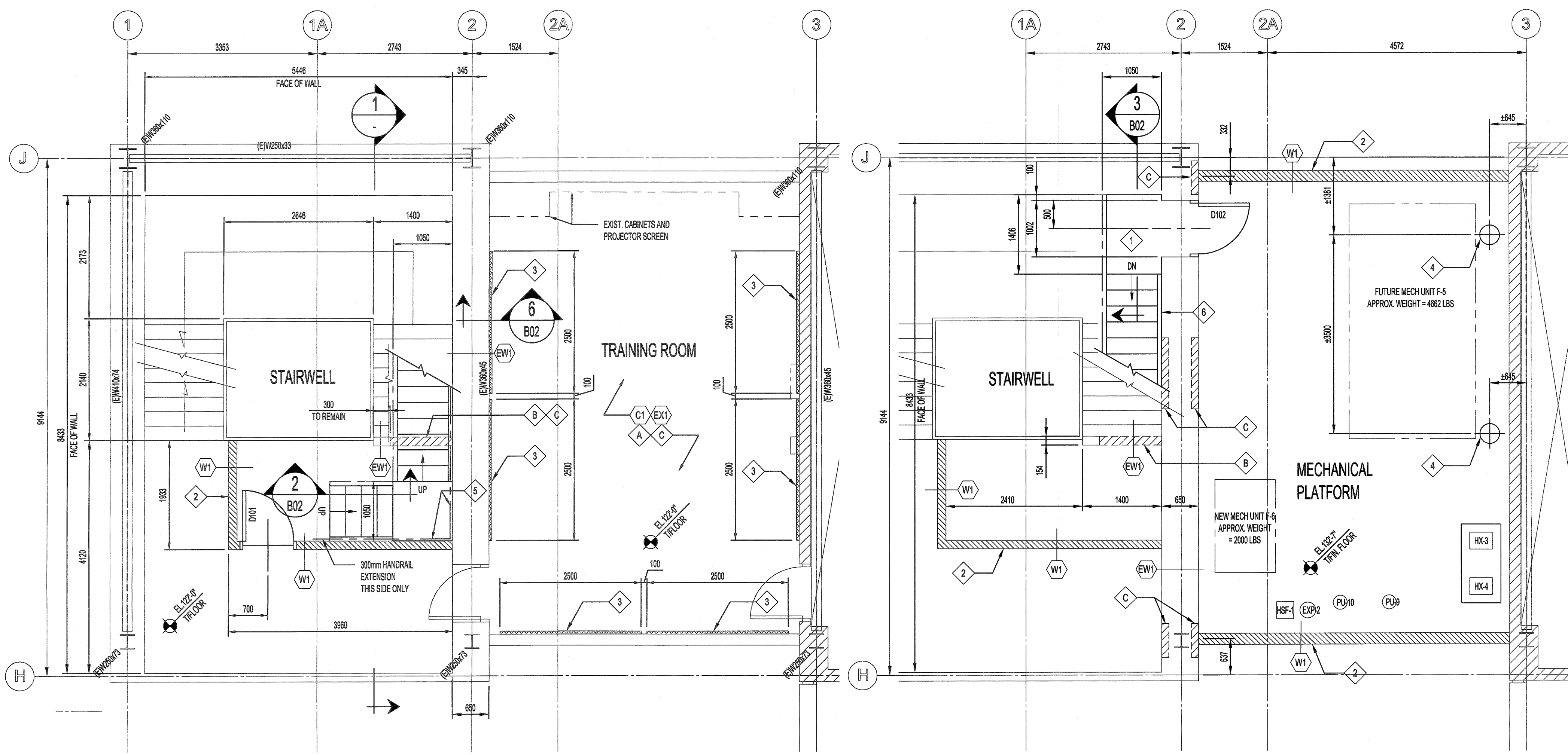

PARTIAL MEZZANINE FLOOR PLAN
SCALE 1:50

MECHANICAL PLATFORM PLAN
SCALE 1:50

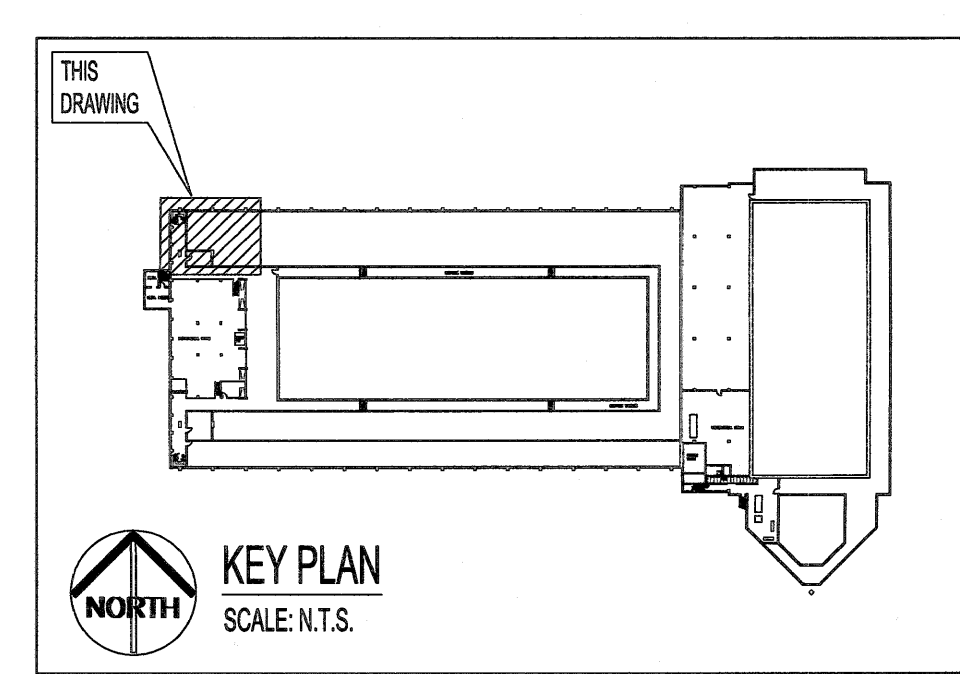

- DEMOLITION KEYNOTES:**
- ◇ A DEMOLISH EXISTING PLASTER CEILING (ASBESTOS) AND FRAMING SUPPORTS IN TRAINING ROOM TO INSTALL NEW BEAMS & CONNECTIONS.
 - ◇ B DEMOLISH 840mm HIGH x 1100mm WIDE EXISTING PLASTER & METAL LATH (ASBESTOS) STEEL STUD WALL FOR NEW STAIR.
 - ◇ C AREA OF ASBESTOS CONTAINING PLASTER TO BE REMOVED BY CITY OF WINNIPEG. ACTUAL AREAS TO BE REMOVED TO BE CONFIRMED BY THE CONTRACTOR BASED ON THEIR CONSTRUCTION METHODOLOGY.
- NEW CONSTRUCTION KEYNOTES:**
- ◇ 1 NEW 100mm CONCRETE TOPPING ON 38 DEEP STEEL DECK LANDING W/ PERIMETER ANGLE AND STEEL GUARDRAIL.
 - ◇ 2 NEW STEEL STUD WALL.
 - ◇ 3 DECOUSTICS ACOUSTICAL PAN MIN. 25mm THK CUT OUT 100mm COVER AROUND INTERFERING EXISTING MECHANICAL PIPING, AIR UNITS AND INTERCOM.
 - ◇ 4 NEW FLOOR OPENING (2) COORDINATE W/ MECHANICAL.
 - ◇ 5 NEW WALL MOUNTED HANDRAIL.
 - ◇ 6 NEW PRE-FABRICATED CONCRETE PAN STEEL STAIR AND GUARDRAIL.

NOTES:

THESE DRAWINGS SHALL NOT BE SCALED.

THE CONTRACTOR SHALL VISIT THE SITE AND SATISFY ONESELF ALL DIMENSIONS, DATUM, AND DETAILED INFORMATION SHOWN ARE CORRECT.

THE CONTRACTOR IS TO REVIEW AND COORDINATE ALL ARCHITECTURAL, MECHANICAL, ELECTRICAL AND STRUCTURAL DRAWINGS FOR ADDITIONAL OPENINGS THROUGH FLOORS, WALLS, AND CEILINGS FOR DUCT, PIPE & ELECTRICAL RISERS AND ALL OPENINGS NOT SHOWN ON DRAWINGS.

ALL OPENINGS THROUGH THE FIRE SEPARATIONS AS A RESULT OF THE WORK OF THIS CONTRACT ARE TO BE FIRE STOPPED AND SEALED WITH ULC APPROVED FIRE STOPPING TO MAINTAIN THE INTEGRITY OF THE FIRE SEPARATION, AND PROVIDE AND SMOKE-TIGHT BARRIER.

ALL PRODUCTS AND MATERIALS TO BE USED AND INSTALLED SHALL CONFORM WITH MANUFACTURERS SPECIFICATIONS & APPLICABLE CODES.

THE CONTRACTOR SHALL BE RESPONSIBLE TO PATCH AND MAKE GOOD ALL EXISTING CONSTRUCTION AFFECTED BY THE REMOVAL OF ALL ITEMS FORMING THE PART OF THE RENOVATION WORK.

WHERE NEW FLOORING AND BASE IS TO BE INSTALLED IN EXISTING AREAS (REFER TO FLOOR PLAN AND ROOM SCHEDULE) THE EXISTING FLOORING SURFACE AND BASE MUST BE REMOVED, UNLESS OTHERWISE NOTED. ALL FLOOR SURFACES SHALL BE PREPARED IN ACCORDANCE TO MANUFACTURER'S RECOMMENDATIONS FOR INSTALLATION OF NEW FLOOR.

WHERE PAINTING OF EXISTING WALLS IS INDICATED ON THE ROOM SCHEDULE, THESE WALLS MUST BE CLEANED OF ANY EXISTING WALL COVERING, PATCHED & PREPARED TO ACCEPT NEW MATERIAL, UNLESS OTHERWISE NOTED.

LEGEND:

- ▨ EXISTING WALL AREA TO BE DEMOLISHED (CONTAINING ASBESTOS)
- ▨ NEW STEEL STUD WALL

WALL SCHEDULE:

- W1 INTERIOR WALL
13mm GYPSUM BOARD (PAINTED)
92mm STEEL STUDS @ 400 O.C.
13mm GYPSUM BOARD (PAINTED)
150mm HIGH RUBBER COVE BASE E.S.
- EW1 EXISTING PARTITION
PLASTER & METAL LATH (ASBESTOS)
STEEL STUDS (TRUSS TYPE)
PLASTER & METAL LATH (ASBESTOS)

CEILING SCHEDULE:

- C1 TRAINING ROOM CEILING - NEW CONSTRUCTION
38mm CARRYING CHANNELS @ 910 O.C.
19mm FURRING CHANNELS @ 400 O.C.
16mm GYPSUM BOARD (PAINTED)
- EC1 EXISTING CEILING
38mm CARRYING CHANNELS @ 910 O.C.
19mm FURRING CHANNELS @ 400 O.C.
METAL LATH
19mm CEMENT PLASTER (ASBESTOS)

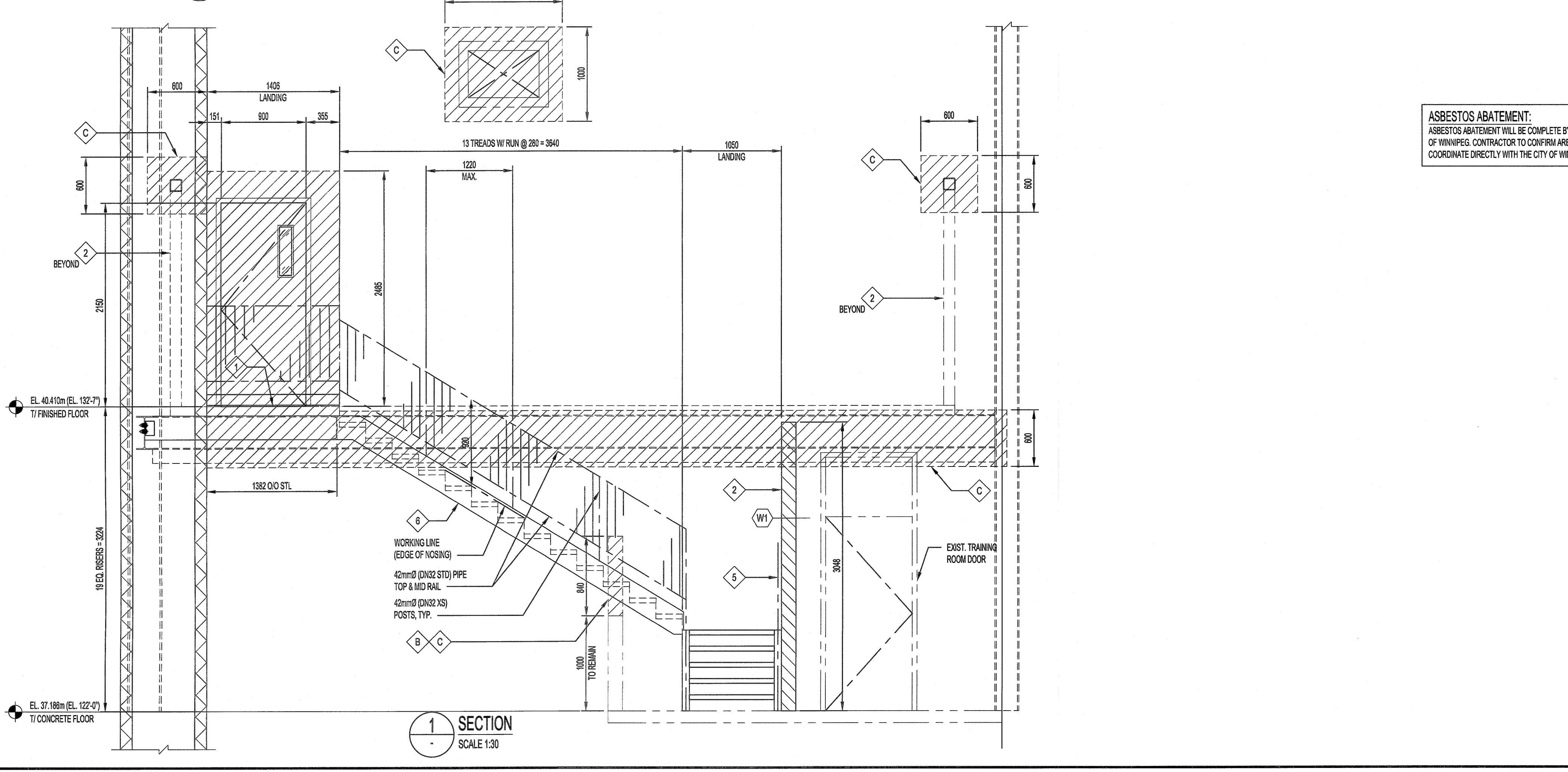

SECTION 1
SCALE 1:30

ASBESTOS ABATEMENT:
ASBESTOS ABATEMENT WILL BE COMPLETE BY THE CITY OF WINNIPEG. CONTRACTOR TO CONFIRM AREAS AND COORDINATE DIRECTLY WITH THE CITY OF WINNIPEG.

No.	REVISION/DESCRIPTION	BY	DATE
0	ISSUED FOR TENDER	RG	18.08.21

SEAL

2018-08-21

DRAWN: JAR, CHECKED: RG, DESIGNED: PPG, APPROVED: J.P.

DATE: 2018.05.16 USER: APPROVAL

THE CITY OF WINNIPEG
PLANNING, PROPERTY AND DEVELOPMENT DEPARTMENT
MUNICIPAL ACCOMMODATIONS DIVISION
3-65 GARRY STREET, R3C 4K4

PROJECT
BOILER ROOM
COMBUSTION AIR UPGRADE
AT PAN AM POOL
25 POSEIDON BAY

ENGINEERS
GEOSCIENTISTS
MANITOBA
Certificate of Authorization
KGS Group
No. 245

KGS GROUP
CONSULTING ENGINEERS

SHEET TITLE
BUILDING
MECHANICAL EQUIPMENT SUPPORT
PLANS & STAIR ELEVATION

SCALE AS SHOWN	PROJECT No: 18-0107-006	SHEET No: B01
-------------------	----------------------------	------------------