

Date & Time Plotted: Jun/19/2018 at 11:11 am - Plotted By: barujas
 File & Path: P:\2017\17M-01932-00 - 2018 Industrial Streets\11 WSP Dwg\17M-01932-00 C06-C11 Contract 2 Higgins Ave Plan and Profile.dwg-Current Layout Tab =17M-01932-00-C07

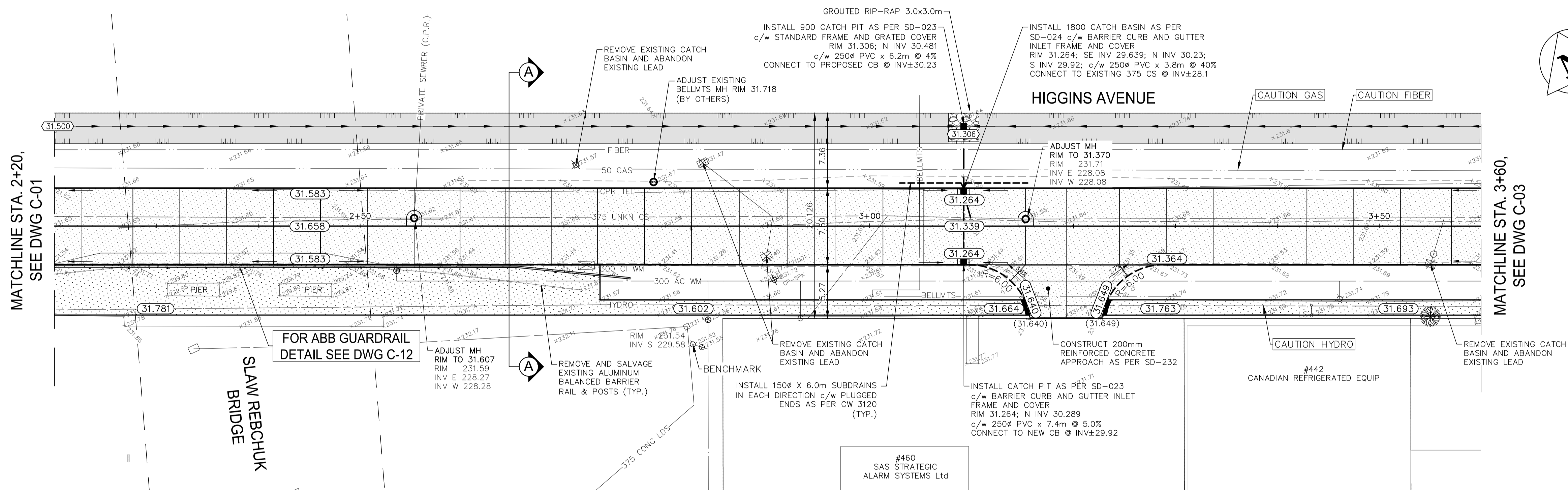
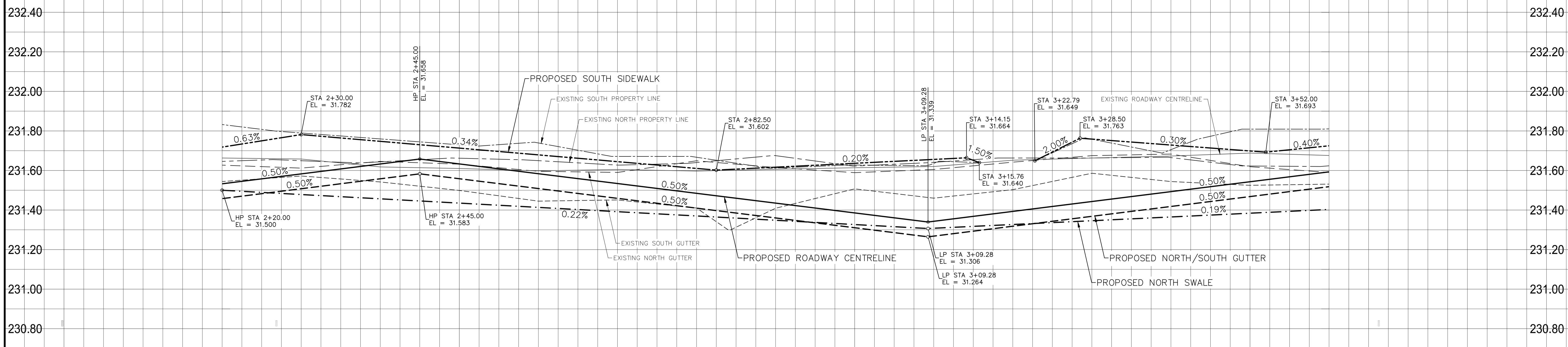

WATERMAIN RENEWAL TO BE COMPLETED IN 2018
BID OPPORTUNITY 134-2018

STREET LIGHTING RENEWAL TO BE COMPLETED BY MANITOBA HYDRO

NOTE: These design documents are prepared solely for the use by the party with whom the design professional has entered into a contract and there are no representations of any kind made by the design professional to any party with whom the design professional has not entered into a contract.

EXISTING	PROPOSED	EXISTING	LEGEND-PLAN	PROPOSED	EXISTING	LEGEND-PROFILE	PROPOSED
---	---	---	WATER MAIN	---	---	---	SWALE GRADE (31.255)
---	---	---	LAND DRAINAGE SEWER	---	---	---	SLOPE
---	---	---	WASTE WATER SEWER	---	---	---	DIRECTION FLOW
---	---	---	HYDRO	---	---	---	HYDRO POLE & LIGHT STANDARD
---	---	---	M.T.S.	---	---	---	LIGHT STANDARD OR TRAFFIC SIGNAL
---	---	---	GAS	---	---	---	HYDRO POLE
---	---	---	SIGNALS	---	---	---	CURB RAMP
○	○	○	MANHOLE	○	○	○	DETECTABLE WARNING SURFACE TILE
□	□	□	CATCH BASIN	□	□	□	EDGE OF SIDEWALK
△	△	△	CURB INLET	△	△	△	FENCE
○	○	○	UTILITIES ADJUSTED	○	○	○	PROPERTY LINE
⌋	⌋	⌋	PLUG	⌋	⌋	⌋	EDGE OF ASPHALT
◇	◇	◇	HYDRANT	◇	◇	◇	EDGE OF CONCRETE
⊗	⊗	⊗	VALVE	⊗	⊗	⊗	MODIFIED BARRIER CURB
⊙	⊙	⊙	CURB STOP	⊙	⊙	⊙	BARRIER CURB
230.99	230.99	230.99	GROUND GRADE	230.99	230.99	230.99	CONC SIDEWALK
(31.000)	(31.000)	(31.000)	PAVEMENT GRADE	(31.000)	(31.000)	(31.000)	CONCRETE SLAB
→	→	→	ANCHOR	→	→	→	ASPHALT OVERLAY
#111	#111	#111	CIVIC ADDRESS	#111	#111	#111	BULLNOSE
---	---	---	EXISTING LEGEND-PLAN	---	---	---	PROPOSED LEGEND-PROFILE

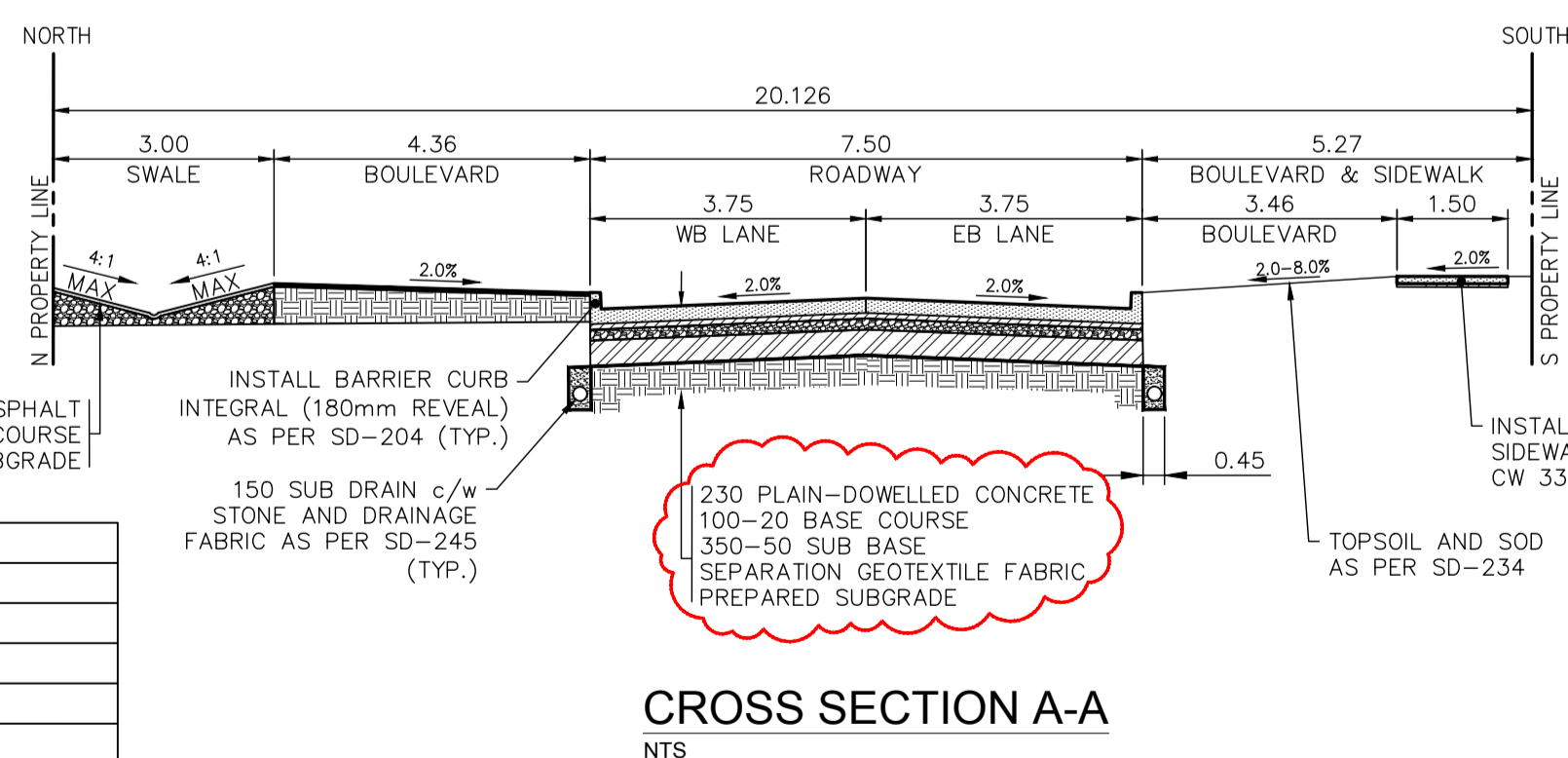

CROSS SECTION A-A
 NTS

LOCATIONS APPROVED UNDERGROUND STRUCTURES

SIGNED BY: _____ DATE: _____
 SUPP UG STRUCTURES

LOCATION OF UNDERGROUND STRUCTURES AS SHOWN ARE BASED ON THE BEST INFORMATION AVAILABLE BUT NO GUARANTEE IS GIVEN THAT ALL EXISTING UTILITIES ARE SHOWN OR THAT THE GIVEN LOCATIONS ARE EXACT CONFIRMATION OF EXISTENCE AND EXACT LOCATION OF ALL SERVICES MUST BE OBTAINED FROM THE INDIVIDUAL UTILITIES BEFORE PROCEEDING

NO.	REVISIONS	DATE	BY
H			
G			
F			
E			
D	ISSUED FOR ADDENDUM 3	2018-05-19	DS
C	ISSUED FOR TENDER	2018-05-29	DS
B	ISSUED FOR UGS REVIEW	2018-04-26	DS
A	ISSUE FOR CLIENT REVIEW	2018-04-13	DS

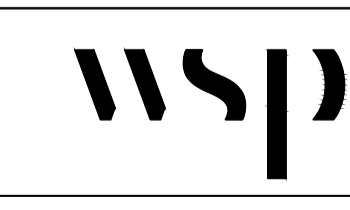

DESIGNED BY: **DS**
 DRAWN BY: **SB**
 CHECKED BY: **TP**
 APPROVED BY: **VM**
 HOR SCALE: **1:250**
 VERTICAL: **1:25**
 DATE: **2018-02-15**

NOTES:

- ALL WORK AND MATERIALS TO BE IN ACCORDANCE WITH THE LATEST REVISION OF THE CITY OF WINNIPEG STANDARD CONSTRUCTION SPECIFICATIONS.
- CONTRACTOR TO CONFIRM THE LOCATION OF ALL UTILITIES/SERVICES IN THE FIELD PRIOR TO CONSTRUCTION.
- ALL ROADWAY DIMENSIONS SHOWN ARE TO BACK OF CURB.
- ADD 200.00 TO ABBREVIATED ELEVATIONS TO OBTAIN GEODETIC ELEVATION.
- PAVEMENT REPAIRS SHOWN ARE ONLY A REPRESENTATIVE APPROXIMATION OF THE TENDERED QUANTITIES.
- ALL PRIVATE WALKWAYS TO BE ADJUSTED TO NEW SIDEWALK OR TOP OF CURB ELEVATION, AS REQUIRED.
- MODIFIED BARRIER CURB TO BE CONSTRUCTED AT ALL INTERSECTION RADII AND APPROACH RADII
- INSTALL 40MM LIP CURB THROUGH ALL APPROACHES UNLESS OTHERWISE NOTED.
- CONTRACTORS TO TAKE PRECAUTIONARY STEPS TO PROTECT EXISTING TREES WITHIN THE LIMITS OF CONSTRUCTION FROM DAMAGE FROM CONSTRUCTION ACTIVITIES AS OUTLINED IN THE SPECIFICATIONS.
- TRAFFIC SERVICES TO PAINT TRAFFIC LINES LANE MARKINGS (IF REQ'D).
- CONTRACTOR TO CONFIRM LOCATION AND LIMITS OF SEWER REPAIRS BY PERFORMING VIDEO INSPECTION AND REVIEWING WITH CONTRACT ADMINISTRATOR PRIOR TO CONSTRUCTION.
- ADJUST ALL WATER VALVES, HYDRANTS, MANHOLES, AND CATCH BASINS IN WORK AREA TO GRADE.
- INSULATE ALL LONG-WATER SERVICES UNLESS OTHERWISE NOTED.
- STREET LIGHTING RENEWAL TO BE COMPLETED BY MANITOBA HYDRO.
- CONTRACTOR TO NOTIFY CONTRACT ADMINISTRATOR AND FOLLOW SOIL MANAGEMENT PLAN IF CONTAMINATED SOIL IS ENCOUNTERED DURING EXCAVATION.

METRIC

WHOLE NUMBERS INDICATE MILLIMETRES
 DECIMALIZED NUMBERS INDICATE METRES



THE CITY OF WINNIPEG
 PUBLIC WORKS DEPARTMENT
 ENGINEERING SERVICES DIVISION

2018/2019 INDUSTRIAL STREETS RENEWAL PROGRAM
 HIGGINS AVENUE - HENRY AVE TO PRINCESS ST
 PAVEMENT RECONSTRUCTION
 STA. 2+20 TO STA. 3+60

CITY DRAWING NUMBER: ---
 SHEET: 07 OF 12
 BID NO.: 85-2018

CONSULTANT ACAD DWG. NO.: 17M-01932-00-C07