

1 E.O.C AREA SOUTH ELEVATION  
A2.2 SCALE: 3/8"=1'-0"

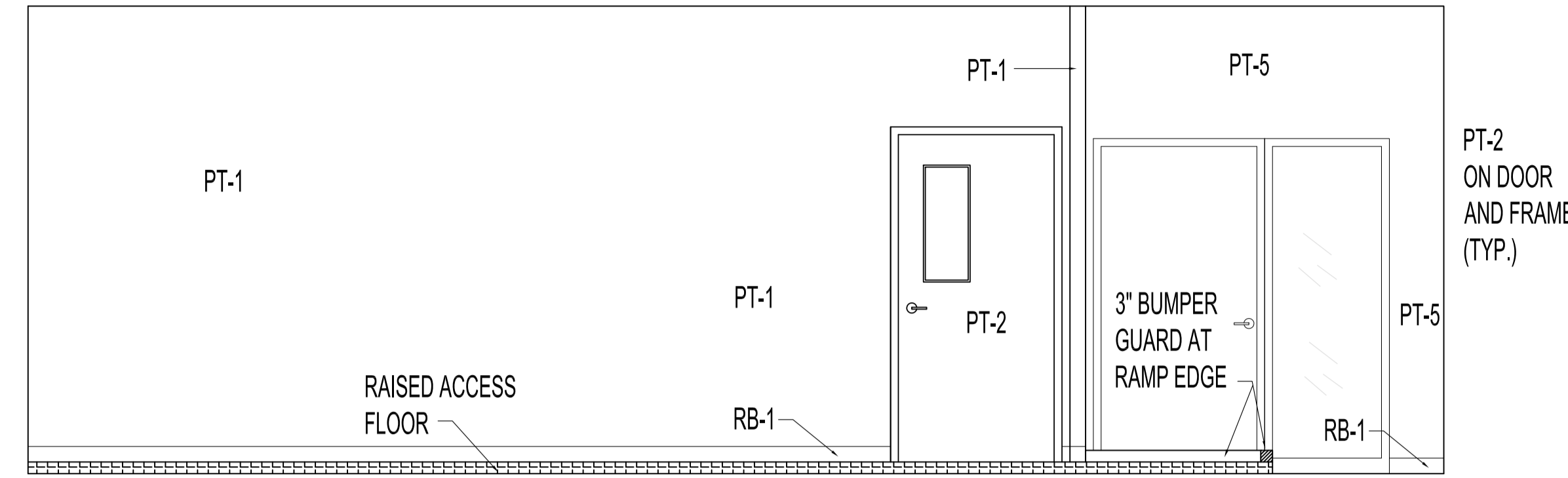

2 E.O.C AREA NORTH ELEVATION  
A2.2 SCALE: 3/8"=1'-0"

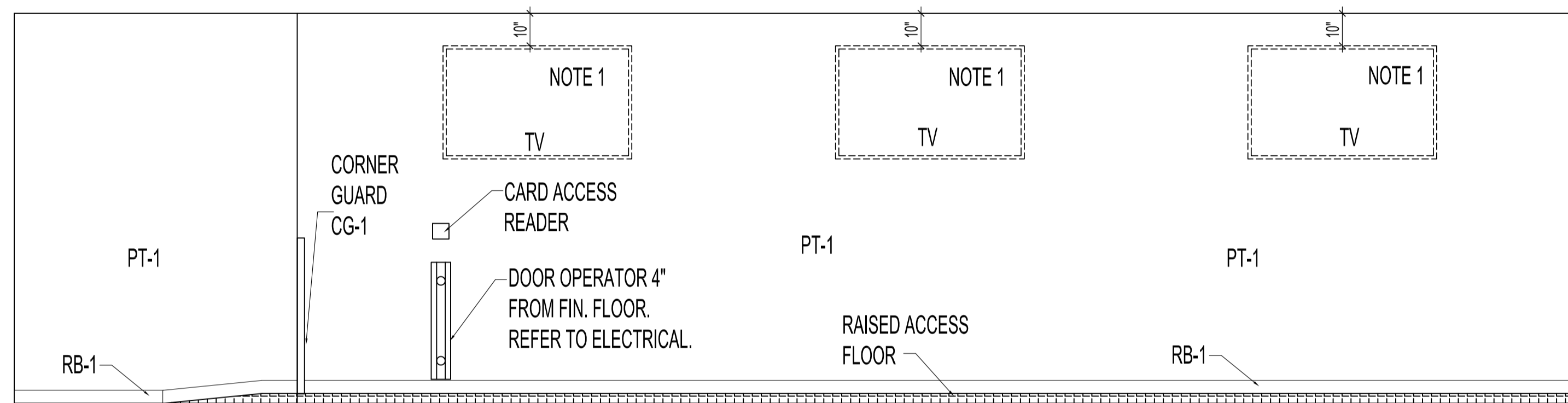

3 E.O.C AREA EAST ELEVATION  
A2.2 SCALE: 3/8"=1'-0"

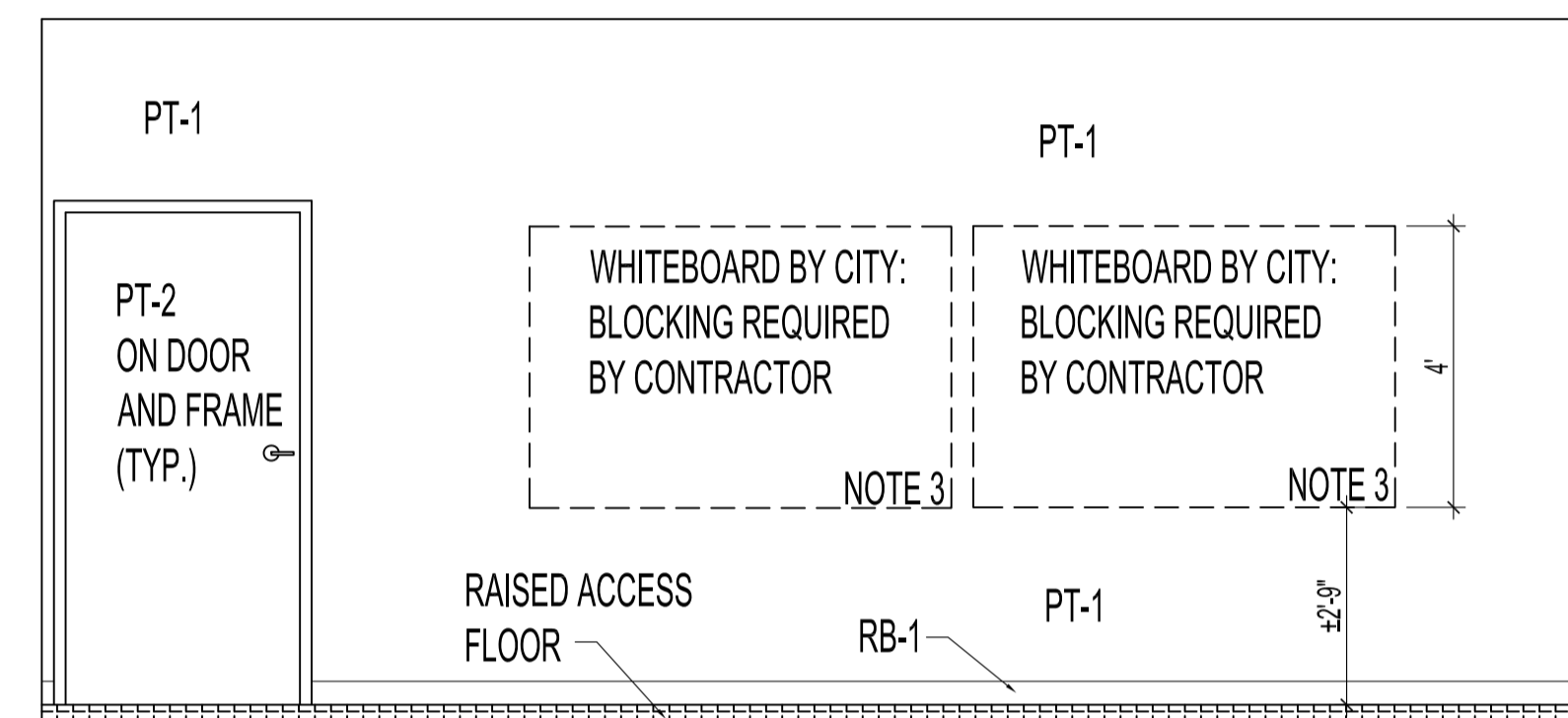

4 BREAK OUT ROOM  
A2.2 SCALE: 3/8"=1'-0"

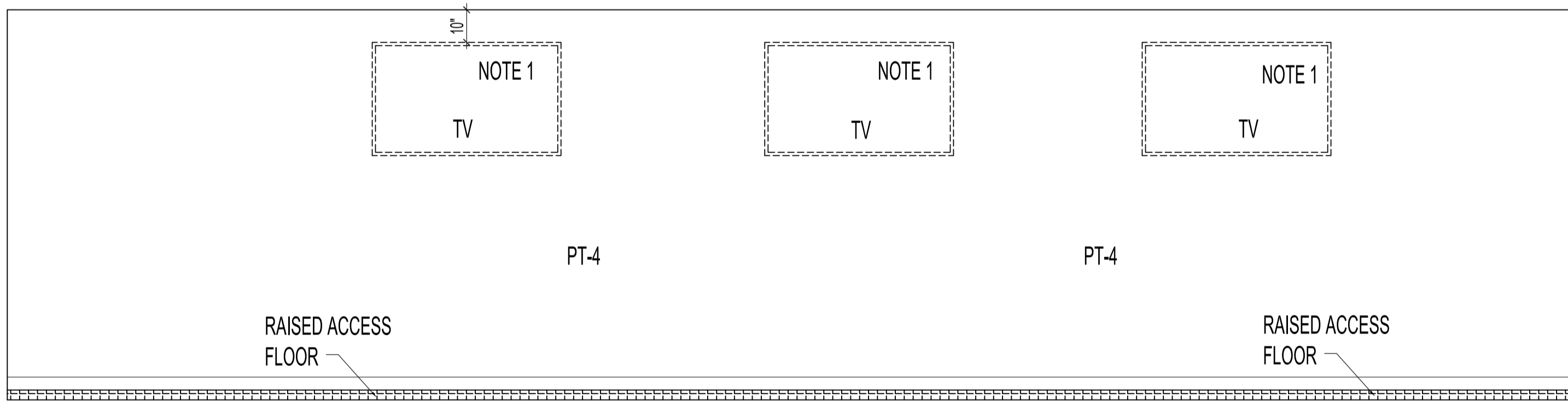

5 E.O.C AREA WEST ELEVATION  
A2.2 SCALE: 3/8"=1'-0"

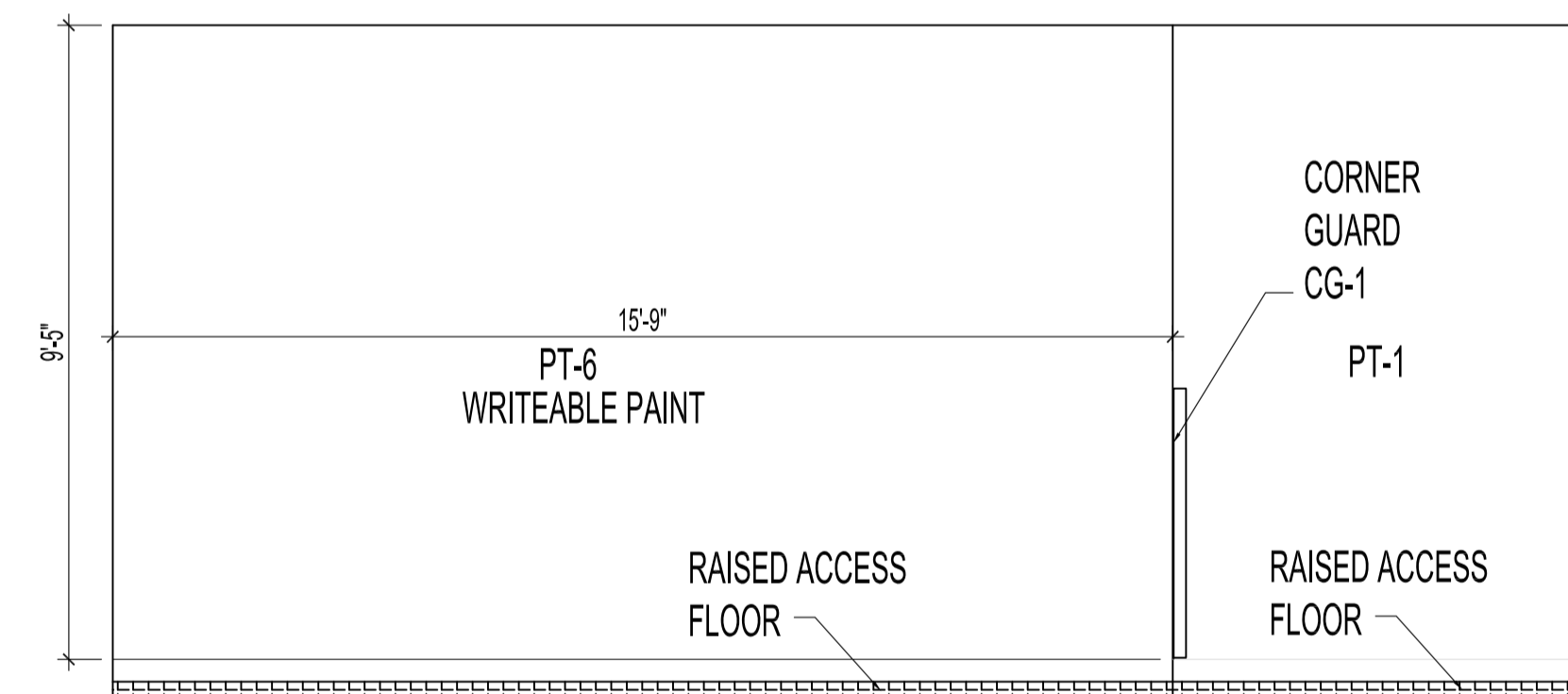

6 BREAK OUT ROOM  
A2.2 SCALE: 3/8"=1'-0"

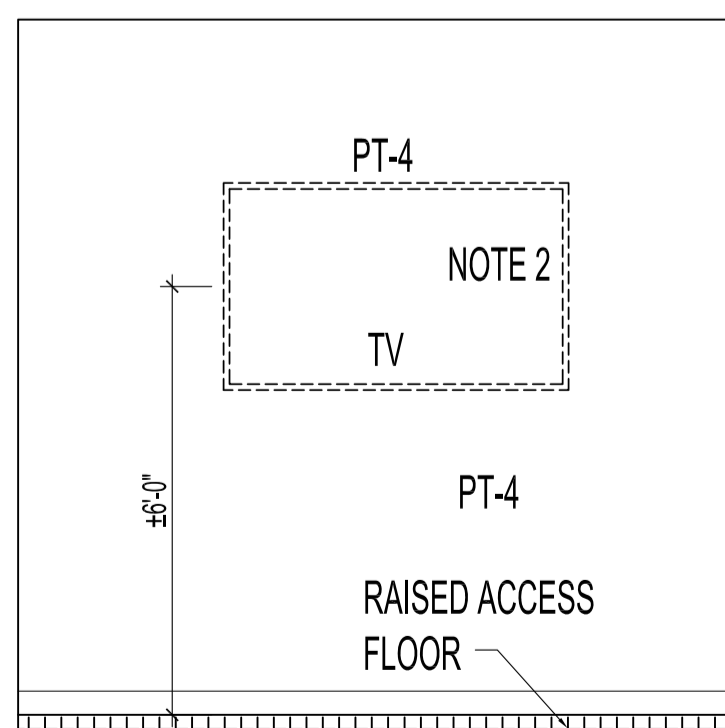

7 BREAK OUT ROOM  
A2.2 SCALE: 3/8"=1'-0"

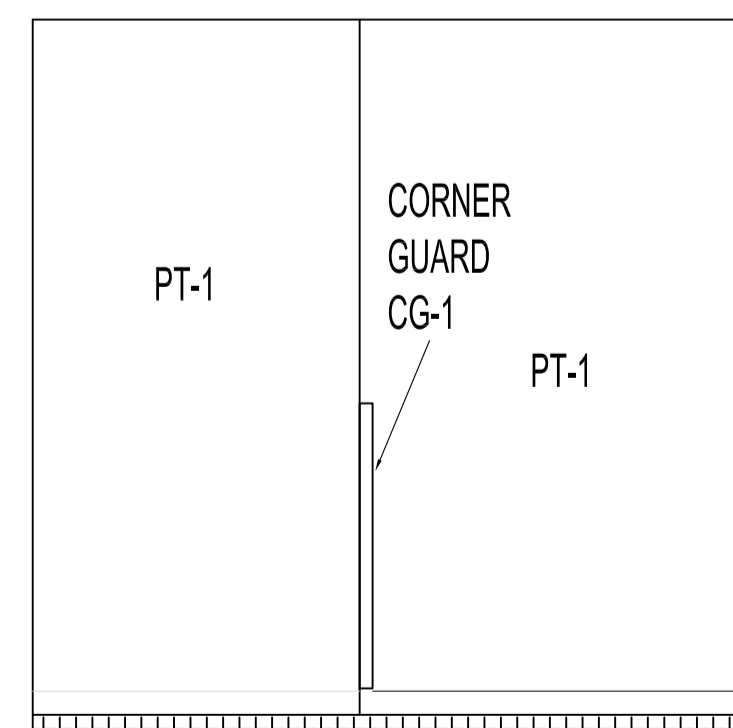

8 BREAK OUT ROOM  
A2.2 SCALE: 3/8"=1'-0"

NOTES:

- THESE DRAWINGS SHALL NOT BE SCALED. CONSULT WITH CONTRACT ADMINISTRATOR AND DESIGNER ON ANY CONCERNS.
- SUBMISSION OF SITE MARK-UPS, AS-BUILTS, OPERATING & MAINTENANCE MANUALS AND OTHER SUPPORTING DOCUMENTS TO CLIENT ARE MANDATORY AT THE COMPLETION OF THIS PROJECT.
- THE CONTRACTOR SHALL VISIT THE SITE AND SATISFY ONESELF ALL DIMENSIONS, DATUM, AND DETAILED INFORMATION SHOWN ARE CORRECT.
- THE CONTRACTOR IS TO REVIEW AND COORDINATE ALL ARCHITECTURAL, STRUCTURAL, MECHANICAL AND ELECTRICAL DRAWINGS FOR ADDITIONAL OPENINGS THROUGH FLOORS, WALLS, AND CEILING FOR DUCTS, PIPES & ELECTRICAL RISERS AND ALL OPENINGS NOT SHOWN ON DRAWINGS.
- ALL OPENINGS THROUGH FIRE ASSEMBLIES INCLUDING FLOORS AND CEILING ARE TO BE FIRE STOPPED AND SEALED WITH U.L.C APPROVED FIRE STOPPING TO MAINTAIN THE INTEGRITY OF THE FIRE SEPARATION, AND PROVIDE A SMOKE-TIGHT BARRIER.
- ALL PRODUCTS AND MATERIALS TO BE USED AND INSTALLED SHALL CONFORM WITH MANUFACTURER'S SPECIFICATIONS, APPLICABLE CODES AND AUTHORITY HAVING JURISDICTION.
- THE CONTRACTOR SHALL BE RESPONSIBLE TO PATCH AND MAKE GOOD ALL EXISTING CONSTRUCTION AFFECTED BY THE REMOVAL OF ALL ITEMS FORMING PART OF THE RENOVATION WORK.
- WHERE NEW FLOORING AND BASE IS TO BE INSTALLED IN EXISTING AREAS (REFER TO FLOOR PLAN AND ROOM SCHEDULE) THE EXISTING FLOORING SURFACE AND BASE MUST BE REMOVED, UNLESS OTHERWISE NOTED. ALL FLOOR SURFACES SHALL BE PREPARED IN ACCORDANCE TO MANUFACTURER'S RECOMMENDATIONS FOR INSTALLATION OF NEW FLOOR.
- WHERE PAINTING OF EXISTING WALLS IS INDICATED ON THE ROOM SCHEDULE, THESE WALLS MUST BE CLEANED OF ANY EXISTING WALL COVERING, PATCHED & PREPARED TO ACCEPT NEW MATERIAL, UNLESS OTHERWISE NOTED.
- ALL NEW LIGHTING FIXTURES & NEW RECEPTACLES TO BE CONNECTED TO APPROPRIATE PANELS.
- GENERAL DUTY RECEPTACLES SHALL BE WHITE & CSA APPROVED, C/W STAINLESS STEEL TRIM PLATES MOUNTED 18" ABOVE FINISHED FLOOR OR OTHERWISE NOTED.
- THERMOSTATS, FIRE ALARM PULL STATIONS & OCCUPANCY LIGHT SWITCHES SHALL BE MOUNTED 47" ABOVE FINISHED FLOOR OR OTHERWISE NOTED.
- ALL ABANDONED ELECTRICAL FIXTURES, COMPONENTS, RECEPTACLE & DATA WIRING SHALL BE REMOVED BACK TO SOURCE & TERMINATED AS PER APPLICABLE CODES. IF APPLICABLE, THIS INCLUDES WIRING CONTAINED IN HEADER DUCTS IN-FLOOR.
- REFER TO CITY OF WINNIPEG MATERIALS MANAGEMENT GENERAL TERMS & CONDITIONS FOR PROJECT: [HTTP://WINNIPEG.CA/MAIN/MTM/GEN\\_COND.STM](http://WINNIPEG.CA/MAIN/MTM/GEN_COND.STM)
- WARNING:** ASBESTOS KNOWN TO BE PRESENT IN SPRAY ON FIREPROOFING ABOVE CEILING TILES. ABATEMENT BY CITY OF WINNIPEG CONTRACTOR TO PRECEED START OF CONSTRUCTION. ASBESTOS MAY BE PRESENT IN OTHER AREAS. IF ASBESTOS OR ANY HAZARDOUS MATERIAL IS FOUND, STOP WORK IMMEDIATELY & CONTACT CITY OF WINNIPEG, CENTRAL CONTROL, PH: 204-986-2351.

No.	REVISION/DESCRIPTION	BY	DATE
0	ISSUED FOR CONSTRUCTION	KJN	SEPT. 24 2018
00	ISSUED FOR 60% CLIENT REVIEW	KJN	AUG. 17 2018

- DRAWING NOTES**
- 3/4" THICK PLYWOOD AS SURFACE MOUNTED BLOCKING REQUIRED ON EXISTING WALLS FOR SUPPORT FOR NEW TELEVISION MOUNTS PROVIDED BY CITY. TV MOUNTS TO BE INSTALLED BY GENERAL CONTRACTOR. CONFIRM INSTALL HEIGHTS OF TV'S WITH CITY PRIOR TO INSTALLATION. TO BE PAINTED TO MATCH WALL.
  - BLOCKING FOR TELEVISIONS AND WHITEBOARDS REQUIRED WITHIN WALL.
  - INSTALLATION OF CITY SUPPLIED WHITEBOARDS REQUIRED BY CONTRACTOR. BLOCKING IN WALL REQUIRED.

DRAWN	CHECKED	DESIGNED	APPROVED
DATE 2018.09.24	USER APPROVAL		

**THE CITY OF WINNIPEG**  
 PLANNING, PROPERTY AND DEVELOPMENT DEPARTMENT  
 MUNICIPAL ACCOMMODATIONS DIVISION  
 3-65 GARRY STREET, R3C 4K4

PROJECT: WFPS EMERGENCY OPERATIONS CENTRE INTERIOR RENOVATIONS  
 510 MAIN STREET BID OPP # 870-2018

SHEET TITLE: INTERIOR ELEVATIONS  
 SCALE: AS SHOWN PROJECT No: 2018-010 SHEET No: A2.2