

ABBREVIATIONS	
	DESCRIPTION
A	AMPERE, AMPACITY
AC	ABOVE COUNTER
ACT	ACOUSTIC CEILING TILE
AFF	ABOVE FINISH FLOOR
BFC	BELOW FINISH CEILING
CCT	CIRCUIT, CCT: C-PANEL "B"; CT- CIRCUIT "1" (B1)
CLNG	CEILING
D	DEMOLITION , REMOVE BACK TO SOURCE
DA	DOOR ACTUATOR
DCB	DURESS CALL BUTTON
DED	DEDICATED CIRCUIT
DSW	DISCONNECT SWITCH
DWG	DRAWING
D/W	DISHWASHER
E	EXISTING OR "NO DESIGNATION"
ES	ELECTRIC STRIKE
FAB	FLOOR ACCESS BOX
FMS	FACILITY MANAGEMENT SYSTEM
GFCI	GROUND FAULT CIRCUIT INTERRUPTER
HTR	HEATER
HVAC	HEATING, VENTILATING AND AIR CONDITIONING
HZ	HERTZ
JB	JUNCTION BOX
M	METER
MD	MOTION DETECTOR
MW	MICROWAVE
N	NEW
N.I.C.	NOT IN CONTRACT
NTS	NOT TO SCALE
OC	ON COUNTER
O/C	ON CENTER
OS	OCCUPANCY SENSOR
PNL	PANEL
R	RELOCATED LOCATION
RECPT.	RECEPTACLE
SW	SWITCH
TBD	TO BE DETERMINED
TYP.	TYPICAL
V	VOLT
W	WATT

ELECTRICAL LEGEND	
TYPE	DESCRIPTION
⊕	DUPEX RECEPTACLE
⊕ ₆₀	HEIGHT IN INCHES ABOVE FINISH FLOOR TO CENTERLINE OF DEVICE
⊕ ₁₂	2-GANG DUPEX RECEPTACLE
⊕ ₂₄	DUPEX RECEPTACLE WITH (2) 2A USB 2.2 & 3.0 CAPABLE
⊕ ₃₆	GROUND FAULT CIRCUIT INTERRUPTER DUPEX RECEPTACLE
⊕	LIGHT SWITCH, SINGLE POLE
⊕ ₃₆	OCCUPANCY SENSOR SWITCH WITH AUTO-ON & AUTO-OFF, WHITE
DA	36" DOOR ACTUATOR FOR AUTOMATIC DOOR OPERATOR
DSW-1	DISCONNECT SWITCH
DD-1	AUTOMATIC DOOR OPERATOR
JB	JUNCTION BOX
F1	FIRE ALARM MANUAL PULL STATION
F2	FIRE ALARM BELL
F3	FIRE ALARM STROBE SIREN
⊕ ₁	HEAT DETECTOR, CEILING RECESSED
⊕ ₁ ₊	HEAT DETECTOR, CEILING SURFACE MOUNT
⊕	PUBLIC ADDRESS MICROPHONE INPUT JACK
⊕ ₊	PUBLIC ADDRESS SPEAKER
⊕ ₊	SPEAKER
⊕ ₊	SPEAKER
⊕ ₊	SPEAKER
⊕ ₊	SPEAKER VOLUME CONTROLLER
▷	DATA PORT
▷	FLOOR PEDESTAL DATA PORT
◀	VOICE (PHONE) PORT: CENTREX LAND LINE
⊕ ₊	KEY PAD/DISPLAY - SECURITY
⊕ ₊	CARD READER TO KEYPAD - SECURITY
⊕ ₊	HORN - SECURITY
◀ ₊	MOTION DETECTOR- SECURITY
PNL	ELECTRICAL PANEL
⊕ ₊	NETWORK ACCESS POINT
⊕ ₊	THERMOSTAT
⊕ ₊	COAXIAL CABLE (TV)
+⊕ ₃₆	DURESS CALL BUTTON, AMSECO MODEL HUSD-158M,
CA	CARD ACCESS, MULTICLASS SE READER, MINI MULLION SIZE, HID PART # RP10, BLACK
ES	ELECTRIC STRIKE FOR OFFICES, FINISH TBD
⊕ ₊	REQUEST-TO-EXIT SENSOR , DUAL TECHNOLOGY (PIR & DOPPLER RADAR), INTERLOGIX PART # RCR-REX-B
⊕ ₊	DOOR CONTACT - FLUSH MOUNT, GE MODEL # 1076CW
CAB-1	EIA COMPLIANT 19" WALL MOUNT RACK, MIDDLE ATLANTIC PRODUCT No: DWR-24-22PD WITH VENTED FRONT DOOR, ACTIVE COOLING VIA TOP-MOUNT DUAL-FANS, 49" HEIGHT x 23" WIDTH x 22" DEPTH, 42" USABLE HEIGHT x 20" USABLE DEPTH, 24 RACK UNITS, 300 LBS CAPACITY. PATCH PANEL: 2RU 48-PORT FLAT PANEL (CAT 6) W/FRONT & REAR CABLE MANAGEMENT, LEVITON OR EQUIVALENT. (2) REQUIRED.
CAB-2	EIA COMPLIANT 19" WALL MOUNT RACK, MIDDLE ATLANTIC PRODUCT No: EWR-12-17, 28" HEIGHT x 23.4" WIDTH x 17.3" DEPTH, 21" USABLE HEIGHT x 15" USABLE DEPTH, 12 RACK UNITS. NETWORK RACKMOUNT SHELF, VENTED, 12"DP., 2 RACK UNITS FOR EXISTING TOA BG-2060 AMPLIFIER.

HEATER SCHEDULE									
TAG	DESCRIPTION	MANUFACTURER	CATALOG No.	WATTS	BRANCH CIRCUIT	WIRE (COPPER)	CONDUIT	VOLTPH.	NOTES
BB-1	BASEBOARD	OUELLET	OFM2208	2000	B14,15	#122	1/2"EMT	208V/1PH.	1,2

HEATER SCHEDULE NOTES:
 1. PROVIDE NON PROGRAMMABLE ELECTRONIC THERMOSTAT & CONNECT TO BASEBOARD HEATER WITH SINGLE-POLE RELAY, COIL 24V, WITH TRANSFORMER 208V/24V, 22A AT 208V (OUELLET CONTROL OCB-RT-208) TO DE-ENERGIZED HEATER WHEN EXHAUST FAN (F-B1) IS ENERGIZED BY THERMOSTAT CONTROL. CONFIRM WITH CONTROLS CONTRACTOR.
 2. APPROVED EQUAL IN ACCORDANCE WITH B7: CHROMALOX, STELPRO, REZINOR

AREA OF WORK
 SUB-BASEMENT,
 BASEMENT &
 MAIN FLOORS

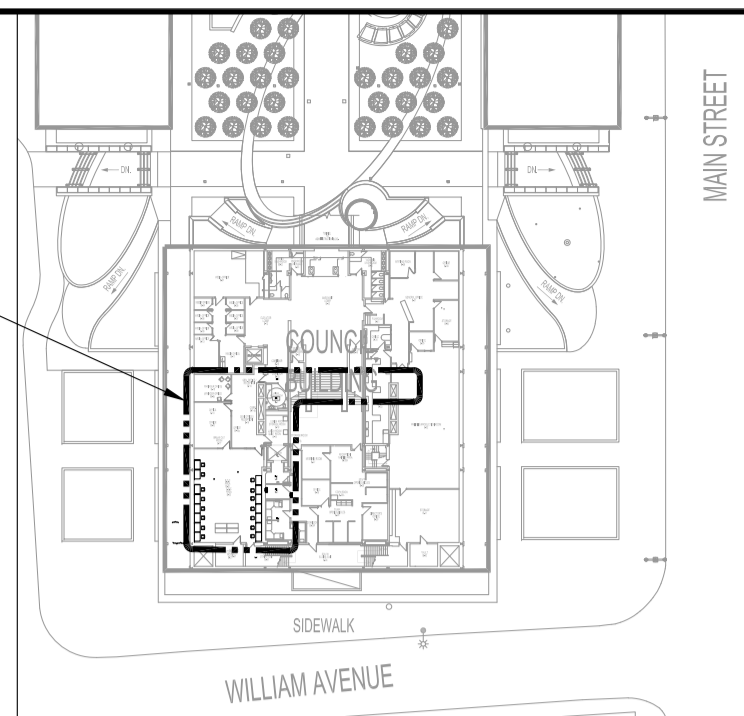

KEY PLAN
 SCALE: N.T.S.

NOTES:
 THESE DRAWINGS SHALL NOT BE SCALED. CONSULT WITH CLIENT AND DESIGNER ON ANY CONCERNS.
 ALSO REFER TO ARCHITECTURAL, MECHANICAL & ELECTRICAL DRAWINGS & SPECIFICATIONS.
 SUBMISSION OF SITE MARK-UPS, AS-BUILTS, OPERATING & MAINTENANCE MANUALS AND OTHER SUPPORTING DOCUMENTS TO CLIENT ARE MANDATORY AT THE COMPLETION OF THIS PROJECT.
 THE CONTRACTOR SHALL VISIT THE SITE AND ENSURE ALL DIMENSIONS, DATUM, AND DETAILED INFORMATION SHOWN ARE CORRECT.
 THE CONTRACTOR IS TO REVIEW AND COORDINATE ALL ARCHITECTURAL, MECHANICAL AND ELECTRICAL DRAWINGS FOR ADDITIONAL OPENINGS THROUGH FLOORS, WALLS, AND CEILINGS FOR DUCTS, PIPES & ELECTRICAL RISERS AND ALL OPENINGS NOT SHOWN ON DRAWINGS.
 ALL OPENINGS THROUGH FIRE ASSEMBLIES INCLUDING FLOORS AND CEILINGS ARE TO BE FIRE STOPPED AND SEALED WITH ULC APPROVED FIRE STOPPING TO MAINTAIN THE INTEGRITY OF THE FIRE SEPARATION, AND PROVIDE A SMOKE-TIGHT BARRIER.
 ALL PRODUCTS AND MATERIALS TO BE USED AND INSTALLED SHALL CONFORM WITH MANUFACTURER'S SPECIFICATIONS, APPLICABLE CODES AND AUTHORITY HAVING JURISDICTION.
 THE CONTRACTOR SHALL BE RESPONSIBLE TO PATCH AND MAKE GOOD ALL EXISTING CONSTRUCTION AFFECTED BY THE REMOVAL OF ALL ITEMS FORMING PART OF THE RENOVATION WORK.
 PROVIDE D'YNA LABELS ON ALL EXISTING SWITCHES, PORTS & RECEPTACLES. PANEL SCHEDULE SHALL BE RETYPED TO REFLECT AS-BUILT CONDITIONS & INSERTED TO INSIDE OF ASSOCIATED PANEL DOOR SLEEVE PROTECTOR.
 ALL ABANDONED (KNOWN & UNKNOWN) ELECTRICAL FIXTURES, COMPONENTS, RECEPTACLES & DATA CABLING SHALL BE REMOVED BACK TO SOURCE & TERMINATED AS PER APPLICABLE CODES. IF APPLICABLE, THIS INCLUDES WIRING CONTAINED IN HEADER DUCTS IN-FLOOR.
 RECONNECT & TEST ALL FIRE PREVENTION EQUIPMENT.
WARNING:
 ASBESTOS MAYBE PRESENT BEHIND WALLS, CEILING SPACE & FLOORS. IF ASBESTOS & ANY HAZARDOUS MATERIAL IS FOUND, STOP WORK IMMEDIATELY & CONTACT CITY OF WINNIPEG, CENTRAL CONTROLS, PH: 204-986-2351.

0	ISSUED FOR CONSTRUCTION	DTA	2018.08.24
00	ISSUED FOR 60% CLIENT REVIEW	DTA	2018.08.17
No.	REVISION/DESCRIPTION	BY	DATE

SEAL



DRAWN	DTA	CHECKED	DESIGNED	DTA	APPROVED
DATE	2018.07.26	USER	APPROVAL		

THE CITY OF WINNIPEG
 PLANNING, PROPERTY AND
 DEVELOPMENT DEPARTMENT
 MUNICIPAL ACCOMMODATIONS DIVISION
 3-65 GARRY STREET, R3C 4K4

PROJECT
 COUNCIL BUILDING
 EMERGENCY OPERATIONS CENTRE RENOVATIONS

510 MAIN STREET
 BID OPPORTUNITY: 870-2018

SHEET TITLE
 ELECTRICAL
 ABBREVIATIONS, LEGENDS, SYMBOLS
 SCHEDULES

SCALE	PROJECT No:	SHEET No:
AS SHOWN	2018-010	E1

ELECTRICAL	
SHEET No:	SHEET TITLE
E1	ELECTRICAL: ABBREVIATIONS, LEGENDS, SYMBOLS, SCHEDULES
E2	PARTIAL BASEMENT FLOOR PLAN: DEMOLITION: POWER & SYSTEMS
E3	PARTIAL BASEMENT FLOOR PLAN: RENOVATION: POWER, SYSTEMS, PANEL SCHEDULES
E4	PARTIAL BASEMENT REFLECTED CEILING PLAN: RENOVATION: LIGHTING AND SCHEDULES
E5	PARTIAL BASEMENT REFLECTED CEILING PLAN: RENOVATION: FIRE ALARM AND EMERGENCY LIGHTING
E6	ELECTRICAL SPECIFICATIONS: POWER & SYSTEMS