

APPENDIX D – TRAFFIC MANAGEMENT PLANS

ARCHIBALD STREET

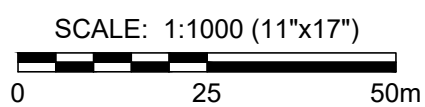
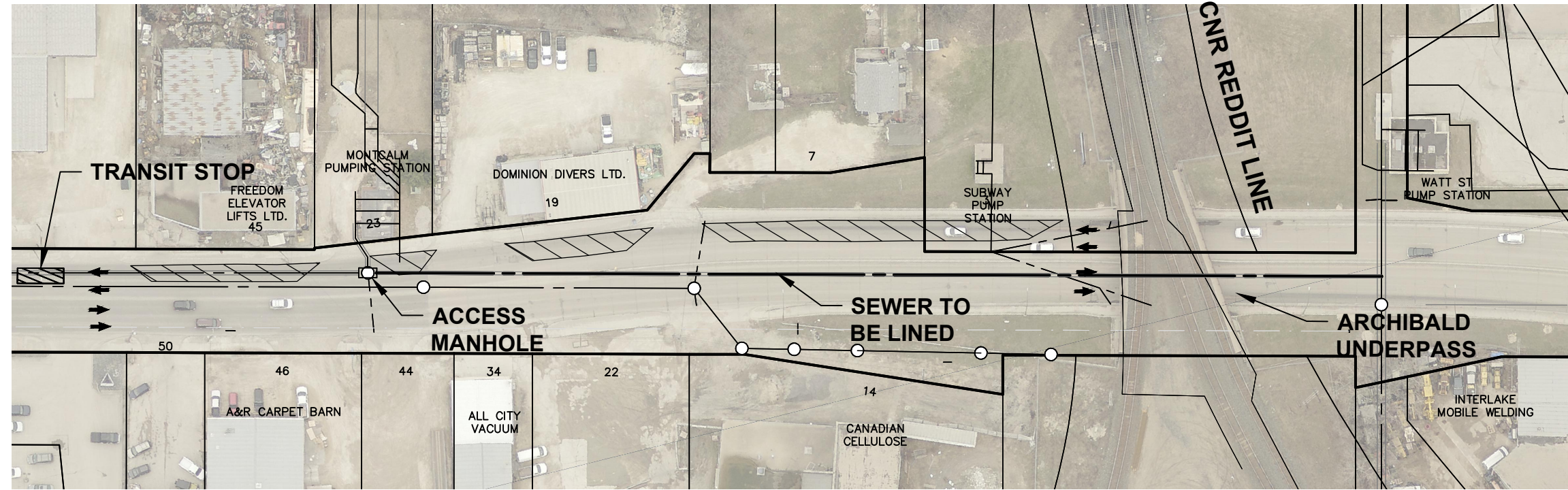
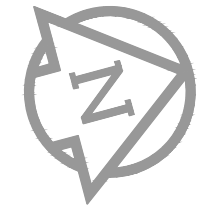

NOTES:

1. MAINTAIN A MINIMUM OF ONE LANE OF TRAFFIC IN THE SOUTHBOUND LANES AT ALL TIMES DURING CONSTRUCTION. NO LANE CLOSURES WILL BE PERMITTED DURING PEAK HOURS.
2. PEAK HOURS ARE MONDAY TO FRIDAY 0700 HRS TO 0900 HRS AND FROM 1530 HRS TO 1730 HRS.
3. IF THE INSTALLATION OF THE LINER CANNOT BE COMPLETED WITHIN NON-PEAK HOURS, LINER INSTALLATION WILL HAVE TO BE COMPLETED DURING EVENINGS OR ON WEEKENDS.
4. INTERSECTING STREETS AND PRIVATE APPROACH ACCESS SHALL BE MAINTAINED AS SHOWN.
5. CONSTRUCTION STAGING IN ACCORDANCE WITH THE 2016 EDITION OF THE CITY OF WINNIPEG "MANUAL OF TEMPORARY TRAFFIC CONTROL IN WORK AREAS ON CITY STREETS".
6. MAINTAIN EXISTING DRAINAGE AND INSTALL PROPOSED DRAINAGE APPURTENANCES AS REQUIRED DURING THE APPROPRIATE STAGES AND AS DIRECTED BY THE CONTRACT ADMINISTRATOR.
7. IF REQUIRED, TO FACILITATE MANHOLE REMOVAL, SAWCUT EXISTING PAVEMENT (FULL DEPTH) PRIOR TO REMOVAL.
8. MAINTAIN PEDESTRIAN ACCESS TO ALL BUSINESSES.
9. ERECT AND MAINTAIN FENCE BETWEEN PEDESTRIANS AND CONSTRUCTION AREAS.
10. CONSTRUCTION SHALL NOT INTERFERE WITH TRANSIT STOPS AT ANY TIME.

LEGEND:

- LANE CLOSURES ALLOWED DURING NON-PEAK HOURS
- TRAFFIC FLOW

METRIC
 WHOLE NUMBERS INDICATE MILLIMETRES
 DECIMALIZED NUMBERS INDICATE METRES



2017 SEWER RENEWALS BY CIPP LINING
 CONTRACT 3
TRAFFIC MANAGEMENT PLANS
 BID OPPORTUNITY 94-2018

SCALE	1:1000
DATE	December, 2017
FIGURE NO.	01

DALY STREET N

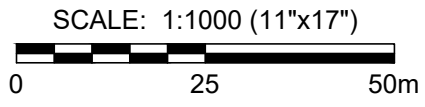
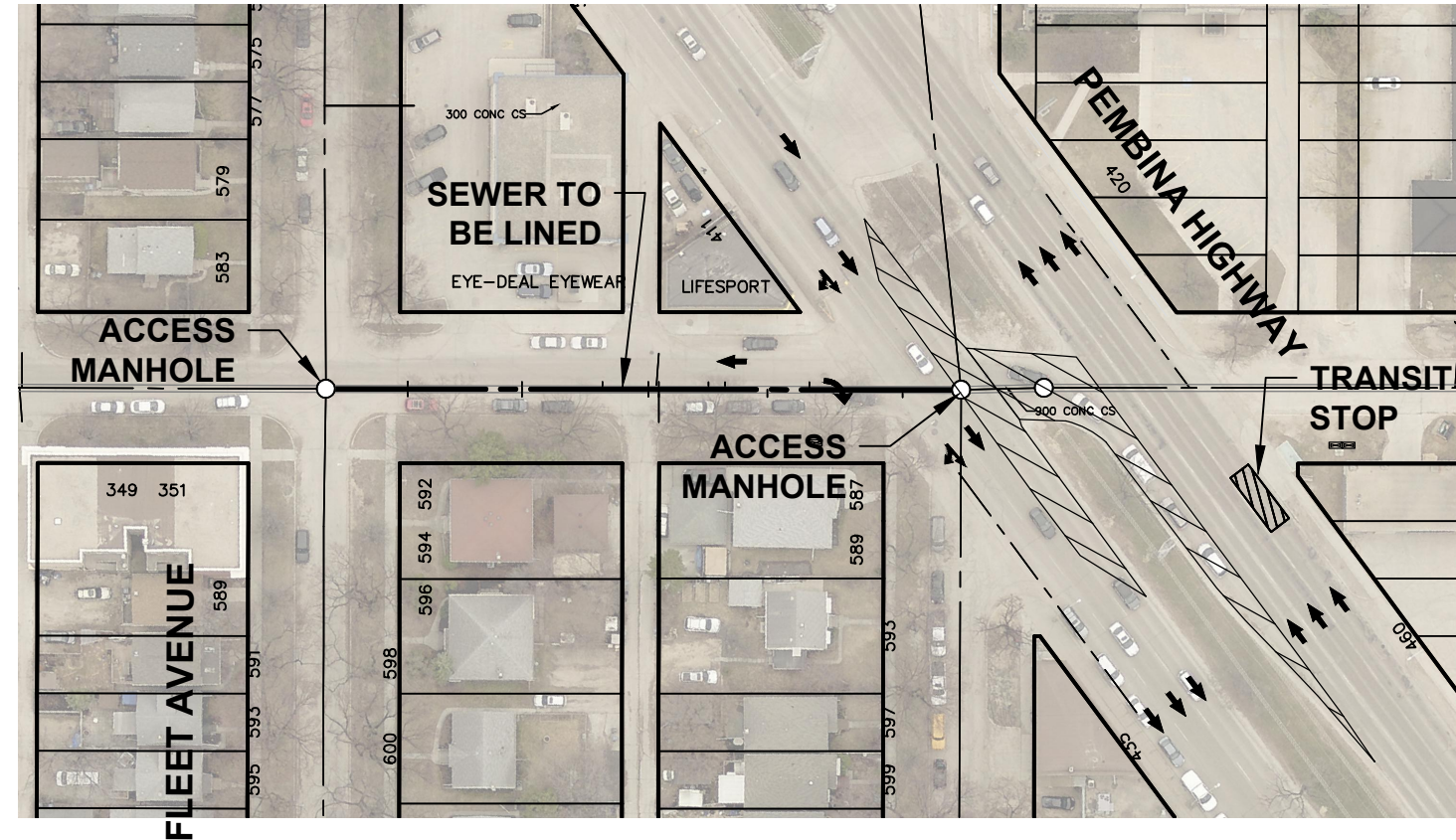

LEGEND:

- LANE CLOSURES ALLOWED DURING NON-PEAK HOURS
- TRAFFIC FLOW

NOTES:

1. MAINTAIN A MINIMUM OF TWO LANE OF TRAFFIC IN THE SOUTHBOUND LANES AT ALL TIMES DURING CONSTRUCTION. NO LANE CLOSURES WILL BE PERMITTED DURING PEAK HOURS.
2. PEAK HOURS ARE MONDAY TO FRIDAY 0700 HRS TO 0900 HRS AND FROM 1530 HRS TO 1730 HRS.
3. IF THE INSTALLATION OF THE LINER CANNOT BE COMPLETED WITHIN NON-PEAK HOURS, LINER INSTALLATION WILL HAVE TO BE COMPLETED DURING EVENINGS OR ON WEEKENDS.
4. INTERSECTING STREETS AND PRIVATE APPROACH ACCESS SHALL BE MAINTAINED AS SHOWN.
5. CONSTRUCTION STAGING IN ACCORDANCE WITH THE 2016 EDITION OF THE CITY OF WINNIPEG "MANUAL OF TEMPORARY TRAFFIC CONTROL IN WORK AREAS ON CITY STREETS".
6. MAINTAIN EXISTING DRAINAGE AND INSTALL PROPOSED DRAINAGE APPURTENANCES AS REQUIRED DURING THE APPROPRIATE STAGES AND AS DIRECTED BY THE CONTRACT ADMINISTRATOR.
7. IF REQUIRED, TO FACILITATE MANHOLE REMOVAL, SAWCUT EXISTING PAVEMENT (FULL DEPTH) PRIOR TO REMOVAL.
8. MAINTAIN PEDESTRIAN ACCESS TO ALL BUSINESSES.
9. ERECT AND MAINTAIN FENCE BETWEEN PEDESTRIANS AND CONSTRUCTION AREAS.
10. CONSTRUCTION SHALL NOT INTERFERE WITH TRANSIT STOPS AT ANY TIME.

11"x17" SIZE 279.4mm x 431.8mm

PLOT: 3/8/2018 3:26:20 PM

FILE NAME: 1700089 - Traffic Management.dwg Saved By: jhines

METRIC
WHOLE NUMBERS INDICATE MILLIMETRES
DECIMALIZED NUMBERS INDICATE METRES



2017 SEWER RENEWALS BY CIPP LINING
CONTRACT 3
TRAFFIC MANAGEMENT PLANS
BID OPPORTUNITY 94-2018

SCALE	1:1000
DATE	December, 2017
FIGURE NO.	02

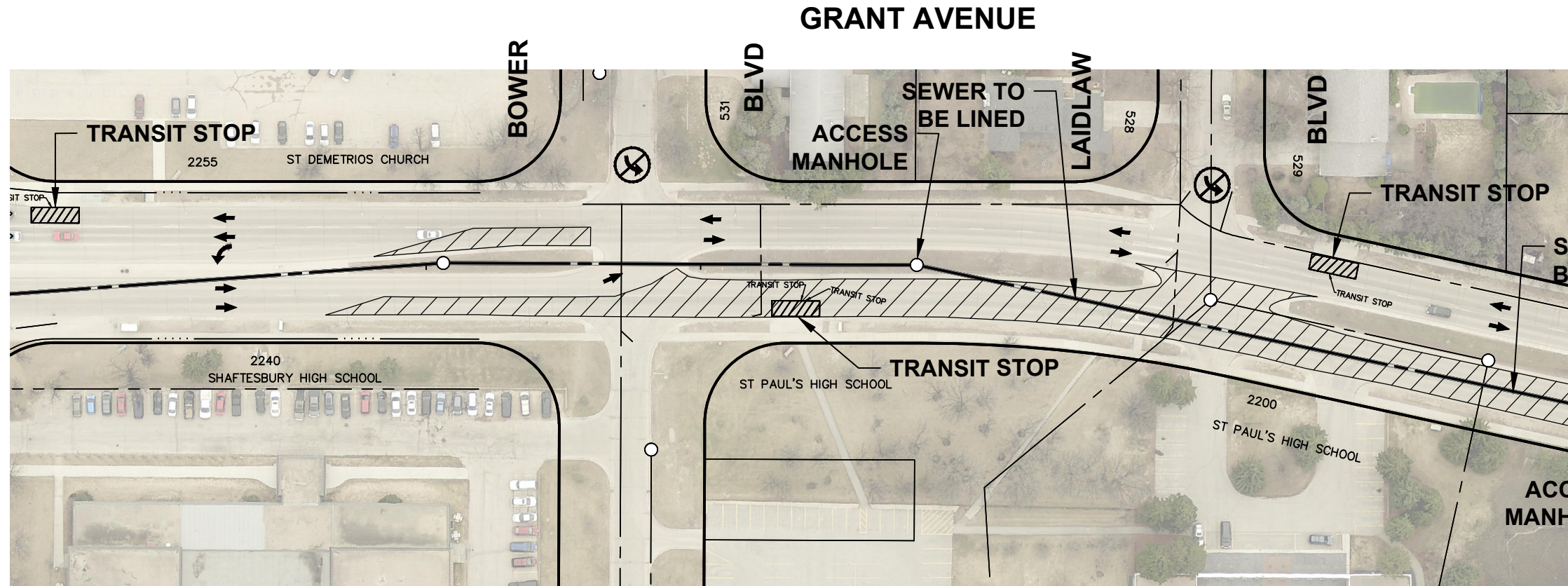

FOR CONTINUATION
SEE FIGURE 04

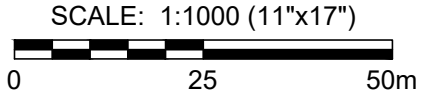

LEGEND:

- LANE CLOSURES ALLOWED DURING NON-PEAK HOURS
- TRAFFIC FLOW

NOTES:

1. MAINTAIN A MINIMUM OF ONE LANE OF TRAFFIC IN THE EASTBOUND AND WESTBOUND DIRECTIONS AT ALL TIMES DURING CONSTRUCTION. NO LANE CLOSURES WILL BE PERMITTED DURING PEAK HOURS.
2. PEAK HOURS ARE MONDAY TO FRIDAY 0700 HRS TO 0900 HRS AND FROM 1530 HRS TO 1730 HRS.
3. IF THE INSTALLATION OF THE LINER CANNOT BE COMPLETED WITHIN NON-PEAK HOURS, LINER INSTALLATION WILL HAVE TO BE COMPLETED DURING EVENINGS OR ON WEEKENDS.
4. INTERSECTING STREETS AND PRIVATE APPROACH ACCESS SHALL BE MAINTAINED AS SHOWN.
5. CONSTRUCTION STAGING IN ACCORDANCE WITH THE 2016 EDITION OF THE CITY OF WINNIPEG "MANUAL OF TEMPORARY TRAFFIC CONTROL IN WORK AREAS ON CITY STREETS".
6. MAINTAIN EXISTING DRAINAGE AND INSTALL PROPOSED DRAINAGE APPURTENANCES AS REQUIRED DURING THE APPROPRIATE STAGES AND AS DIRECTED BY THE CONTRACT ADMINISTRATOR.
7. IF REQUIRED, TO FACILITATE MANHOLE REMOVAL, SAWCUT EXISTING PAVEMENT (FULL DEPTH) PRIOR TO REMOVAL.
8. MAINTAIN PEDESTRIAN ACCESS TO ALL BUSINESSES.
9. ERECT AND MAINTAIN FENCE BETWEEN PEDESTRIANS AND CONSTRUCTION AREAS.
10. CONSTRUCTION SHALL NOT INTERFERE WITH TRANSIT STOPS AT ANY TIME UNLESS FIGURE ILLUSTRATES CLOSURE.
11. THESE LINERS ARE LOCATED WITHIN A SCHOOL ZONE, WORK MUST BE COMPLETED IN JULY OR AUGUST.

METRIC
 WHOLE NUMBERS INDICATE MILLIMETRES
 DECIMALIZED NUMBERS INDICATE METRES



2017 SEWER RENEWALS BY CIPP LINING
 CONTRACT 3
TRAFFIC MANAGEMENT PLANS
 BID OPPORTUNITY 94-2018

SCALE	1:1000
DATE	December, 2017
FIGURE NO.	03

GRANT AVENUE

FOR CONTINUATION
SEE FIGURE 03

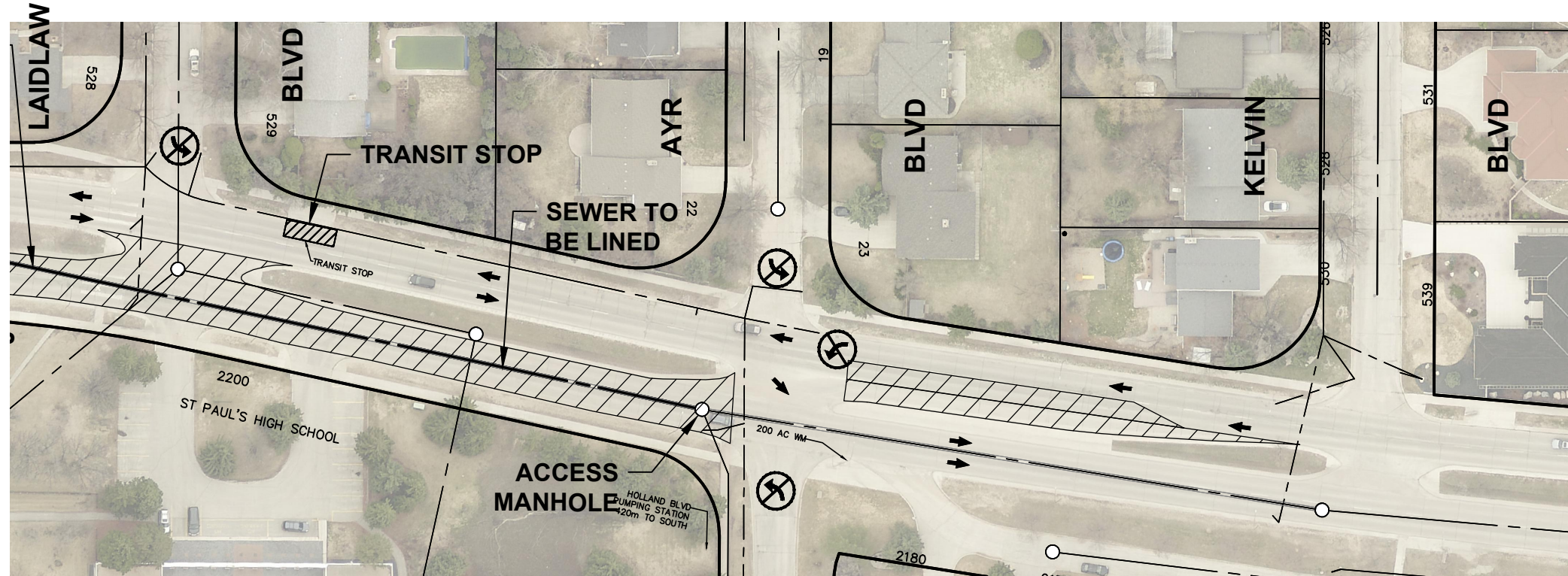

SCALE: 1:1000 (11"x17")

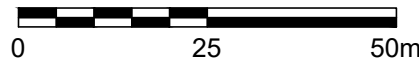

LEGEND:

- LANE CLOSURES ALLOWED DURING NON-PEAK HOURS
- TRAFFIC FLOW

NOTES:

1. MAINTAIN A MINIMUM OF ONE LANE OF TRAFFIC IN THE EASTBOUND AND WESTBOUND DIRECTIONS AT ALL TIMES DURING CONSTRUCTION. NO LANE CLOSURES WILL BE PERMITTED DURING PEAK HOURS.
2. PEAK HOURS ARE MONDAY TO FRIDAY 0700 HRS TO 0900 HRS AND FROM 1530 HRS TO 1730 HRS.
3. IF THE INSTALLATION OF THE LINER CANNOT BE COMPLETED WITHIN NON-PEAK HOURS, LINER INSTALLATION WILL HAVE TO BE COMPLETED DURING EVENINGS OR ON WEEKENDS.
4. INTERSECTING STREETS AND PRIVATE APPROACH ACCESS SHALL BE MAINTAINED AS SHOWN.
5. CONSTRUCTION STAGING IN ACCORDANCE WITH THE 2016 EDITION OF THE CITY OF WINNIPEG "MANUAL OF TEMPORARY TRAFFIC CONTROL IN WORK AREAS ON CITY STREETS".
6. MAINTAIN EXISTING DRAINAGE AND INSTALL PROPOSED DRAINAGE APPURTENANCES AS REQUIRED DURING THE APPROPRIATE STAGES AND AS DIRECTED BY THE CONTRACT ADMINISTRATOR.
7. IF REQUIRED, TO FACILITATE MANHOLE REMOVAL, SAWCUT EXISTING PAVEMENT (FULL DEPTH) PRIOR TO REMOVAL.
8. MAINTAIN PEDESTRIAN ACCESS TO ALL BUSINESSES.
9. ERECT AND MAINTAIN FENCE BETWEEN PEDESTRIANS AND CONSTRUCTION AREAS.
10. CONSTRUCTION SHALL NOT INTERFERE WITH TRANSIT STOPS AT ANY TIME UNLESS FIGURE ILLUSTRATES CLOSURE.
11. THESE LINERS ARE LOCATED WITHIN A SCHOOL ZONE, WORK MUST BE COMPLETED IN JULY OR AUGUST.

METRIC
WHOLE NUMBERS INDICATE MILLIMETRES
DECIMALIZED NUMBERS INDICATE METRES



2017 SEWER RENEWALS BY CIPP LINING
CONTRACT 3
TRAFFIC MANAGEMENT PLANS
BID OPPORTUNITY 94-2018

SCALE	1:1000
DATE	December, 2017
FIGURE NO.	04

FOR CONTINUATION
SEE FIGURE 06

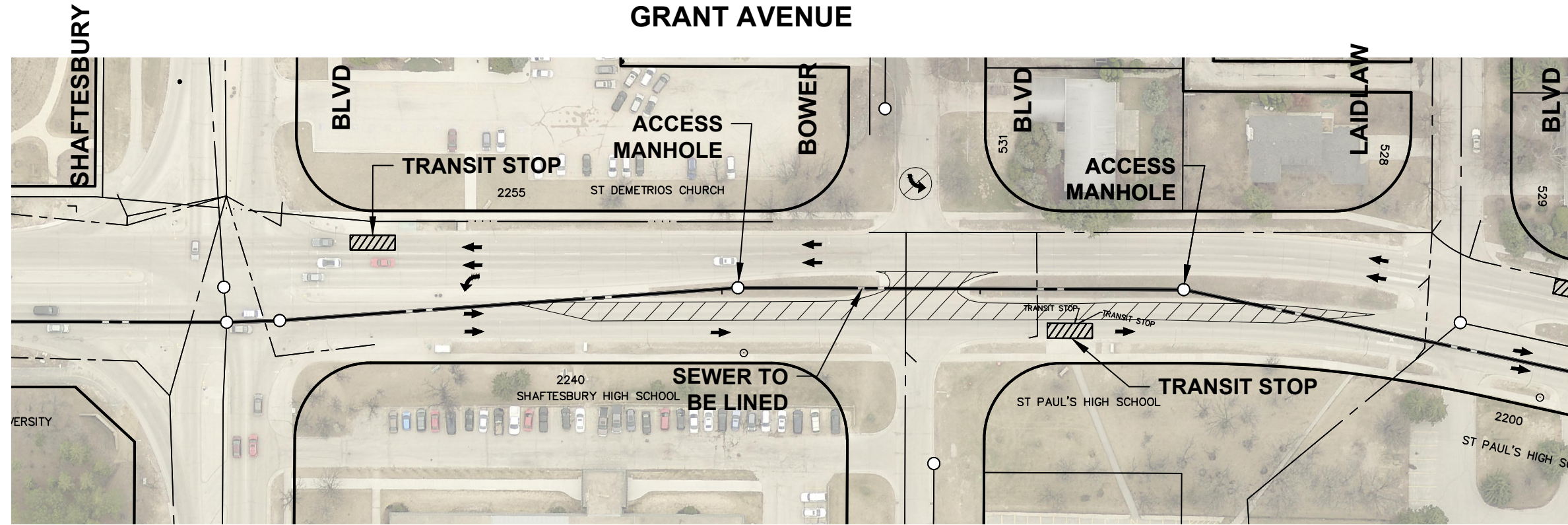

FOR CONTINUATION
SEE FIGURE 04

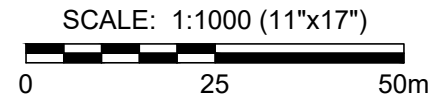

LEGEND:

- LANE CLOSURES ALLOWED DURING NON-PEAK HOURS
- TRAFFIC FLOW

NOTES:

1. MAINTAIN A MINIMUM OF ONE LANE OF TRAFFIC IN THE EASTBOUND AND WESTBOUND DIRECTIONS AT ALL TIMES DURING CONSTRUCTION. NO LANE CLOSURES WILL BE PERMITTED DURING PEAK HOURS.
2. PEAK HOURS ARE MONDAY TO FRIDAY 0700 HRS TO 0900 HRS AND FROM 1530 HRS TO 1730 HRS.
3. IF THE INSTALLATION OF THE LINER CANNOT BE COMPLETED WITHIN NON-PEAK HOURS, LINER INSTALLATION WILL HAVE TO BE COMPLETED DURING EVENINGS OR ON WEEKENDS.
4. INTERSECTING STREETS AND PRIVATE APPROACH ACCESS SHALL BE MAINTAINED AS SHOWN.
5. CONSTRUCTION STAGING IN ACCORDANCE WITH THE 2016 EDITION OF THE CITY OF WINNIPEG "MANUAL OF TEMPORARY TRAFFIC CONTROL IN WORK AREAS ON CITY STREETS".
6. MAINTAIN EXISTING DRAINAGE AND INSTALL PROPOSED DRAINAGE APPURTENANCES AS REQUIRED DURING THE APPROPRIATE STAGES AND AS DIRECTED BY THE CONTRACT ADMINISTRATOR.
7. IF REQUIRED, TO FACILITATE MANHOLE REMOVAL, SAWCUT EXISTING PAVEMENT (FULL DEPTH) PRIOR TO REMOVAL.
8. MAINTAIN PEDESTRIAN ACCESS TO ALL BUSINESSES.
9. ERECT AND MAINTAIN FENCE BETWEEN PEDESTRIANS AND CONSTRUCTION AREAS.
10. CONSTRUCTION SHALL NOT INTERFERE WITH TRANSIT STOPS AT ANY TIME UNLESS FIGURE ILLUSTRATES CLOSURE.
11. THESE LINERS ARE LOCATED WITHIN A SCHOOL ZONE, WORK MUST BE COMPLETED IN JULY OR AUGUST.

METRIC
WHOLE NUMBERS INDICATE MILLIMETRES
DECIMALIZED NUMBERS INDICATE METRES



2017 SEWER RENEWALS BY CIPP LINING
CONTRACT 3
TRAFFIC MANAGEMENT PLANS
BID OPPORTUNITY 94-2018

SCALE
1:1000
DATE
December, 2017
FIGURE NO.
05

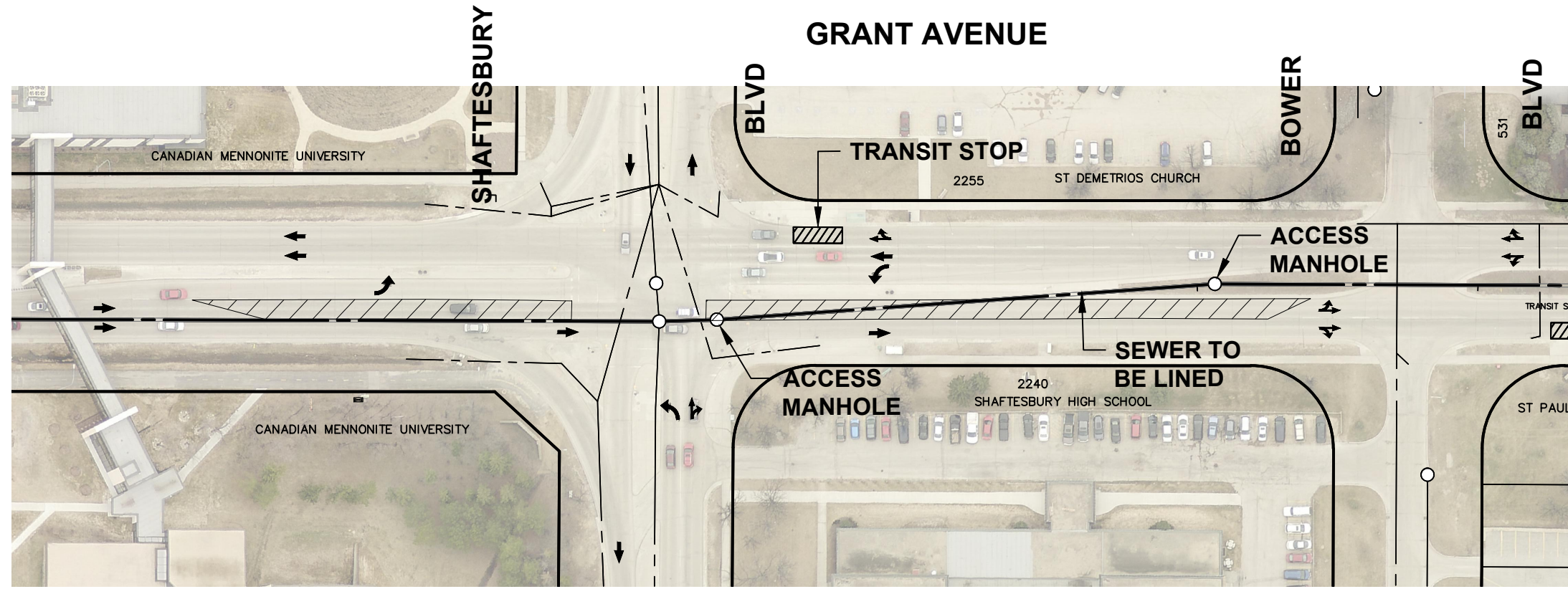

FOR CONTINUATION
SEE FIGURE 07

FOR CONTINUATION
SEE FIGURE 05

SCALE: 1:1000 (11"x17")

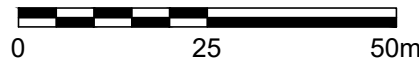

LEGEND:

- LANE CLOSURES ALLOWED DURING NON-PEAK HOURS
- TRAFFIC FLOW

NOTES:

1. MAINTAIN A MINIMUM OF ONE LANE OF TRAFFIC IN THE EASTBOUND AND WESTBOUND DIRECTIONS AT ALL TIMES DURING CONSTRUCTION. NO LANE CLOSURES WILL BE PERMITTED DURING PEAK HOURS.
2. PEAK HOURS ARE MONDAY TO FRIDAY 0700 HRS TO 0900 HRS AND FROM 1530 HRS TO 1730 HRS.
3. IF THE INSTALLATION OF THE LINER CANNOT BE COMPLETED WITHIN NON-PEAK HOURS, LINER INSTALLATION WILL HAVE TO BE COMPLETED DURING EVENINGS OR ON WEEKENDS.
4. INTERSECTING STREETS AND PRIVATE APPROACH ACCESS SHALL BE MAINTAINED AS SHOWN.
5. CONSTRUCTION STAGING IN ACCORDANCE WITH THE 2016 EDITION OF THE CITY OF WINNIPEG "MANUAL OF TEMPORARY TRAFFIC CONTROL IN WORK AREAS ON CITY STREETS".
6. MAINTAIN EXISTING DRAINAGE AND INSTALL PROPOSED DRAINAGE APPURTENANCES AS REQUIRED DURING THE APPROPRIATE STAGES AND AS DIRECTED BY THE CONTRACT ADMINISTRATOR.
7. IF REQUIRED, TO FACILITATE MANHOLE REMOVAL, SAWCUT EXISTING PAVEMENT (FULL DEPTH) PRIOR TO REMOVAL.
8. MAINTAIN PEDESTRIAN ACCESS TO ALL BUSINESSES.
9. ERECT AND MAINTAIN FENCE BETWEEN PEDESTRIANS AND CONSTRUCTION AREAS.
10. CONSTRUCTION SHALL NOT INTERFERE WITH TRANSIT STOPS AT ANY TIME UNLESS FIGURE ILLUSTRATES CLOSURE.
11. THESE LINERS ARE LOCATED WITHIN A SCHOOL ZONE, WORK MUST BE COMPLETED IN JULY OR AUGUST.

METRIC
WHOLE NUMBERS INDICATE MILLIMETRES
DECIMALIZED NUMBERS INDICATE METRES



2017 SEWER RENEWALS BY CIPP LINING
CONTRACT 3
TRAFFIC MANAGEMENT PLANS
BID OPPORTUNITY 94-2018

SCALE	1:1000
DATE	December, 2017
FIGURE NO.	06

GRANT AVENUE

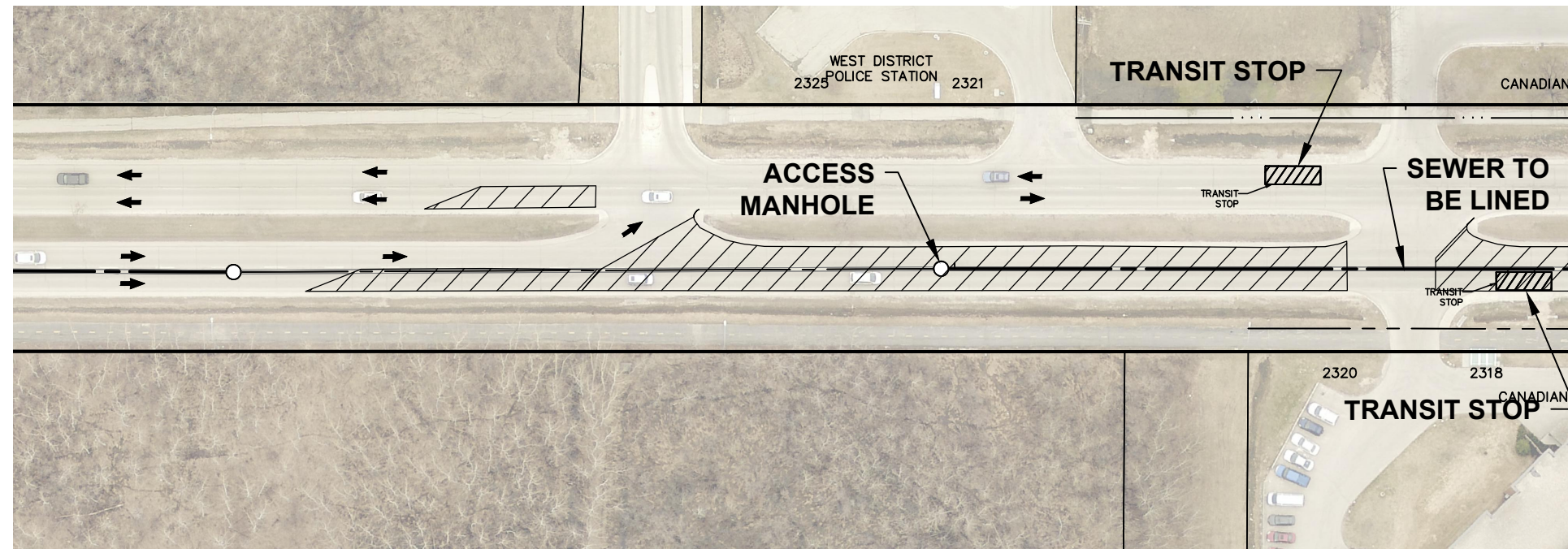

FOR CONTINUATION
SEE FIGURE 08

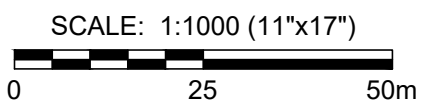
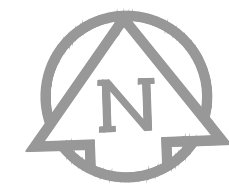

LEGEND:

- LANE CLOSURES ALLOWED DURING NON-PEAK HOURS
- TRAFFIC FLOW

NOTES:

1. MAINTAIN A MINIMUM OF ONE LANE OF TRAFFIC IN THE EASTBOUND AND WESTBOUND DIRECTIONS AT ALL TIMES DURING CONSTRUCTION. NO LANE CLOSURES WILL BE PERMITTED DURING PEAK HOURS.
2. PEAK HOURS ARE MONDAY TO FRIDAY 0700 HRS TO 0900 HRS AND FROM 1530 HRS TO 1730 HRS.
3. IF THE INSTALLATION OF THE LINER CANNOT BE COMPLETED WITHIN NON-PEAK HOURS, LINER INSTALLATION WILL HAVE TO BE COMPLETED DURING EVENINGS OR ON WEEKENDS.
4. INTERSECTING STREETS AND PRIVATE APPROACH ACCESS SHALL BE MAINTAINED AS SHOWN.
5. CONSTRUCTION STAGING IN ACCORDANCE WITH THE 2016 EDITION OF THE CITY OF WINNIPEG "MANUAL OF TEMPORARY TRAFFIC CONTROL IN WORK AREAS ON CITY STREETS".
6. MAINTAIN EXISTING DRAINAGE AND INSTALL PROPOSED DRAINAGE APPURTENANCES AS REQUIRED DURING THE APPROPRIATE STAGES AND AS DIRECTED BY THE CONTRACT ADMINISTRATOR.
7. IF REQUIRED, TO FACILITATE MANHOLE REMOVAL, SAWCUT EXISTING PAVEMENT (FULL DEPTH) PRIOR TO REMOVAL.
8. MAINTAIN PEDESTRIAN ACCESS TO ALL BUSINESSES.
9. ERECT AND MAINTAIN FENCE BETWEEN PEDESTRIANS AND CONSTRUCTION AREAS.
10. CONSTRUCTION SHALL NOT INTERFERE WITH TRANSIT STOPS AT ANY TIME UNLESS FIGURE ILLUSTRATES CLOSURE.
11. THESE LINERS ARE LOCATED WITHIN A SCHOOL ZONE, WORK MUST BE COMPLETED IN JULY OR AUGUST.

METRIC
WHOLE NUMBERS INDICATE MILLIMETRES
DECIMALIZED NUMBERS INDICATE METRES



2017 SEWER RENEWALS BY CIPP LINING
CONTRACT 3
TRAFFIC MANAGEMENT PLANS
BID OPPORTUNITY 94-2018

SCALE	1:1000
DATE	December, 2017
FIGURE NO.	07

GRANT AVENUE

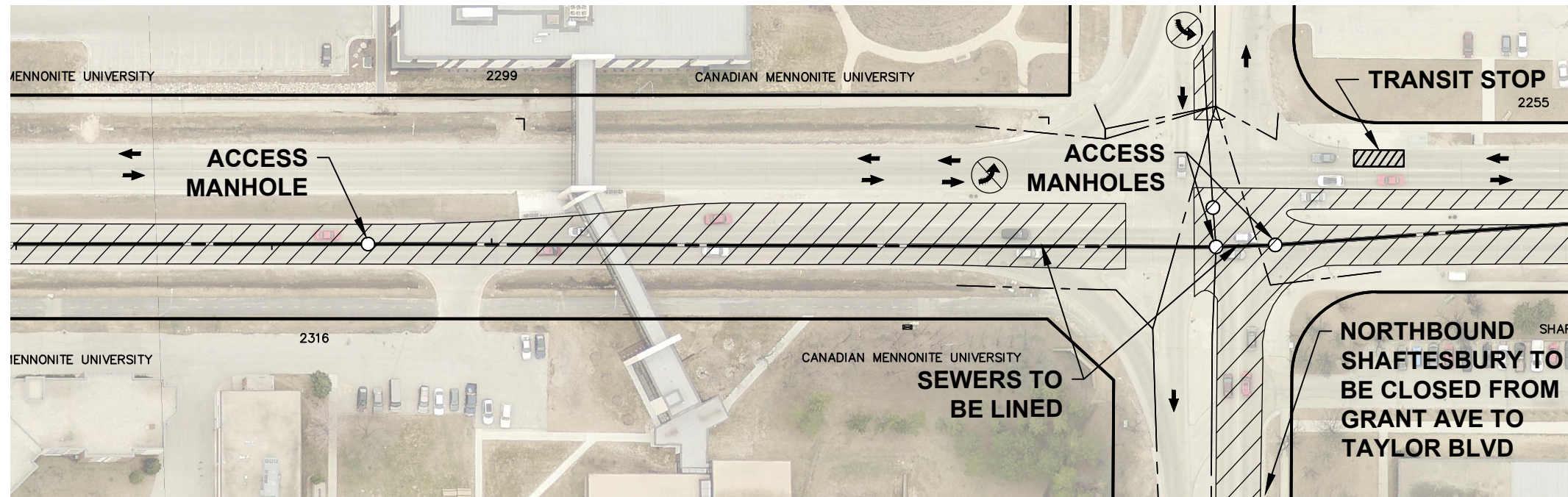

FOR CONTINUATION
SEE FIGURE 09

SCALE: 1:1000 (11"x17")

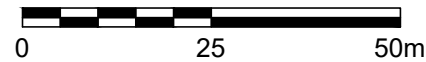

NOTES:

1. MAINTAIN A MINIMUM OF ONE LANE OF TRAFFIC IN THE EASTBOUND AND WESTBOUND DIRECTIONS AT ALL TIMES DURING CONSTRUCTION. NO LANE CLOSURES WILL BE PERMITTED DURING PEAK HOURS.
2. PEAK HOURS ARE MONDAY TO FRIDAY 0700 HRS TO 0900 HRS AND FROM 1530 HRS TO 1730 HRS.
3. IF THE INSTALLATION OF THE LINER CANNOT BE COMPLETED WITHIN NON-PEAK HOURS, LINER INSTALLATION WILL HAVE TO BE COMPLETED DURING EVENINGS OR ON WEEKENDS.
4. INTERSECTING STREETS AND PRIVATE APPROACH ACCESS SHALL BE MAINTAINED AS SHOWN.
5. CONSTRUCTION STAGING IN ACCORDANCE WITH THE 2016 EDITION OF THE CITY OF WINNIPEG "MANUAL OF TEMPORARY TRAFFIC CONTROL IN WORK AREAS ON CITY STREETS".
6. MAINTAIN EXISTING DRAINAGE AND INSTALL PROPOSED DRAINAGE APPURTENANCES AS REQUIRED DURING THE APPROPRIATE STAGES AND AS DIRECTED BY THE CONTRACT ADMINISTRATOR.
7. IF REQUIRED, TO FACILITATE MANHOLE REMOVAL, SAWCUT EXISTING PAVEMENT (FULL DEPTH) PRIOR TO REMOVAL.
8. MAINTAIN PEDESTRIAN ACCESS TO ALL BUSINESSES.
9. ERECT AND MAINTAIN FENCE BETWEEN PEDESTRIANS AND CONSTRUCTION AREAS.
10. CONSTRUCTION SHALL NOT INTERFERE WITH TRANSIT STOPS AT ANY TIME UNLESS FIGURE ILLUSTRATES CLOSURE.
11. THESE LINERS ARE LOCATED WITHIN A SCHOOL ZONE, WORK MUST BE COMPLETED IN JULY OR AUGUST.

LEGEND:

- LANE CLOSURES ALLOWED DURING NON-PEAK HOURS
- TRAFFIC FLOW

METRIC
WHOLE NUMBERS INDICATE MILLIMETRES
DECIMALIZED NUMBERS INDICATE METRES



2017 SEWER RENEWALS BY CIPP LINING
CONTRACT 3
TRAFFIC MANAGEMENT PLANS
BID OPPORTUNITY 94-2018

SCALE
1:1000
DATE
December, 2017
FIGURE NO.
08

FOR CONTINUATION
SEE FIGURE 08

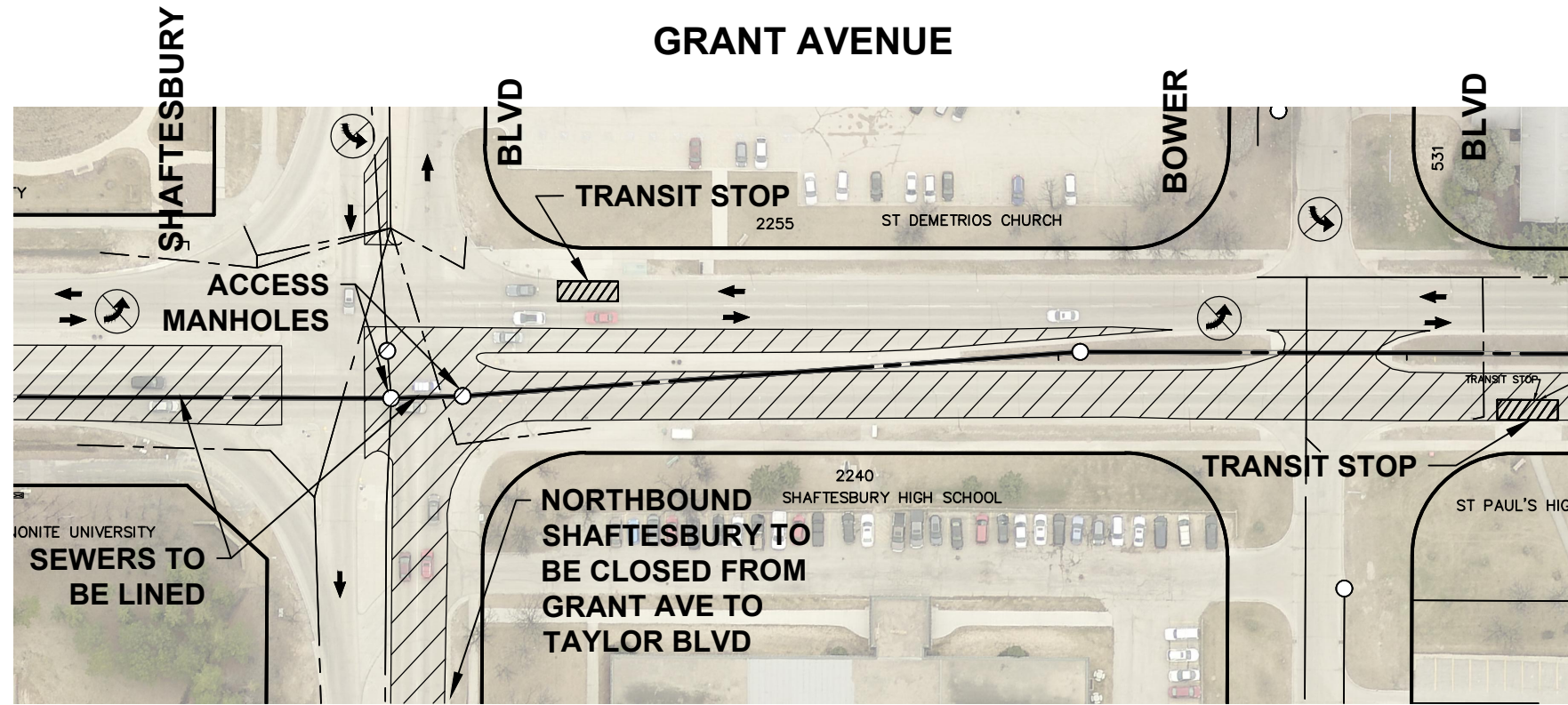

FOR CONTINUATION
SEE FIGURE 10



SCALE: 1:1000 (11"x17")



NOTES:

1. MAINTAIN A MINIMUM OF ONE LANE OF TRAFFIC IN THE EASTBOUND AND WESTBOUND DIRECTIONS AT ALL TIMES DURING CONSTRUCTION. NO LANE CLOSURES WILL BE PERMITTED DURING PEAK HOURS.
2. PEAK HOURS ARE MONDAY TO FRIDAY 0700 HRS TO 0900 HRS AND FROM 1530 HRS TO 1730 HRS.
3. IF THE INSTALLATION OF THE LINER CANNOT BE COMPLETED WITHIN NON-PEAK HOURS, LINER INSTALLATION WILL HAVE TO BE COMPLETED DURING EVENINGS OR ON WEEKENDS.
4. INTERSECTING STREETS AND PRIVATE APPROACH ACCESS SHALL BE MAINTAINED AS SHOWN.
5. CONSTRUCTION STAGING IN ACCORDANCE WITH THE 2016 EDITION OF THE CITY OF WINNIPEG "MANUAL OF TEMPORARY TRAFFIC CONTROL IN WORK AREAS ON CITY STREETS".
6. MAINTAIN EXISTING DRAINAGE AND INSTALL PROPOSED DRAINAGE APPURTENANCES AS REQUIRED DURING THE APPROPRIATE STAGES AND AS DIRECTED BY THE CONTRACT ADMINISTRATOR.
7. IF REQUIRED, TO FACILITATE MANHOLE REMOVAL, SAWCUT EXISTING PAVEMENT (FULL DEPTH) PRIOR TO REMOVAL.
8. MAINTAIN PEDESTRIAN ACCESS TO ALL BUSINESSES.
9. ERECT AND MAINTAIN FENCE BETWEEN PEDESTRIANS AND CONSTRUCTION AREAS.
10. CONSTRUCTION SHALL NOT INTERFERE WITH TRANSIT STOPS AT ANY TIME UNLESS FIGURE ILLUSTRATES CLOSURE.
11. THESE LINERS ARE LOCATED WITHIN A SCHOOL ZONE, WORK MUST BE COMPLETED IN JULY OR AUGUST.

LEGEND:

- LANE CLOSURES ALLOWED DURING NON-PEAK HOURS
- TRAFFIC FLOW

METRIC
 WHOLE NUMBERS INDICATE MILLIMETRES
 DECIMALIZED NUMBERS INDICATE METRES



2017 SEWER RENEWALS BY CIPP LINING
 CONTRACT 3
TRAFFIC MANAGEMENT PLANS
 BID OPPORTUNITY 94-2018

SCALE	1:1000
DATE	December, 2017
FIGURE NO.	09

FOR CONTINUATION
SEE FIGURE 09

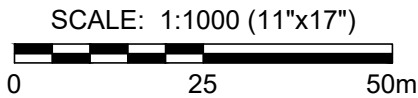
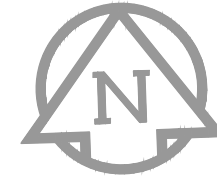
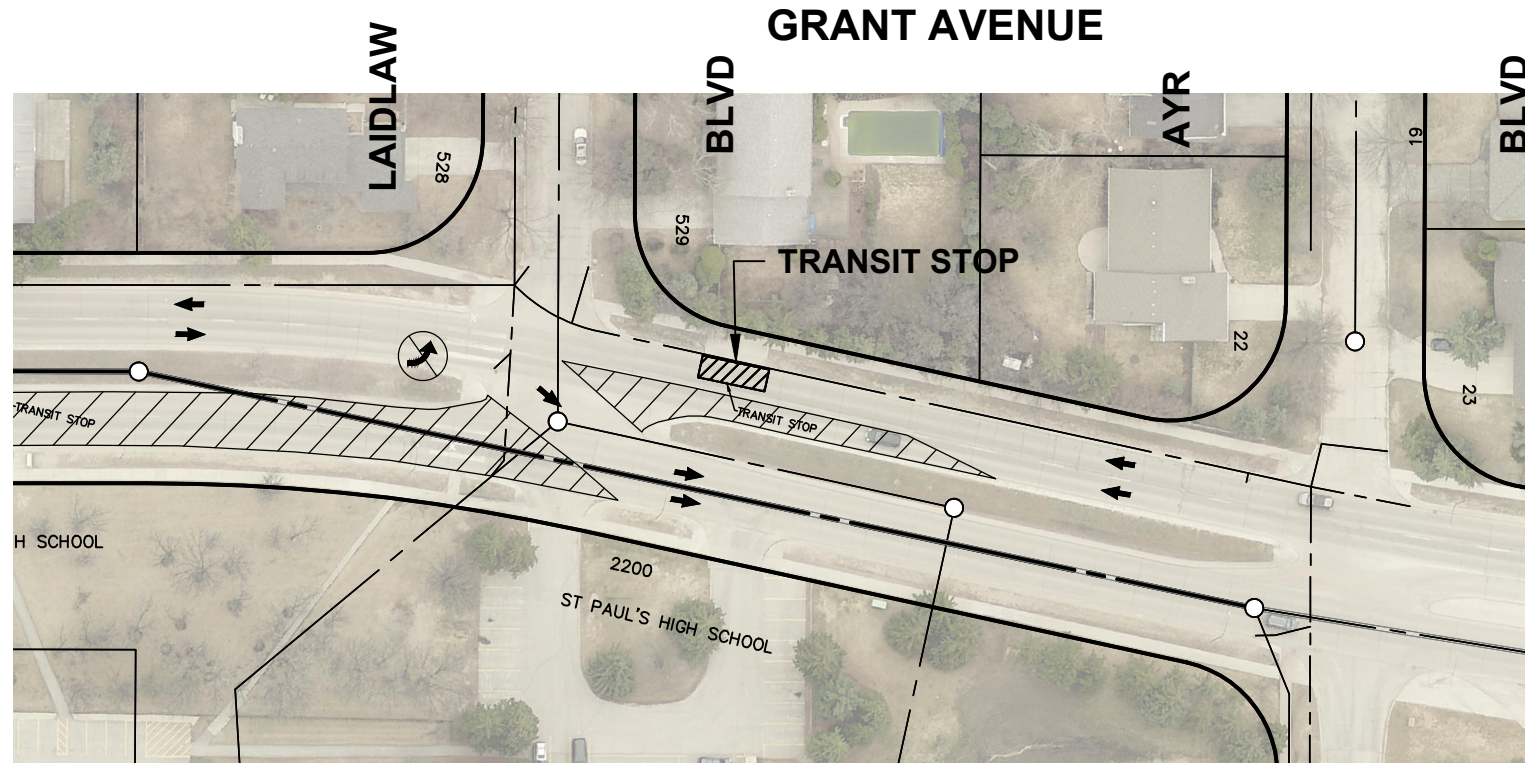

LEGEND:

- LANE CLOSURES ALLOWED DURING NON-PEAK HOURS
- TRAFFIC FLOW

NOTES:

1. MAINTAIN A MINIMUM OF ONE LANE OF TRAFFIC IN THE EASTBOUND AND WESTBOUND DIRECTIONS AT ALL TIMES DURING CONSTRUCTION. NO LANE CLOSURES WILL BE PERMITTED DURING PEAK HOURS.
2. PEAK HOURS ARE MONDAY TO FRIDAY 0700 HRS TO 0900 HRS AND FROM 1530 HRS TO 1730 HRS.
3. IF THE INSTALLATION OF THE LINER CANNOT BE COMPLETED WITHIN NON-PEAK HOURS, LINER INSTALLATION WILL HAVE TO BE COMPLETED DURING EVENINGS OR ON WEEKENDS.
4. INTERSECTING STREETS AND PRIVATE APPROACH ACCESS SHALL BE MAINTAINED AS SHOWN.
5. CONSTRUCTION STAGING IN ACCORDANCE WITH THE 2016 EDITION OF THE CITY OF WINNIPEG "MANUAL OF TEMPORARY TRAFFIC CONTROL IN WORK AREAS ON CITY STREETS".
6. MAINTAIN EXISTING DRAINAGE AND INSTALL PROPOSED DRAINAGE APPURTENANCES AS REQUIRED DURING THE APPROPRIATE STAGES AND AS DIRECTED BY THE CONTRACT ADMINISTRATOR.
7. IF REQUIRED, TO FACILITATE MANHOLE REMOVAL, SAWCUT EXISTING PAVEMENT (FULL DEPTH) PRIOR TO REMOVAL.
8. MAINTAIN PEDESTRIAN ACCESS TO ALL BUSINESSES.
9. ERECT AND MAINTAIN FENCE BETWEEN PEDESTRIANS AND CONSTRUCTION AREAS.
10. CONSTRUCTION SHALL NOT INTERFERE WITH TRANSIT STOPS AT ANY TIME UNLESS FIGURE ILLUSTRATES CLOSURE.
11. THESE LINERS ARE LOCATED WITHIN A SCHOOL ZONE, WORK MUST BE COMPLETED IN JULY OR AUGUST.

METRIC
WHOLE NUMBERS INDICATE MILLIMETRES
DECIMALIZED NUMBERS INDICATE METRES



2017 SEWER RENEWALS BY CIPP LINING
CONTRACT 3
TRAFFIC MANAGEMENT PLANS
BID OPPORTUNITY 94-2018

SCALE	1:1000
DATE	December, 2017
FIGURE NO.	10

GRANT AVENUE

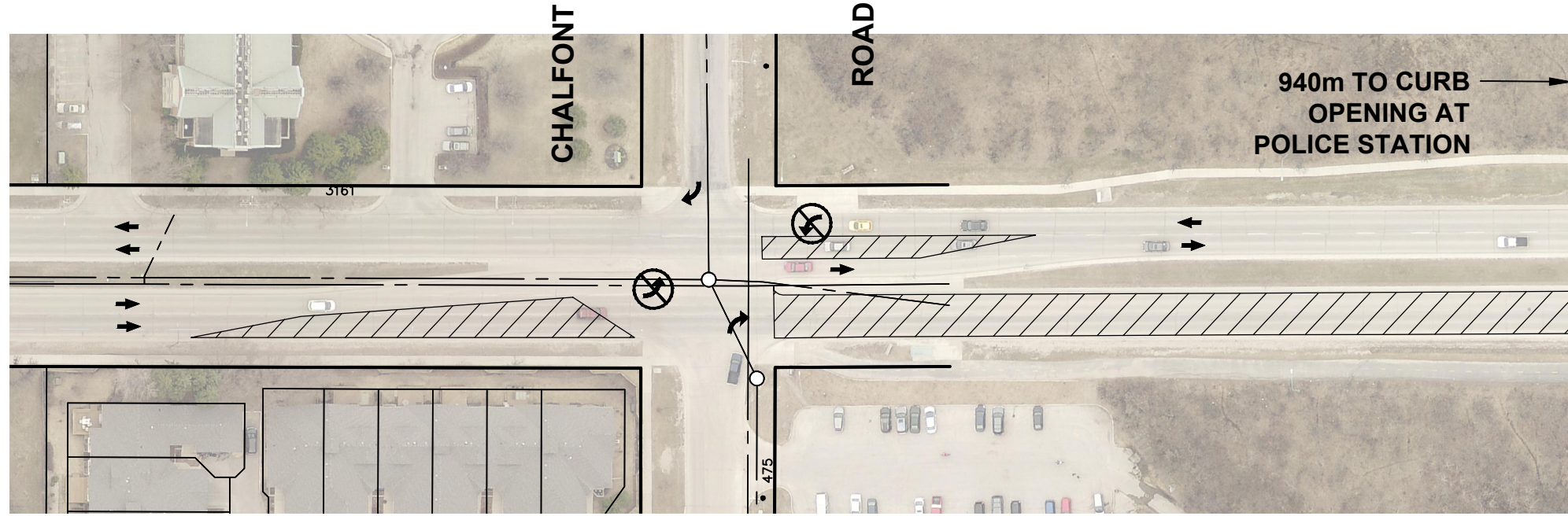

FOR CONTINUATION
SEE FIGURE 12

SCALE: 1:1000 (11"x17")

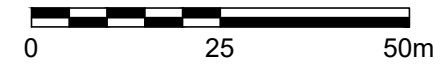

LEGEND:

- LANE CLOSURES ALLOWED DURING NON-PEAK HOURS
- TRAFFIC FLOW

NOTES:

1. MAINTAIN A MINIMUM OF ONE LANE OF TRAFFIC IN THE EASTBOUND AND WESTBOUND DIRECTIONS AT ALL TIMES DURING CONSTRUCTION. NO LANE CLOSURES WILL BE PERMITTED DURING PEAK HOURS.
2. PEAK HOURS ARE MONDAY TO FRIDAY 0700 HRS TO 0900 HRS AND FROM 1530 HRS TO 1730 HRS.
3. IF THE INSTALLATION OF THE LINER CANNOT BE COMPLETED WITHIN NON-PEAK HOURS, LINER INSTALLATION WILL HAVE TO BE COMPLETED DURING EVENINGS OR ON WEEKENDS.
4. INTERSECTING STREETS AND PRIVATE APPROACH ACCESS SHALL BE MAINTAINED AS SHOWN.
5. CONSTRUCTION STAGING IN ACCORDANCE WITH THE 2016 EDITION OF THE CITY OF WINNIPEG "MANUAL OF TEMPORARY TRAFFIC CONTROL IN WORK AREAS ON CITY STREETS".
6. MAINTAIN EXISTING DRAINAGE AND INSTALL PROPOSED DRAINAGE APPURTENANCES AS REQUIRED DURING THE APPROPRIATE STAGES AND AS DIRECTED BY THE CONTRACT ADMINISTRATOR.
7. IF REQUIRED, TO FACILITATE MANHOLE REMOVAL, SAWCUT EXISTING PAVEMENT (FULL DEPTH) PRIOR TO REMOVAL.
8. MAINTAIN PEDESTRIAN ACCESS TO ALL BUSINESSES.
9. ERECT AND MAINTAIN FENCE BETWEEN PEDESTRIANS AND CONSTRUCTION AREAS.
10. CONSTRUCTION SHALL NOT INTERFERE WITH TRANSIT STOPS AT ANY TIME UNLESS FIGURE ILLUSTRATES CLOSURE.

METRIC
WHOLE NUMBERS INDICATE MILLIMETRES
DECIMALIZED NUMBERS INDICATE METRES



2017 SEWER RENEWALS BY CIPP LINING
CONTRACT 3
TRAFFIC MANAGEMENT PLANS
BID OPPORTUNITY 94-2018

SCALE	1:1000
DATE	December, 2017
FIGURE NO.	11

GRANT AVENUE

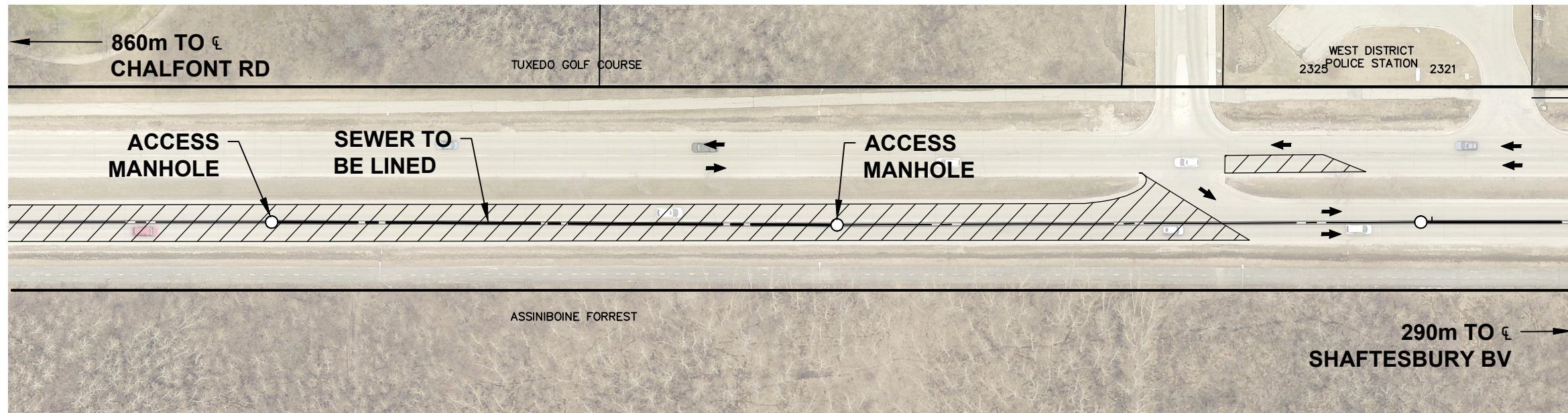

FOR CONTINUATION
SEE FIGURE 12

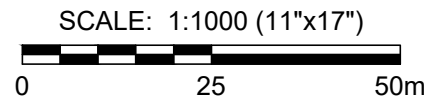

NOTES:

1. MAINTAIN A MINIMUM OF ONE LANE OF TRAFFIC IN THE EASTBOUND AND WESTBOUND DIRECTIONS AT ALL TIMES DURING CONSTRUCTION. NO LANE CLOSURES WILL BE PERMITTED DURING PEAK HOURS.
2. PEAK HOURS ARE MONDAY TO FRIDAY 0700 HRS TO 0900 HRS AND FROM 1530 HRS TO 1730 HRS.
3. IF THE INSTALLATION OF THE LINER CANNOT BE COMPLETED WITHIN NON-PEAK HOURS, LINER INSTALLATION WILL HAVE TO BE COMPLETED DURING EVENINGS OR ON WEEKENDS.
4. INTERSECTING STREETS AND PRIVATE APPROACH ACCESS SHALL BE MAINTAINED AS SHOWN.
5. CONSTRUCTION STAGING IN ACCORDANCE WITH THE 2016 EDITION OF THE CITY OF WINNIPEG "MANUAL OF TEMPORARY TRAFFIC CONTROL IN WORK AREAS ON CITY STREETS".
6. MAINTAIN EXISTING DRAINAGE AND INSTALL PROPOSED DRAINAGE APPURTENANCES AS REQUIRED DURING THE APPROPRIATE STAGES AND AS DIRECTED BY THE CONTRACT ADMINISTRATOR.
7. IF REQUIRED, TO FACILITATE MANHOLE REMOVAL, SAWCUT EXISTING PAVEMENT (FULL DEPTH) PRIOR TO REMOVAL.
8. MAINTAIN PEDESTRIAN ACCESS TO ALL BUSINESSES.
9. ERECT AND MAINTAIN FENCE BETWEEN PEDESTRIANS AND CONSTRUCTION AREAS.
10. CONSTRUCTION SHALL NOT INTERFERE WITH TRANSIT STOPS AT ANY TIME UNLESS FIGURE ILLUSTRATES CLOSURE.

LEGEND:

- LANE CLOSURES ALLOWED DURING NON-PEAK HOURS
- TRAFFIC FLOW

11"x17" SIZE 279.4mm x 431.8mm

PLOT: 3/8/2018 3:34:30 PM

FILE NAME: 1700089 - Traffic Management.dwg Saved By: jhines

METRIC
WHOLE NUMBERS INDICATE MILLIMETRES
DECIMALIZED NUMBERS INDICATE METRES



2017 SEWER RENEWALS BY CIPP LINING
CONTRACT 3
TRAFFIC MANAGEMENT PLANS
BID OPPORTUNITY 94-2018

SCALE	1:1000
DATE	December, 2017
FIGURE NO.	12

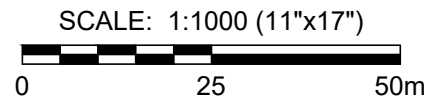
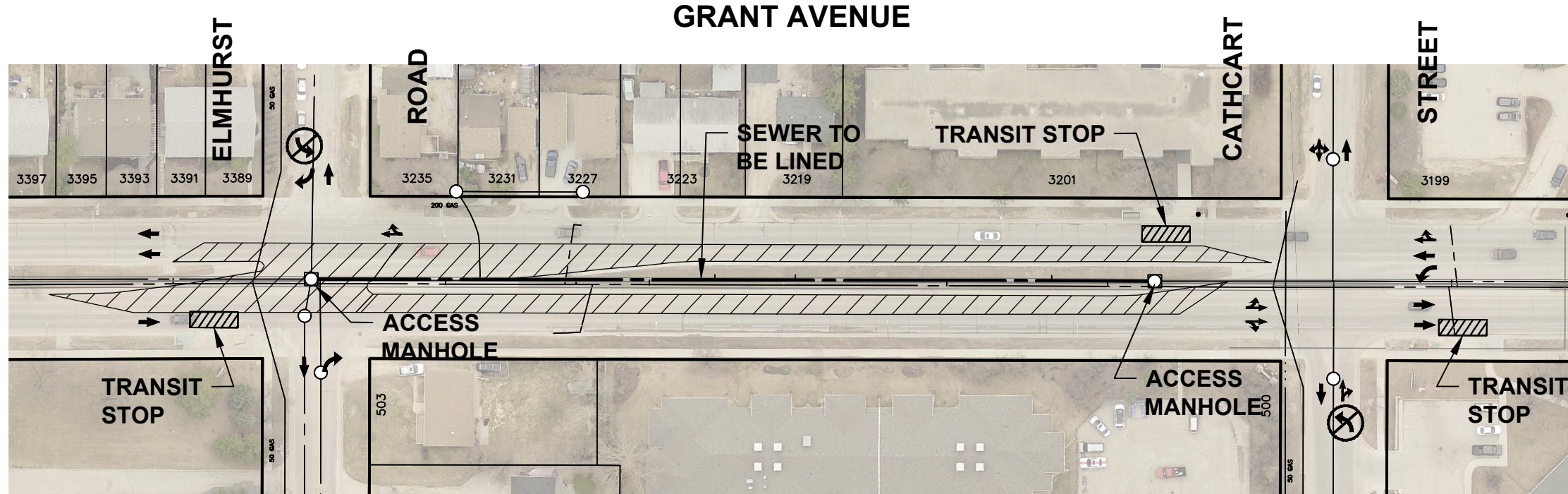

LEGEND:

- LANE CLOSURES ALLOWED DURING NON-PEAK HOURS
- TRAFFIC FLOW

NOTES:

1. MAINTAIN A MINIMUM OF ONE LANE OF TRAFFIC IN THE EASTBOUND AND WESTBOUND DIRECTIONS AT ALL TIMES DURING CONSTRUCTION. NO LANE CLOSURES WILL BE PERMITTED DURING PEAK HOURS.
2. PEAK HOURS ARE MONDAY TO FRIDAY 0700 HRS TO 0900 HRS AND FROM 1530 HRS TO 1730 HRS.
3. IF THE INSTALLATION OF THE LINER CANNOT BE COMPLETED WITHIN NON-PEAK HOURS, LINER INSTALLATION WILL HAVE TO BE COMPLETED DURING EVENINGS OR ON WEEKENDS.
4. INTERSECTING STREETS AND PRIVATE APPROACH ACCESS SHALL BE MAINTAINED AS SHOWN.
5. CONSTRUCTION STAGING IN ACCORDANCE WITH THE 2016 EDITION OF THE CITY OF WINNIPEG "MANUAL OF TEMPORARY TRAFFIC CONTROL IN WORK AREAS ON CITY STREETS".
6. MAINTAIN EXISTING DRAINAGE AND INSTALL PROPOSED DRAINAGE APPURTENANCES AS REQUIRED DURING THE APPROPRIATE STAGES AND AS DIRECTED BY THE CONTRACT ADMINISTRATOR.
7. IF REQUIRED, TO FACILITATE MANHOLE REMOVAL, SAWCUT EXISTING PAVEMENT (FULL DEPTH) PRIOR TO REMOVAL.
8. MAINTAIN PEDESTRIAN ACCESS TO ALL BUSINESSES.
9. ERECT AND MAINTAIN FENCE BETWEEN PEDESTRIANS AND CONSTRUCTION AREAS.
10. CONSTRUCTION SHALL NOT INTERFERE WITH TRANSIT STOPS AT ANY TIME UNLESS FIGURE ILLUSTRATES CLOSURE.

METRIC
WHOLE NUMBERS INDICATE MILLIMETRES
DECIMALIZED NUMBERS INDICATE METRES



2017 SEWER RENEWALS BY CIPP LINING
CONTRACT 3
TRAFFIC MANAGEMENT PLANS
BID OPPORTUNITY 94-2018

SCALE	1:1000
DATE	December, 2017
FIGURE NO.	13

LAGIMODIERE BOULEVARD

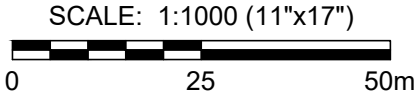
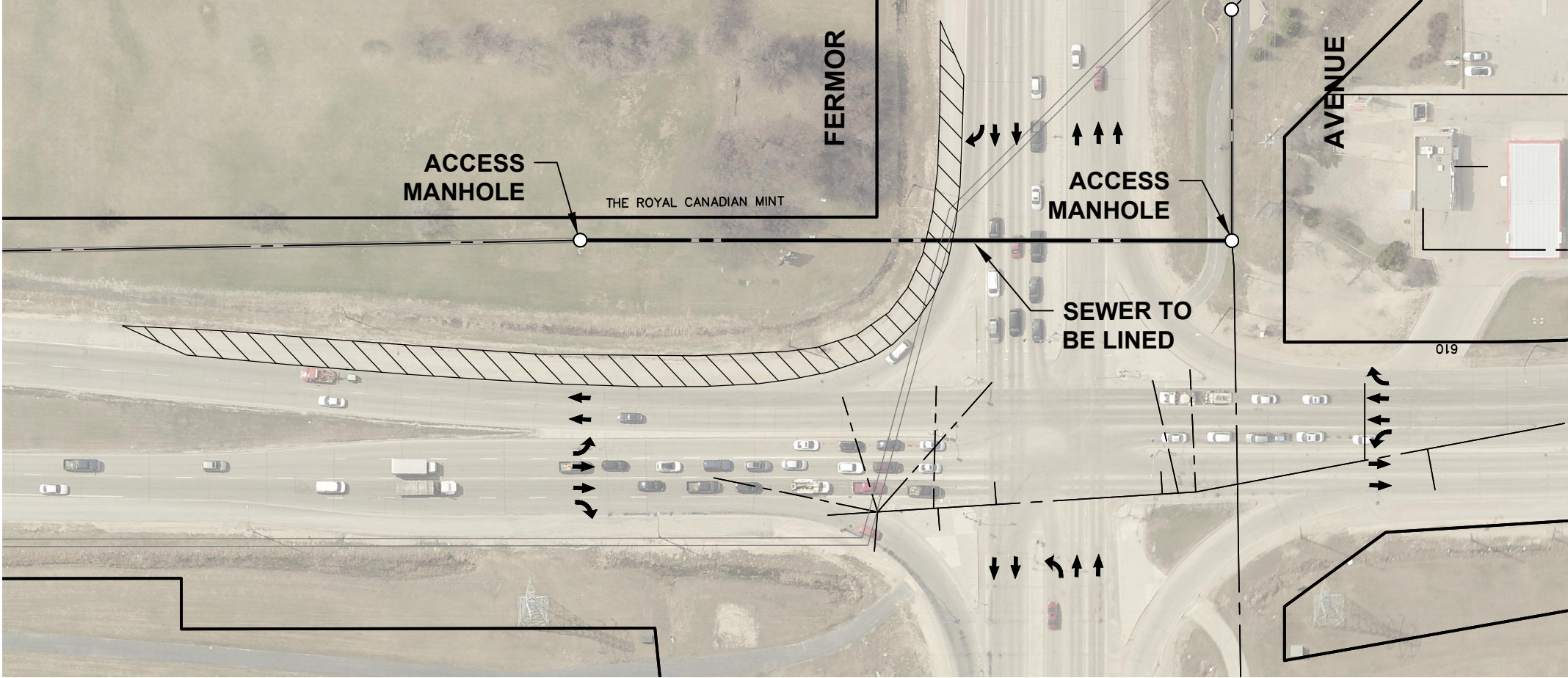

LEGEND:

- LANE CLOSURES ALLOWED DURING NON-PEAK HOURS
- TRAFFIC FLOW

NOTES:

1. ONLY THE SHOULDER WILL BE CLOSED AS SHOWN DURING CONSTRUCTION. NO LANE CLOSURES WILL BE PERMITTED DURING PEAK HOURS.
2. PEAK HOURS ARE MONDAY TO FRIDAY 0700 HRS TO 0900 HRS AND FROM 1530 HRS TO 1730 HRS.
3. IF THE INSTALLATION OF THE LINER CANNOT BE COMPLETED WITHIN NON-PEAK HOURS, LINER INSTALLATION WILL HAVE TO BE COMPLETED DURING EVENINGS OR ON WEEKENDS.
4. INTERSECTING STREETS AND PRIVATE APPROACH ACCESS SHALL BE MAINTAINED AS SHOWN.
5. CONSTRUCTION STAGING IN ACCORDANCE WITH THE 2016 EDITION OF THE CITY OF WINNIPEG "MANUAL OF TEMPORARY TRAFFIC CONTROL IN WORK AREAS ON CITY STREETS".
6. MAINTAIN EXISTING DRAINAGE AND INSTALL PROPOSED DRAINAGE APPURTENANCES AS REQUIRED DURING THE APPROPRIATE STAGES AND AS DIRECTED BY THE CONTRACT ADMINISTRATOR.
7. MAINTAIN PEDESTRIAN ACCESS TO ALL BUSINESSES.
8. ERECT AND MAINTAIN FENCE BETWEEN PEDESTRIANS AND CONSTRUCTION AREAS.

METRIC
 WHOLE NUMBERS INDICATE MILLIMETRES
 DECIMALIZED NUMBERS INDICATE METRES



2017 SEWER RENEWALS BY CIPP LINING
 CONTRACT 3
TRAFFIC MANAGEMENT PLANS
 BID OPPORTUNITY 94-2018

SCALE	1:1000
DATE	December, 2017
FIGURE NO.	14

ST. MATTHEWS AVENUE

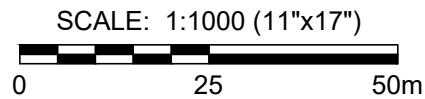
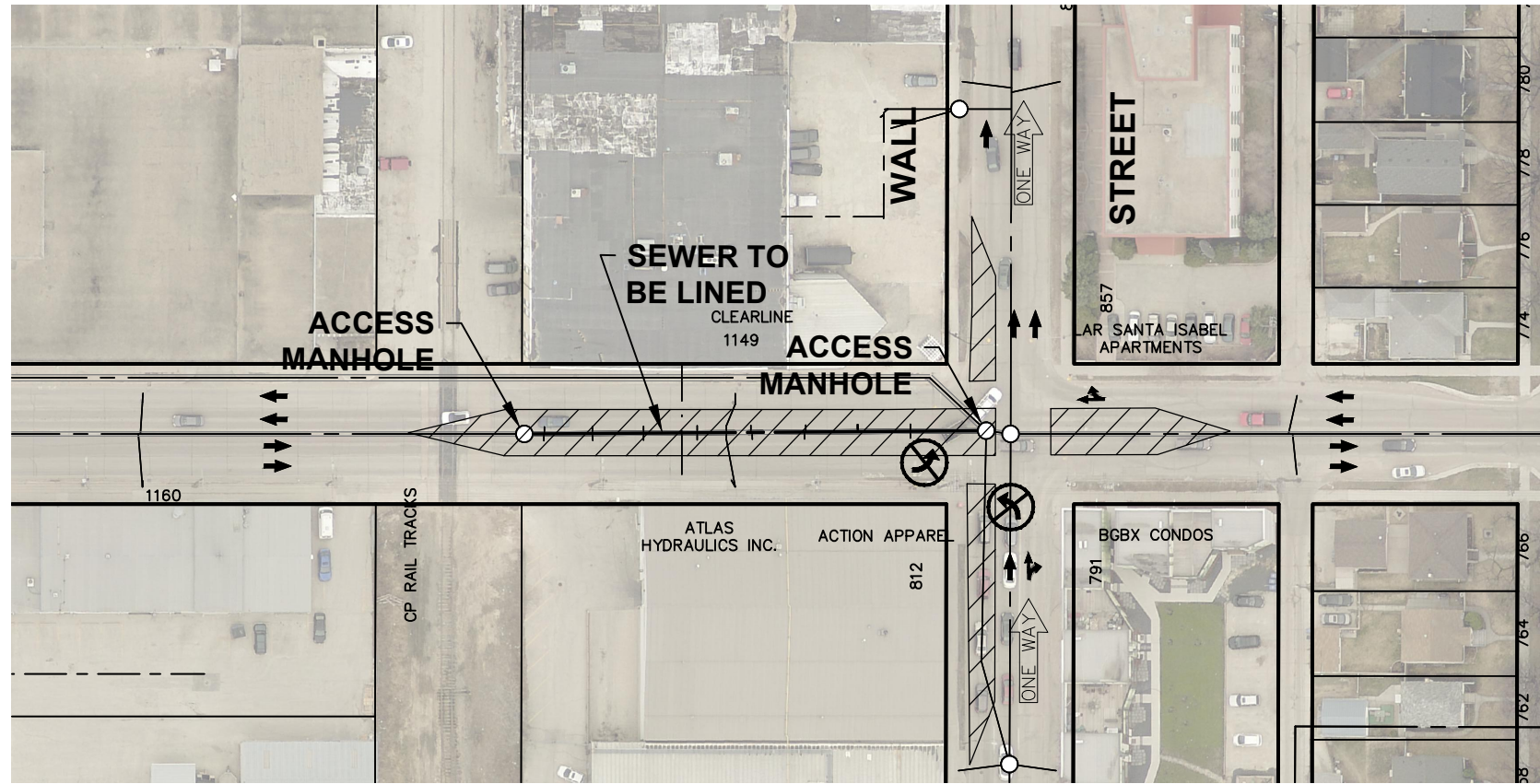

LEGEND:

- LANE CLOSURES ALLOWED DURING NON-PEAK HOURS
- TRAFFIC FLOW

NOTES:

1. MAINTAIN A MINIMUM OF ONE LANE OF TRAFFIC IN THE EASTBOUND AND WESTBOUND LANES ON ST. MATTHEWS AVE. AT ALL TIMES DURING CONSTRUCTION. NO LANE CLOSURES WILL BE PERMITTED DURING PEAK HOURS.
2. MAINTAIN A MINIMUM OF TWO LANES OF NORTHBOUND TRAFFIC ON WALL ST. AT ALL TIMES DURING CONSTRUCTION. NO LANE CLOSURES WILL BE PERMITTED DURING PEAK HOURS.
3. PEAK HOURS ARE MONDAY TO FRIDAY 0700 HRS TO 0900 HRS AND FROM 1530 HRS TO 1730 HRS.
4. IF THE INSTALLATION OF THE LINER CANNOT BE COMPLETED WITHIN NON-PEAK HOURS, LINER INSTALLATION WILL HAVE TO BE COMPLETED DURING EVENINGS OR ON WEEKENDS.
5. INTERSECTING STREETS AND PRIVATE APPROACH ACCESS SHALL BE MAINTAINED AS SHOWN.
6. CONSTRUCTION STAGING IN ACCORDANCE WITH THE 2016 EDITION OF THE CITY OF WINNIPEG "MANUAL OF TEMPORARY TRAFFIC CONTROL IN WORK AREAS ON CITY STREETS".
7. MAINTAIN EXISTING DRAINAGE AND INSTALL PROPOSED DRAINAGE APPURTENANCES AS REQUIRED DURING THE APPROPRIATE STAGES AND AS DIRECTED BY THE CONTRACT ADMINISTRATOR.
8. IF REQUIRED, TO FACILITATE MANHOLE REMOVAL, SAWCUT EXISTING PAVEMENT (FULL DEPTH) PRIOR TO REMOVAL.
9. MAINTAIN PEDESTRIAN ACCESS TO ALL BUSINESSES.
10. ERECT AND MAINTAIN FENCE BETWEEN PEDESTRIANS AND CONSTRUCTION AREAS.

METRIC
WHOLE NUMBERS INDICATE MILLIMETRES
DECIMALIZED NUMBERS INDICATE METRES



2017 SEWER RENEWALS BY CIPP LINING
CONTRACT 3
TRAFFIC MANAGEMENT PLANS
BID OPPORTUNITY 94-2018

SCALE	1:1000
DATE	December, 2017
FIGURE NO.	15