

GRANT AVENUE

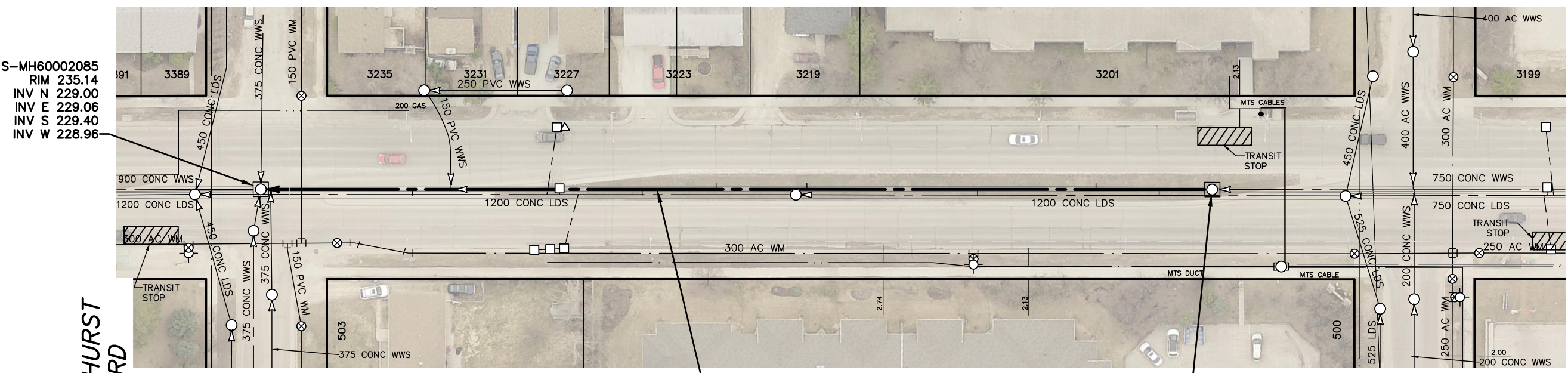

S-MH60002085
RIM 235.14
INV N 229.00
INV E 229.06
INV S 229.40
INV W 228.96

S-MH60002139
RIM 235.60
INV E 229.35
INV W 229.38

158.3 OF 750 CONC WWS TO BE LINED
S-MA60020828
(PARTIALLY DETERIORATED)

ELMHURST RD

CATHCART ST

SEWER JUNCTION INFORMATION FROM SEWER VIDEO INSPECTION		
SEWER ID S-MA60020828		
DISTANCE FROM MH ID S-MH60002139		
DISTANCE	DIAMETER	CLOCK
8.8	100	10
19.3	100	02
39.0	100	10
67.4	100	02
82.5	100	01
94.8	100	11
126.6	100	02
133.0	100	11
156.6	250	09

WARNING
IF POWER EQUIPMENT OR EXPLOSIVES ARE TO BE USED FOR EXCAVATION ON THIS PROJECT THE CONTRACTOR MUST:
1) NOTIFY THE GAS COMPANY OF THE PROPOSED LOCATION OF EXCAVATION.
2) TAKE PRECAUTION TO AVOID DAMAGE TO GAS COMPANY INSTALLATIONS.
SEE PROVINCIAL REGULATION 210/72 FOR DETAILS

FOR INDEX SEE 11643

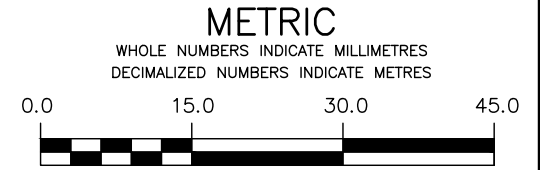

LOCATION APPROVED UNDERGROUND STRUCTURES		B.M. ELEV.
SUPV. U/G STRUCTURES COMMITTEE	DATE	
NOTE: LOCATION OF UNDERGROUND STRUCTURES AS SHOWN ARE BASED ON THE BEST INFORMATION AVAILABLE BUT NO GUARANTEE IS GIVEN THAT ALL EXISTING UTILITIES ARE SHOWN OR THAT THE GIVEN LOCATIONS ARE EXACT. CONFIRMATION OF EXISTENCE AND EXACT LOCATION OF ALL SERVICES MUST BE OBTAINED FROM THE INDIVIDUAL UTILITIES BEFORE PROCEEDING WITH CONSTRUCTION.		
NO.	REVISIONS	DATE BY

MH MORRISON HERSHFIELD

DESIGNED BY	JKH	CHECKED BY	HAK
DRAWN BY	DML	APPROVED BY	BWB
SCALE: HORIZONTAL VERTICAL	1:750	RELEASED FOR CONSTRUCTION	ORIGINAL SIGNED K. ZUREK
DATE	18/01/15	DATE	2018 03 12

ENGINEER'S SEAL
ORIGINAL SIGNED BY H.A. KATZ 2018 03 12
CONSULTANT DRAWING NUMBER

THE CITY OF WINNIPEG
WATER AND WASTE DEPARTMENT
ENGINEERING DIVISION

2017 SEWER RENEWALS
BY CIPP LINING - CONTRACT NO. 3
GRANT AVENUE
1ST MH W OF CATHCART STREET TO MH AT ELMHURST ROAD

SHEET 5 OF 25
CITY DRAWING NUMBER
11646