

- NOTES:**
1. ALL EXCAVATED MATERIAL WITHIN 76.2 (250ft) OF THE REGULATED SUMMER RIVER LEVEL (RSRL) MUST BE REMOVED FROM SITE (NO STOCKPILING).
  2. CONSTRUCT CLAY COFFERDAM AT CREEK AS REQUIRED (SEE DWG LD-9569).
  3. REMOVE AND INSTALL NEW TREES AS DIRECTED BY THE CONTRACT ADMINISTRATOR.
  4. CONTRACTOR TO PROVIDE AND INSTALL PROPER WARNING SIGNS ALONG PEDESTRIAN PATHWAY CONCERNING WORK SITE.
  5. THERE HAS BEEN ON-GOING COORDINATION WITH MANITOBA HYDRO TO RELOCATE EXISTING TRANSFORMER. CONTRACTOR TO COORDINATE WITH MANITOBA HYDRO AS REQUIRED TO MEET CONTRACTOR'S PROPOSED SCHEDULE. COSTS FOR TRANSFORMER RELOCATION AND NEW BURIED ELECTRICAL CONDUCTORS TO MILL AND WASHROOM COVERED DIRECTLY BY CITY OF WINNIPEG (OUTSIDE OF CONTRACT).
  6. COST OF ELECTRICAL CONNECTIONS AND UPGRADE OF ELECTRICAL SERVICE BOX FOR GRANTS OLD MILL BUILDING IS THE RESPONSIBILITY OF THE CONTRACTOR.

NOTE: CHAINAGES SHOWN ARE ALONG  $\phi$  OF 1850 CONC LDS

FOR INDEX PAGE SEE DWG LD-9566

FOR GEOTECHNICAL WORKS SEE DWG LD-9568

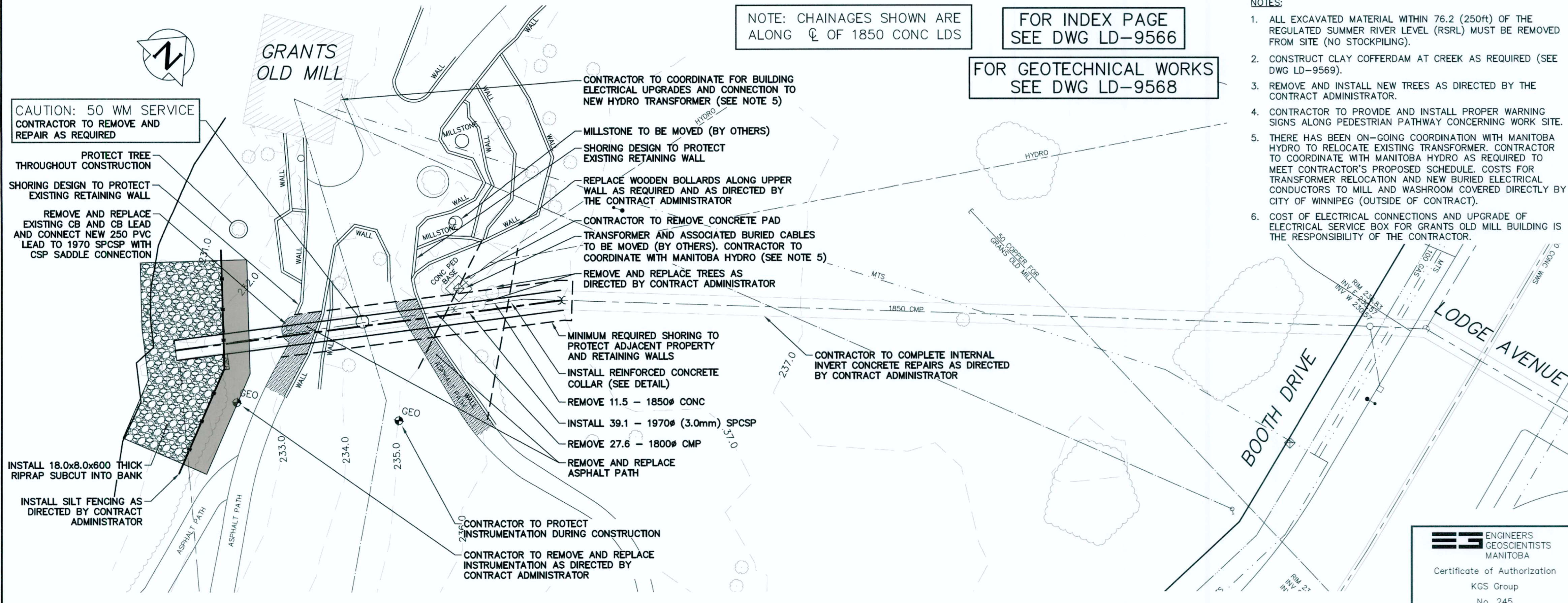

**CAUTION: 50 WM SERVICE**  
CONTRACTOR TO REMOVE AND REPAIR AS REQUIRED

PROTECT TREE THROUGHOUT CONSTRUCTION  
SHORING DESIGN TO PROTECT EXISTING RETAINING WALL  
REMOVE AND REPLACE EXISTING CB AND CB LEAD AND CONNECT NEW 250 PVC LEAD TO 1970 SPCSP WITH CSP SADDLE CONNECTION

INSTALL 18.0x8.0x600 THICK RIPRAP SUBCUT INTO BANK  
INSTALL SILT FENCING AS DIRECTED BY CONTRACT ADMINISTRATOR



**METRIC**  
WHOLE NUMBERS INDICATE MILLIMETRES  
DECIMALIZED NUMBERS INDICATE METRES

**PROPERTY LIMITS DELINEATION**  
DELINEATION OF PROPERTY LIMITS AS SHOWN ON THIS DWG DOES NOT REPRESENT A "LEGAL SURVEY". KGS GROUP MAKES NO REPRESENTATION OR WARRANTY AS TO THE ACCURACY OF PROPERTY LIMITS DELINEATED ON THIS DWG, NOR ON THE DIMENSIONAL ACCURACY OF DWG FEATURES RELATIVE TO THOSE PROPERTY LIMITS.

**WARNING**  
IF POWER EQUIPMENT OR EXPLOSIVES ARE TO BE USED FOR EXCAVATION ON THIS PROJECT THE CONTRACTOR MUST:  
1) NOTIFY THE GAS COMPANY OF THE PROPOSED LOCATION OF EXCAVATION.  
2) TAKE PRECAUTION TO AVOID DAMAGE TO GAS COMPANY INSTALLATIONS.  
SEE PROVINCIAL REGULATION 21072 FOR DETAILS

**LOCATION APPROVED UNDERGROUND STRUCTURES**  
SUPV. U/G STRUCTURES COMMITTEE DATE  
NOTE:  
LOCATION OF UNDERGROUND STRUCTURES AS SHOWN ARE BASED ON THE BEST INFORMATION AVAILABLE BUT NO GUARANTEE IS GIVEN THAT ALL EXISTING UTILITIES ARE SHOWN OR THAT THE GIVEN LOCATIONS ARE EXACT. CONFIRMATION OF EXISTENCE AND EXACT LOCATION OF ALL SERVICES MUST BE OBTAINED FROM THE INDIVIDUAL UTILITIES BEFORE PROCEEDING WITH CONSTRUCTION.

B.M.	ELEV.	ISSUED FOR TENDER	DATE	BY
0			2019 11 15	RBO
		REVISIONS	DATE	BY

DESIGNED BY	NGV	CHECKED BY	RBo
DRAWN BY	GEL	APPROVED BY	RBo
SCALE:		RELEASED FOR CONSTRUCTION	
HORIZONTAL	1:250		
VERTICAL	1:50		
DATE	2019 11 14	DATE	NOV 14/19

**KGS GROUP**  
ENGINEERS  
GEOLOGISTS  
MANITOBA  
Certificate of Authorization  
KGS Group  
No. 245

ENGINEER'S SEAL  
**R.B. OFFMAN**  
Member 24701  
REGISTERED PROFESSIONAL ENGINEER  
CONSULTANT DRAWING NUMBER  
LD-9567

**THE CITY OF WINNIPEG**  
WATER AND WASTE DEPARTMENT  
ENGINEERING DIVISION  
2019 OUTFALL RENEWAL REHABILITATION PROGRAM  
**LODGE AVENUE OUTFALL**  
PLAN AND PROFILE  
S-MA20003886  
SHEET 3 OF 7  
CITY DRAWING NUMBER  
LD-9567