

- CONSTRUCTION NOTES:**
1. ALL WORK AND MATERIALS TO BE IN ACCORDANCE WITH LATEST REVISION OF THE CITY OF WINNIPEG STANDARD CONSTRUCTION SPECIFICATIONS.
  2. LEGAL PLAN AND UNDERGROUND INFORMATION FROM CITY OF WINNIPEG LBIS. CONTRACTOR TO VERIFY ALL UNDERGROUNDS IN THE FIELD.
  3. CONTRACTOR TO TAKE PRECAUTIONARY STEPS TO AVOID DAMAGE FROM CONSTRUCTION ACTIVITIES TO TREES WITHIN THE LIMITS OF CONSTRUCTION.
  4. LOCATION OF EXISTING SERVICES TO BE CONFIRMED IN THE FIELD BY THE CONTRACTOR.
  5. HYDRO POLES AND ANCHORS THAT REQUIRE TEMPORARY SUPPORT, REMOVAL OR REPLACEMENT, TO BE DONE SO AT THE EXPENSE OF THE CONTRACTOR, AS NECESSARY.
  6. CONTRACTOR TO TAKE PRECAUTIONARY STEPS WHEN WORKING IN PROXIMITY TO THE TRANSCANADA PIPELINE. CONTRACTOR IS RESPONSIBLE TO FOLLOW ALL TRANSCANADA PIPELINE REQUIREMENTS INCLUDING SAFETY WATCH AS REQUIRED.
  7. LIMITS OF WORK FOR CLEARING AND GRUBBING, ROESTORATION OF APPROACHES, AND LANDSCAPING AS DIRECTED BY THE CONTRACT ADMINISTRATOR.

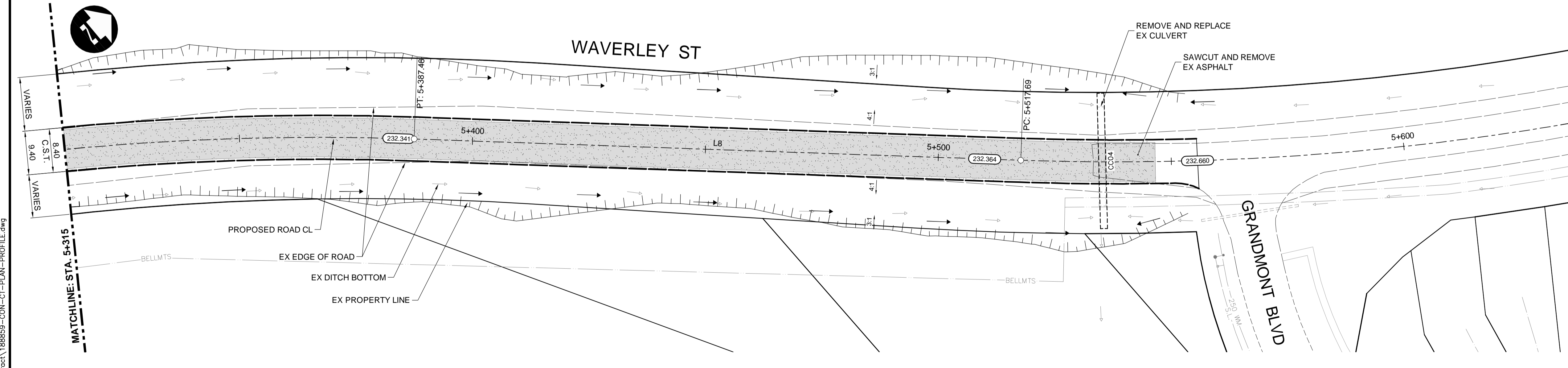

**METRIC**  
WHOLE NUMBERS INDICATE MILLIMETRES  
DECIMALIZED NUMBERS INDICATE METRES

- WARNING**
- IF POWER EQUIPMENT OR EXPLOSIVES ARE TO BE USED FOR EXCAVATION ON THIS PROJECT THE CONTRACTOR MUST:
1. NOTIFY THE GAS COMPANY OF THE PROPOSED LOCATION OF EXCAVATION.
  2. TAKE PRECAUTION TO AVOID DAMAGE TO GAS COMPANY INSTALLATIONS SEE PROVINCIAL REGULATION 210/72 FOR DETAILS.
  3. OBTAIN EXCAVATION PERMITS PRIOR TO CONSTRUCTION.



**PRELIMINARY ONLY  
NOT FOR CONSTRUCTION**

HYDRANT	CONCRETE	WATERMAIN	150 WWS
VALVE	C.S.T.	LAND DRAINAGE SEWER	300 LDS
MANHOLE	SIDEWALK	WASTE WATER SEWER	250 WWS
CATCH BASIN	PROPERTY LINE	HYDRANT	
CATCH PIT	ELEVATION	VALVE	
150 WM	HYDRO POLE	PROFILE	
300 LDS	SURVEY BAR	NORTH/WEST GUTTER	
250 WWS	BELLMTS PEDESTAL	SOUTH/EAST GUTTER	
HYDRO	DITCH ARROWS	NORTH/WEST DITCH	
BELLMTS	SWALE ARROWS	SOUTH/EAST DITCH	
100 GAS			
EXISTING	LEGEND-PLAN	PROPOSED	EXISTING
	LEGEND-PROFILE	PROPOSED	EXISTING

**UNDERGROUND STRUCTURES**

SUPPLY U/G STRUCTURES DATE

B.M. ELEV.			
DESIGNED BY	RTP		
DRAWN BY	TJH		
CHECKED BY	TS		
APPROVED BY	BC		
HOR. SCALE	1:500		
VERTICAL	1:20		
ISSUED FOR TENDER	19/05/28	BC	
NO. REVISIONS			

LOCATION OF UNDERGROUND STRUCTURES AS SHOWN ARE BASED ON THE BEST INFORMATION AVAILABLE, BUT NO GUARANTEE IS GIVEN THAT ALL EXISTING UTILITIES ARE SHOWN OR THAT THE GIVEN LOCATIONS ARE EXACT. CONFIRMATION OF EXISTENCE AND EXACT LOCATION OF ALL SERVICES MUST BE OBTAINED FROM THE INDIVIDUAL UTILITIES BEFORE PROCEEDING WITH CONSTRUCTION.

**DILLON CONSULTING**

DESIGNED BY: RTP  
DRAWN BY: TJH  
CHECKED BY: TS  
APPROVED BY: BC

HOR. SCALE: 1:500  
VERTICAL: 1:20

RELEASED FOR CONSTRUCTION

ENGINEER'S SEAL

PROVINCE OF MANITOBA  
REGISTERED PROFESSIONAL ENGINEER  
S.B. COOK  
2019/05/28

CONSULTANT PROJECT NUMBER  
**18-8859**

**THE CITY OF WINNIPEG**  
PUBLIC WORKS DEPARTMENT

2019 GRANULAR ROAD PROGRAM  
WAVERLEY STREET  
(GRANDMONT BOULEVARD TO CITY LIMIT)

WAVERLEY STREET - PLAN-PROFILE  
(STA. 5+315 TO END)

CITY DRAWING NUMBER: P-3506-2019-15  
SHEET 15 OF 18  
CONSULTANT DRAWING NUMBER

G:\CAD\188959\Drawings\Roadworks\Contract\188959-COIN-CT-PLAN-PROFILE.dwg