

TYPICAL CROSS SECTION
N.T.S.

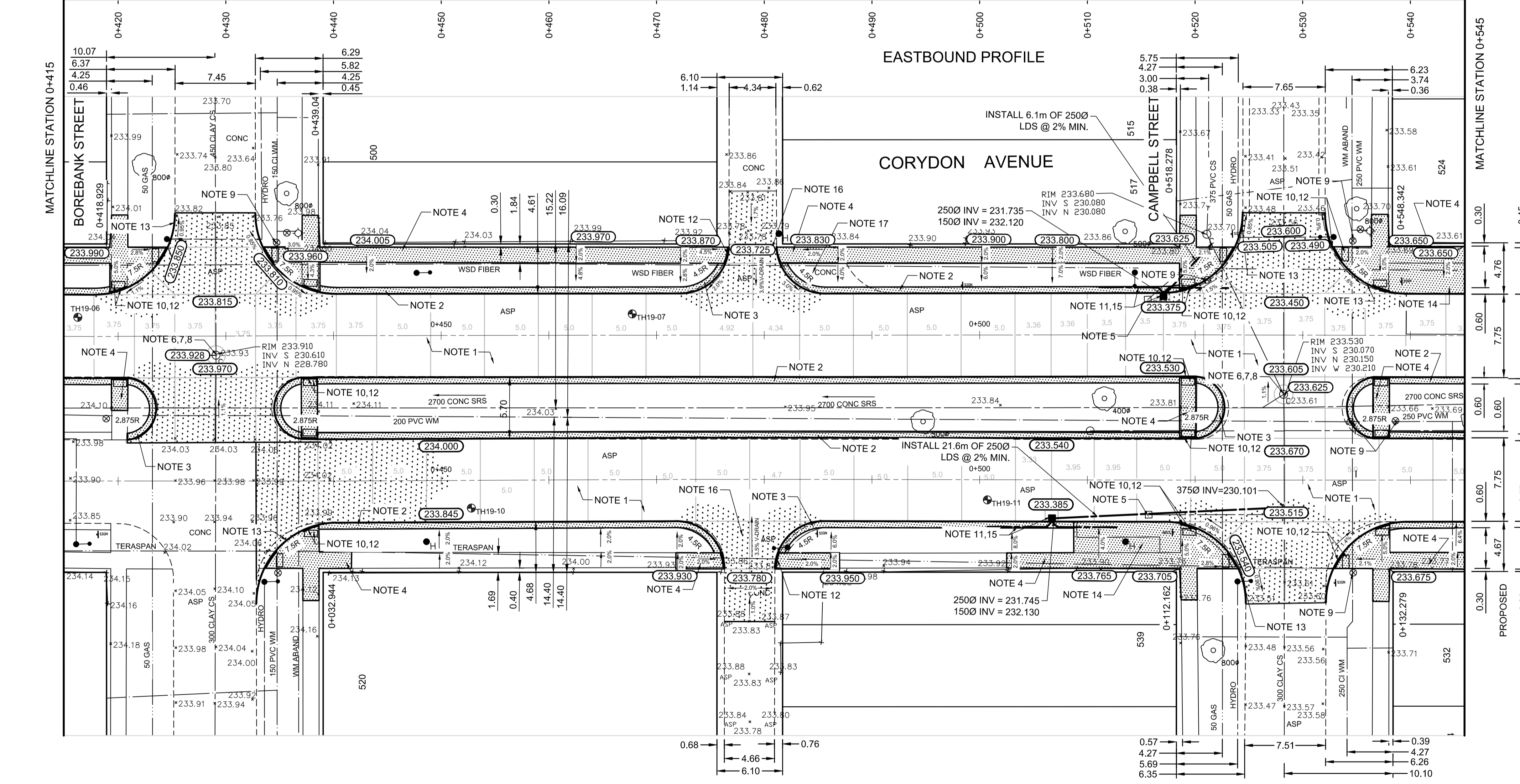

- REFERENCE NOTES:**
- PAVEMENT DIMENSIONS ARE TO BACK OF CURB
 - BASELINE IS CENTRE LINE ROADWAY
 - PROPERTY LINES OBTAINED FROM CITY OF WINNIPEG L.B.I.S., AND NO SCALE FACTOR WAS APPLIED
 - REFER TO AECOM FIELD BOOK NO. 5031
- CONSTRUCTION NOTES:**
- REMOVE EXISTING PAVEMENT AND CONSTRUCT NEW 230mm PLAIN DOWELED CONCRETE PAVEMENT
 - CONSTRUCT NEW MONOLITHIC CONCRETE SPLASH STRIP (180mm HT SEPARATE)
 - CONSTRUCT NEW MODIFIED MONOLITHIC CONCRETE SPLASH STRIP (180mm HT, SEPARATE)
 - RENEW EXISTING 100mm CONCRETE SIDEWALK
 - REMOVE EXISTING CATCHBASIN/CATCHPIT AND PLUG EXISTING LEAD
 - ADJUST EXISTING CATCH BASIN/MANHOLE TO GRADE
 - REMOVE EXISTING FRAME AND COVER AND PLACE NEW FRAME AND COVER (AP-006/AP-007)
 - INSTALL NEW CAST IRON RISER RING
 - ADJUST EXISTING WATERMAIN VALVE BOX TO GRADE
 - INSTALL NEW DETECTABLE SURFACE WARNING TILES
 - INSTALL NEW CURB AND GUTTER INLET c/w CATCHBASIN (SD-024) AND CONNECT NEW 250mm LEAD TO EXISTING 300 CLAY COMBINED SEWER
 - CONSTRUCT NEW CURB RAMP (10-12mm REVEAL HT. INTEGRAL)
 - CONSTRUCT NEW MODIFIED BARRIER CURB (180mm HT. INTEGRAL)
 - CONSTRUCT NEW 100mm CONCRETE BUSPAD
 - INSTALL 150mm SUBDRAIN 6m ON EACH SIDE OF CATCHBASIN
 - REMOVE EXISTING PAVEMENT AND CONSTRUCT NEW 200mm REINFORCED CONCRETE PAVEMENT
 - REMOVE EXISTING CONCRETE APPROACH

**ENGINEERS
GEOLOGISTS
MANITOBA**

Certificate of Authorization
AECOM Canada Ltd.
No. 4671 Date: _____

**PRELIMINARY
NOT FOR CONSTRUCTION**

METRIC
WHOLE NUMBERS INDICATE MILLIMETRES
DECIMALIZED NUMBERS INDICATE METRES

EXISTING	LEGEND - PLAN	PROPOSED	EXISTING	LEGEND - PLAN	PROPOSED	EXISTING	LEGEND - PROFILE	PROPOSED
	WATERMAIN HYDRANT			HYDRO M.T.S.			NORTH GUTTER	
	VALVE			CONCRETE			NORTH MEDIAN GUTTER	
	LAND DRAINAGE SEWER			ASPHALT			N PROPERTY LINE	
	WASTEWATER SEWER			PROPERTY LINE			SOUTH GUTTER	
	MANHOLE			SURVEY BAR			SOUTH MEDIAN GUTTER	
	CATCH BASIN			ELEVATION			S PROPERTY LINE	
	CATCH PIT			TREE				
	JUNCTIONS			SIDEWALK RAMP				
	CULVERT			CONCRETE SIDEWALK				
	GAS			FENCE				

LOCATION APPROVED UNDERGROUND STRUCTURES

SUPV. U/G STRUCTURES COMMITTEE DATE _____

NOTE:
LOCATION OF UNDERGROUND STRUCTURES AS SHOWN ARE BASED ON THE BEST INFORMATION AVAILABLE. BUT NO GUARANTEE IS GIVEN THAT ALL EXISTING UTILITIES ARE SHOWN OR THAT THE GIVEN LOCATIONS ARE EXACT. LOCATION OF ALL SERVICES MUST BE OBTAINED FROM THE INDIVIDUAL UTILITIES BEFORE PROCEEDING WITH CONSTRUCTION.

B.M. 23 - N W COR. JOHN BREBUIF & RENFEW ST. ELEV. TBLT. IN E. CONC. FOUNDATION OF NO.1707 ST. JOHN BREBUIF SCHOOL. 1.5m N. & 0.2m BELOW BRICK OF S.E. COR. OF SCHOOL. ELEVATION: 233.864

AECOM

DESIGNED BY	JT	CHECKED BY	RC/KWR
DRAWN BY	JT	APPROVED BY	
HOR. SCALE:	1:250	ORIGINAL SIGNED BY:	
VERTICAL:	1:10	DATE	04/09/2019

ENGINEER'S SEAL
R. T. CUNNINGHAM
Member 24711
REGISTERED PROFESSIONAL ENGINEER

THE CITY OF WINNIPEG
PUBLIC WORKS DEPARTMENT
ENGINEERING DIVISION

2019 REGIONAL STREET RENEWAL PROGRAM

CORDYON AVENUE WESTBOUND - LANARK STREET TO CORDOVA STREET
CORDYON AVENUE EASTBOUND - BOREBANK STREET TO BROCK STREET

CONCRETE PAVEMENT RECONSTRUCTION
STATION 0+440 TO STATION 0+560

CITY DRAWING NUMBER P-3507-05
SHEET 05 OF 08

CONSULTANT DRAWING NO. CT-05