

100 ASPHALT (TYPE 1A)
75 BASE COURSE MATERIAL
300 CRUSHED SUB BASE MATERIAL
(MAX. SIZE 50mm)
NON WOVEN GEOTEXTILE

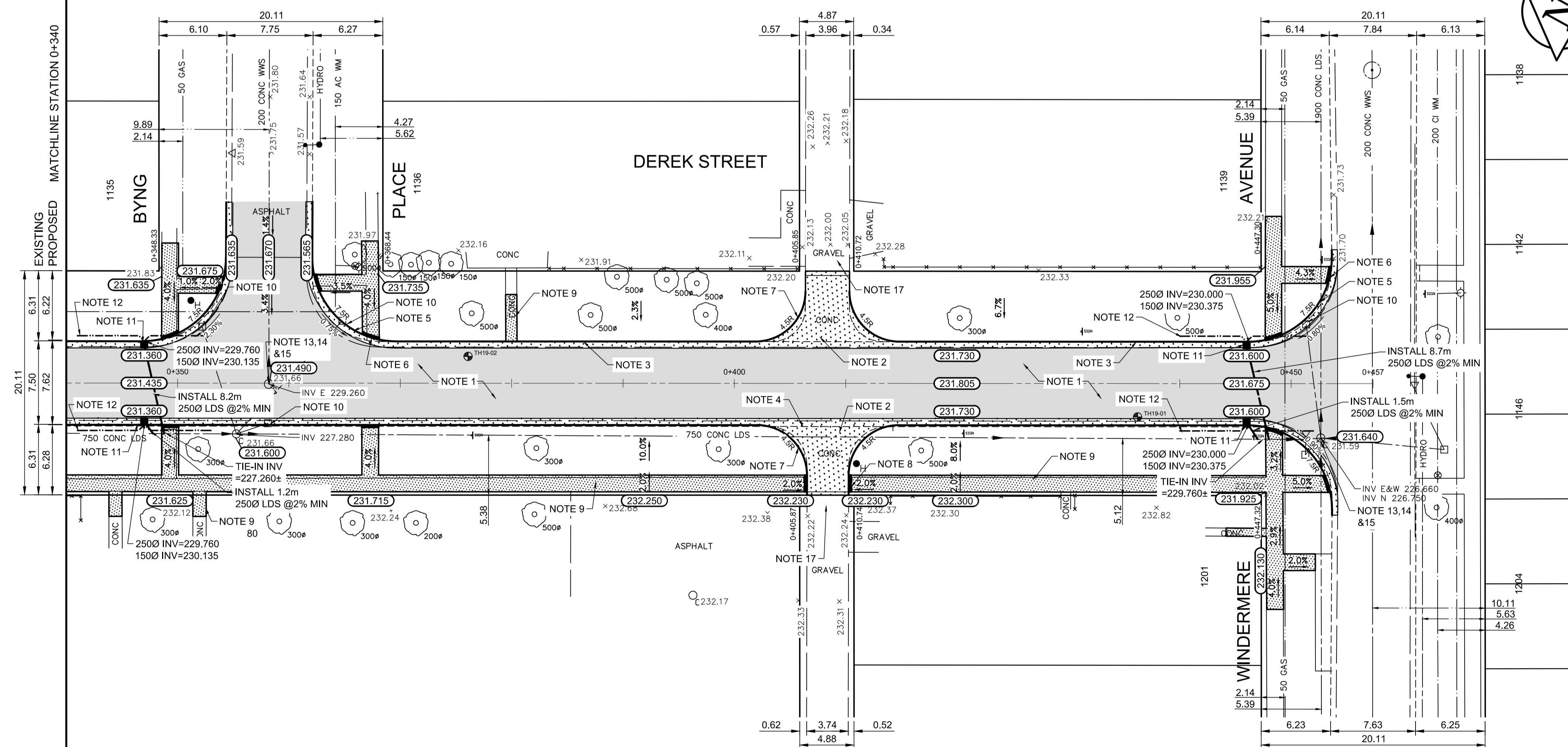

- REFERENCE NOTES**
- PAVEMENT DIMENSIONS ARE TO BACK OF CURB
 - BASELINE IS CENTRE LINE RIGHT-OF-WAY
 - PROPERTY LINES OBTAINED FROM CITY OF WINNIPEG L.B.I.S., AND NO SCALE FACTOR WAS APPLIED
 - REFER TO AECOM FIELD BOOK NO. 5033

- CONSTRUCTION NOTES**
- REMOVE EXISTING CONCRETE AND ASPHALTIC PAVEMENT AND CONSTRUCT NEW ASPHALTIC PAVEMENT TYPE 1A (100mm)
 - REMOVE EXISTING CONCRETE PAVEMENT AND CONSTRUCT NEW 150mm REINFORCED CONCRETE PAVEMENT
 - CONSTRUCT NEW BARRIER CURB AND GUTTER (600mm WIDTH, 180mm HT.)
 - CONSTRUCT NEW LIP CURB AND GUTTER (40mm HT. INTEGRAL)
 - CONSTRUCT NEW MODIFIED BARRIER CURB AND GUTTER (600mm WIDTH, 180mm HT.)
 - CONSTRUCT NEW CURB RAMP CURB AND GUTTER (10mm HT. INTEGRAL)
 - CONSTRUCT NEW MODIFIED BARRIER CURB (180mm HT. INTEGRAL)
 - CONSTRUCT NEW CURB RAMP (10mm HT. INTEGRAL)
 - RENEW EXISTING 100mm CONCRETE SIDEWALK
 - REMOVE EXISTING CATCHBASIN AND ABANDON LEAD
 - INSTALL NEW CURB AND GUTTER INLET c/w CATCHBASIN 1800mm (SD-024) AND CONNECT TO EXISTING MANHOLE
 - INSTALL 150mm SUBDRAIN
 - ADJUST EXISTING MANHOLE/CATCHBASIN TO GRADE
 - REMOVE EXISTING FRAME AND COVER AND INSTALL NEW FRAME AND SOLID COVER (AP-006 AND AP-007)
 - INSTALL NEW CAST IRON RISER RING
 - ADJUST EXISTING WATER VALVE TO GRADE
 - REGRADE EXISTING GRAVEL

AECOM
Certificate of Authorization
AECOM Canada Ltd.
No. 4671 Date: _____

METRIC
WHOLE NUMBERS INDICATE MILLIMETRES
DECIMALIZED NUMBERS INDICATE METRES

150 mm W.M.	WATERMAIN	150 mm W.M.	HYDRO	— x —	Q PROFILE
150 mm W.M.	HYDRANT	150 mm W.M.	M.T.S.	— x —	WEST GUTTER
300mm L.D.S.	VALVE	300mm L.D.S.	CONCRETE	— x —	EAST GUTTER
300mm L.D.S.	LAND DRAINAGE SEWER	300mm L.D.S.	ASPHALT	— x —	N/W PROPERTY LINE
250mm W.W.S.	WASTEWATER SEWER	250mm W.W.S.	PROPERTY LINE	— x —	S/E PROPERTY LINE
300mm	MANHOLE	300mm	SURVEY BAR	— x —	
300mm	CATCH BASIN	300mm	ELEVATION (235.750)	— x —	
300mm	CATCH PIT	300mm	TREE	— x —	
300mm	JUNCTIONS	300mm	SIDEWALK RAMP	— x —	
300mm	CULVERT	300mm	CONCRETE SIDEWALK	— x —	
300mm	GAS	300mm	FENCE	— x —	
EXISTING	LEGEND - PLAN	PROPOSED	EXISTING	LEGEND - PLAN	PROPOSED
EXISTING	LEGEND - PROFILE	PROPOSED	EXISTING	LEGEND - PROFILE	PROPOSED

LOCATION APPROVED UNDERGROUND STRUCTURES

SUPV. U/G STRUCTURES COMMITTEE DATE

NOTE:
LOCATION OF UNDERGROUND STRUCTURES AS SHOWN ARE BASED ON THE BEST INFORMATION AVAILABLE. BUT NO GUARANTEE IS GIVEN THAT ALL EXISTING UTILITIES ARE SHOWN OR THAT THE GIVEN LOCATIONS ARE EXACT. CONFIRMATION OF EXISTENCE AND EXACT LOCATION OF ALL SERVICES MUST BE OBTAINED FROM THE INDIVIDUAL UTILITIES BEFORE PROCEEDING WITH CONSTRUCTION.

B.M.	65-016	N. side Windermere Ave., E. of Daniel st., Tblt. in
ELEV.	233.024	S Conc. foundation of No. 1229 Windermere Ave. (Berean Pentecostal Church), 7.0m W. & 0.3m below brick of S.E. Cor of Church.
NO.	REVISIONS	DATE BY
0	ISSUED FOR TENDER	05/02/2019 KWR
A	ISSUED FOR REVIEW	03/15/2019 BC

AECOM	
DESIGNED BY	SS
CHECKED BY	BC/KWR
DRAWN BY	SS
APPROVED BY	
HOR. SCALE:	1:250
VERTICAL:	1:10
RELEASED FOR CONSTRUCTION BY:	
DATE	

ENGINEER'S SEAL
PROVINCE OF MANITOBA
K.W. RAE
REGISTERED PROFESSIONAL ENGINEER

THE CITY OF WINNIPEG
PUBLIC WORKS DEPARTMENT
ENGINEERING DIVISION

2019 LOCAL STREET RENEWAL PROGRAM

DEREK STREET - PARKER AVENUE TO WINDERMERE AVENUE
PAVEMENT RECONSTRUCTION
STATION 0+340 TO WINDERMERE AVENUE

CITY DRAWING NUMBER
SHEET 03 OF 17

CONSULTANT DRAWING NO. CT-03