

**WATER SERVICE INFORMATION**

ADDRESS	SIZE (mm) MATERIAL (STREET)	SIZE (mm) MATERIAL (PROP.)	SHORT & LONG MEASUREMENT	CORP. LOCATION	REMARKS
967 ST MARY'S RD COMMERCIAL	-	-	-	-	RENEW TO R W/20 CU
964 ST MARY'S RD COMMERCIAL	-	-	2.54 NSL BLDG	-	RECONNECT SERVICE WY'D W/962
962 ST MARY'S RD COMMERCIAL	-	-	42.398 SSL ST VITAL RD	-	RECONNECT SERVICE WY'D W/964
960 ST MARY'S RD COMMERCIAL	-	-	42.398 SSL ST VITAL RD	-	RECONNECT SERVICE
958 ST MARY'S RD COMMERCIAL	-	-	-	-	-
956 ST MARY'S RD COMMERCIAL	25	25	2.35 NSL BLDG	-	RECONNECT SERVICE
955 ST MARY'S RD COMMERCIAL	CU	CU	25.211 SSL ST VITAL RD	-	RECONNECT SERVICE
954 ST MARY'S RD COMMERCIAL	-	-	-	-	RECONNECT SERVICE
953 ST MARY'S RD COMMERCIAL	20	20	14.30 EWL BLDG	-	RECONNECT SERVICE
952 ST MARY'S RD COMMERCIAL	CU	CU	14.303 EEL ST MARY'S RD	-	RECONNECT SERVICE
948 ST MARY'S RD COMMERCIAL	25	25	3.98 NSL BLDG	-	OUTSIDE LIMITS VALVE IN BACK LANE
946 ST MARY'S RD COMMERCIAL	25	25	5.872 SSL ST VITAL RD	-	OUTSIDE LIMITS VALVE IN BACK LANE
942 ST MARY'S RD COMMERCIAL	25	25	2.92 SNL BLDG	-	RECONNECT SERVICE
942/942A/942B ST MARY'S RD COMMERCIAL	CU	CU	16.576>NNL ST VITAL RD	-	RECONNECT SERVICE
			25.474>NNL ST VITAL RD	-	RECONNECT SERVICE
			3.62 SNL BLDG	-	RECONNECT SERVICE
			45.122>NNL ST VITAL RD	-	RECONNECT SERVICE

\* SERVICES TO BE RENEWED TO R. ALL OTHERS TO BE RECONNECTED

NOTE: CHAINAGES SHOWN ARE ALONG E. R. OF ST MARY'S ROAD

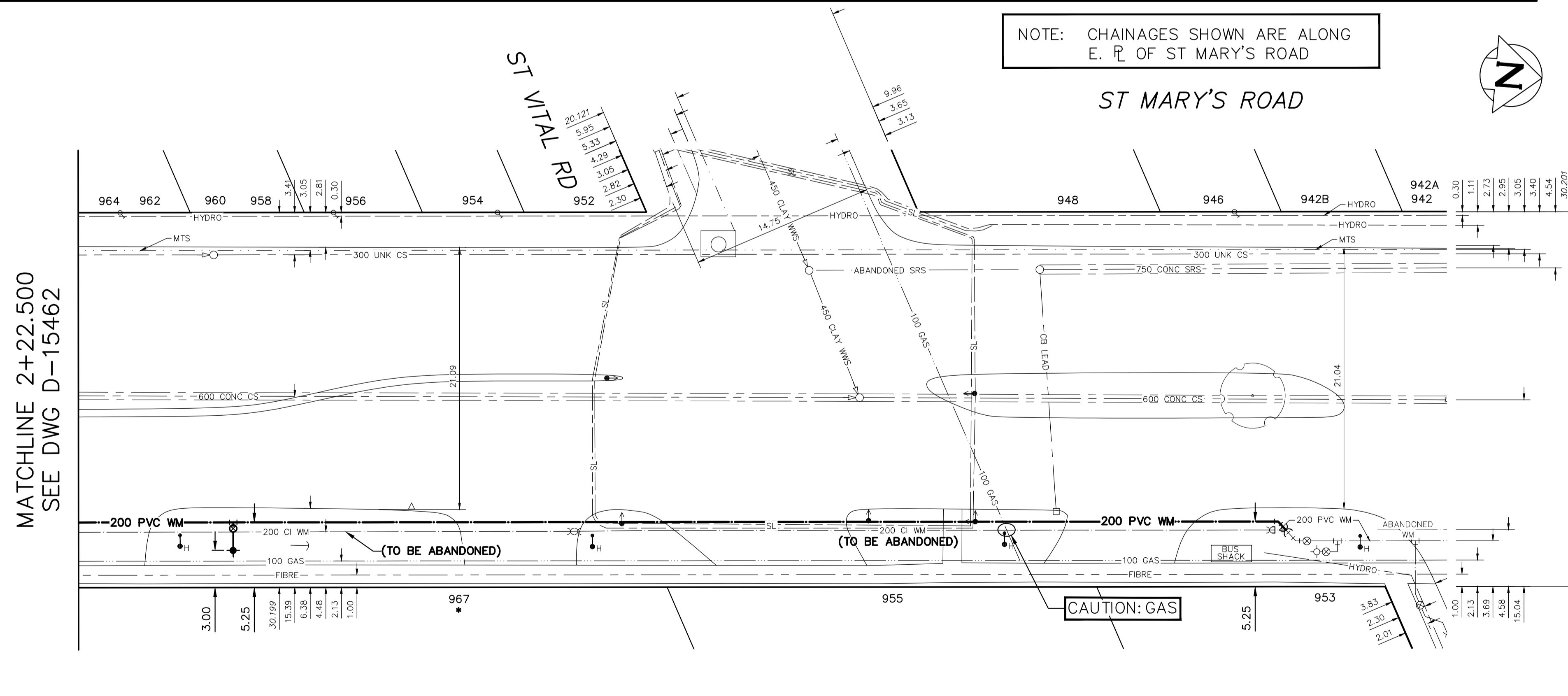
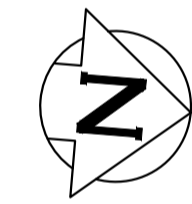

MATCHLINE 2+22.500 SEE DWG D-15462

POPLARWOOD AVENUE

FOR INDEX SEE D-15456

NOTE: ALL VALVES TO BE INSTALLED CLOCKWISE TO CLOSE

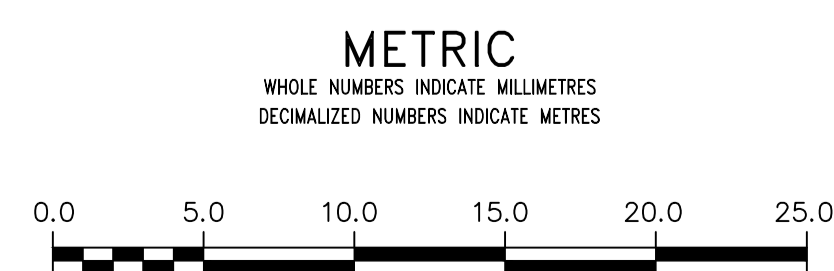

**WARNING**  
IF POWER EQUIPMENT OR EXPLOSIVES ARE TO BE USED FOR EXCAVATION ON THIS PROJECT THE CONTRACTOR MUST:  
1) NOTIFY THE GAS COMPANY OF THE PROPOSED LOCATION OF EXCAVATION.  
2) TAKE PRECAUTION TO AVOID DAMAGE TO GAS COMPANY INSTALLATIONS.  
SEE PROVINCIAL REGULATION 210/72 FOR DETAILS

**LOCATION APPROVED**  
UNDERGROUND STRUCTURES  
SUPV. U/G STRUCTURES COMMITTEE DATE  
NOTE:  
LOCATION OF UNDERGROUND STRUCTURES AS SHOWN ARE BASED ON THE BEST INFORMATION AVAILABLE BUT NO GUARANTEE IS GIVEN THAT ALL EXISTING UTILITIES ARE SHOWN OR THAT THE GIVEN LOCATIONS ARE EXACT. CONFIRMATION OF EXISTENCE AND EXACT LOCATION OF ALL SERVICES MUST BE OBTAINED FROM THE INDIVIDUAL UTILITIES BEFORE PROCEEDING WITH CONSTRUCTION.

B.M. ELEV.	NO.	REVISIONS	DATE	BY

DESIGNED BY	TGS	CHECKED BY	SC
DRAWN BY	BL	APPROVED BY	KZ
SCALE:		RELEASED FOR CONSTRUCTION	
HORIZONTAL	1:250	KAS ZUREK	2019-05-13
VERTICAL	1:50		
DATE	2019 05 14	DATE	2019-05-13

ENGINEER'S SEAL  
ORIGINAL SIGNED BY  
S.R.J. COURNOYER  
19/05/13  
CONSULTANT DRAWING NUMBER

**THE CITY OF WINNIPEG**  
WATER AND WASTE DEPARTMENT  
ENGINEERING DIVISION  
2019 WATER MAIN RENEWALS  
CONTRACT 3  
ST MARY'S ROAD  
6 N OF BERRYDALE AVENUE TO  
POPLARWOOD AVENUE  
SHEET 9 OF 14  
CITY DRAWING NUMBER  
D-15463