

NOTE: CHAINAGES SHOWN ARE ALONG S. R. OF WALLER AVENUE

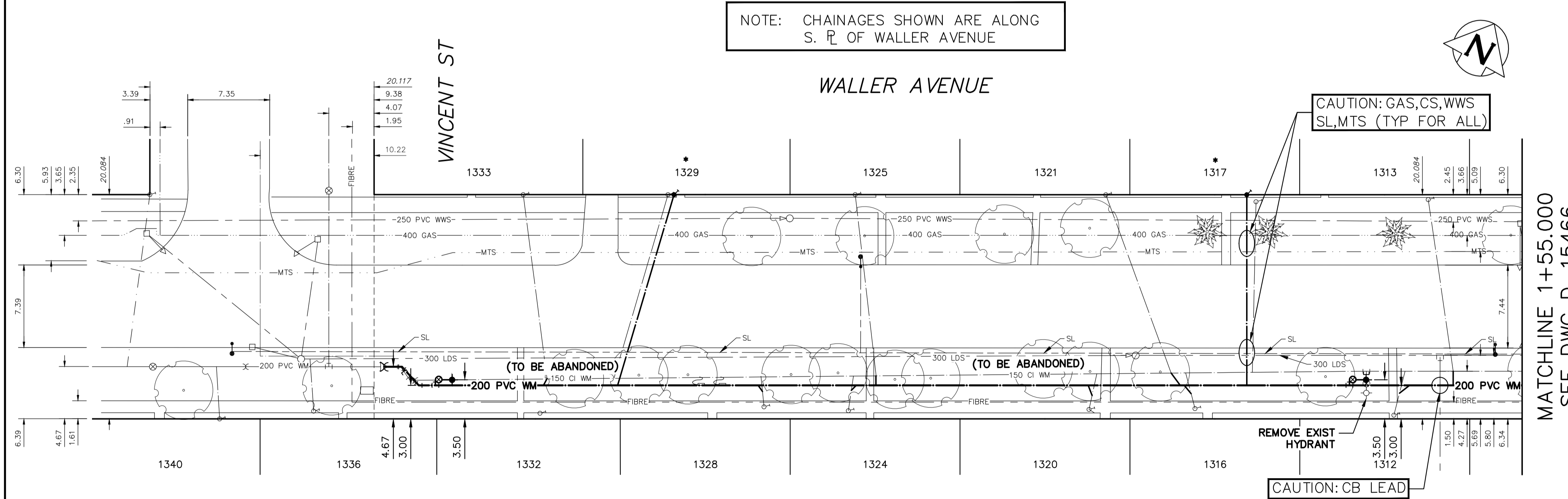

MATCHLINE 1+55.000
SEE DWG D-15466

WATER SERVICE INFORMATION

| ADDRESS | SIZE (mm) MATERIAL (STREET) | SIZE (mm) MATERIAL (PROP.) | SHORT & LONG MEASUREMENT | CORP. LOCATION | REMARKS |
|----------------------------|-----------------------------|----------------------------|--|----------------|--|
| 1340 WALLER ST RESIDENTIAL | 20 CU | 20 CU | 1.63 WEL HSE 13.865 EEL VINCENT AVE | 0.3 W OF S/C | OUTSIDE RENEWAL LIMITS |
| 1336 WALLER ST RESIDENTIAL | 20 CU | - | 2.31 EWL HSE 6.338 EEL VINCENT AVE | 0.3 W OF S/C | OUTSIDE RENEWAL LIMITS |
| 1333 WALLER ST RESIDENTIAL | 20 CU | 20 CU | 3.03 WEL HSE 13.435 EEL VINCENT AVE | 3.1 E OF S/C | RECONNECT SERVICE |
| 1332 WALLER ST COMMERCIAL | - | 20 CU | 6.26 EWL HSE 14.874 EEL VINCENT AVE | - | RECONNECT SERVICE |
| 1329 WALLER ST RESIDENTIAL | 20 CU | 20 CU | 4.23 EWL HSE 26.388 EEL VINCENT AVE | 4.7 W OF S/C | RENEW TO R W/20 CU PREVIOUS FROZEN SERVICE |
| 1328 WALLER ST RESIDENTIAL | 20 CU | - | OPP EL HSE 34.934 EEL VINCENT AVE | 0.3 W OF S/C | RECONNECT SERVICE |
| 1325 WALLER ST RESIDENTIAL | 20 CU | - | 3.04 EWL HSE 43.185 EEL VINCENT AVE | 1.9 E OF S/C | RECONNECT SERVICE |
| 1324 WALLER ST RESIDENTIAL | 20 CU | - | 8.13 WEL HSE 42.600 EEL VINCENT AVE | 0.5 E OF S/C | RECONNECT SERVICE |
| 1321 WALLER ST RESIDENTIAL | 20 CU | - | OPP EL HSE 65.635 EEL VINCENT AVE | 5.8 E OF S/C | RECONNECT SERVICE |
| 1320 WALLER ST RESIDENTIAL | 20 CU | - | 0.82 WEL HSE 64.151 EEL VINCENT AVE | 0.7 E OF S/C | RECONNECT SERVICE |
| 1317 WALLER ST COMMERCIAL | 12 CU | - | 8.59 EWL HSE 79.094 EEL VINCENT AVE | 0.3 E OF S/C | RENEW TO R W/20 CU PREVIOUS FROZEN SERVICE |
| 1316 WALLER ST RESIDENTIAL | 20 CU | - | 7.25 WEL HSE 73.697 EEL VINCENT AVE | 0.9 W OF S/C | RECONNECT SERVICE |
| 1313 WALLER ST RESIDENTIAL | 20 CU | - | 1.32 WEL HSE 94.580 EEL VINCENT AVE | 2.3 E OF S/C | RECONNECT SERVICE |
| 1312 WALLER ST RESIDENTIAL | 20 CU | - | 4.13 WEL HSE 91.522 EEL VINCENT AVE | 0.9 E OF S/C | RECONNECT SERVICE |

* SERVICES TO BE RENEWED TO R. ALL OTHERS TO BE RECONNECTED

NOTE: ALL VALVES TO BE INSTALL CLOCKWISE TO CLOSE

FOR INDEX SEE 15456

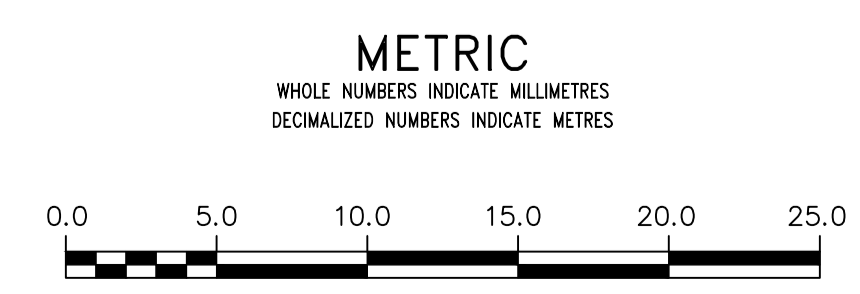

WARNING
IF POWER EQUIPMENT OR EXPLOSIVES ARE TO BE USED FOR EXCAVATION ON THIS PROJECT THE CONTRACTOR MUST:
1) NOTIFY THE GAS COMPANY OF THE PROPOSED LOCATION OF EXCAVATION.
2) TAKE PRECAUTION TO AVOID DAMAGE TO GAS COMPANY INSTALLATIONS.
SEE PROVINCIAL REGULATION 210/72 FOR DETAILS

LOCATION APPROVED UNDERGROUND STRUCTURES
SUPV. U/G STRUCTURES COMMITTEE DATE
NOTE:
LOCATION OF UNDERGROUND STRUCTURES AS SHOWN ARE BASED ON THE BEST INFORMATION AVAILABLE BUT NO GUARANTEE IS GIVEN THAT ALL EXISTING UTILITIES ARE SHOWN OR THAT THE GIVEN LOCATIONS ARE EXACT. CONFIRMATION OF EXISTENCE AND EXACT LOCATION OF ALL SERVICES MUST BE OBTAINED FROM THE INDIVIDUAL UTILITIES BEFORE PROCEEDING WITH CONSTRUCTION.

| NO. | REVISIONS | DATE | BY |
|-----|-----------|------|----|
| | | | |
| | | | |

| | | | |
|-------------|-----------------------------------|---------------------------|-------------------------|
| DESIGNED BY | TGS | CHECKED BY | SC |
| DRAWN BY | RS | APPROVED BY | KZ |
| SCALE: | HORIZONTAL 1:250 VERTICAL 1:50 | | |
| DATE | 2019 05 14 | RELEASED FOR CONSTRUCTION | KAS ZUREK 2019-05-13 |

ENGINEER'S SEAL
ORIGINAL SIGNED BY
S.R.J COURNOYER
19/05/13
CONSULTANT DRAWING NUMBER

THE CITY OF WINNIPEG
WATER AND WASTE DEPARTMENT
ENGINEERING DIVISION
2019 WATER MAIN RENEWALS
CONTRACT 3
WALLER AVENUE
VINCENT STREET TO
155 E OF VINCENT STREET

SHEET 11 OF 14
CITY DRAWING NUMBER
D-15465