

NOTE: CHAINAGES SHOWN ARE ALONG CENTRE LINE OF ROW

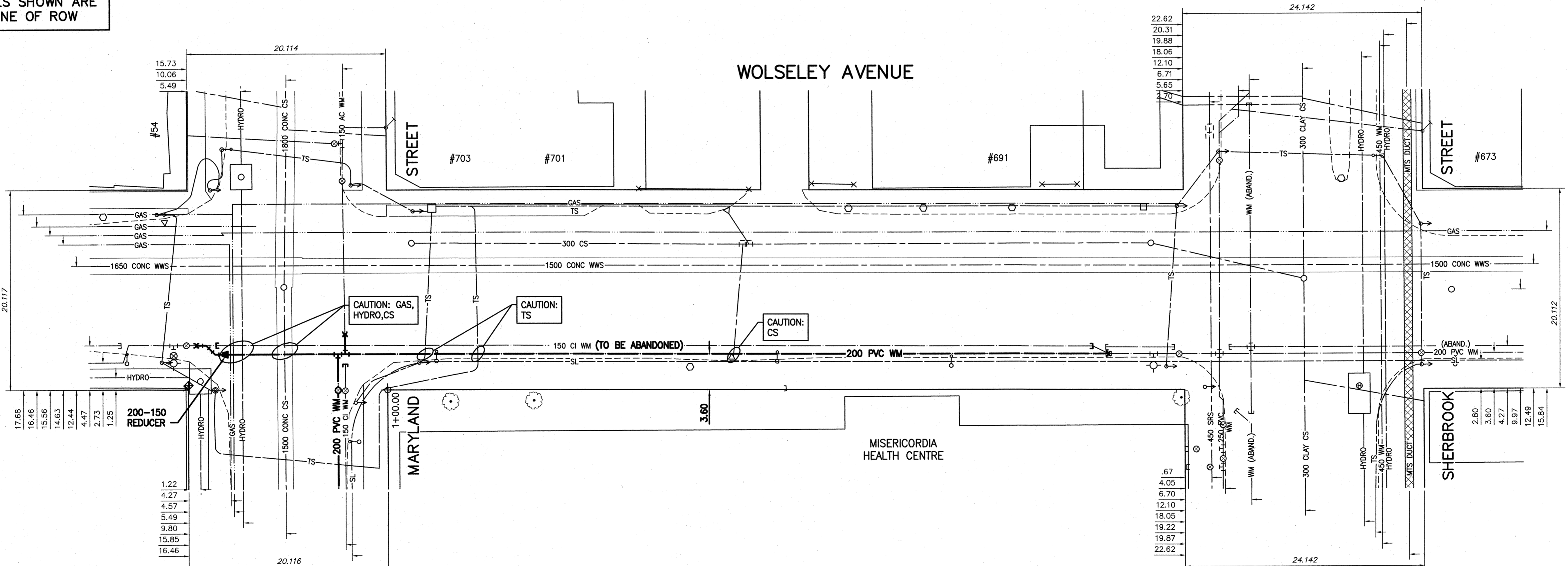

NOTE: VALVES TO BE INSTALLED COUNTERCLOCKWISE TO CLOSE

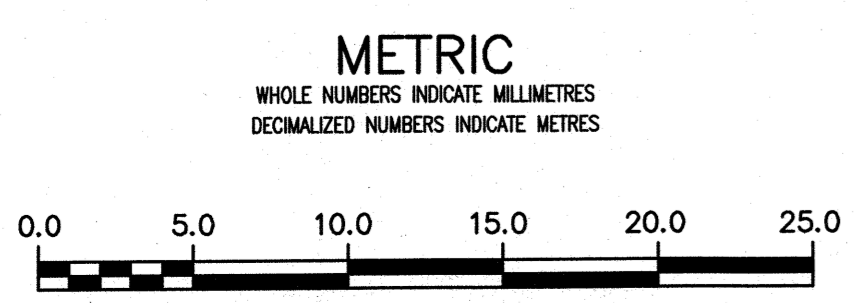

ENGINEERS GEOSCIENTISTS MANITOBA
 Certificate of Authorization
 Stantec Consulting Ltd.
 No. 1301

LOCATION APPROVED UNDERGROUND STRUCTURES		B.M. 37-56 ELEV. 231.218m	
SUPV. U/G STRUCTURES COMMITTEE	DATE	S. SIDE PALMERSTON AVE. S. OF WOLSELEY AVE. ON PRODUCTION OF CANADA ST. TRAIL ON TOP OF N.E. COR. OF SITE CHAMBER 0.2 M W. OF E. EDGE & 0.2 M S. OF NECK OF GATE CHAMBER.	
NOTE: LOCATION OF UNDERGROUND STRUCTURES AS SHOWN ARE BASED ON THE BEST INFORMATION AVAILABLE BUT NO GUARANTEE IS GIVEN THAT ALL EXISTING UTILITIES ARE SHOWN OR THAT THE GIVEN LOCATIONS ARE EXACT. CONFIRMATION OF EXISTENCE AND EXACT LOCATION OF ALL SERVICES MUST BE OBTAINED FROM THE INDIVIDUAL UTILITIES BEFORE PROCEEDING WITH CONSTRUCTION.			
NO.	ISSUED FOR	DATE	BY
02	ISSUED FOR TENDER	2019.04.02	RS
01	ISSUED FOR 30% REVIEW	2019.02.22	RS
REVISIONS			

Stantec

DESIGNED BY	RS	CHECKED BY	RS
DRAWN BY	SC	APPROVED BY	RS
SCALE:		RELEASED FOR CONSTRUCTION	
HORIZONTAL 1:250		DATE	
VERTICAL 1:50		2019.01.15	
PLOT DATE: 2019 04 01			

ENGINEER'S SEAL

PROVINCE OF MANITOBA
RAY SHEDDOCK
 REGISTERED PROFESSIONAL ENGINEER
 MEMBER 24045

CONSULTANT DRAWING NUMBER
 C-212

THE CITY OF WINNIPEG
 WATER AND WASTE DEPARTMENT
 ENGINEERING DIVISION

2019 WATERMAIN RENEWALS
 CONTRACT 5
WOLSELEY AVENUE
 MARYLAND ST. TO
 SHERBROOK ST.

SHEET 13 OF 17
 CITY DRAWING NUMBER
D-15439