

NOTE: CHAINAGES SHOWN ARE ALONG E R OF CLIFTON STREET

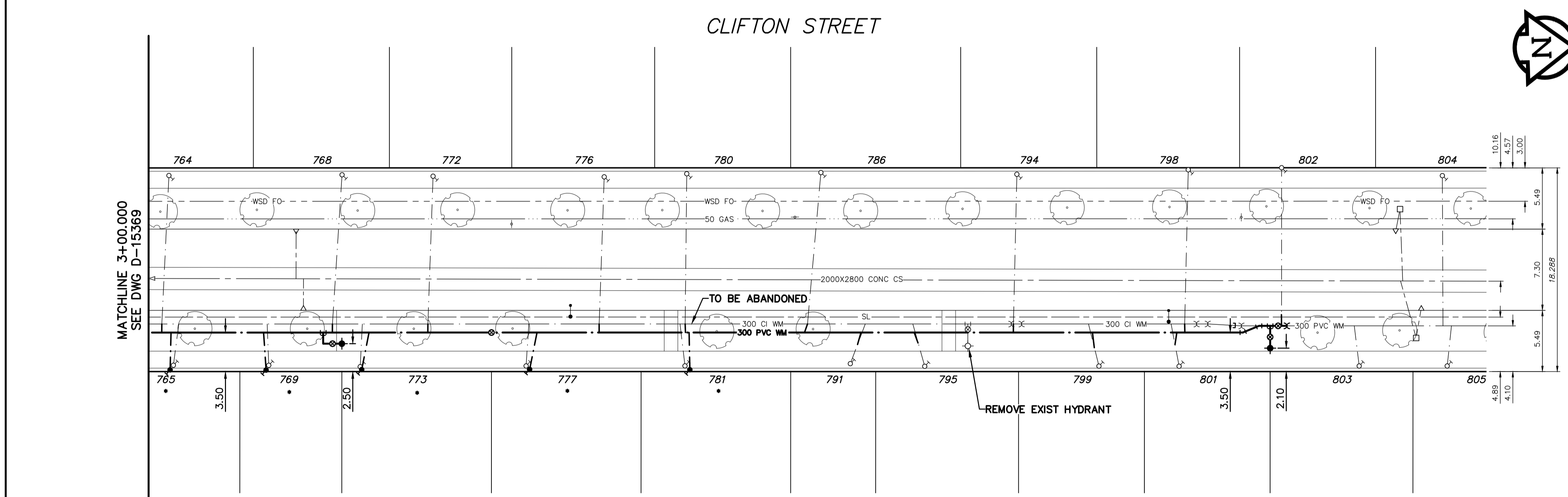

**WATER SERVICE INFORMATION**

ADDRESS	SIZE (mm) MATERIAL (STREET)	SIZE (mm) MATERIAL (PROP.)	SHORT & LONG MEASUREMENT	CORP. LOCATION	REMARKS
761 CLIFTON ST	20	20	5.18 NSHL	OPP CURB STOP	RENEW SERVICE TO PIL WITH 20 CU
764 CLIFTON ST	20	20	3.51 NSHL	OPP CURB STOP	RECONNECT SERVICE
765 CLIFTON ST	20	20	4.88 NSHL	0.30 N CURB STOP	RENEW SERVICE TO PIL WITH 20 CU
768 CLIFTON ST	20	20	1.22 NSHL	0.30 S CURB STOP	RECONNECT SERVICE
769 CLIFTON ST	20	20	0.76 NSHL	OPP CURB STOP	RENEW SERVICE TO PIL WITH 20 CU
772 CLIFTON ST	20	20	2.23 NSHL	OPP CURB STOP	RECONNECT SERVICE
773 CLIFTON ST	20	20	OPP SH	0.30 N CURB STOP	RENEW SERVICE TO PIL WITH 20 CU
776 CLIFTON ST	20	20	2.74 NSHL	OPP CURB STOP	RECONNECT SERVICE
777 CLIFTON ST	20	20	1.22 NSHL	0.30 N CURB STOP	RENEW SERVICE TO PIL WITH 20 CU
780 CLIFTON ST	20	20	1.07 NSHL	0.30 N CURB STOP	RECONNECT SERVICE
781 CLIFTON ST	20	20	1.98 NSHL	0.61 N CURB STOP	RENEW SERVICE TO PIL WITH 20 CU
786 CLIFTON ST	20	20	0.61 NSHL	OPP CURB STOP	RECONNECT SERVICE
791 CLIFTON ST	20	12	1.52 NSHL	0.91 N CURB STOP	RECONNECT SERVICE
794 CLIFTON ST	20	20	3.17 NSHL	OPP CURB STOP	RECONNECT SERVICE
795 CLIFTON ST	20	20	83.09 SSL ST MATTHEWS AVE	0.30 S CURB STOP	RECONNECT SERVICE
798 CLIFTON ST	20	20	91.74 SSL ST MATTHEWS AVE	OPP CURB STOP	RECONNECT SERVICE
799 CLIFTON ST	20	20	2.32 NSHL	0.61 S CURB STOP	RECONNECT SERVICE
801 CLIFTON ST	20	20	0.98 NSHL	0.49 N CURB STOP	RECONNECT SERVICE
803 CLIFTON ST	20	20	88.43 SSL ST MATTHEWS AVE	OPP CURB STOP	RECONNECT SERVICE

\* SERVICES TO BE RENEWED TO R. ALL OTHERS TO BE RECONNECTED

FOR INDEX SEE D-15367

NOTE: ALL VALVES TO BE INSTALLED COUNTERCLOCKWISE TO CLOSE

**ENGINEERS GEOSCIENTISTS MANITOBA**  
 Certificate of Authorization  
 MORRISON HERSHFIELD  
 No. 1736

**METRIC**  
 WHOLE NUMBERS INDICATE MILLIMETRES  
 DECIMALIZED NUMBERS INDICATE METRES

**WARNING**  
 IF POWER EQUIPMENT OR EXPLOSIVES ARE TO BE USED FOR EXCAVATION ON THIS PROJECT THE CONTRACTOR MUST:  
 1) NOTIFY THE GAS COMPANY OF THE PROPOSED LOCATION OF EXCAVATION.  
 2) TAKE PRECAUTION TO AVOID DAMAGE TO GAS COMPANY INSTALLATIONS.  
 SEE PROVINCIAL REGULATION 210/72 FOR DETAILS

**LOCATION APPROVED UNDERGROUND STRUCTURES**  
 SUPV. U/G STRUCTURES COMMITTEE DATE  
 NOTE:  
 LOCATION OF UNDERGROUND STRUCTURES AS SHOWN ARE BASED ON THE BEST INFORMATION AVAILABLE BUT NO GUARANTEE IS GIVEN THAT ALL EXISTING UTILITIES ARE SHOWN OR THAT THE GIVEN LOCATIONS ARE EXACT. CONFIRMATION OF EXISTENCE AND EXACT LOCATION OF ALL SERVICES MUST BE OBTAINED FROM THE INDIVIDUAL UTILITIES BEFORE PROCEEDING WITH CONSTRUCTION.

B.M. ELEV.

NO.	REVISIONS	DATE	BY

**MORRISON HERSHFIELD**

DESIGNED BY	JKH	CHECKED BY	HAK
DRAWN BY	DML	APPROVED BY	HAK
SCALE:		RELEASED FOR CONSTRUCTION	KAS ZUREK
HORIZONTAL	1:250	DATE	2019 02 28
VERTICAL	1:50	DATE	2019 03 05

ENGINEER'S SEAL  
 ORIGINAL SIGNED BY H.A. KATZ  
 2019 03 05

**THE CITY OF WINNIPEG**  
 WATER AND WASTE DEPARTMENT  
 ENGINEERING DIVISION

2019 WATER MAIN RENEWALS  
 CONTRACT 6  
 CLIFTON STREET  
 200 m N OF WOLEVER AVENUE TO  
 40 m S OF ST MATTHEWS AVENUE

SHEET 5 OF 14  
 CITY DRAWING NUMBER  
 D-15370