

**NORTH EASEMENT**

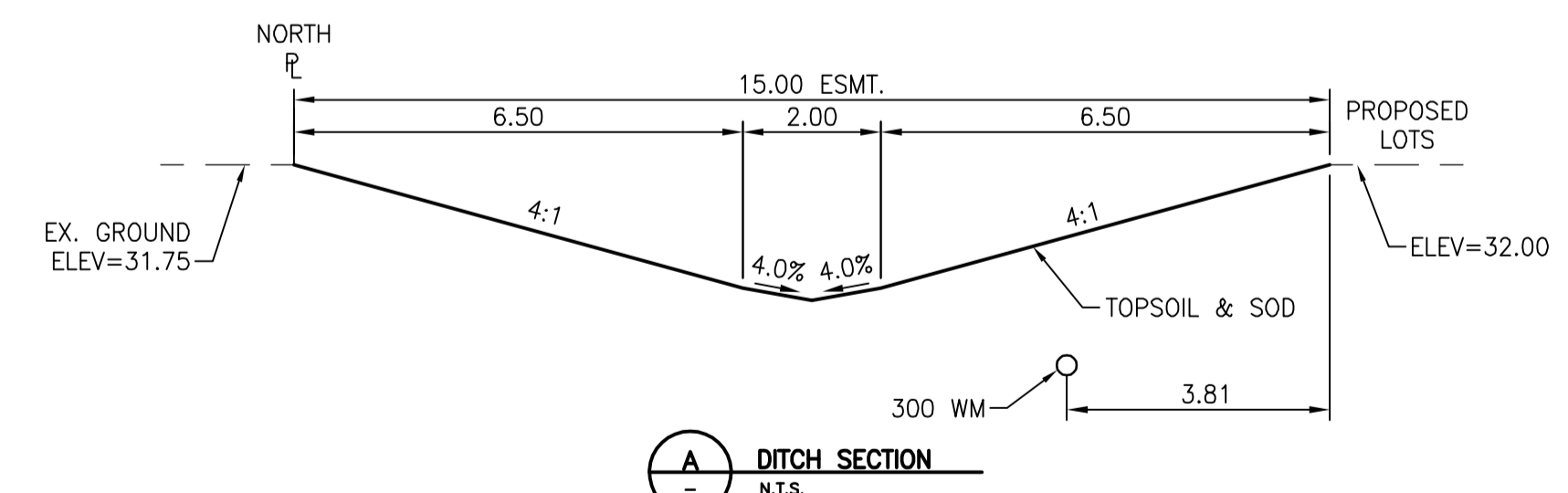

BENCHMARK: N.W. Cor. of Mazenod Rd. & G.W.W.D. R.O.W., 19 mm dia. x 4.6 m I.B. in Valve Box, 3.0 m W. of W.L. of Mazenod Rd. & 4.0 m N. of N. rail of tracks in G.W. W.D. R.O.W.

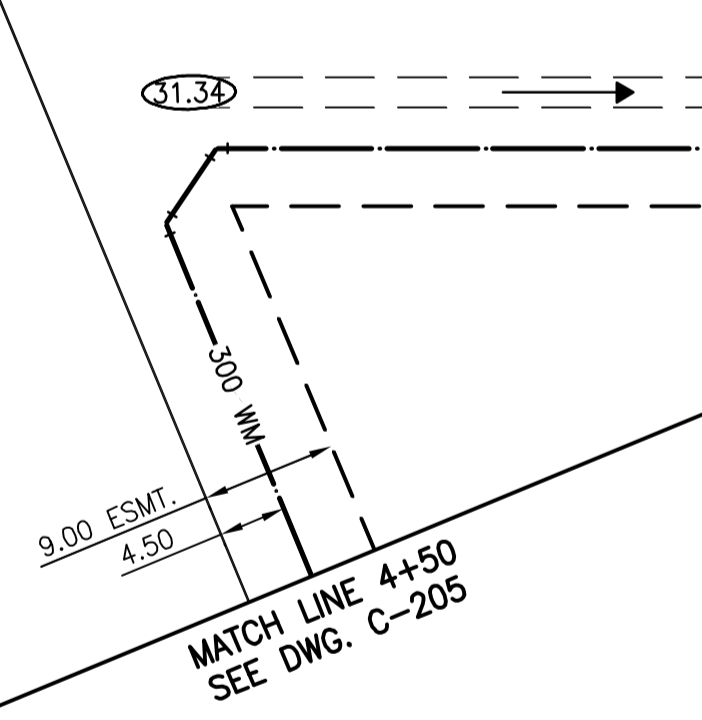
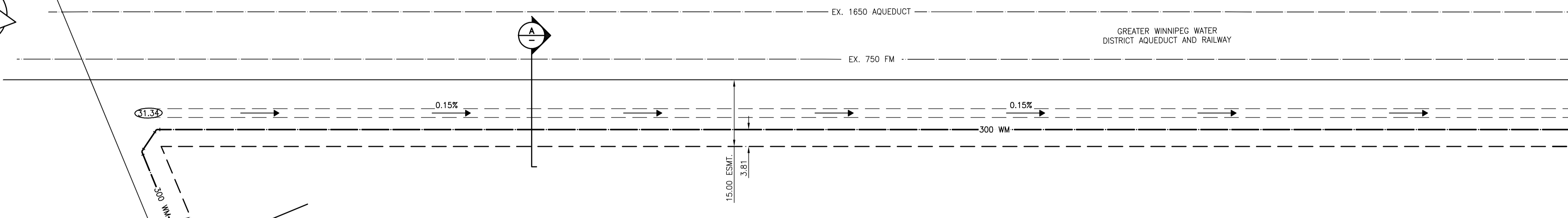
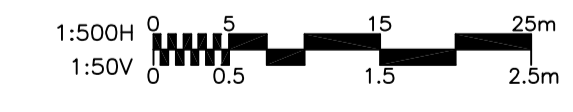

**ENGINEERS GEOSCIENTISTS MANITOBA**  
 Certificate of Authorization  
 Stantec Consulting Ltd.  
 No. 1301

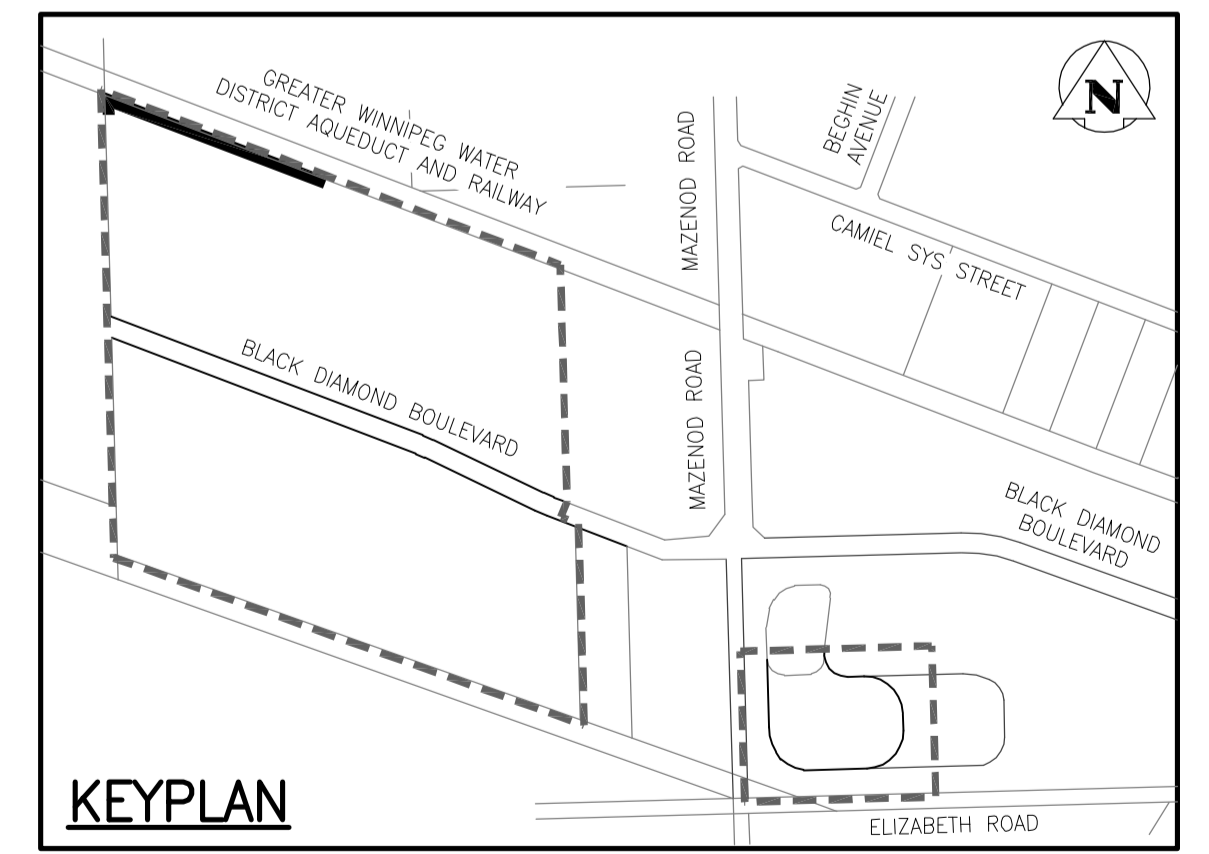

**WARNING**

IF POWER EQUIPMENT OR EXPLOSIVES ARE TO BE USED FOR EXCAVATION ON THIS PROJECT THE CONTRACTOR MUST:  
 1) NOTIFY THE GAS COMPANY OF THE PROPOSED LOCATION OF EXCAVATION.  
 2) TAKE PRECAUTION TO AVOID DAMAGE TO GAS COMPANY INSTALLATIONS.  
 SEE PROVINCIAL REGULATION 140/92 FOR DETAILS

**METRIC**

WHOLE NUMBERS INDICATE MILLIMETRES  
 DECIMALIZED NUMBERS INDICATE METRES

**NOTES:**

- CHAINAGES SHOWN ARE ALONG CENTERLINE OF PIPE.
- SUBDRAINS 18.00m EACH SIDE OF CATCH BASINS (SD-245).
- ALL PIPE UNDER EXISTING AND FUTURE PAVEMENT ARE INSTALLED BY TRENCHLESS METHODS.
- ALL LONG ASSEMBLY HYDRANTS (SD-006)  
 ALL SHORT ASSEMBLY HYDRANTS (SD-007).

EXISTING	LEGEND-PLAN	PROPOSED	EXISTING	LEGEND-PLAN	PROPOSED	EXISTING	LEGEND-PROFILE	PROPOSED
150 WM	WATERMAIN	150 WM	HYDRO	M.T.S.	150 WM	WATERMAIN	150 WM	WATERMAIN
+	HYDRANT	+	+	CONCRETE	+	+	+	HYDRANT, VALVE
+	VALVE	+	+	ASPHALT	+	+	+	LAND DRAINAGE SEWER
300 LDS	LAND DRAINAGE SEWER	300 LDS	+	SIDEWALK	+	+	+	WASTE WATER SEWER
250 WWS	WASTE WATER SEWER	250 WWS	+	PROPERTY LINE	+	+	+	WASTE WATER SEWER
○	MANHOLE	○	+	SURVEY BAR	+	+	+	WASTE WATER SEWER
■	CATCH BASIN	■	+	DITCH	+	+	+	WASTE WATER SEWER
▽	CURB INLET	▽	+	ROAD ELEVATION	+	+	+	WASTE WATER SEWER
+	JUNCTIONS	+	+	+	+	+	+	WASTE WATER SEWER
+	CULVERT	+	+	+	+	+	+	WASTE WATER SEWER
+	GAS	+	+	+	+	+	+	WASTE WATER SEWER

**LOCATION APPROVED UNDERGROUND STRUCTURES**  
 SUPV. U/G STRUCTURES COMMITTEE DATE \_\_\_\_\_  
 NOTE:  
 LOCATION OF UNDERGROUND STRUCTURES AS SHOWN ARE BASED ON THE BEST INFORMATION AVAILABLE BUT NO GUARANTEE IS GIVEN THAT ALL EXISTING UTILITIES ARE SHOWN OR THAT THE GIVEN LOCATIONS ARE EXACT. CONFIRMATION OF EXISTENCE AND EXACT LOCATION OF ALL SERVICES MUST BE OBTAINED FROM THE INDIVIDUAL UTILITIES BEFORE PROCEEDING WITH CONSTRUCTION.

NO.	REVISIONS	DATE	BY
1	SUBMITTED FOR CITY REVIEW	19.02.21	P.J.S.

**Stantec**  
 500 - 311 Portage Avenue, Winnipeg MB Canada R3B 2B9  
 Tel. 204.489.5900 Fax. 204.453.9012 www.stantec.com

DESIGNED BY: P.J.S. CHECKED BY: D.P.M.  
 DRAWN BY: L.D. APPROVED BY: P.J.S.  
 HOR. SCALE: 1:500 VERTICAL: 1:50  
 RELEASED FOR CONSTRUCTION: \_\_\_\_\_  
 DATE: 2018 .10 .15

ENGINEER'S SEAL  
**P.J. SUNDERLAND**  
 REGISTERED PROFESSIONAL ENGINEER  
 CONSULTANT DRAWING NO. C-206

**THE CITY OF WINNIPEG**  
 Winnipeg

ST. BONIFACE INDUSTRIAL PARK - PHASE 2 - STAGE 5  
**NORTH EASEMENT - WM**  
 250m N OF BLACK DIAMOND BOULEVARD TO  
 950m W OF MAZENOD ROAD

SHEET 9 OF 12  
 CAD FILE DRAWING NUMBER 09351C-205\_P2-5.DWG  
 CITY DRAWING NUMBER

V:\1680\p1680351\0300\_dwg\p1680351\_0302\_sheret\_files\02\_civil\phase\_2-stage\_5\09351c-205\_p2-5.dwg  
 2019/02/25 9:43 AM By: Derek Labanda