

**STAGE 3**

SCALE: 1:800 (22"x34")  
0 20 40m

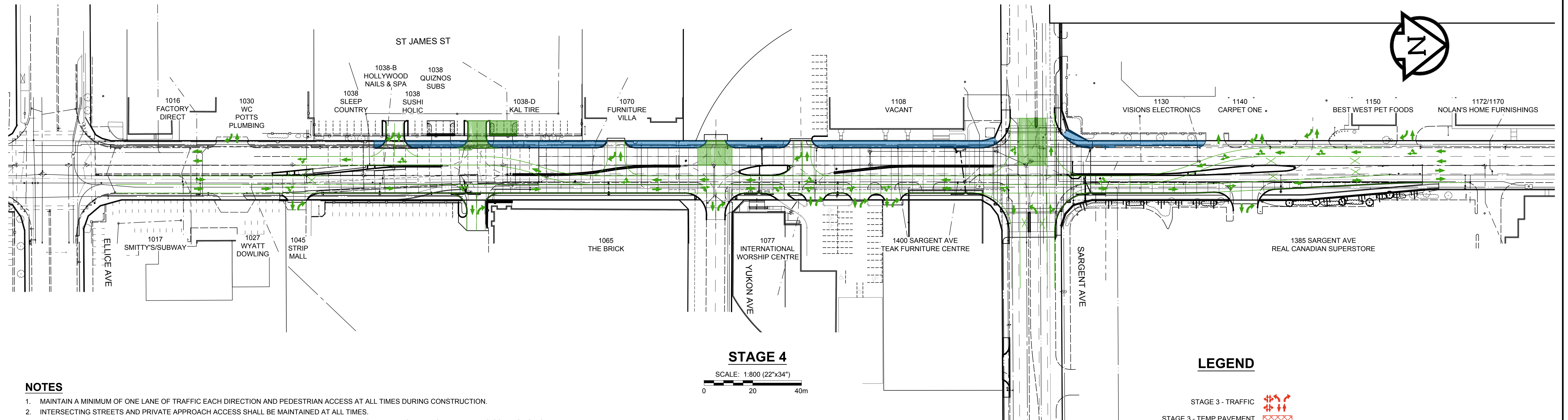

**STAGE 4**

SCALE: 1:800 (22"x34")  
0 20 40m

**NOTES**

1. MAINTAIN A MINIMUM OF ONE LANE OF TRAFFIC EACH DIRECTION AND PEDESTRIAN ACCESS AT ALL TIMES DURING CONSTRUCTION.
2. INTERSECTING STREETS AND PRIVATE APPROACH ACCESS SHALL BE MAINTAINED AT ALL TIMES.
3. CONSTRUCTION STAGING IN ACCORDANCE WITH THE LATEST EDITION OF THE CITY OF WINNIPEG "MANUAL OF TEMPORARY TRAFFIC CONTROL ON CITY STREETS".
4. MAINTAIN EXISTING DRAINAGE AND INSTALL PROPOSED DRAINAGE APPURTENANCES AS REQUIRED DURING THE APPROPRIATE STAGES AND AS DIRECTED BY THE CONTRACT ADMINISTRATOR.
5. TO FACILITATE LDS INSTALLATION, SAWCUT EXISTING PAVEMENT (FULL DEPTH) PRIOR TO REMOVAL.
6. CONSTRUCT TEMPORARY ASPHALT PAVEMENT AND RAMPS AS REQUIRED TO FACILITATE THE CONSTRUCTION STAGING. THE TEMPORARY ASPHALT PAVEMENT SHALL CONSIST OF 75mm - TYPE 1A ASPHALTIC CONCRETE PAVEMENT AND 300mm BASE COURSE.
7. LEFT TURN LANE WIDTH TO BE PARTIALLY EXCAVATED AND PERMANENT SUB-BASE / BASE STRUCTURE INSTALLED, IN ADDITION TO THE THROUGH LANES, WHILE MAINTAINING REQUIRED TRAFFIC (TO AVOID UNDERMINING OF PAVEMENT IN SUBSEQUENT STAGES).
8. SAWCUT EXISTING PAVEMENT FULL DEPTH PRIOR TO REMOVAL TO ENSURE INTEGRITY OF REMAINING PAVEMENT LEFT OPEN TO TRAFFIC.
9. PROPOSED SIDEWALKS TO BE CONSTRUCTED FOLLOWING CONSTRUCTION OF MAIN LANES.

**LEGEND**

- STAGE 3 - TRAFFIC
- STAGE 3 - TEMP PAVEMENT
- STAGE 3 - CONSTRUCTION
- STAGE 3 - SIDEWALK
- STAGE 4 - TRAFFIC
- STAGE 4 - TEMP PAVEMENT
- STAGE 4 - CONSTRUCTION
- STAGE 4 - SIDEWALK

**CITY OF WINNIPEG**  
**ST. JAMES STREET**  
**RECONSTRUCTION**  
**STAGING - STAGE 3 - 4**  
**ST. JAMES STREET**  
**FIGURE S-02**

McProj\W70414 Design\1 Drawings\04 Model\W70414 - St. James - Staging - 2019.dwg Last Saved: 2/20/2019 2:57 PM by kbernd Plotted: 2/20/2019 2:58 PM by Kevin Berend