

O:\Winipeg\Proj\7004\14 Design\Drawings\06 Sheets\WT7004-14-HG-01.dwg
 Last Saved: 5/15/2019 2:48 PM by kbarard
 Plotted: 5/15/2019 4:01 PM by Kevin Barard
 ISO A1 - 594mm x 841mm

ST. JAMES STREET

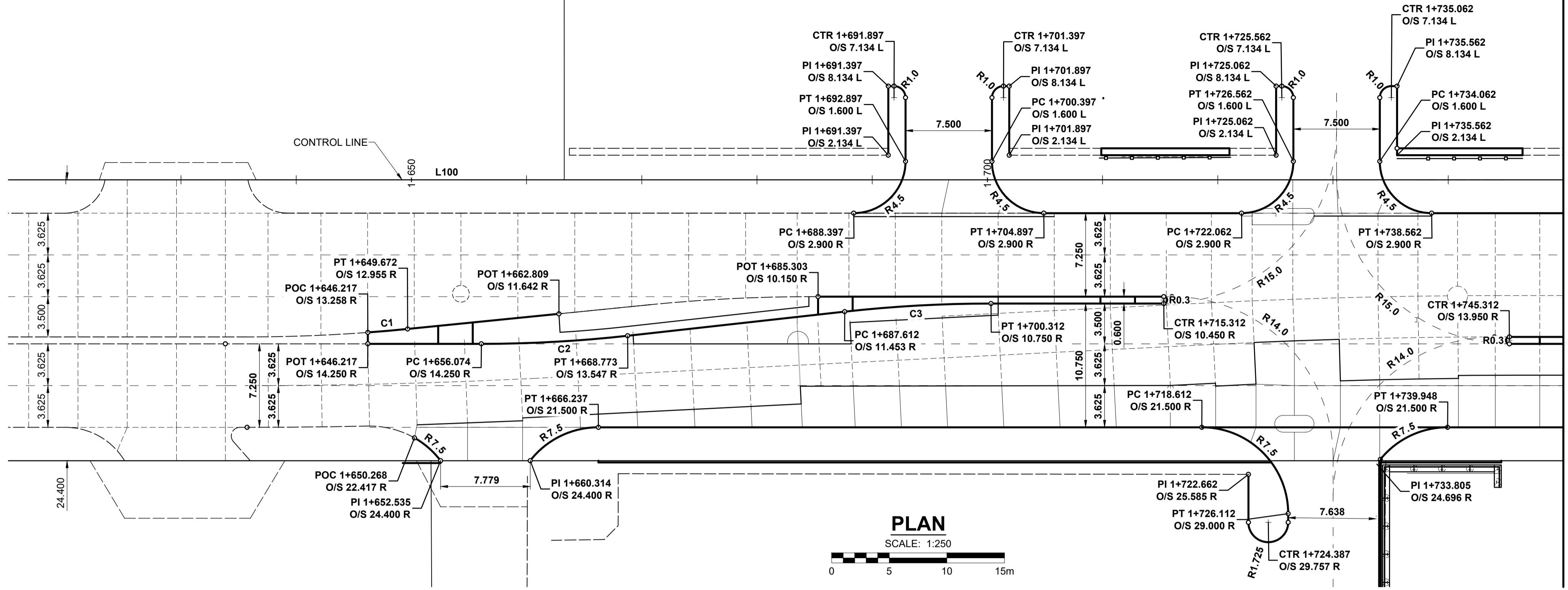

PLAN

SCALE: 1:250



CURVE TABLE				
CURVE	RADIUS	LENGTH	DELTA	TANGENT
C1	140.000	3.468	1°25'10"	1.734
C2	115.000	12.726	6°20'25"	6.369
C3	115.000	12.726	6°20'25"	6.369
C4	114.400	19.983	10°00'30"	10.017
C5	115.000	20.088	10°00'30"	10.070
C6	115.600	20.193	10°00'30"	10.122
C7	115.000	20.088	10°00'30"	10.070
C8	9.000	14.183	90°17'25"	9.046
C9	9.000	14.092	89°42'35"	8.955
C10	15.000	5.374	20°31'31"	2.716
C11	35.000	12.507	20°28'29"	6.321
C12	12.000	7.501	35°48'50"	3.877

ST. JAMES STREET

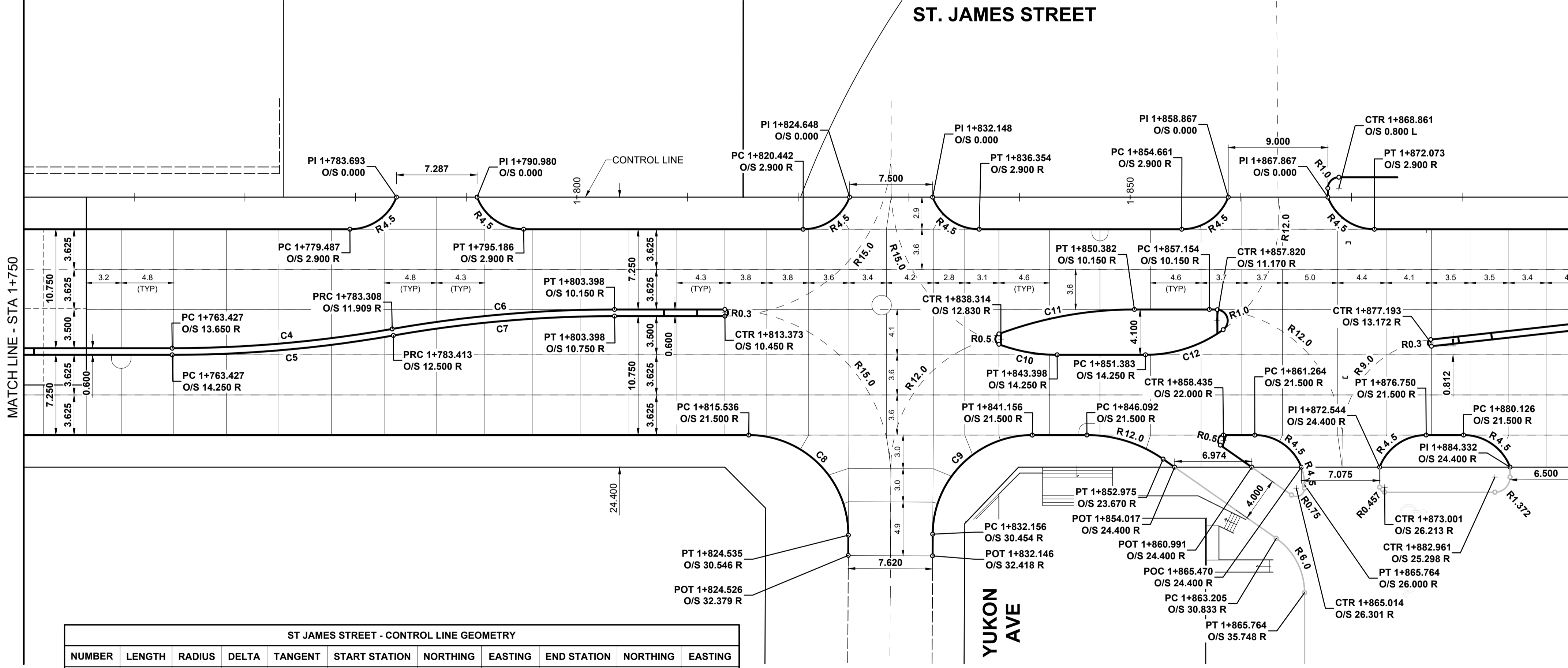

PLAN

SCALE: 1:250



ST JAMES STREET - CONTROL LINE GEOMETRY										
NUMBER	LENGTH	RADIUS	DELTA	TANGENT	START STATION	NORTHING	EASTING	END STATION	NORTHING	EASTING
L100	870.630				+504.352	10369.663	10329.202	+374.982	11239.929	10354.363

METRIC
 WHOLE NUMBERS INDICATE MILLIMETRES
 DECIMALIZED NUMBERS INDICATE METRES

EXISTING	LEGEND - PLAN	NEW	EXISTING	LEGEND - PLAN	NEW	EXISTING	LEGEND - PLAN	NEW	
	GAS		MANHOLE		CONCRETE PAVEMENT		LOCATION APPROVED		BM 38-002 ELEV 234.182 m
	MTS HANDWELL/PEDESTAL		CATCH BASIN/CATCH PIT		CONC SIDEWALK/MEDIAN		UNDERGROUND STRUCTURES		74M633 - Tbt in E. wall of No. 1108 St. James St., 0.2 m S. of N.E. Cor. of Bldg.
	HYDRO HANDWELL/CABINET		CURB INLET WITH BOX		ASPHALT PAVEMENT		DATE		
	CATV/FIBRE OPTIC		TREE		PAVING STONE		NOTE:		LOCATION OF UNDERGROUND STRUCTURES AS SHOWN ARE BASED ON THE BEST INFORMATION AVAILABLE BUT NO GUARANTEE IS GIVEN THAT ALL EXISTING UTILITIES ARE SHOWN OR THAT THE GIVEN LOCATIONS ARE EXACT. CONFIRMATION OF EXISTENCE AND EXACT LOCATION OF ALL SERVICES MUST BE OBTAINED FROM THE INDIVIDUAL UTILITIES BEFORE PROCEEDING WITH CONSTRUCTION.
	TRAFFIC SIGNALS/PIT		TEST HOLE		GRAVEL		RAMP CURBS		
	LAND DRAINAGE SEWER		PROPERTY LINE		PLANING/REMOVAL		PLANING/REMOVAL		
	SANITARY/COMBINED SEWER		FENCE						
	CB LEAD/SS/DCP		BOC/EDGE OF PAVEMENT						
	WATERMAIN		ELEVATION						
	SUBDRAIN		TRAFFIC SIGN						

LOCATION APPROVED
 UNDERGROUND STRUCTURES

SUPR. U/G STRUCTURES COMMITTEE DATE

NOTE:
 LOCATION OF UNDERGROUND STRUCTURES AS SHOWN ARE BASED ON THE BEST INFORMATION AVAILABLE BUT NO GUARANTEE IS GIVEN THAT ALL EXISTING UTILITIES ARE SHOWN OR THAT THE GIVEN LOCATIONS ARE EXACT. CONFIRMATION OF EXISTENCE AND EXACT LOCATION OF ALL SERVICES MUST BE OBTAINED FROM THE INDIVIDUAL UTILITIES BEFORE PROCEEDING WITH CONSTRUCTION.

NO.	REVISIONS	DATE	BY
B	ISSUED FOR TENDER	19/05/17	RPB
A	ISSUED FOR CLIENT REVIEW	18/06/07	RPB

	MORRISON HERSHFIELD
DESIGNED BY	WRJ
CHECKED BY	RPB
DRAWN BY	KMB
APPROVED BY	BWB
RELEASED FOR CONSTRUCTION	
HOR SCALE	1:250
VERT SCALE	
DATE	18/06/07

PROFESSIONAL'S SEAL
 PROVINCE OF MANITOBA

 R.P. BRUCE
 REGISTERED PROFESSIONAL ENGINEER
 CONSULTANT FILE NAME
 W170041-HG-01.dwg

THE CITY OF WINNIPEG
 PUBLIC WORKS DEPARTMENT
 ENGINEERING DIVISION

2019 REGIONAL STREET RENEWAL PROGRAM
ST. JAMES STREET RECONSTRUCTION
 50 m N OF ELLICE AVE TO 150 m N OF SARGENT AVE

CITY DRAWING NUMBER: P-3508-02
 SHEET 2 OF 16
 DRAWING NUMBER: 2

HORIZONTAL GEOMETRY
 ST JAMES STREET - STA 1+615 TO STA 1+890

ENGINEERS GEOSCIENTISTS MANITOBA
 Certificate of Authorization
 MORRISON HERSHFIELD
 No. 1736

TENDER 266-2019