

ISO A1 - 594mm x 841mm  
 C:\winnipeg\proj\7004\14\Design\Drawings\06\Sheets\W7004-1-PP-04.dwg  
 Last Saved: 21/05/2019 3:03 PM by kbarad  
 Plotted: 21/05/2019 4:04 PM by Kevin Barad

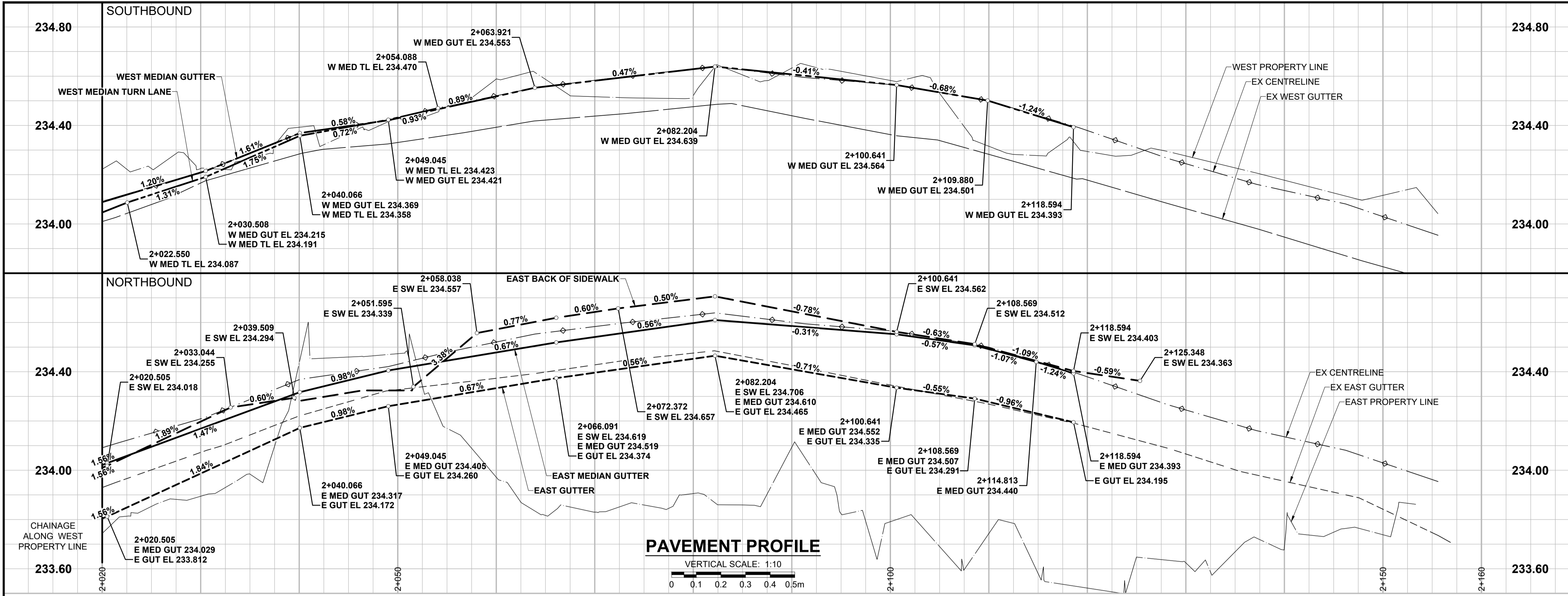

- NOTES**
- ADJUST MH AND CB RIMS TO NEW GRADES.
  - CONTRACTOR TO REGRADE/RENEW EXISTING PRIVATE SIDEWALKS TO LIMITS AS SHOWN. SIDEWALKS TO BE RENEWED WITH CONCRETE UNLESS NOTED OTHERWISE. CONTRACTOR TO TAKE PRECAUTIONARY STEPS TO PROTECT EXISTING TREES WITHIN THE LIMITS OF CONSTRUCTION FROM DAMAGE FROM CONSTRUCTION ACTIVITIES AS OUTLINED IN THE SPECIFICATIONS.
  - MODIFIED BARRIER CURB TO BE CONSTRUCTED AT ALL INTERSECTION RADII, BACK LANE RADII AND BULLNOSES.
  - CONTRACTOR TO CONFIRM THE LOCATION OF ALL UTILITIES/SERVICES IN THE FIELD PRIOR TO CONSTRUCTION.
  - ADD 200.000m TO ABBREVIATED ELEVATIONS TO OBTAIN GEODETIC ELEVATIONS.
  - CB SD-024 OFFSETS ARE DIMENSIONED TO BACK OF CURB. CB SD-025 OFFSETS ARE DIMENSIONED O/C.
  - ALL DIMENSIONS TO BACK OF CURB.

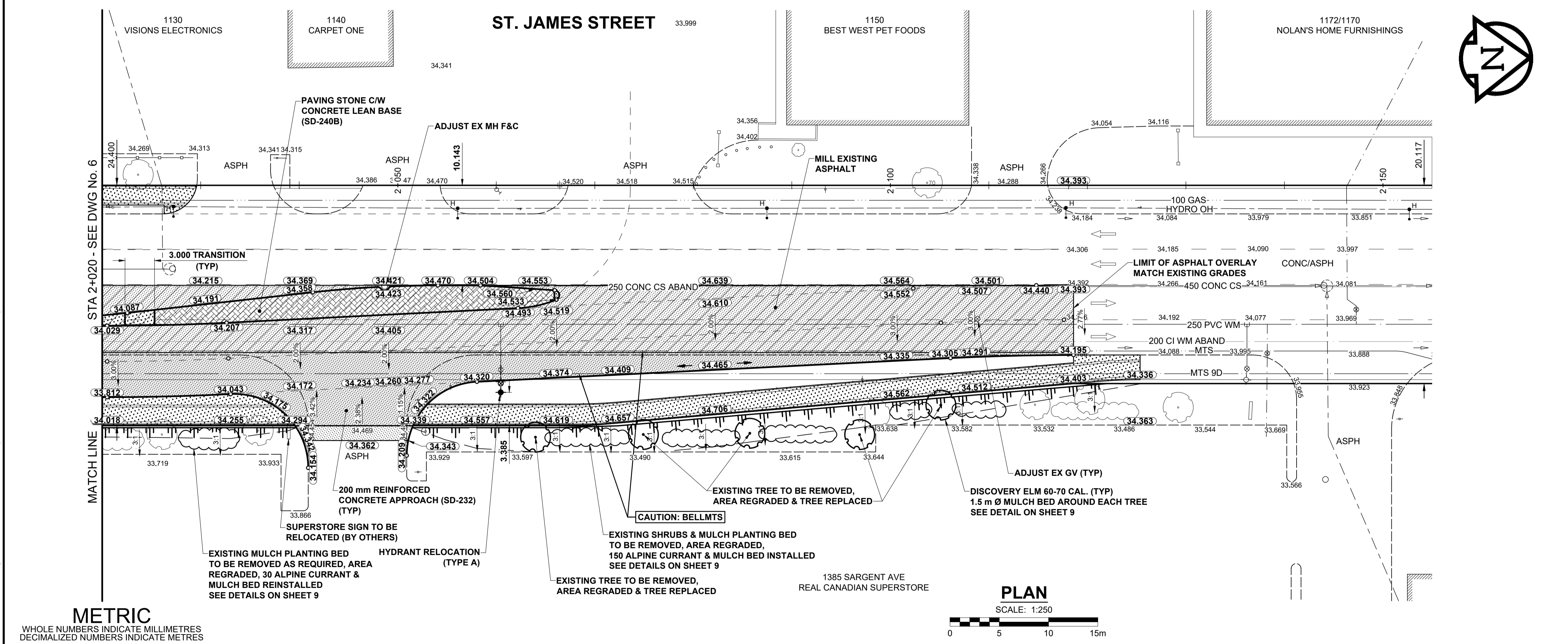

**METRIC**  
WHOLE NUMBERS INDICATE MILLIMETRES  
DECIMALIZED NUMBERS INDICATE METRES

---	GAS	○	MANHOLE	●	CONCRETE PAVEMENT
---	MTS HANDWELL/PEDESTAL	□	CATCH BASIN/CATCH PIT	■	CONC SIDEWALK/MEDIAN
---	HYDRO HANDWELL/CABINET	△	CURB INLET WITH BOX	▲	ASPHALT PAVEMENT
---	CATV/FIBRE OPTIC	○	TREE	○	PAVING STONE
---	TRAFFIC SIGNALS/PIT	⊕	TEST HOLE	⊕	GRAVEL
---	LAND DRAINAGE SEWER	⊕	PROPERTY LINE	---	RAMP CURB
---	SANITARY/COMBINED SEWER	⊕	SURVEY BAR	---	PLANING/REMOVAL
---	CB LEAD/SSP/DCP	---	FENCE	---	
---	WATERMAIN	---	BOC/EDGE OF PAVEMENT	---	
---	SUBDRAIN	33.000	ELEVATION	(33.333)	
---	DITCH	---	TRAFFIC SIGN	---	
---	EXISTING	---	LEGEND - PLAN	---	
---	NEW	---	LEGEND - PLAN	---	

---	CONCRETE PAVEMENT	---	LOCATION APPROVED
---	CONC SIDEWALK/MEDIAN	---	UNDERGROUND STRUCTURES
---	ASPHALT PAVEMENT	---	DATE
---	PAVING STONE	---	SUPR. U/G STRUCTURES
---	GRAVEL	---	COMMITTEE
---	RAMP CURB	---	NOTE:
---	PLANING/REMOVAL	---	LOCATION OF UNDERGROUND STRUCTURES
---		---	AS SHOWN ARE BASED ON THE BEST
---		---	INFORMATION AVAILABLE BUT NO
---		---	GUARANTEE IS GIVEN THAT ALL EXISTING
---		---	UTILITIES ARE SHOWN OR THAT THE GIVEN
---		---	LOCATIONS ARE EXACT. CONFIRMATION OF
---		---	EXISTENCE AND EXACT LOCATION OF ALL
---		---	SERVICES MUST BE OBTAINED FROM THE
---		---	INDIVIDUAL UTILITIES BEFORE PROCEEDING
---		---	WITH CONSTRUCTION.

BM 38-002	74M633 - Tilt. in E. wall of No. 1108 St.
ELEV 234.182 m	James St., 0.2 m S. of N.E. Cor. of Bldg.
DESIGNED BY	WRJ
CHECKED BY	RPB
DRAWN BY	KMB
APPROVED BY	BWB
RELEASED FOR CONSTRUCTION	
HOR SCALE	1:250
VERT SCALE	1:10
ISSUED FOR TENDER	19/05/17 RPB
ISSUED FOR CLIENT REVIEW	18/06/07 RPB
REVISIONS	YY/MM/DD BY

PROFESSIONAL'S SEAL	PROVINCE OF MANITOBA
REGISTERED PROFESSIONAL ENGINEER	R.P. BRUCE
CONSULTANT FILE NAME	W170041-PP-04.dwg

<b>MORRISON HERSHFIELD</b>	DESIGNED BY	WRJ	CHECKED BY	RPB
	DRAWN BY	KMB	APPROVED BY	BWB
	RELEASED FOR CONSTRUCTION			
	HOR SCALE	1:250		
	VERT SCALE	1:10		
	ISSUED FOR TENDER	19/05/17 RPB		
	ISSUED FOR CLIENT REVIEW	18/06/07 RPB		
	REVISIONS	YY/MM/DD BY		

<b>THE CITY OF WINNIPEG</b>	CITY DRAWING NUMBER	P-3508-07
<b>PUBLIC WORKS DEPARTMENT</b>	SHEET	7 OF 16
<b>ENGINEERING DIVISION</b>	DRAWING NUMBER	

<b>2019 REGIONAL STREET RENEWAL PROGRAM</b>	<b>PAVING &amp; GRADING</b>
<b>ST. JAMES STREET RECONSTRUCTION</b>	ST JAMES STREET - STA 2+020 TO STA 2+155
<b>50 m N OF ELLICE AVE TO 150 m N OF SARGENT AVE</b>	

<b>ENGINEERS</b>	<b>GEOSCIENTISTS</b>
<b>MANITOBA</b>	
Certificate of Authorization	MORRISON HERSHFIELD
No. 1736	
TENDER 266-2019	