

2019-05-01

U:\FMS\18-0107-016\18-0107-016_35 SANFORD FLEMING.DWG
PLOT 1:1 (A-1)

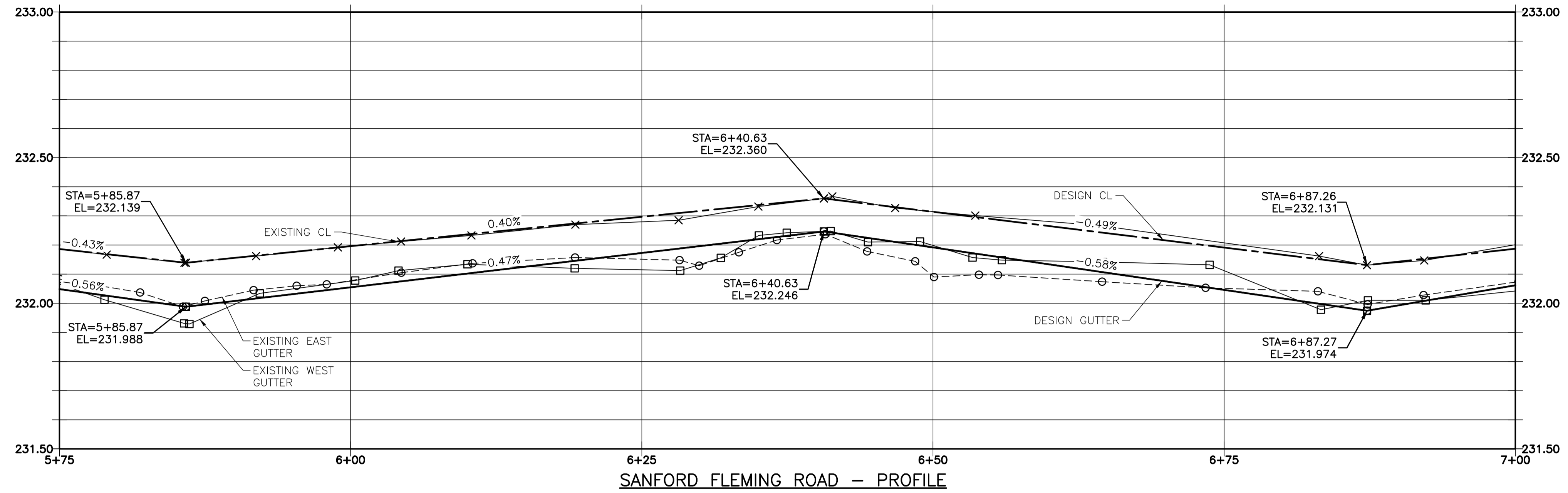

SANFORD FLEMING ROAD - PROFILE

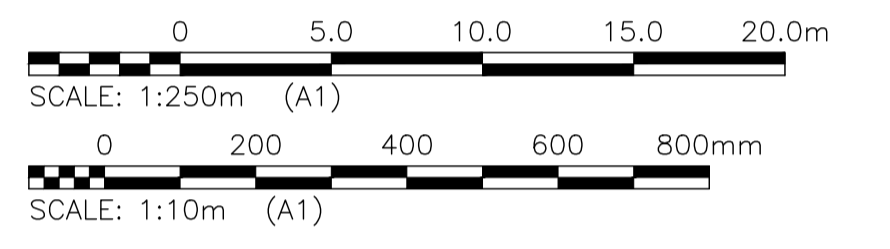

NOTES:

1. STATION IN CENTRE OF RIGHT-OF-WAY UNLESS OTHERWISE NOTED.
2. EAST PROPERTY LINE OF PLESSIS ROAD IS STA 1+00
3. ALL MEASUREMENTS TO BACK OF CURB.
4. ALL EXISTING TREES TO BE PROTECTED AND MAINTAINED THROUGHOUT CONSTRUCTION UNLESS NOTED OTHERWISE.
5. ALL BUS STOPS WITHIN LIMITS OF CONSTRUCTION TO BE TEMPORARILY RELOCATED BY OTHERS DURING WORKS.
6. HAND OR SOFT DIG METHODS REQUIRED OVER GAS UTILITIES AT INTERVALS DETERMINED BY THE ENGINEER TO DETERMINE DEPTH OF COVER.
7. NO WORKS, INCLUDING CONCRETE CUTTING OR BREAKING, TO BE UNDERTAKEN NEAR GAS LINES UNTIL DEPTH OF COVER IS DETERMINED AND A MANITOBA HYDRO SAFETY WATCH REPRESENTATIVE IS ON SITE.
8. NO VIBRATORY COMPACTION PERMITTED WITHIN 1M OF GAS MAINS.
9. INSTALL MODIFIED BARRIER CURB AT ALL INTERSECTION RADII, ALLEY RADII, AND BULLNOSES.
10. CONSTRUCT NEW MONOLITHIC CURB RAMP (10mm HEIGHT INTEGRAL)
11. ADJUST ALL WATER VALVES, WATER SERVICE VALVES, MANHOLES AND CATCH BASINS TO GRADE.
12. INSTALL DETECTABLE WARNING SURFACE TILE (SD-229AB) AT STREET INTERSECTIONS.
13. MILL EXISTING LIP CURB AND CONSTRUCT NEW BARRIER CURB 150mm REVEAL, DOWELED.
14. CONCRETE REPAIRS SHOWN BASED ON VISUAL INSPECTION PRIOR TO REMOVAL OF ASPHALT OVERLAY. FINAL REPAIR LIMITS AND DIMENSIONS MAY VARY FROM THOSE SHOWN.

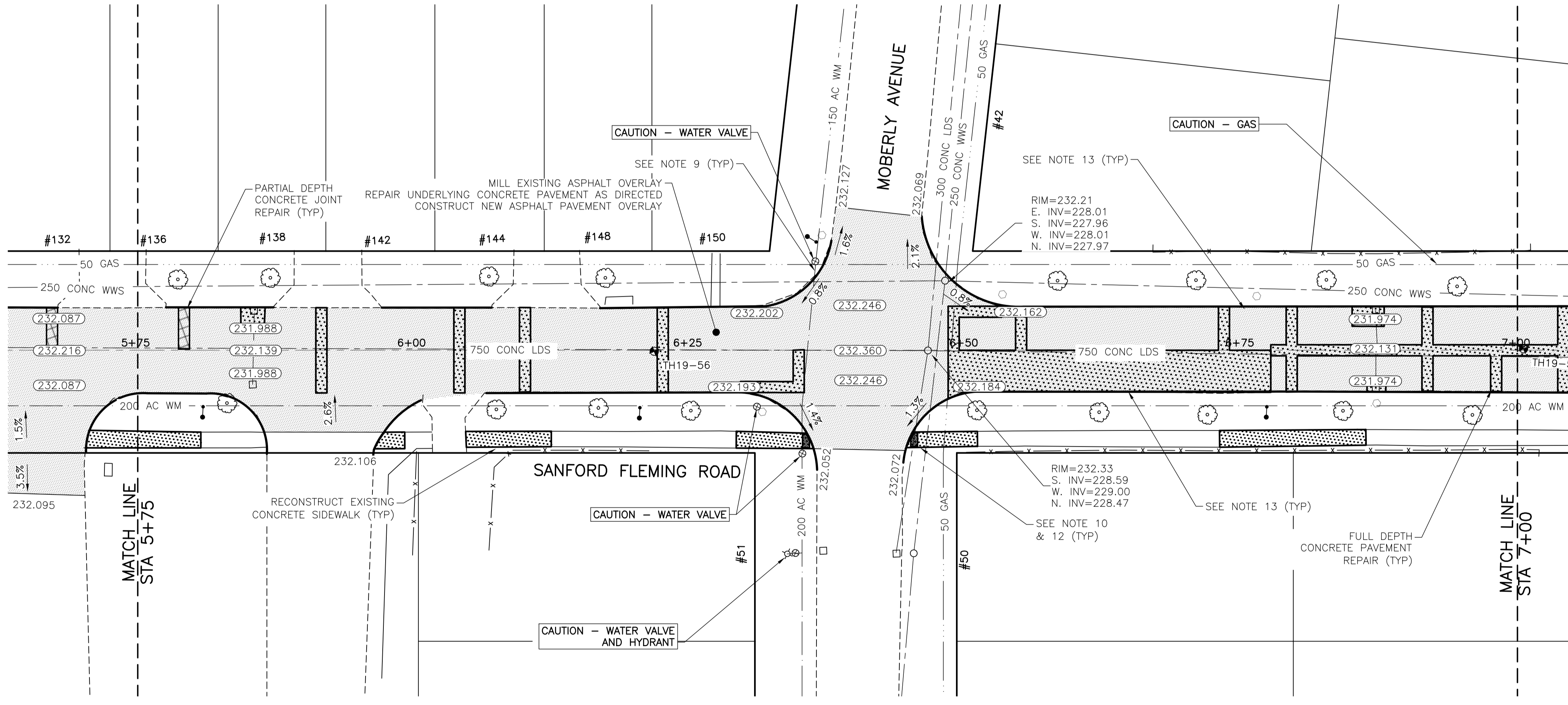

SANFORD FLEMING ROAD - PLAN

LOCATIONS OF UNDERGROUND STRUCTURES AS SHOWN ARE BASED ON THE BEST INFORMATION AVAILABLE. BUT NO GUARANTEE IS GIVEN THAT ALL EXISTING UTILITIES ARE SHOWN OR THAT THE GIVEN LOCATIONS ARE EXACT. CONFIRMATION OF THE EXISTENCE AND EXACT LOCATION OF ALL SERVICES MUST BE OBTAINED FROM INDIVIDUAL UTILITIES BEFORE PROCEEDING WITH CONSTRUCTION.

PROPERTY LIMITS DELINEATION
DELINEATION OF PROPERTY LIMITS AS SHOWN ON THIS DWG DOES NOT REPRESENT A "LEGAL SURVEY". KGS GROUP MAKES NO REPRESENTATION OR WARRANTY AS TO THE ACCURACY OF PROPERTY LIMITS DELINEATED ON THIS DWG, NOR ON THE DIMENSIONAL ACCURACY OF DWG FEATURES RELATIVE TO THOSE PROPERTY LIMITS.

WARNING
NOTIFY THE GAS COMPANY OF THE PROPOSED LOCATION OF EXCAVATION. TAKE PRECAUTION TO AVOID DAMAGE TO GAS COMPANY INSTALLATIONS. SEE PROVINCIAL REGULATION 210/72 FOR DETAILS.

METRIC
WHOLE NUMBERS INDICATE MILLIMETRES
DECIMALIZED NUMBERS INDICATE METRES

PRELIMINARY
NOT TO BE USED FOR CONSTRUCTION

| | | | | | | | |
|----------|---------------------|----------|-----|---------------------|----------------|----------|--|
| 300_LDS | LAND DRAINAGE SEWER | 300_LDS | ● | TEST HOLE | | | |
| 250_WWS | WASTE WATER SEWER | 250_WWS | — | GUY WIRE | | | |
| --- | GAS | --- | — | LIGHT STANDARD | | | |
| --- | HYDRO | --- | --- | BACK OF CURB | | | |
| --- | M.T.S. | --- | --- | PARTIAL DEPTH PATCH | | | |
| 150_WM | WATERMAIN | 150_WM | --- | CONCRETE | | | |
| + | HYDRANT | + | + | ASPHALT | | | |
| ○ | VALVE | ○ | ○ | SIDEWALK | | | |
| ○ | MANHOLE | ○ | ○ | PROPERTY LINE | | | |
| □ | CATCH BASIN | □ | + | SURVEY BAR | | | |
| ▽ | CURB INLET | ▽ | + | GEODETIC BENCHMARK | | | |
| ● | POLES | ● | ● | ELEVATION | | | |
| ● | POLES | ● | ● | | | | |
| EXISTING | LEGEND-PLAN | PROPOSED | | EXISTING | LEGEND-PROFILE | PROPOSED | |

| | | | |
|--|--|-------------------------------|---------------------------|
| LOCATION APPROVED UNDERGROUND STRUCTURES | | B.I.M. KGS_BASE ELEV. 249.221 | COORDINATE SYSTEM: CGVD28 |
| SUPV. U/G STRUCTURES COMMITTEE | | DATE | |
| NOTE: LOCATION OF UNDERGROUND STRUCTURES AS SHOWN ARE BASED ON THE BEST INFORMATION AVAILABLE BUT NO GUARANTEE IS GIVEN THAT ALL EXISTING UTILITIES ARE SHOWN OR THAT THE GIVEN LOCATIONS ARE EXACT. CONFIRMATION OF EXISTENCE AND EXACT LOCATION OF ALL SERVICES MUST BE OBTAINED FROM THE INDIVIDUAL UTILITIES BEFORE PROCEEDING WITH CONSTRUCTION. | | | |

| | | |
|---------------------------------------|-------------------|----------------------------|
| KGS GROUP CONSULTING ENGINEERS | | ENGINEER'S SEAL |
| DESIGNED BY: MH | CHECKED BY: | |
| DRAWN BY: MH | APPROVED BY: | |
| B ISSUED FOR TENDER 19/05/02 | HOR. SCALE: 1:250 | RELEASED FOR CONSTRUCTION: |
| A ISSUED FOR REVIEW 19/03/05 JB | VERTICAL: 1:10 | DATE |
| NO. REVISIONS | DATE | BY |
| | 2019/01/24 | |

THE CITY OF WINNIPEG PUBLIC WORKS DEPARTMENT ENGINEERING DIVISION

PROJECT TITLE: **2019 LOCAL STREET PACKAGE**

SANFORD FLEMING ROAD

PLAN AND PROFILE 05+75 TO 07+00

SHEET 5 OF 21

COMPUTER FILE NAME: 18-0107-016_35 SANFORD FLEMING.DWG

CITY DRAWING NUMBER: -

CONSULTANT DRAWING NO. **C105**