

MATCHLINE 9+30

MATCHLINE 12+90

MATCHLINE 12+90

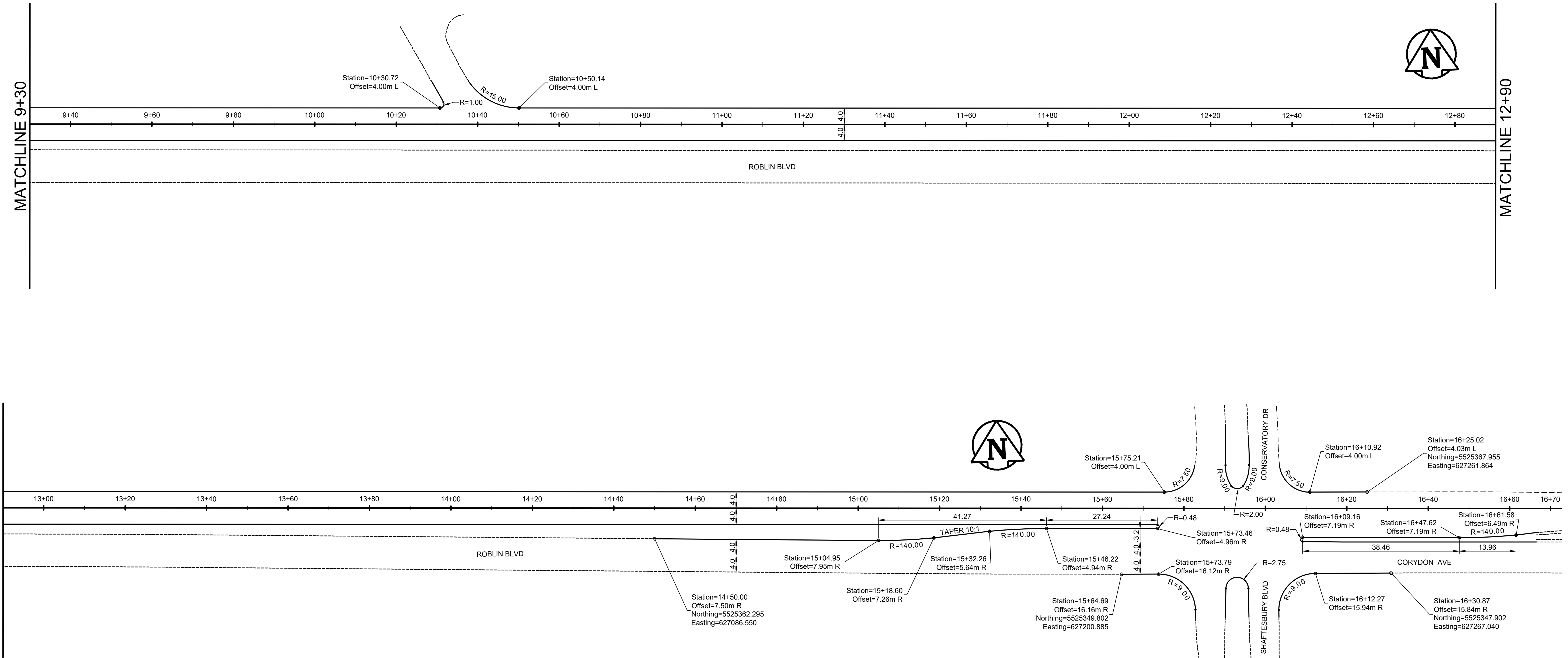

**ROBLIN BOULEVARD WESTBOUND POINT TABLE - CONTROL**

Point	Station	Northing	Easting
PT1	2+10	5525429.092	625848.343
PI1	3+16.98	5525422.192	625955.105
PC1	6+18.09	5525403.848	626255.650
PT2	6+40.38	5525402.447	626277.893
PC2	7+03.47	5525398.646	626340.871
PT3	7+18.76	5525397.714	626356.138
PI2	7+77.50	5525394.136	626414.764
PC3	8+46.61	5525390.039	626483.749
PT4	8+65.75	5525389.385	626502.883
EP	16+70	5525362.418	627306.697

**ROBLIN BOULEVARD WESTBOUND CURVE TABLE - CONTROL**

Curve	Radius	Δ Delta	External Tangent	Length	Chord Length
C1	2000.000	0°38'19"	11.144	22.287	22.287
C2	2000.000	0°26'17"	7.648	15.295	15.295
C3	2000.000	0°32'54"	9.573	19.145	19.145

- GENERAL NOTES**
- A. PAVEMENT DIMENSIONS ARE TO BACK OF CURB
  - B. ALL CURB RADII UNDER 15.0m SHALL BE MODIFIED
  - C. ADD 200.000m TO ALL DESIGN ELEVATION TO OBTAIN GEODETIC ELEVATIONS
  - D. CURB REPLACEMENT AS DIRECTED BY CONTRACT ADMINISTRATOR
  - E. CONTRACTOR TO CONFIRM THE LOCATION OF ALL UTILITIES/SERVICES IN THE FIELD PRIOR TO CONSTRUCTION
  - F. ADJUST ALL EXISTING WATER VALVES AND CURB STOPS TO GRADE

**PRELIMINARY**  
NOT TO BE USED FOR CONSTRUCTION

**METRIC**  
WHOLE NUMBERS INDICATE MILLIMETERS  
DECIMALIZED NUMBERS INDICATE METERS

TENDER NO. 4-2019

LOCATION APPROVED UNDERGROUND STRUCTURES		B.M. ELEV.
SUPR. U/G STRUCTURES COMMITTEE	DATE	
NOTE: LOCATION OF UNDERGROUND STRUCTURES AS SHOWN ARE BASED ON THE BEST INFORMATION AVAILABLE BUT NO GUARANTEE IS GIVEN THAT ALL EXISTING UTILITIES ARE SHOWN OR THAT THE GIVEN LOCATIONS ARE EXACT. CONFIRMATION OF EXISTENCE AND EXACT LOCATION OF ALL SERVICES MUST BE OBTAINED FROM THE INDIVIDUAL UTILITIES BEFORE PROCEEDING WITH CONSTRUCTION.		
NO.	REVISIONS	DATE BY

ENGINEERING DIVISION TECHNOLOGY SERVICES BRANCH 106 - 1155 PACIFIC AVE	
DESIGNED BY R.W.	CHECKED BY R.W. / A.M.C.
DRAWN BY J.D.	APPROVED BY
HOR. SCALE: 1 : 500	
VERTICAL:	
DATE 18/03/2019	

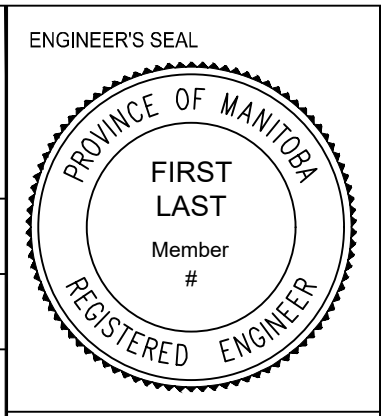

**THE CITY OF WINNIPEG**  
PUBLIC WORKS DEPARTMENT

**ROBLIN BOULEVARD WESTBOUND**  
FROM ASSINBOINE PARK DRIVE TO SHAFESBURY BOULEVARD  
CONCRETE RECONSTRUCTION AND ASSOCIATED WORKS

HORIZONTAL GEOMETRY  
FROM STA. 9+30 TO STA. 16+70

CITY DRAWING NUMBER P-3504-19	SHEET 19 OF 28
19	