

ASSINIBOINE PARK DRIVE - ASPHALT RECONSTRUCTION CROSS SECTION (TYPICAL)

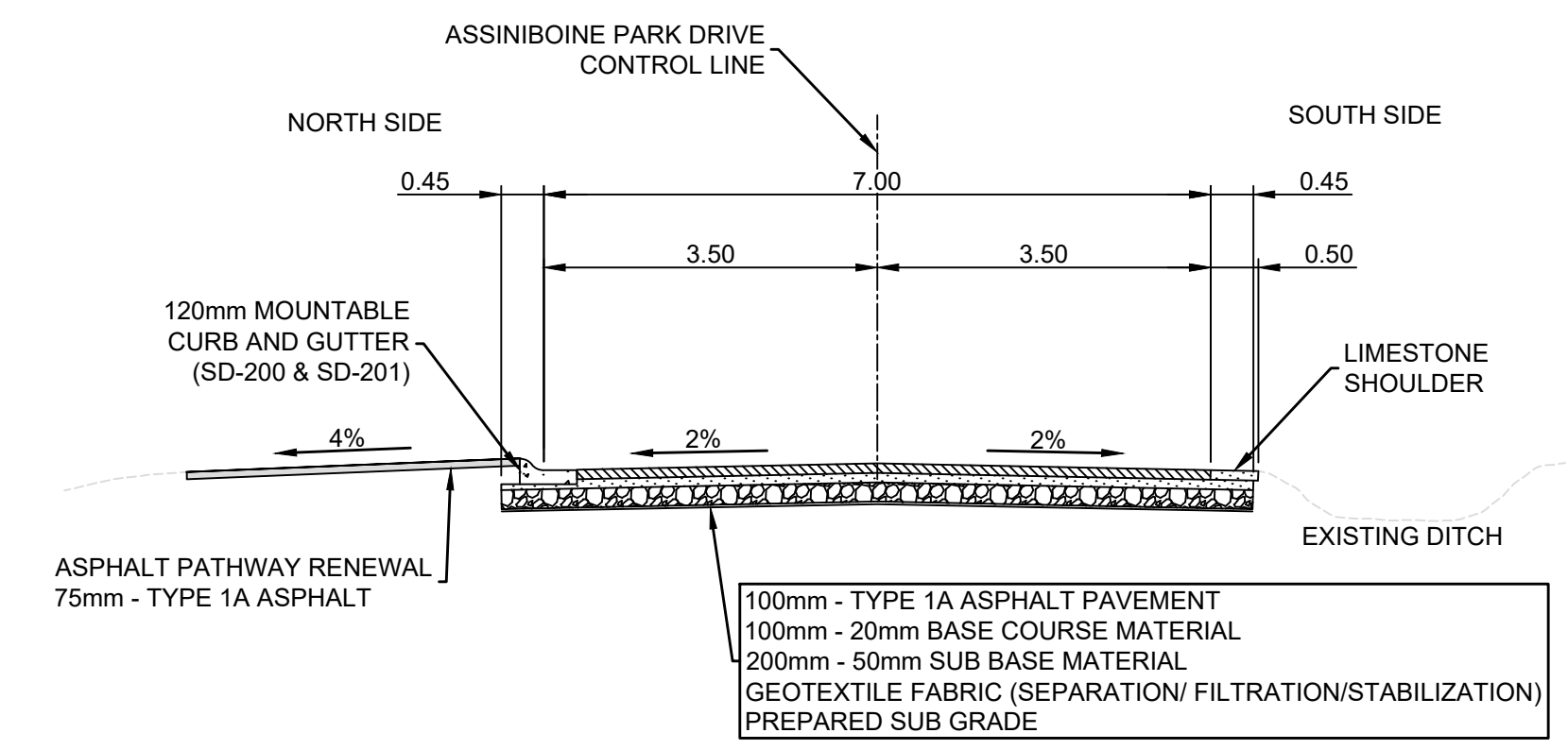

ASSINIBOINE PARK DRIVE - ASPHALT RECONSTRUCTION CROSS SECTION (TYPICAL) PROPOSED 120mm MOUNTABLE CURB AND GUTTER

- CONSTRUCTION NOTES**
- MILL EXISTING ASPHALT AND CONSTRUCT NEW ASPHALTIC PAVEMENT OVERLAY
  - REMOVE EXISTING PAVEMENT AND CONSTRUCT NEW 100mm ASPHALT PAVEMENT
  - REMOVE EXISTING CULVERT
  - INSTALL NEW CULVERT
  - RENEW EXISTING ASPHALT PATHWAY
  - CONSTRUCT NEW 120mm MOUNTABLE CURB AND GUTTER (SD-200 & SD-201)
  - RE-GRADE EXISTING DITCH AS REQUIRED
  - RELOCATE TERASSPAN CONDUIT AS REQUIRED
- GENERAL NOTES**
- PAVEMENT DIMENSIONS ARE TO EDGE OF ASPHALT
  - ALL CURB RADII UNDER 15.0m SHALL BE MODIFIED
  - ADD 200.00mm TO ALL DESIGN ELEVATION TO OBTAIN GEODETIC ELEVATIONS
  - CURB REPLACEMENT AS DIRECTED BY CONTRACT ADMINISTRATOR
  - CONTRACTOR TO CONFIRM THE LOCATION OF ALL UTILITIES/SERVICES IN THE FIELD PRIOR TO CONSTRUCTION

**PRELIMINARY**  
NOT TO BE USED FOR CONSTRUCTION

**METRIC**  
WHOLE NUMBERS INDICATE MILLIMETERS  
DECIMALIZED NUMBERS INDICATE METERS

TENDER NO. 4-2019

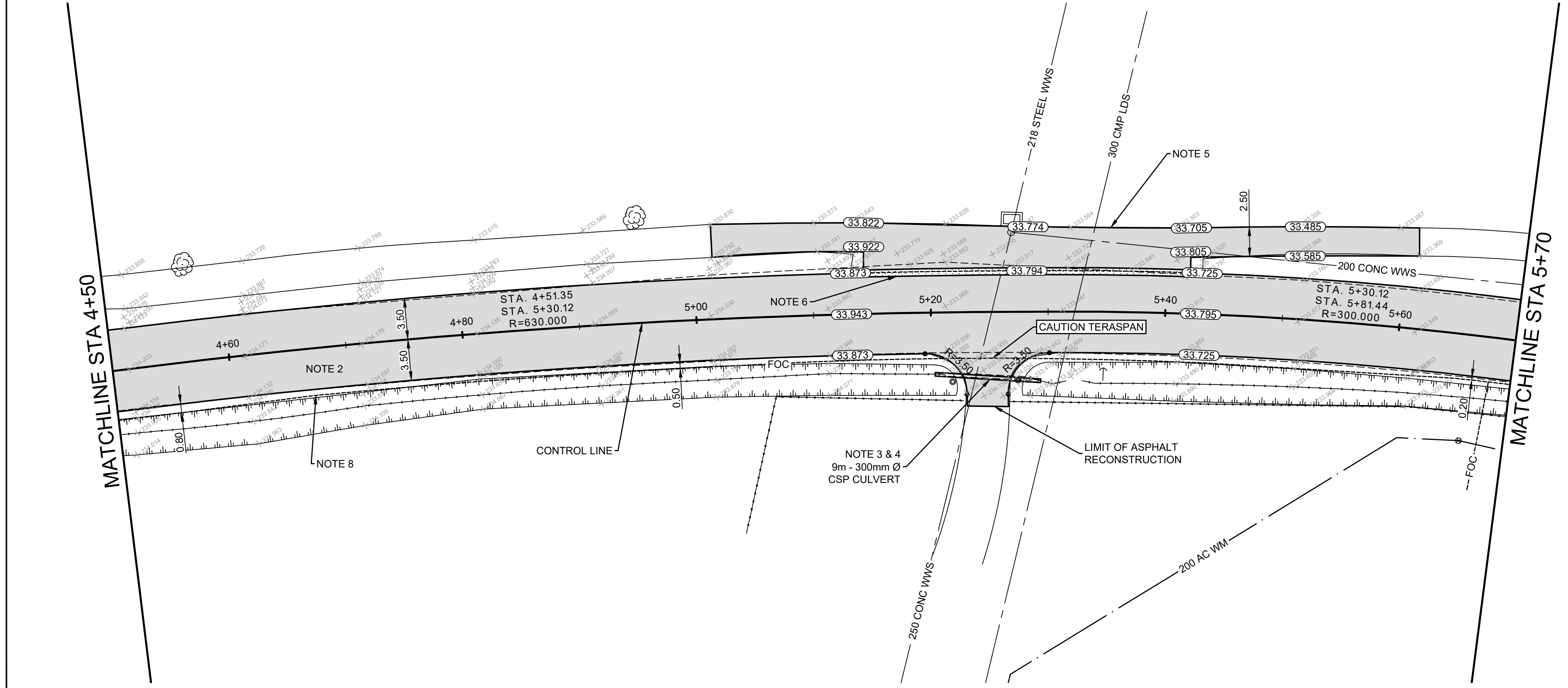

EXISTING	LEGEND - PLAN	PROPOSED	EXISTING	LEGEND - PLAN	PROPOSED	EXISTING	LEGEND - PLAN	PROPOSED
⊕	HYDRANT	◆	---	LDS/WWS	---	▒	CONCRETE	▒
⊗	VALVE	●	---	WATERMAIN	---	▒	CONCRETE SIDEWALK	▒
○	CURB STOP	●	---	GAS	---	▒	ASPHALT	▒
○	MANHOLE	●	---	TRAFFIC SIGNALS	---	▒	DITCH FLOW	▒
□	CATCH BASIN	●	---	HYDRO/STREET LIGHT	---	▒	DITCH - TOP OF SLOPE	▒
△	CURB INLET	▲	---	MTS	---	▒	CULVERT	▒
○	HYDRO POLE	●	---	CURB RENEWAL	---	▒	LDS FLOW DIRECTION	▒
○	LIGHT STANDARD	●	---	PROPERTY LINE	---	▒	EDGE OF PAVEMENT	▒
○	TRAFFIC SIGNAL POLE	●	---	RAMP CURB	---	▒	ASPHALT CROSSOVER	▒
⊕	SURVEY BAR	◆	---	ELEVATIONS	---	▒		
⊕	GEODETIC BENCH MARK	◆	---	TREELINE	---	▒		

LOCATION APPROVED UNDERGROUND STRUCTURES		B.M. ELEV.
NO.	REVISIONS	
1.	ISSUE FOR TENDER	18/03/19 R.W.
2.	SUBMIT FOR PLAN APPROVAL	08/03/19 R.W.
3.		
4.		
5.		
6.		
7.		
8.		
9.		
10.		

ENGINEERING DIVISION TECHNOLOGY SERVICES BRANCH 106 - 1155 PACIFIC AVE	
DESIGNED BY J.D.	CHECKED BY R.W. / A.M.C.
DRAWN BY J.D.	APPROVED BY
HOR. SCALE: 1 : 250	
VERTICAL: 1 : 10	
DATE: 18/03/2019	

ENGINEER'S SEAL  
PROVINCE OF MANITOBA  
FIRST LAST  
Member #  
REGISTERED ENGINEER

**THE CITY OF WINNIPEG**  
PUBLIC WORKS DEPARTMENT

**ASSINIBOINE PARK DRIVE**  
FROM COMMISSARY ROAD TO ZOO DRIVE  
MILL & FILL, ASPHALT RECONSTRUCTION AND ASSOCIATED WORKS  
FROM STA. 4+50 TO STA. 5+70

CITY DRAWING NUMBER  
P-3504-23  
SHEET 23 OF 28

4