

NOTE: CHAINAGES SHOWN ARE ALONG E. R. OF WABASHA STREET

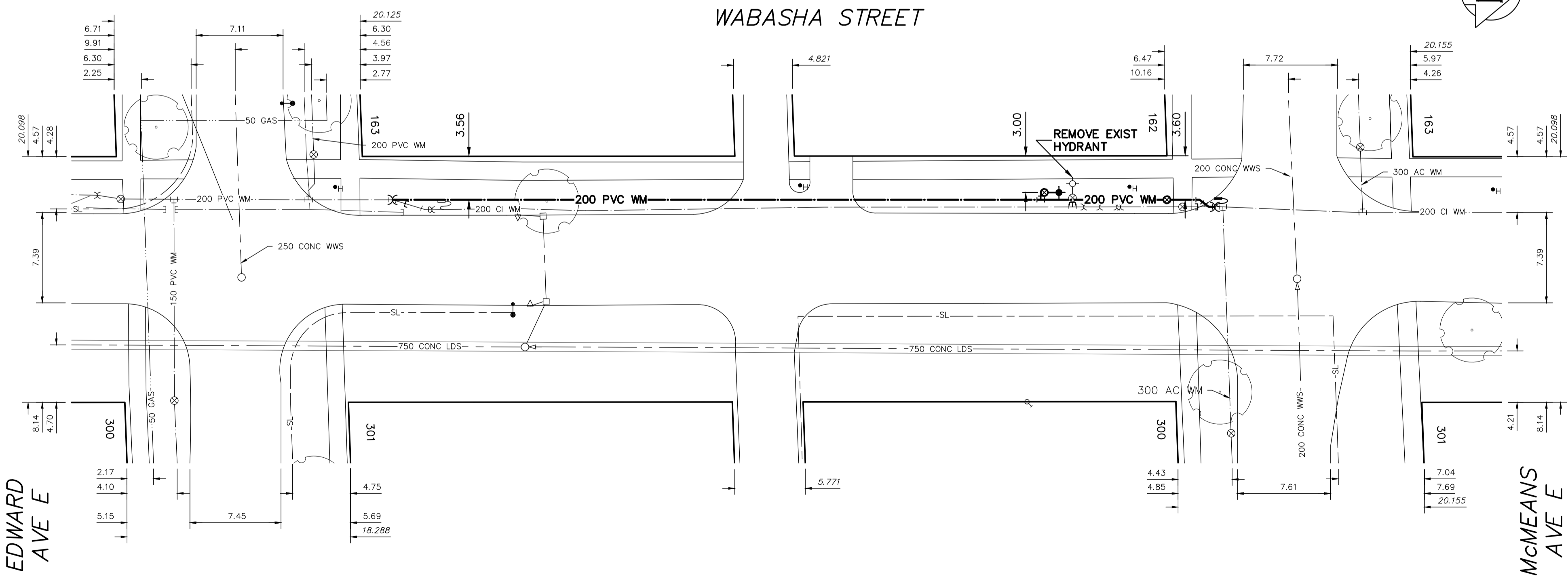

WATER SERVICE INFORMATION

ADDRESS	SIZE (mm) MATERIAL (STREET)	SIZE (mm) MATERIAL (PROP.)	SHORT & LONG MEASUREMENT	CORP. LOCATION	REMARKS
162 McMEANS AVE	-	20	3.72 WEL HSE	-	OUTSIDE LIMITS
RESIDENTIAL	-	CU	7.395 WML WABASHA AVE	-	-
300 McMEANS AVE	-	20	6.27 SNL HSE	-	RECONNECTED SERVICE
RESIDENTIAL	-	CU	12.178 SSL McMEANS AVE E	-	-
163 EDWARD AVE E	20	20	2.86 WEL HSE	1.1 E OF S/C	OUTSIDE LIMITS
RESIDENTIAL	CU	LEAD	7.420 WML WABASHA AVE	0.6 E OF S/C	OUTSIDE LIMITS
301 EDWARD AVE E	20	20	0.76 WML HSE	-	OUTSIDE LIMITS
RESIDENTIAL	CU	CU	12.966 WML RIGHT ST	-	-

*SERVICES TO BE RENEWED TO R. ALL OTHERS TO BE RECONNECTED

FOR INDEX SEE D-15482

NOTE: ALL VALVES TO BE INSTALLED CLOCKWISE TO CLOSE

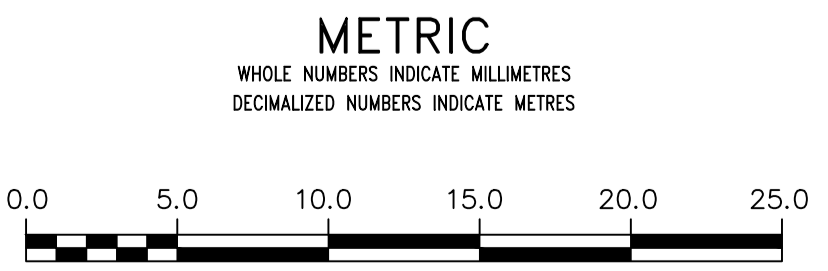

WARNING
IF POWER EQUIPMENT OR EXPLOSIVES ARE TO BE USED FOR EXCAVATION ON THIS PROJECT THE CONTRACTOR MUST:
1) NOTIFY THE GAS COMPANY OF THE PROPOSED LOCATION OF EXCAVATION.
2) TAKE PRECAUTION TO AVOID DAMAGE TO GAS COMPANY INSTALLATIONS.
SEE PROVINCIAL REGULATION 21072 FOR DETAILS

LOCATION APPROVED
UNDERGROUND STRUCTURES
SUPV. U/G STRUCTURES COMMITTEE DATE
NOTE:
LOCATION OF UNDERGROUND STRUCTURES AS SHOWN ARE BASED ON THE BEST INFORMATION AVAILABLE BUT NO GUARANTEE IS GIVEN THAT ALL EXISTING UTILITIES ARE SHOWN OR THAT THE GIVEN LOCATIONS ARE EXACT. CONFIRMATION OF EXISTENCE AND EXACT LOCATION OF ALL SERVICES MUST BE OBTAINED FROM THE INDIVIDUAL UTILITIES BEFORE PROCEEDING WITH CONSTRUCTION.

B.M. ELEV.	NO.	REVISIONS	DATE	BY

DESIGNED BY	MJK	CHECKED BY	SC
DRAWN BY	RS	APPROVED BY	KZ
SCALE:		RELEASED FOR CONSTRUCTION	
HORIZONTAL	1:250		
VERTICAL	1:50		
DATE	2019 06 13	DATE	2019-06-13

ENGINEER'S SEAL
ORIGINAL SIGNED BY
S.R.J. COURNOYER
19/06/13
CONSULTANT DRAWING NUMBER

THE CITY OF WINNIPEG
WATER AND WASTE DEPARTMENT
ENGINEERING DIVISION
2019 WATER MAIN RENEWALS
CONTRACT 10
WABASHA STREET
EDWARD AVENUE EAST TO
MCMEANS AVENUE EAST

SHEET 10 OF 10
CITY DRAWING NUMBER
D-15490